

PUB. SEWER STATUS VERIFIED BY _____

ISSUE DATE: _____

APPROVAL DATE: _____

PERMIT

INDEXED

ON-SITE SEWAGE DISPOSAL SYSTEM HOWARD COUNTY HEALTH DEPARTMENT BUREAU OF ENVIRONMENTAL HEALTH

P Re-index

A 519872-L

02-242400

IS PERMITTED TO INSTALL ALTER

ADDRESS: _____ PHONE NUMBER: _____

SUBDIVISION: Allenford LOT NUMBER: 27

ADDRESS: 10162 Green Clover Road PROPERTY OWNER: Charles Schubert

SEPTIC TANK CAPACITY (GALLONS): _____

PUMP CHAMBER CAPACITY (GALLONS): _____

NUMBER OF BEDROOMS: _____

SQUARE FEET PER BEDROOM: _____

LINEAR FEET OF TRENCH REQUIRED: _____

TRENCHES:	Trench to be _____ feet wide. Inlet _____ feet below original grade. Bottom maximum depth _____ feet below original grade. Effective area begins at _____ feet below original grade. _____ feet of stone below distribution pipe.
LOCATION:	Re-index
PURPOSE:	

PLANS APPROVED: _____ DATE: _____

- NOTE: PERMIT VOID AFTER 2 YEARS
- NOTE: CONTRACTOR RESPONSIBLE FOR SCHEDULING A PRE-CONSTRUCTION INSPECTION FOR ALL INSTALLATIONS
- NOTE: WATERTIGHT SEPTIC TANKS REQUIRED
- NOTE: ALL PARTS OF SEPTIC SYSTEM SHALL BE 100 FEET FROM ANY WATER WELL
- NOTE: MANHOLE RISERS REQUIRED ON ALL SEPTIC TANKS AND PUMP CHAMBERS

NEITHER THE HOWARD COUNTY COUNCIL NOR THE HEALTH DEPARTMENT IS RESPONSIBLE FOR THE SUCCESSFUL OPERATION OF ANY SYSTEM PERMITTEE RESPONSIBLE FOR OBTAINING FINAL APPROVAL ON THIS PERMIT CALL 410-313-2640 FOR INSPECTION OF SEPTIC SYSTEM

A519872-L

11-12-71
JW

PERMIT

SEWAGE DISPOSAL SYSTEM

MARYLAND STATE DEPARTMENT OF HEALTH

HOWARD COUNTY

INDEXED

P 16400

A 13000

ELLICOTT CITY

DISTRICT 2

DATE 11/12/71

Douglas Lichter IS PERMITTED TO INSTALL ALTER

ADDRESS 10084 Mapleswood Drive, Ellicott City, Md. PHONE 465-2051

A SEWAGE DISPOSAL SYSTEM LOCATED AT _____

SUBDIVISION Alford ROAD Green Clover Dr. LOT 27, Blk. B, Sec.

PROPERTY OWNER SAME AS ABOVE

ADDRESS _____

SPECIFICATIONS - 3 bedrooms

DRAIN FIELD _____ DEPTH _____ FEET. BOTTOM AREA _____ SQ. FT.

SEEPAGE PITS _____ ABSORBENT SIDE-WALL AREA _____ SQ. FT.

SEPTIC TANK CAPACITY 1,000 GALLONS

FOR GARBAGE GRINDER, INCREASE DISPOSAL AREA 22% & TANK CAPACITY 50%.

OTHER Dry well - 100 sq. ft. sidewall and below the inlet with a maximum depth below original grade at time of penetration test of 11 ft. Place the dry well between 25 ft. and 30 ft. from the front lot line and between 20 ft. and 40 ft. from the right side of the lot as seen when facing the lot from Green Clover Drive.

NOTE: ALL PIPE FROM HOUSE TO SEPTIC TANK MUST BE CAST IRON.

PERMIT VOID AFTER THREE YEARS.

NOTE: INSTALL STAND PIPE ON SEPTIC TANK AND DRY WELL.

PLANS APPROVED BY Raymond Rodgers DATE 11/17/71

FILL SEPTIC TANK AND DISTRIBUTION BOX WITH WATER BEFORE CALLING FOR AN INSPECTION. COVER NO WORK UNTIL INSPECTED AND APPROVED.

NEITHER THE HOWARD COUNTY COMMISSIONERS NOR THE HEALTH DEPARTMENT IS RESPONSIBLE FOR THE SUCCESSFUL OPERATION OF ANY SYSTEM.

*trunk length 100 ft., Inlet welded, max depth 8 ft at
back (front) and 3 ft stone, etc.*

13190

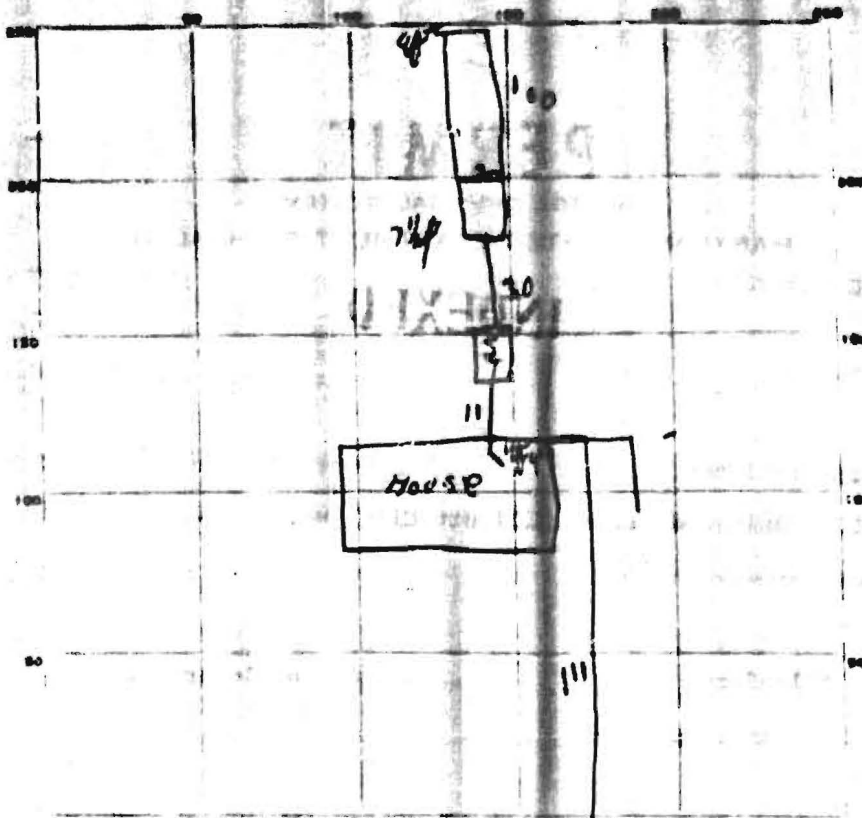

Iron Clove Dr

PERMIT CARD OK

SEPTIC TANK LEVEL OK

CLEANOUTS OK

DISTRIBUTION BOX LEVEL

TILE FIELD DEPTH 2 1/2 ft FT. TRENCH WIDTH 2 FT.

GRAVEL DEPTH _____ IN. TOTAL LENGTH 100 FT.

NUMBER OF TRENCHES 1 TOTAL BOTTOM AREA 200

SEEPAGE PITS INSIDE DIAMETER _____ FT. DEPTH BELOW INLET _____ FT.

ABSORBENT AREA 600 SQ. FT.

REMARKS 12-3-71 gravel to 3 ft of grade

DATE SYSTEM APPROVED 12-3-71

INSPECTOR W. M. M...