

04-346238

PERMIT

SEWAGE DISPOSAL SYSTEM

MARYLAND STATE DEPARTMENT OF HEALTH

P 44574

A 38671

DISTRICT 4th

DATE 6/4/89

DATE SYSTEM APPROVED 8-8-89

INSPECTOR S. Abel
R. Hodge

HOWARD COUNTY

BUREAU OF ENVIRONMENTAL HEALTH

461-9933

INDEXED

8/7/89
TAA
8/8/89
AMASAP

Fogle's Refuse & Septic Service, Inc.

IS PERMITTED TO INSTALL ALTER

ADDRESS 558 R. Obrecht Road, Sykesville, MD 21784 PHONE 795-5670

SUBDIVISION Lauran Property ROAD 17590 Hardy Road LOT 7

PROPERTY OWNER James L. Feage

ADDRESS _____

IF GARBAGE GRINDER IS USED INCREASE SEPTIC TANK CAPACITY BY 50% AND ABSORPTION AREA BY 22%.

GARBAGE GRINDER? YES NO

SEPTIC TANK CAPACITY 1500 GALLONS NUMBER OF BEDROOMS 5

TRENCHES - 210 sq. ft. per bedroom. Trench to be 2 feet wide. Inlet 4 feet below original grade. Bottom maximum depth 8 feet below original grade. Effective area begins at 4 feet below original grade. 4 feet of stone below distribution pipe.

LOCATION - Start the first trench 250 feet from the front lot line and 70 feet from the right lot line as seen when facing the lot from Hardy Road. Run trenches on contour toward the left lot line.

NOTE - No trench to exceed 100 feet in length. Provide 6" - 8" diameter cleanout and cap to grade or above on septic tank. o/c/w

PLANS APPROVED BY Sid Abel DATE 3/27/89

COVER NO WORK UNTIL INSPECTED AND APPROVED

NEITHER THE HOWARD COUNTY COUNCIL NOR THE HEALTH DEPARTMENT IS RESPONSIBLE FOR THE SUCCESSFUL OPERATION OF ANY SYSTEM.

NOTE: CLEANOUT REQUIRED EVERY 70 FEET OF SEWER LINE AND/OR AT 90° SWEEPS IN LINES FROM HOUSE TO DRAIN FIELDS

NOTE: ALL PARTS OF SEPTIC SYSTEMS (I.E. TANK, DISTRIBUTION BOX, TRENCHES) TO BE 100 FEET FROM WELL (UNLESS OTHERWISE SPECIFICALLY AUTHORIZED)

NOTE: IF DEEP TRENCHES ARE USED CALL FOR INSPECTION BEFORE AND AFTER PLACING GRAVEL IN TRENCHES

NOTE: NO DRY WELL SHALL EXCEED 15 FOOT IN DIAMETER NO ABSORPTION TRENCH TO EXCEED 100 FEET IN LENGTH.

NOTE: ALL PIPE FROM HOUSE TO SEPTIC TANK MUST BE CAST IRON OR SCHEDULE 40 PVC OR ABS

PERMIT VOID AFTER TWO YEARS

NOTE: INSTALL STAND PIPE ON SEPTIC TANK AND DRY WELL. STAND PIPES MUST BE 6 INCHES IN DIAMETER. CAST IRON, CONCRETE OR TERRA COTTA OR PVC OR ABS ACCEPTED. IF TOP OF SEPTIC TANK IS DEEPER THAN 3 FEET, MANHOLE TO GRADE REQUIRED

NOTE: DISTRIBUTION BOXES MUST HAVE BAFFLES

***INSTALLER IS RESPONSIBLE FOR OBTAINING FINAL APROVAL ON THIS PERMIT**

*CALL 461-9933 FOR INSPECTION OF SEPTIC SYSTEMS.

A
38671

$$\begin{array}{r} 88 \\ 3 \overline{)262} \\ \underline{24} \\ 22 \end{array}$$

$$\begin{array}{r} 262 \\ 4 \overline{)1050} \\ \underline{8} \\ 25 \\ \underline{24} \\ 10 \end{array}$$

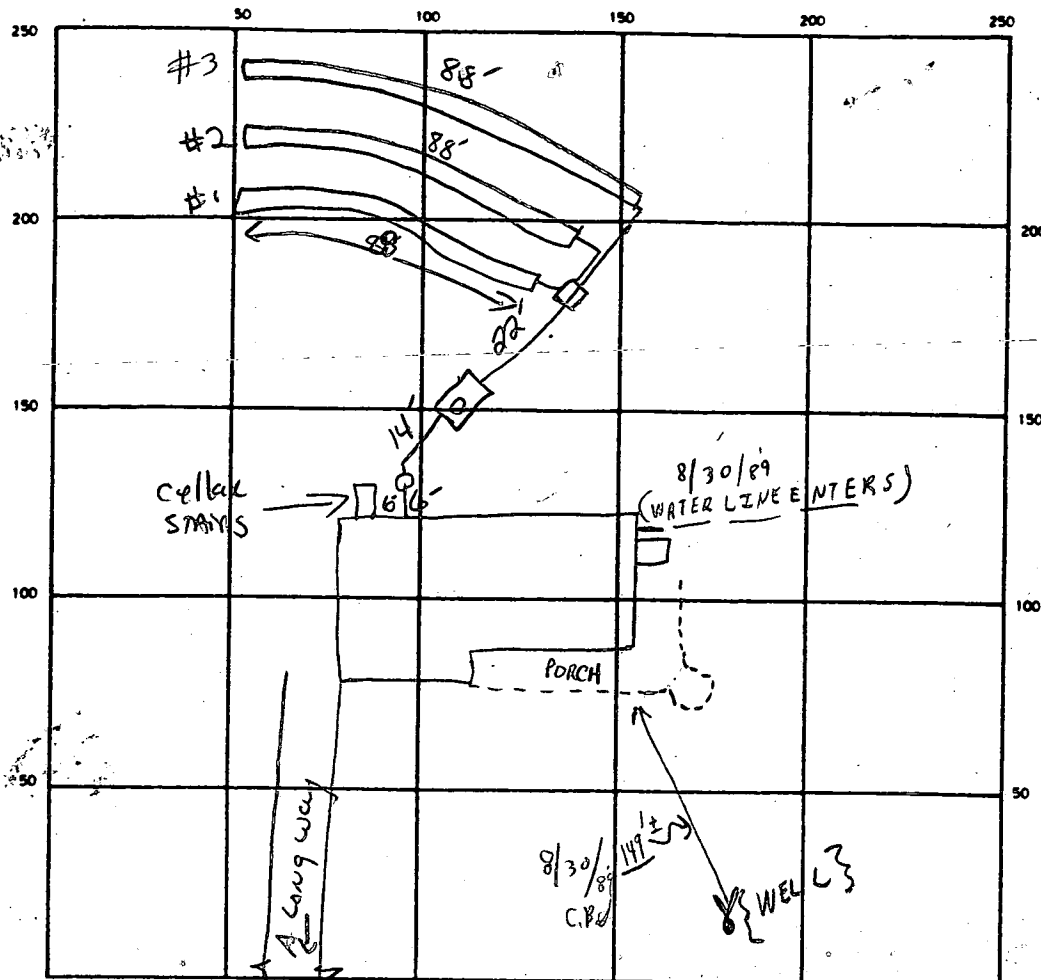

INDICATE NORTH - NAME ADJOINING ROADWAY AS BASE LINE
Hardy Rd.

SEPTIC TANK LEVEL 1500 GAL CLEANOUTS

 DISTRIBUTION BOX LEVEL

 DRAIN FIELD/TILE FIELD DEPTH 8 FT. TRENCH WIDTH 2 FT. INLET DEPTH 4 FT.

EFFECTIVE GRAVEL DEPTH 4 FT. TOTAL LENGTH 88 88 88 ^{① ② ③} TF 264 FT.

NUMBER OF TRENCHES 3 ONE SIDEWALL BOTTOM AREA 1056 SQ. FT.

DRYWELL INSIDE DIAMETER FT. EFFECTIVE DEPTH BELOW INLET FT.

ABSORBENT AREA 1056 SQ. FT.

REMARKS 8-7-89 OK TO hold stone to #1 & 2, Dig #3

8-8-89 IF Insp NOT ON SITE by 10:30 go ahead AND STONE trench SA

8/9/89 TRENCH #3 OK R/H SIDE HAD ALREADY

LEFT STICKER TO COVER SYSTEM R/H

DATE SYSTEM APPROVED 8-8-89 INSPECTOR S. Abel

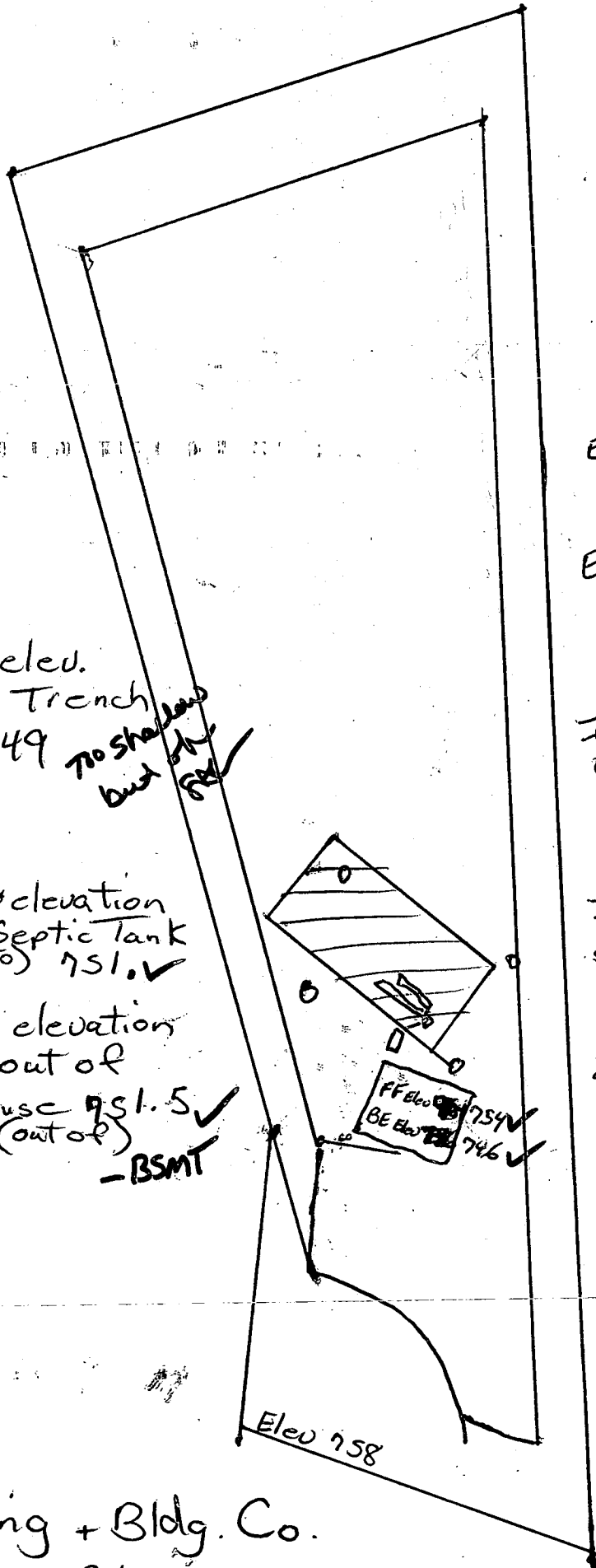

Existing Elev
at Trench
750.8 ✓

Existing ele.
at dist. Box
751 ✓

Inv. elevation
into dist. Box
749.8 ✓

Inv. Elev.
out of
septic tank
750.8 ✓

Exist Elev.
at Septic
750.5 ✓

Inv. elev.
into Trench
749
no shallow
but 8 ft ✓

Inv. elevation
at Septic Tank
(into) 751.5 ✓

Inv. elevation
out of
house 751.5 ✓
(out of)
-BSMT

BLDG. PERMIT SIGNED
AND RETURNED 42789
BP 24993
S-ell

Elev 758

Feaga Contracting + Bldg. Co.

Lot 7 Hardy Rd
Laurand.