

1/21/04

PUB. SEWER STATUS VERIFIED BY NA

ISSUE DATE: 12/3/2003

PERMIT

P 519685

APPROVAL DATE: 1/21/04

A UPGRADE

ON-SITE SEWAGE DISPOSAL SYSTEM HOWARD COUNTY HEALTH DEPARTMENT BUREAU OF ENVIRONMENTAL HEALTH

03-288250

Jack Fyock Septic Service IS PERMITTED TO INSTALL ALTER

ADDRESS: 13775 Triadelphia Rd., Glenelg PHONE NUMBER: 410-988-9270

SUBDIVISION: _____ LOT NUMBER: _____

ADDRESS: 12510 Route 99 (Old Frederick Rd.) PROPERTY OWNER: Floyd Cagle

SEPTIC TANK CAPACITY (GALLONS): Existing 1000

PUMP CHAMBER CAPACITY (GALLONS): N/A

NUMBER OF BEDROOMS: 3

SQUARE FEET PER BEDROOM: 180

LINEAR FEET OF TRENCH REQUIRED: 120

Inlet - 3.5'
Depth - 8.0'
2' Wide

TRENCHES:	Trench to be <u>2</u> feet wide. Inlet <u> </u> feet below original grade. Bottom maximum depth <u> </u> feet below original grade. Effective area begins at <u> </u> feet below original grade. <u> </u> feet of stone below distribution pipe.
LOCATION:	
PURPOSE:	Perc test & system upgrade to support future building permit addition for a garage. Septic system to be relocated.

PLANS APPROVED: _____ DATE: 11/19/03

- NOTE: PERMIT VOID AFTER 2 YEARS
- NOTE: CONTRACTOR RESPONSIBLE FOR SCHEDULING A PRE-CONSTRUCTION INSPECTION FOR ALL INSTALLATIONS
- NOTE: WATERTIGHT SEPTIC TANKS REQUIRED
- NOTE: ALL PARTS OF SEPTIC SYSTEM SHALL BE 100 FEET FROM ANY WATER WELL
- NOTE: MANHOLE RISERS REQUIRED ON ALL SEPTIC TANKS AND PUMP CHAMBERS

NEITHER THE HOWARD COUNTY COUNCIL NOR THE HEALTH DEPARTMENT IS RESPONSIBLE FOR THE SUCCESSFUL OPERATION OF ANY SYSTEM PERMITTEE RESPONSIBLE FOR OBTAINING FINAL APPROVAL ON THIS PERMIT CALL 410-313-2640 FOR INSPECTION OF SEPTIC SYSTEM

P 519685-A

NOT TO SCALE

Significant Swale

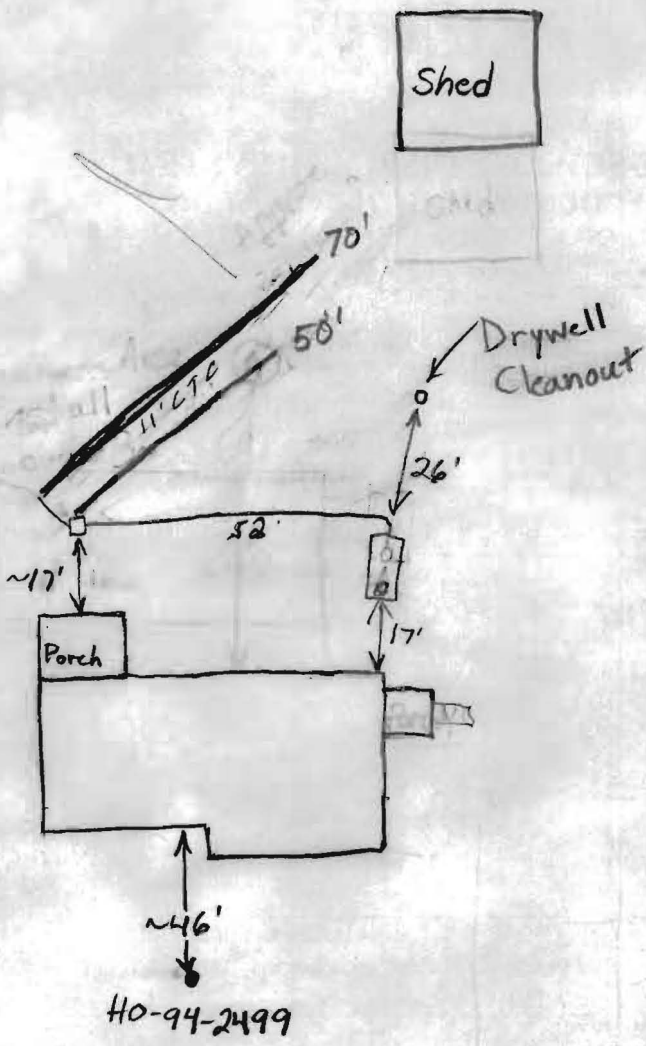

TRENCH/DRAINFIELD DATA		
WIDTH	INLET	BOTTOM
2	3.5	8
NUMBER OF TRENCHES		2
TOTAL LENGTH		120
ABSORPTION AREA		540 ϕ
DISTRIBUTION BOX LEVEL		<input checked="" type="checkbox"/>
DISTRIBUTION BOX BAFFLE		<input checked="" type="checkbox"/>
DISTRIBUTION BOX PORT		<input type="checkbox"/>

SEPTIC TANK DATA	
SEPTIC TANK 1 LEVEL	<input checked="" type="checkbox"/>
CAPACITY	Ex. 1000 GAL
SEAM LOC	Mid
TANK LID DEPTH	2'
BAFFLES	
BAFFLE FILTER	
MANHOLE LOC	
6" PORT LOC	
WATERTIGHT TEST	
SEPTIC TANK 2 LEVEL	
CAPACITY	GAL
SEAM LOC	
TANK LID DEPTH	
BAFFLES	
BAFFLE FILTER	
MANHOLE LOC	
6" PORT LOC	
WATERTIGHT TEST	

Old Frederick Road ROAD

PRE-CONSTRUCTION 12/3/03 To install two trenches on contour with the high trench near perch hole A. The trenches should
 INSTALLATION total 120'. O.K. to connect to and keep using the existing tank if adequate clearance for repairs can be maintained from proposed garage. Keep trenches away from swale. (BB) 1/21/04 - OK to cover all work (SC)

FINAL INSPECTOR [Signature] DATE OF APPROVAL 1/21/04