



# APPLICATION

## FOR PERCOLATION TESTING AND SITE EVALUATION

TEST DATE(S) 11/19/03 TEST TIME 9:00 Am AP 519648

AGENCY REVIEW: \_\_\_\_\_ DATE \_\_\_\_\_

DO NOT WRITE ABOVE THIS LINE

I HEREBY APPLY FOR THE NECESSARY TESTING/EVALUATION PRIOR TO ISSUANCE OF SEWAGE DISPOSAL SYSTEM PERMIT(S) TO:

CHECK AS NEEDED:

- CONSTRUCT NEW SEPTIC SYSTEM(S)
- REPAIR/ADD TO AN EXISTING SEPTIC SYSTEM
- REPLACE AN EXISTING SEPTIC SYSTEM

CHECK AS NEEDED:

- NEW STRUCTURE(S)
- ADDITION TO AN EXISTING STRUCTURE
- REPLACE AN EXISTING STRUCTURE

CHECK ONE:

- CREATE NEW LOT(S)
- BUILD ON AN EXISTING LOT IN A SUBDIVISION
- BUILD ON AN EXISTING PARCEL OF RECORD

IS THE PROPERTY WITHIN 2500' OF ANY RESERVOIR?

- YES
- NO

THE TYPE OF STRUCTURE IS:

- RESIDENTIAL WITH \_\_\_\_\_ PROPOSED BEDROOMS IN THE COMPLETED STRUCTURE (NOTE **UNKNOWN** IF APPROPRIATE)
- COMMERCIAL (PROVIDE DETAIL OF NUMBERS AND TYPES OF EMPLOYEES/ CUSTOMERS ON ACCOMPANYING PLAN)
- INSTITUTIONAL/GOVERNMENT (PROVIDE DETAIL OF NUMBERS AND TYPES OF EMPLOYEES/USERS ON ACCOMPANYING PLAN)

PROPERTY OWNER(S) JOHN C. MURPHY

DAYTIME PHONE 301-490-6400 Home 301-854-1545 FAX \_\_\_\_\_

MAILING ADDRESS 7519 BROWNS BRIDGE ROAD, Highland MD 20777  
STREET CITY/TOWN STATE ZIP

APPLICANT JOHN C. MURPHY

DAYTIME PHONE 301-490-6400 Home 301-854-1545 FAX \_\_\_\_\_

MAILING ADDRESS 7519 BROWNS BRIDGE RD, Highland MD 20777  
STREET CITY/TOWN STATE ZIP

APPLICANT'S ROLE: DEVELOPER BUILDER BUYER RELATIVE/FRIEND REALTOR CONSULTANT

PROPERTY LOCATION  
SUBDIVISION/PROPERTY NAME \_\_\_\_\_ LOT NO. \_\_\_\_\_

PROPERTY ADDRESS 7519 BROWNS BRIDGE ROAD  
STREET TOWN/POST OFFICE

TAX MAP PAGE(S) 40 GRID 18 PARCEL(S) 214 PROPOSED LOT SIZE \_\_\_\_\_

AS APPLICANT, I UNDERSTAND THE FOLLOWING: THE SYSTEM INSTALLED SUBSEQUENT TO THIS APPLICATION IS ACCEPTABLE ONLY UNTIL PUBLIC SEWERAGE IS AVAILABLE. THIS APPLICATION IS COMPLETE WHEN ALL APPLICABLE FEES AND A SUITABLE SITE PLAN HAVE BEEN RECEIVED. I ACCEPT THE RESPONSIBILITY FOR COMPLIANCE WITH ALL M.O.S.H.A. AND "MISS UTILITY" REQUIREMENTS. APPROVAL IS BASED UPON SATISFACTORY REVIEW OF A PERC CERTIFICATION PLAN.

TEST RESULTS WILL BE MAILED TO APPLICANT. \_\_\_\_\_  
SIGNATURE OF APPLICANT

HOWARD COUNTY HEALTH DEPARTMENT, BUREAU OF ENVIRONMENTAL HEALTH, WELL AND SEPTIC PROGRAM  
3525-H ELLICOTT MILLS DRIVE, ELLICOTT CITY, MARYLAND 21043-4544 (410) 313-1771 FAX (410) 313-2648  
TDD (410) 313-2323 TOLL FREE 1-877-4MD-DHMH

A/P \_\_\_\_\_

DATE	TEST #	DEPTH	START	BREAK 1" DROP	STOP 2" DROP	TIME OF 2nd INCH	P/F/H.

REMARKS \_\_\_\_\_

SANITARIAN \_\_\_\_\_ BACKHOE \_\_\_\_\_ OTHERS \_\_\_\_\_

TEST HOLES USED IN SDA \_\_\_\_\_ AVG. PERC TIME \_\_\_\_\_ SQ. FT/BR \_\_\_\_\_

TRENCH WIDTH \_\_\_\_\_ INLET DEPTH \_\_\_\_\_ MAX. BOT DEPTH \_\_\_\_\_ EFFECTIVE S/W \_\_\_\_\_

AP

①

Brown  
moist SL

1  
Orange-brown  
SCL

2 1/2  
hard  
orange-brown  
Lay (59' over  
fines

4  
Fine  
yellow  
brown  
micaceous  
SL

10 water

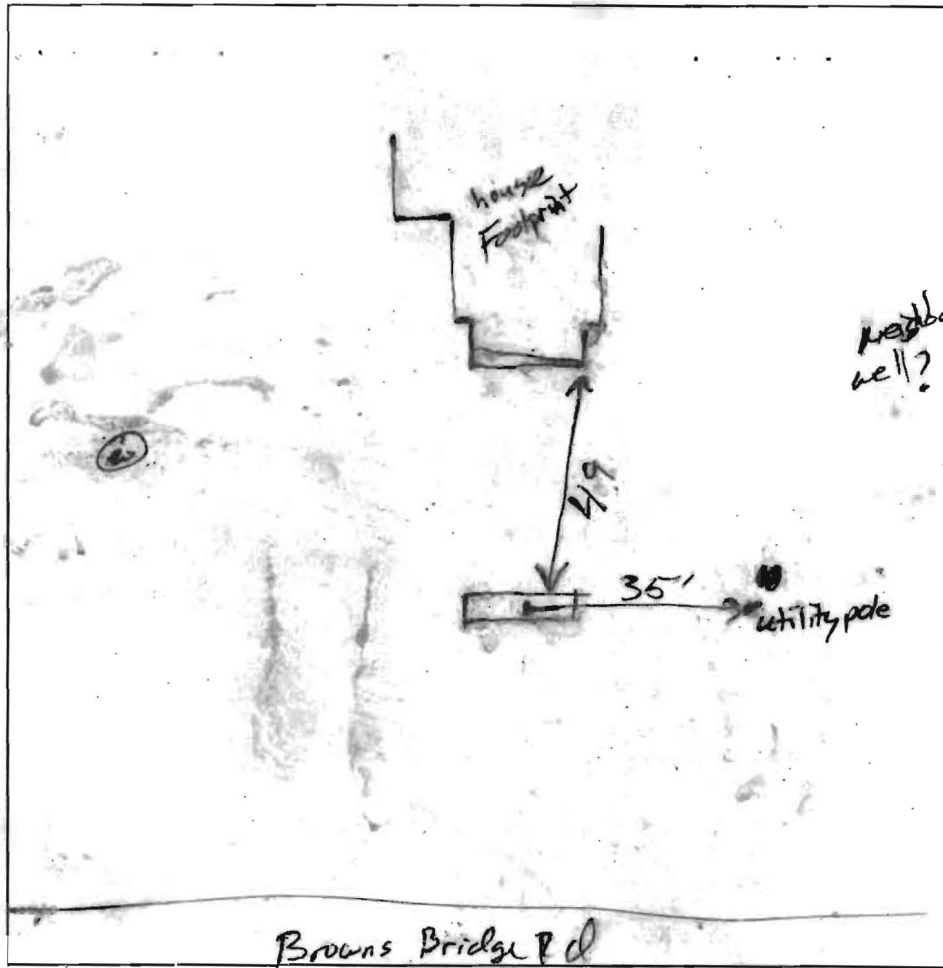

Neighb  
well?

DATE	TEST #	DEPTH	START	BREAK 1" DROP	STOP 2" DROP	TIME OF 2nd INC!!	P/E/H
11/6/03	①	<del>5</del> 13	9:52	10:05	Dirt Clod	~25-30	P
		<del>6</del> 13	10:17	10:22	10:31	9	P

REMARKS Perc for remodel/repair

SANITARIAN J. Borz BACKHOE Ms. Murphy OTHERS \_\_\_\_\_

TEST HOLES USED IN SDA ① AVG. PERC TIME 9 SQ. FT/BR 210

TRENCH WIDTH 3 INLET DEPTH 4 MAX. BOT DEPTH 6 EFFECTIVE SW 1

$3 \times 210 = 630 \div 3 = 210 \times .83 = 174$  so. 3-2-3x57x6

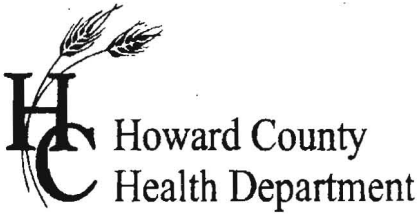

"RIR"  
**APPLICATION**

**FOR PERCOLATION TESTING AND SITE EVALUATION**

TEST DATE(S) \_\_\_\_\_ TEST TIME \_\_\_\_\_ A/P \_\_\_\_\_

AGENCY REVIEW: \_\_\_\_\_ DATE \_\_\_\_\_

DO NOT WRITE ABOVE THIS LINE

I HEREBY APPLY FOR THE NECESSARY TESTING/EVALUATION PRIOR TO ISSUANCE OF SEWAGE DISPOSAL SYSTEM PERMIT(S) TO:

CHECK AS NEEDED:

- CONSTRUCT NEW SEPTIC SYSTEM(S)
- REPAIR/ADD TO AN EXISTING SEPTIC SYSTEM
- REPLACE AN EXISTING SEPTIC SYSTEM

CHECK AS NEEDED:

- NEW STRUCTURE(S)
- ADDITION TO AN EXISTING STRUCTURE
- REPLACE AN EXISTING STRUCTURE

CHECK ONE:

- CREATE NEW LOT(S)
- BUILD ON AN EXISTING LOT IN A SUBDIVISION
- BUILD ON AN EXISTING PARCEL OF RECORD

IS THE PROPERTY WITHIN 2500' OF ANY RESERVOIR?

- YES
- NO

THE TYPE OF STRUCTURE IS:

- RESIDENTIAL WITH \_\_\_\_\_ PROPOSED BEDROOMS IN THE COMPLETED STRUCTURE (NOTE *UNKNOWN* IF APPROPRIATE)
- COMMERCIAL (PROVIDE DETAIL OF NUMBERS AND TYPES OF EMPLOYEES/ CUSTOMERS ON ACCOMPANYING PLAN)
- INSTITUTIONAL/GOVERNMENT (PROVIDE DETAIL OF NUMBERS AND TYPES OF EMPLOYEES/USERS ON ACCOMPANYING PLAN)

PROPERTY OWNER(S) \_\_\_\_\_

DAYTIME PHONE \_\_\_\_\_ CELL \_\_\_\_\_ FAX \_\_\_\_\_

MAILING ADDRESS \_\_\_\_\_  
STREET \_\_\_\_\_ CITY/TOWN \_\_\_\_\_ STATE \_\_\_\_\_ ZIP \_\_\_\_\_

APPLICANT \_\_\_\_\_

DAYTIME PHONE \_\_\_\_\_ CELL \_\_\_\_\_ FAX \_\_\_\_\_

MAILING ADDRESS \_\_\_\_\_  
STREET \_\_\_\_\_ CITY/TOWN \_\_\_\_\_ STATE \_\_\_\_\_ ZIP \_\_\_\_\_

APPLICANT'S ROLE: DEVELOPER BUILDER BUYER RELATIVE/FRIEND REALTOR CONSULTANT

PROPERTY LOCATION  
SUBDIVISION/PROPERTY NAME \_\_\_\_\_ LOT NO. \_\_\_\_\_

PROPERTY ADDRESS \_\_\_\_\_  
STREET \_\_\_\_\_ TOWN/POST OFFICE \_\_\_\_\_

TAX MAP PAGE(S) \_\_\_\_\_ GRID \_\_\_\_\_ PARCEL(S) \_\_\_\_\_ PROPOSED LOT SIZE \_\_\_\_\_

AS APPLICANT, I UNDERSTAND THE FOLLOWING: THE SYSTEM INSTALLED SUBSEQUENT TO THIS APPLICATION IS ACCEPTABLE ONLY UNTIL PUBLIC SEWERAGE IS AVAILABLE. THIS APPLICATION IS COMPLETE WHEN ALL APPLICABLE FEES AND A SUITABLE SITE PLAN HAVE BEEN RECEIVED. I ACCEPT THE RESPONSIBILITY FOR COMPLIANCE WITH ALL M.O.S.H.A. AND "MISS UTILITY" REQUIREMENTS. APPROVAL IS BASED UPON SATISFACTORY REVIEW OF A PERC CERTIFICATION PLAN.

TEST RESULTS WILL BE MAILED TO APPLICANT. \_\_\_\_\_

SIGNATURE OF APPLICANT

HOWARD COUNTY HEALTH DEPARTMENT, BUREAU OF ENVIRONMENTAL HEALTH, WELL AND SEPTIC PROGRAM  
3525-H ELLICOTT MILLS DRIVE, ELLICOTT CITY, MARYLAND 21043-4544 (410) 313-1771 FAX (410) 313-2648  
TDD (410) 313-2323 TOLL FREE 1-877-4MD-DHMH