

PUB. SEWER STATUS VERIFIED BY \_\_\_\_\_

ISSUE DATE: 11/4/2003

P 519649

APPROVAL DATE: 11/13/03

A REPAIR

# PERMIT INDEXED

## ON-SITE SEWAGE DISPOSAL SYSTEM HOWARD COUNTY HEALTH DEPARTMENT BUREAU OF ENVIRONMENTAL HEALTH

04-308522

Jenkins Brothers

IS PERMITTED TO INSTALL  ALTER

ADDRESS: 7670 Smith's Private Road PHONE NUMBER: 410-461-9282

SUBDIVISION: Poplar Heights LOT NUMBER: 31/32

ADDRESS: 17010 Hardy Road PROPERTY OWNER: Robert Alan Berry

SEPTIC TANK CAPACITY (GALLONS): 1000

PUMP CHAMBER CAPACITY (GALLONS): N/A

NUMBER OF BEDROOMS: 3

SQUARE FEET PER BEDROOM: 240

LINEAR FEET OF TRENCH REQUIRED: 150

TRENCHES:	Trench to be <u>3</u> feet wide. Inlet <u>6</u> feet below original grade. Bottom maximum depth <u>8</u> feet below original grade. Effective area begins at <u>6</u> feet below original grade. <u>2</u> feet of stone below distribution pipe.
LOCATION:	<u>Install (2) 75' of trench - 10' CTC</u> <u>Ex D.W. &amp; S.T abandoned</u>
PURPOSE:	Septic system is failing. Call for inspection when the ground has been opened so sanitarian can recommend repair.

PLANS APPROVED: [Signature]

DATE: 11/17/03

- NOTE: PERMIT VOID AFTER 2 YEARS
- NOTE: CONTRACTOR RESPONSIBLE FOR SCHEDULING A PRE-CONSTRUCTION INSPECTION FOR ALL INSTALLATIONS
- NOTE: WATERTIGHT SEPTIC TANKS REQUIRED
- NOTE: ALL PARTS OF SEPTIC SYSTEM SHALL BE 100 FEET FROM ANY WATER WELL
- NOTE: MANHOLE RISERS REQUIRED ON ALL SEPTIC TANKS AND PUMP CHAMBERS

NEITHER THE HOWARD COUNTY COUNCIL NOR THE HEALTH DEPARTMENT IS RESPONSIBLE FOR THE SUCCESSFUL OPERATION OF ANY SYSTEM

PERMITTEE RESPONSIBLE FOR OBTAINING FINAL APPROVAL ON THIS PERMIT  
CALL 410-313-2640 FOR INSPECTION OF SEPTIC SYSTEM

**BUILDING PERMIT SIGNED  
AND RETURNED**

#2604 B00150043-2 CAR GARAGE

519649

☐ - shed

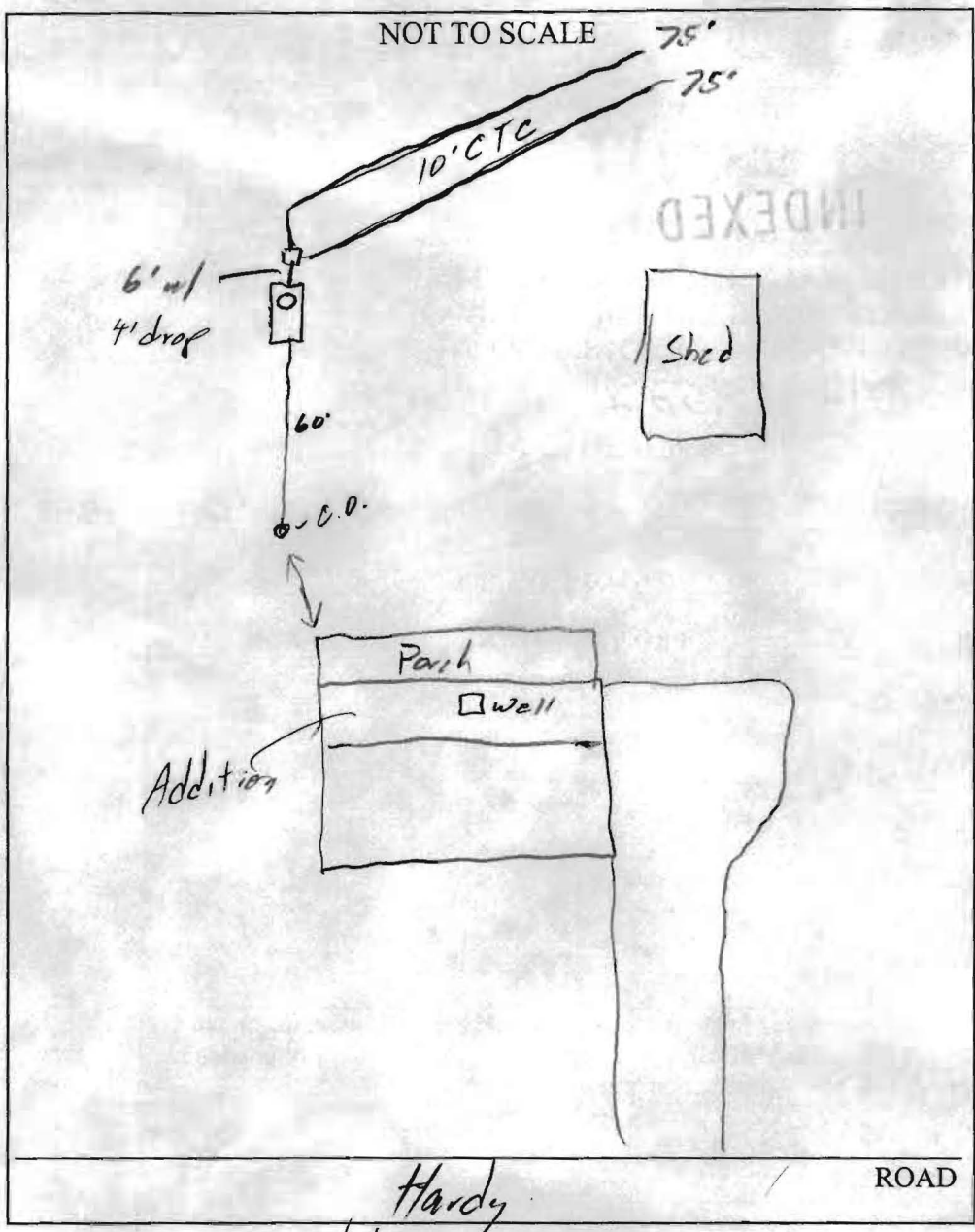

TRENCH/DRAINFIELD DATA		
WIDTH	INLET	BOTTOM
3'	6"	8"
NUMBER OF TRENCHES		2
TOTAL LENGTH		150'
ABSORPTION AREA		450 sq ft
DISTRIBUTION BOX LEVEL		<input checked="" type="checkbox"/>
DISTRIBUTION BOX BAFFLE		<input checked="" type="checkbox"/>
DISTRIBUTION BOX PORT		<input type="checkbox"/>

SEPTIC TANK DATA	
SEPTIC TANK 1 LEVEL	<input checked="" type="checkbox"/>
CAPACITY	1250 GAL
SEAM LOC	<input checked="" type="checkbox"/>
TANK LID DEPTH	18"
BAFFLES	<input checked="" type="checkbox"/>
BAFFLE FILTER	<input checked="" type="checkbox"/>
MANHOLE LOC	Back
6" PORT LOC	<input type="checkbox"/>
WATERTIGHT TEST	<input type="checkbox"/>
SEPTIC TANK 2 LEVEL	<input type="checkbox"/>
CAPACITY	_____ GAL
SEAM LOC	<input type="checkbox"/>
TANK LID DEPTH	_____
BAFFLES	<input type="checkbox"/>
BAFFLE FILTER	<input type="checkbox"/>
MANHOLE LOC	_____
6" PORT LOC	<input type="checkbox"/>
WATERTIGHT TEST	<input type="checkbox"/>

PRE-CONSTRUCTION 11/18/03 See prev notes

INSTALLATION 11/18/03 - Old S.T. ≠ D.W. abandoned. OK to cover all work (SC)

BUILDING PERMIT SIGNED AND RETURNED

FINAL INSPECTOR Steve [Signature]

DATE OF APPROVAL 11/18/03

SITE INSPECTION SHEET

OWNER: \_\_\_\_\_ PHONE #: \_\_\_\_\_

ADDRESS: \_\_\_\_\_ CONTRACTOR: \_\_\_\_\_

\_\_\_\_\_ WELL TAG #: \_\_\_\_\_

SUBDIVISION: \_\_\_\_\_ LOT: \_\_\_\_\_ COUNTY #: \_\_\_\_\_

PROPOSAL: \_\_\_\_\_

LOCATION DIAGRAM

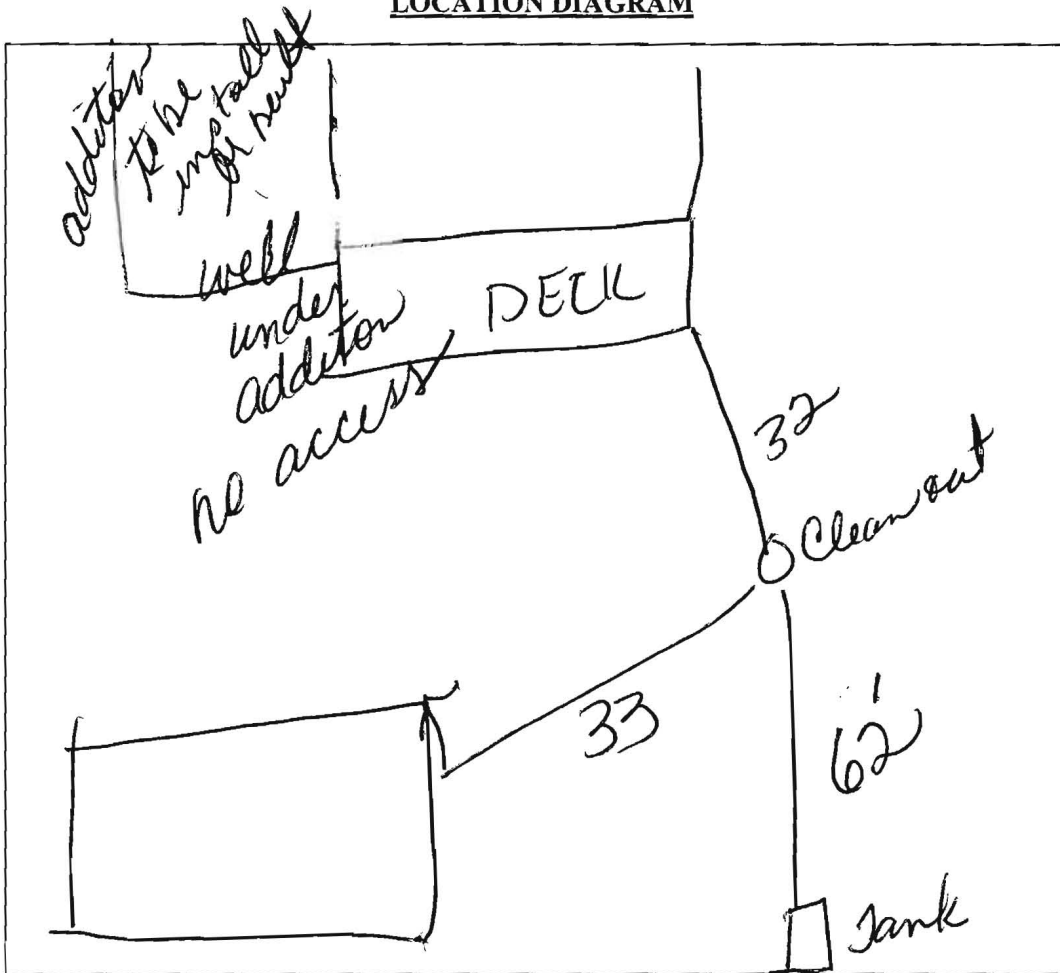

COMMENTS: \_\_\_\_\_

\_\_\_\_\_  
\_\_\_\_\_  
\_\_\_\_\_

DATE: \_\_\_\_\_ INSPECTOR: \_\_\_\_\_