

*When we can get it. Mr. Seck*

# PERMIT

SEWAGE DISPOSAL SYSTEM

MARYLAND STATE DEPARTMENT OF HEALTH

HOWARD COUNTY

ELLICOTT CITY

DISTRICT 9

DATE 7/20/67

INDEXED

Walter Seck

IS PERMITTED TO INSTALL 2 ALTER

ADDRESS 901 Kenneligh Dr., Silver Spring, Md. 20902

PHONE 997-6933

A SEWAGE DISPOSAL SYSTEM LOCATED AT \_\_\_\_\_

SUBDIVISION Green Hill Manor

ROAD Montell Court

LOT 7, Blk. 4

PROPERTY OWNER V. L. Vinella

ADDRESS 12531 Circle Dr., Glen Hills, Rockville, Md.

SPECIFICATIONS 4-Bedrooms

DRAIN FIELD \_\_\_\_\_ DEPTH \_\_\_\_\_ FEET, BOTTOM AREA \_\_\_\_\_ SQ. FT.

SEEPAGE PITS \_\_\_\_\_ ABSORBENT SIDE-WALL AREA \_\_\_\_\_ SQ. FT.

SEPTIC TANK CAPACITY 1000 GALLONS

FOR GARBAGE GRINDER, INCREASE DISPOSAL AREA 25% & TANK CAPACITY 50%.

OTHER Dry Well - 500 sq. ft. sidewall area below the inlet. Place the dry well

40 ft. to 60 ft. from the front lot line and 30 ft. to 125 ft. from the left side  
of the lot as seen when facing the lot from Montell Ct.

Prof. depth 14' below original grade  
PERMIT VOID AFTER THREE YEARS.

PLANS APPROVED BY Rayner I Hodges

DATE March 17, 1966.

FILL SEPTIC TANK AND DISTRIBUTION BOX WITH WATER BEFORE CALLING FOR AN INSPECTION. COVER NO WORK UNTIL INSPECTED AND APPROVED.

NEITHER THE HOWARD COUNTY COMMISSIONERS NOR THE HEALTH DEPARTMENT IS RESPONSIBLE FOR THE SUCCESSFUL OPERATION OF ANY SYSTEM.

## NOTIFY THE HEALTH DEPARTMENT 48 HOURS BEFORE EXCAVATIONS ARE TO BE BACK FILLED.

110328

A10328

A10328

July 6 - 0' cut at D.W. 5 mi at 4 1/2 d 8 1/2 ft.  
 cut ② 2 mi at 5' d 6 mi at 9 ft. 9 ft

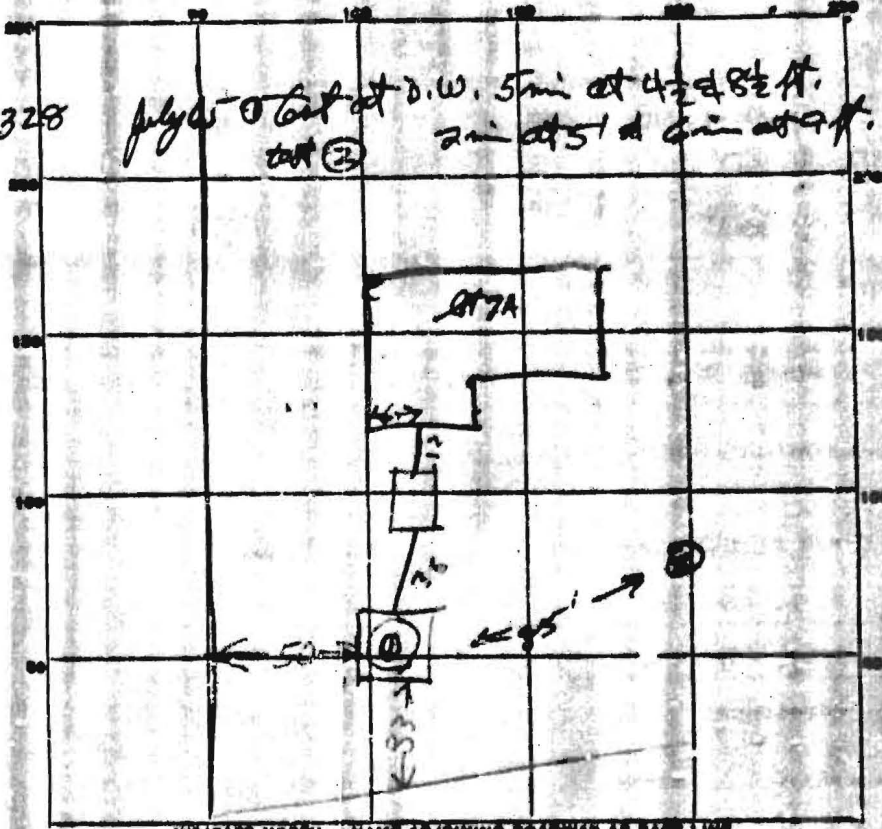

PERMIT CARD \_\_\_\_\_

SEPTIC TANK, LEVEL OK 1000 concrete CLEANOUTS OK  
 TOP IS 1 FT below grade  
 DISTRIBUTION BOX, LEVEL \_\_\_\_\_

TILE FIELD, DEPTH \_\_\_\_\_ FT. TRENCH WIDTH \_\_\_\_\_ FT.  
 GRAVEL DEPTH \_\_\_\_\_ IN. TOTAL LENGTH \_\_\_\_\_ FT.  
 NUMBER OF TRENCHES \_\_\_\_\_ TOTAL BOTTOM AREA \_\_\_\_\_

SEEPAGE PITS, INSIDE DIAMETER 7 FT. DEPTH BELOW INLET 12 FT.  
 ABSORBENT AREA 396 SQ. FT. covering stone not counting stone

REMARKS: AUG-67 Very Well Located 2 FT below  
ground level of very well is 33 ft. 396 sqft absorbent  
area covering stone  
Water Well not yet drilled

DATE SYSTEM APPROVED: AUG-67 INSPECTOR B. Hodges