

9/1/78 would like
disp if possible PARTIAL

Approved (60)
28 Sept 78

9/28/78

PERMIT

P 28638
A 15830

SEWAGE DISPOSAL SYSTEM

MARYLAND STATE DEPARTMENT OF HEALTH

HOWARD COUNTY

ELLICOTT CITY

DISTRICT 3rd

INDEXED

DATE 8/7/78

Mr. Paul Schissler IS PERMITTED TO INSTALL ALTER

ADDRESS 2338 Erin Road, Sukeyville, Md. 21764 PHONE

SUBDIVISION Woodmark ROAD 12223 Mt. Albert Road LOT 73, Blk. C

PROPERTY OWNER Dr. Dennis Gleicher

ADDRESS 12128 Carroll Mill Road, Ellicott City, Md.

SPECIFICATIONS 4 bedrooms

SEPTIC TANK CAPACITY 1250 GALLONS

DRAIN FIELD _____ DEPTH _____ FEET. BOTTOM AREA _____ SQ. FT.

DEEP TRENCH _____ DEPTH _____ FEET. BOTTOM AREA _____ SQ. FT.

SEEPAGE PITS _____ ABSORBENT SIDE-WALL AREA 480 SQ. FT.

INLET PIPE 5 FT BELOW ORIGINAL GRADE. MAXIMUM DEPTH 12 FT. BELOW ORIGINAL GRADE

EFFECTIVE DEPTH AT _____ FT. BELOW ORIGINAL GRADE.

LOCATE DISPOSAL AREA 205± FT. FROM front LOT LINE AND 51 FT FROM left LOT LINE AS SEEN WHEN
FACING LOT FROM Mt. Albert Road.

PLANS APPROVED BY Raymond Hodges DATE 6/25/73

COVER NO WORK UNTIL INSPECTED AND APPROVED.

NEITHER THE HOWARD COUNTY COUNCIL NOR THE HEALTH DEPARTMENT IS RESPONSIBLE FOR THE SUCCESSFUL OPERATION OF ANY SYS

NOTE IF TRENCH IS USED CALL FOR INSPECTION BEFORE PLACING GRAVEL IN TRENCH.

NOTE NO DRY WELL SHALL EXCEED 16 FOOT IN DIAMETER.

NOTE ALL PIPE FROM HOUSE TO DISPOSAL AREA MUST BE CAST IRON.

PERMIT VOID AFTER THREE YEARS

NOTE INSTALL STAND PIPE ON SEPTIC TANK AND DRY WELL STAND PIPES MUST BE 8 INCHES IN DIAMETER. CAST IRON, CONCRETE OR T
COTTA ACCEPTED

*INSTALLER IS RESPONSIBLE FOR OBTAINING FINAL APPROVAL ON THIS PERM

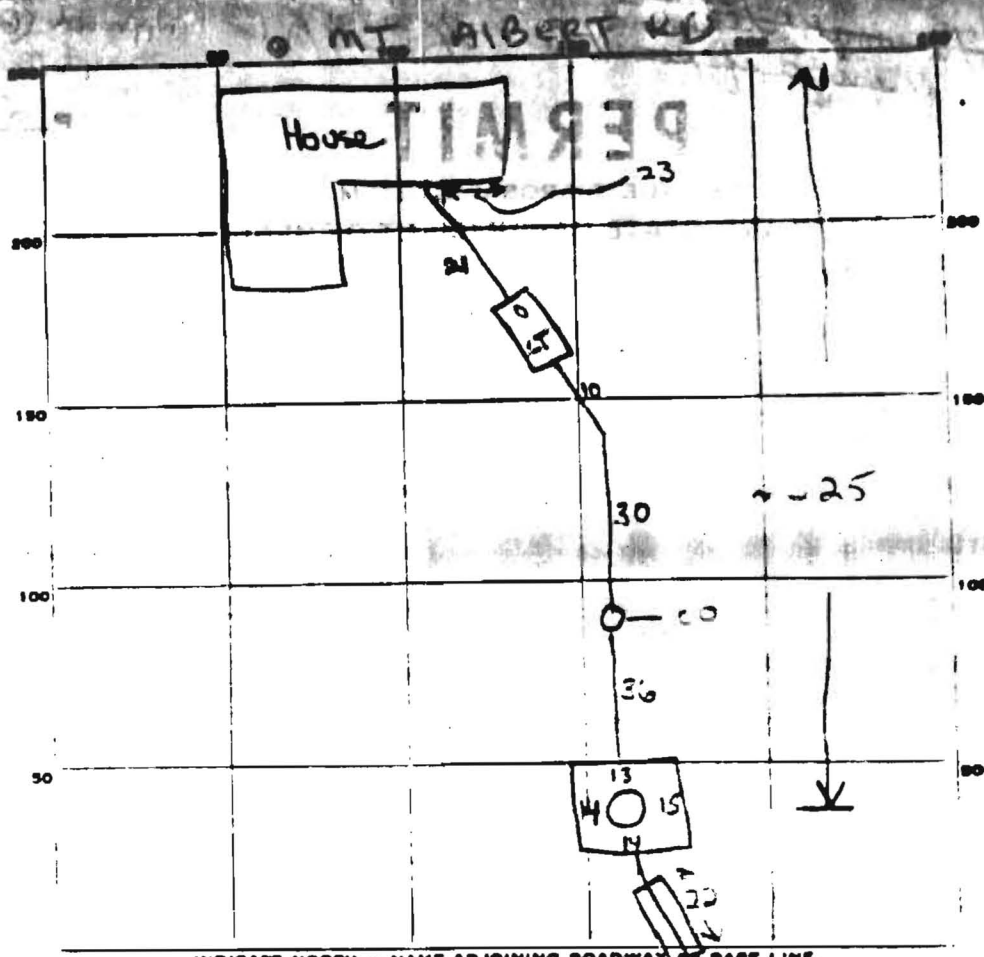

INDICATE NORTH - NAME ADJOINING ROADWAY AT BASE LINE.

PERMIT CARD 311 Electric permit ✓

SEPTIC TANK LEVEL 1250 ✓

DISTRIBUTION BOX LEVEL Na

TILE FIELD, DEPTH 12 FT. TRENCH WIDTH 2 FT.

GRAVEL DEPTH 7' IN. TOTAL LENGTH 22 FT.

NUMBER OF TRENCHES 1 TOTAL BOTTOM AREA $\frac{1}{2}sw \pm 154$

SEEPAGE PITS, INSIDE DIAMETER 56 FT. DEPTH BELOW INLET 7 FT. ± 392

ABSORBENT AREA ± 546 SQ. FT. ± 546

REMARKS
 21/79 - Stop work, so be want to put in pool where digger
 is to be located. Parc robot needed (\$100) and before robot
 information on pool. Contact Joe DM, GLK
 23 Sept 79 - OK to add gravel to trench. GLK (contact of DM per DM)
 28 Sept 79 - Dr. well inlet at 4 1/2. FINAL OK GLK

DATE SYSTEM APPROVED J. Kelle - 28 Sept 79 INSPECTOR

ST	DW	DW with
✓	✓	✓

cast in