

APPLICATION

PERCOLATION TESTING

FOR REPAIR

A REPAIR

P 519078-B

HOWARD COUNTY HEALTH DEPARTMENT
BUREAU OF ENVIRONMENTAL HEALTH
3525-H ELLICOTT MILLS DRIVE/ELLICOTT CITY, MARYLAND 21043
TELEPHONE: 313-2840

DISTRICT _____

DATE 8/8/03

TO: THE COUNTY HEALTH OFFICER
ELLICOTT CITY, MARYLAND

I HEREBY APPLY FOR THE NECESSARY TEST PRIOR TO APPLICATION FOR PERMIT TO CONSTRUCT (OR RECONSTRUCT) A SEWAGE DISPOSAL SYSTEM.

PROPERTY OWNER DAVIS, TERRY L & LINDA R

ADDRESS 10920 HARDY ROAD PHONE _____

AGENT OR PROSPECTIVE BUYER _____

ADDRESS _____ PHONE _____

PROPERTY LOCATION:
SUBDIVISION BRIDELWOOD LOT NO. 12

ROAD AND DESCRIPTION 1020 HARDY ROAD

TAX MAP 7 GRID 3 PARCEL # 337

SIZE OF LOT 1.374 A TYPE BLDG. SINGLE FAMILY
(SINGLE FAMILY DWELLING OR COMMERCIAL)

THE SYSTEM INSTALLED UNDER THIS APPLICATION IS ACCEPTABLE ONLY UNTIL PUBLIC FACILITIES BECOME AVAILABLE. I FULLY UNDERSTAND THE FEE CONNECTED WITH THE FILING OF THIS PERC TEST APPLICATION IS NON-REFUNDABLE UNDER ANY CIRCUMSTANCES. I ALSO AGREE TO COMPLY WITH ALL M.O.S.H.A. REQUIREMENTS IN TESTING THIS LOT. X
(SIGNATURE OF APPLICANT)

APPROVED BY _____ FOR _____ DATE _____

DISAPPROVED BY _____ FOR _____ DATE _____

HOLD PENDING FURTHER TESTS _____

REASONS FOR REJECTION OR HOLDING _____

PERCOLATION TEST PLAT/PRELIMINARY PLAT - TITLE OR I.D. # _____ DATE _____

SITE DEVELOPMENT PLAN/FINAL PLAT - TITLE OR I.D. # _____ DATE _____

THIS IS NOT A PERMIT

HARDY ROAD

COUNTY #

SOIL PROFILE

0' **A**
 DE BROWN LOAM 6"
 YELLOW BROWN SIL LOAM 15"
 Orange Brown SIL LOAM 3'
 Red Brown SIL LOAM 15-25%
 Cherty Micz Schist saprolite 13'

SOIL PROFILE

0'

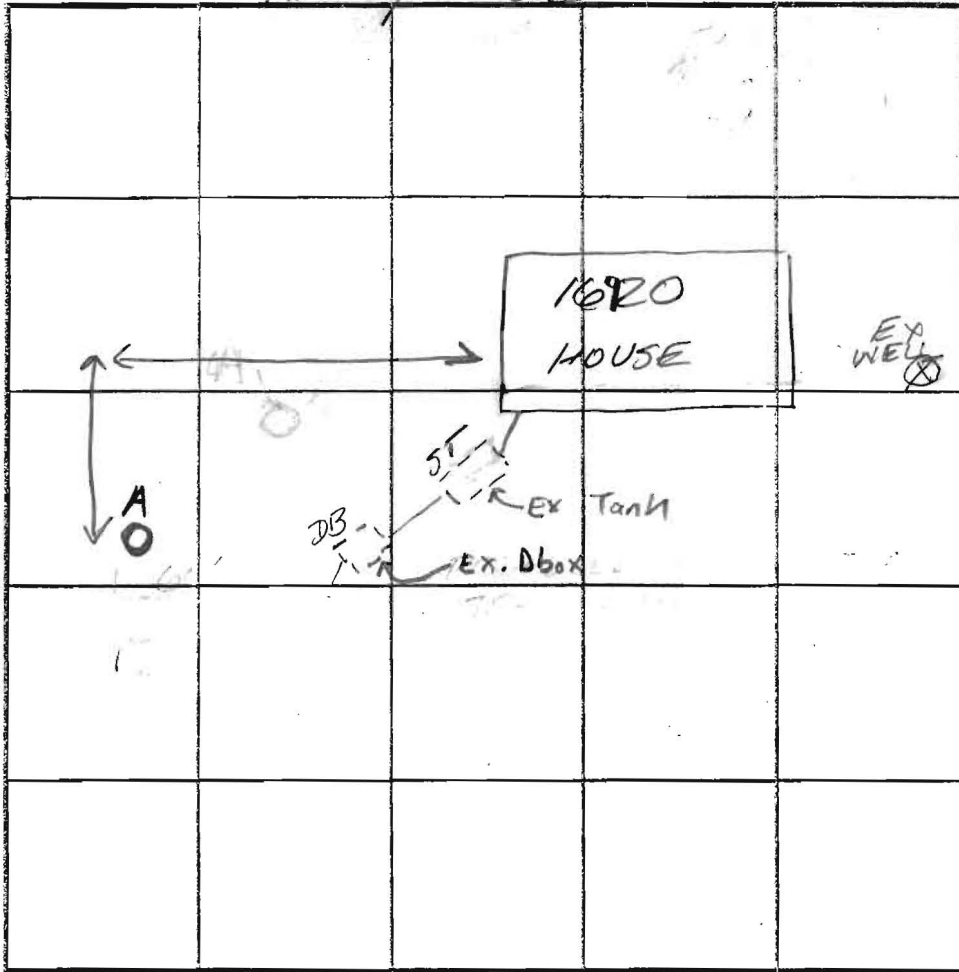

INDICATE NORTH - NAME ADJOINING ROADWAY AS BASE LINE.

DATE	TEST NO.	DEPTH	PRE-WET		TEST - 1" DROP		TIME
			START	STOP	START	STOP	
8/8/03	A	4 1/2' T 13'	11:26	11:28	11:28	11:34	6min

REMARKS _____
 TYPE OF SOIL En B2 - Elsenboro 3-8% Slope
 TESTED BY S. Kvicg / F. Alfonso ALSO PRESENT "SKIP" FROM F/OCK Robert Fyack
 TRENCH DESIGN DATA: AVERAGE PERCOLATION TIME 6' TRENCH WIDTH 3
 INLET DEPTH 3'-3 1/2' MAXIMUM BOTTOM DEPTH 5'-5 1/2' SQ FT/BEDROOM 180