

8/8/03 12:30 8/20/03 - 2PM

PUB. SEWER STATUS VERIFIED BY NA

ISSUE DATE: 8/8/03  
APPROVAL DATE: 8/20/03

# PERMIT INDEXED

P 519078-A  
A REPAIR

## ON-SITE SEWAGE DISPOSAL SYSTEM HOWARD COUNTY HEALTH DEPARTMENT BUREAU OF ENVIRONMENTAL HEALTH

03-286762

Jack Fyock Septic Service IS PERMITTED TO INSTALL  ALTER

ADDRESS: PO Box 89, Glenelg, MD 21737 PHONE NUMBER: 410-988-9270

SUBDIVISION: Green Henge LOT NUMBER: 8, Bl A, S 2

ADDRESS: 2918 Evergreen Way PROPERTY OWNER: Terrence Burkhead

SEPTIC TANK CAPACITY (GALLONS): Ex 1000

PUMP CHAMBER CAPACITY (GALLONS): N/A

NUMBER OF BEDROOMS: 4

SQUARE FEET PER BEDROOM: 180

LINEAR FEET OF TRENCH REQUIRED: 97

TRENCHES:	Trench to be <u>2</u> feet wide. Inlet <u>3</u> feet below original grade. Bottom maximum depth <u>9</u> feet below original grade. Effective area begins at <u>3</u> feet below original grade. <u>6</u> feet of stone below distribution pipe.
LOCATION:	<u>10' CTC</u>
PURPOSE:	Septic system has failed. Call for inspection when the ground is opened so sanitarian can recommend repair.

PLANS APPROVED: Stuart Oster DATE: 8/20/03

- NOTE: PERMIT VOID AFTER 2 YEARS
- NOTE: CONTRACTOR RESPONSIBLE FOR SCHEDULING A PRE-CONSTRUCTION INSPECTION FOR ALL INSTALLATIONS
- NOTE: WATERTIGHT SEPTIC TANKS REQUIRED
- NOTE: ALL PARTS OF SEPTIC SYSTEM SHALL BE 100 FEET FROM ANY WATER WELL
- NOTE: MANHOLE RISERS REQUIRED ON ALL SEPTIC TANKS AND PUMP CHAMBERS

**NEITHER THE HOWARD COUNTY COUNCIL NOR THE HEALTH DEPARTMENT IS RESPONSIBLE FOR THE SUCCESSFUL OPERATION OF ANY SYSTEM PERMITTEE RESPONSIBLE FOR OBTAINING FINAL APPROVAL ON THIS PERMIT CALL 410-313-2640 FOR INSPECTION OF SEPTIC SYSTEM**

P519078A

NOT TO SCALE

INDEXED

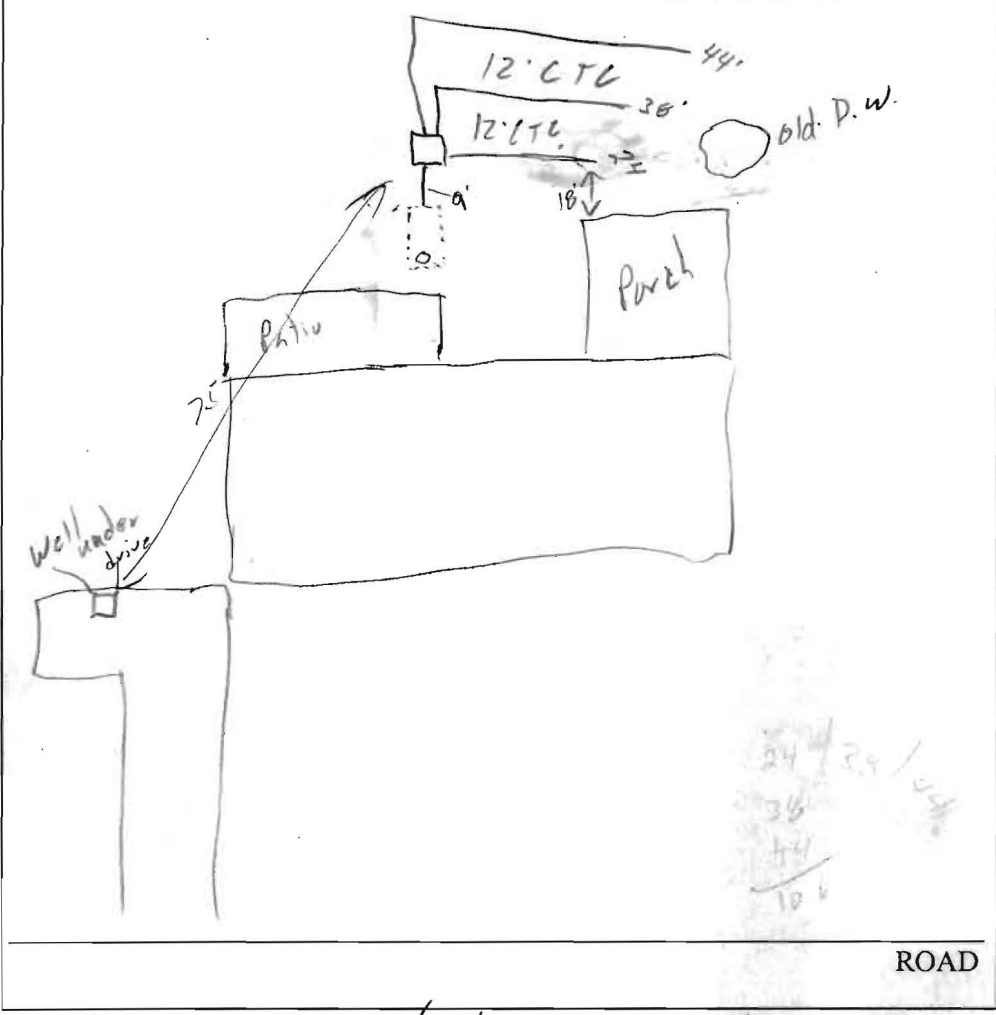

TRENCH/DRAINFIELD DATA		
WIDTH	INLET	BOTTOM
2	3	9
NUMBER OF TRENCHES		3
TOTAL LENGTH		106'
ABSORPTION AREA		6364
DISTRIBUTION BOX LEVEL		<input checked="" type="checkbox"/>
DISTRIBUTION BOX BAFFLE		<input checked="" type="checkbox"/>
DISTRIBUTION BOX PORT		<input checked="" type="checkbox"/>

SEPTIC TANK DATA	
SEPTIC TANK 1 LEVEL	
CAPACITY	Ex 1600 GAL
SEAM LOC	
TANK LID DEPTH	1'
BAFFLES	
BAFFLE FILTER	
MANHOLE LOC	
6" PORT LOC	
WATERTIGHT TEST	
SEPTIC TANK 2 LEVEL	
CAPACITY	GAL
SEAM LOC	
TANK LID DEPTH	
BAFFLES	
BAFFLE FILTER	
MANHOLE LOC	
6" PORT LOC	
WATERTIGHT TEST	

PRE-CONSTRUCTION 8/8/03 Install per specs on front

INSTALLATION 8/20/03 - OK to cover all work

FINAL INSPECTOR [Signature] DATE OF APPROVAL 8/20/03