

PERMIT

SEWAGE DISPOSAL SYSTEM

MARYLAND STATE DEPARTMENT OF HEALTH

HOWARD COUNTY

ELLICOTT CITY

DISTRICT 4th

DATE 1/4/78

INDEX

3/30/78
a.m.

27291
A 17296

Lee Pickett

IS PERMITTED TO INSTALL X A

ADDRESS Mt. Airy, Maryland

PHONE 620-0843

SUBDIVISION MURSEY VIEW

ROAD OFF HAGERSTOWN RD LOT 9, SEC. 3

PROPERTY OWNER Donald Moser

ADDRESS Box 71, Hagerstown, Md. 21770

SPECIFICATIONS 4 bedrooms

SEPTIC TANK CAPACITY 1250 GALLONS

DRAIN FIELD DEPTH 98 FT. BOTTOM AREA 80 FT.

TWO (2) DEEP TRENCH 10 DEPTH 8 FT. BOTTOM AREA 80 FT. each 75 ft. long, 3 ft. wide, 5 ft. of stone.

SEEPAGE PITS ABSORBENT SIDE WALL AREA 80 FT.

INLET PIPE FT. BELOW ORIGINAL GRADE. MAXIMUM DEPTH 10 FT. BELOW ORIGINAL GRADE

EFFECTIVE DEPTH AT FT. BELOW ORIGINAL GRADE

LOCATE DISPOSAL AREA 565 FT. FROM FOOT LOT LINE AND 180 FT. FROM RIGHT LOT LINE AS SEEN WHEN FACING LOT FROM

Trench must follow contour of land and be 10 ft. apart edge to edge. Begin trench 185 ft. from rear lot line (308 ft. line) and 150 ft. from right side (331 ft. lot line). Second trench to begin about 185 ft. from rear lot line.

BR 33338
P-77

PLANE APPROVED BY Donald W. Monaghan

DATE 9/15/77

COVER NO WORK UNTIL INSPECTED AND APPROVED

NEITHER THE HOWARD COUNTY COUNCIL NOR THE HEALTH DEPARTMENT IS RESPONSIBLE FOR THE SUCCESSFUL OPERATION OF ANY SYSTEM.

NOTE IF TRENCH IS USED CALL FOR INSPECTION BEFORE PLACING GRAVEL IN TRENCH.

NOTE NO DRY WELL SHALL EXCEED 18 FOOT IN DIAMETER.

NOTE ALL PIPE FROM HOUSE TO DISPOSAL AREA MUST BE CAST IRON.

PERMIT VOID AFTER THREE YEARS.

NOTE INSTALL STAND PIPE ON SEPTIC TANK AND DRY WELL STAND PIPES MUST BE 8 INCHES IN DIAMETER. CAST IRON, CONCRETE OR TERRAZO ACCEPTED.

*INSTALLER IS RESPONSIBLE FOR OBTAINING FINAL APPROVAL ON THIS PERMIT.

17296

STREETS

PLANS

PERMIT

PLEASE BE CAREFUL SYSTEM

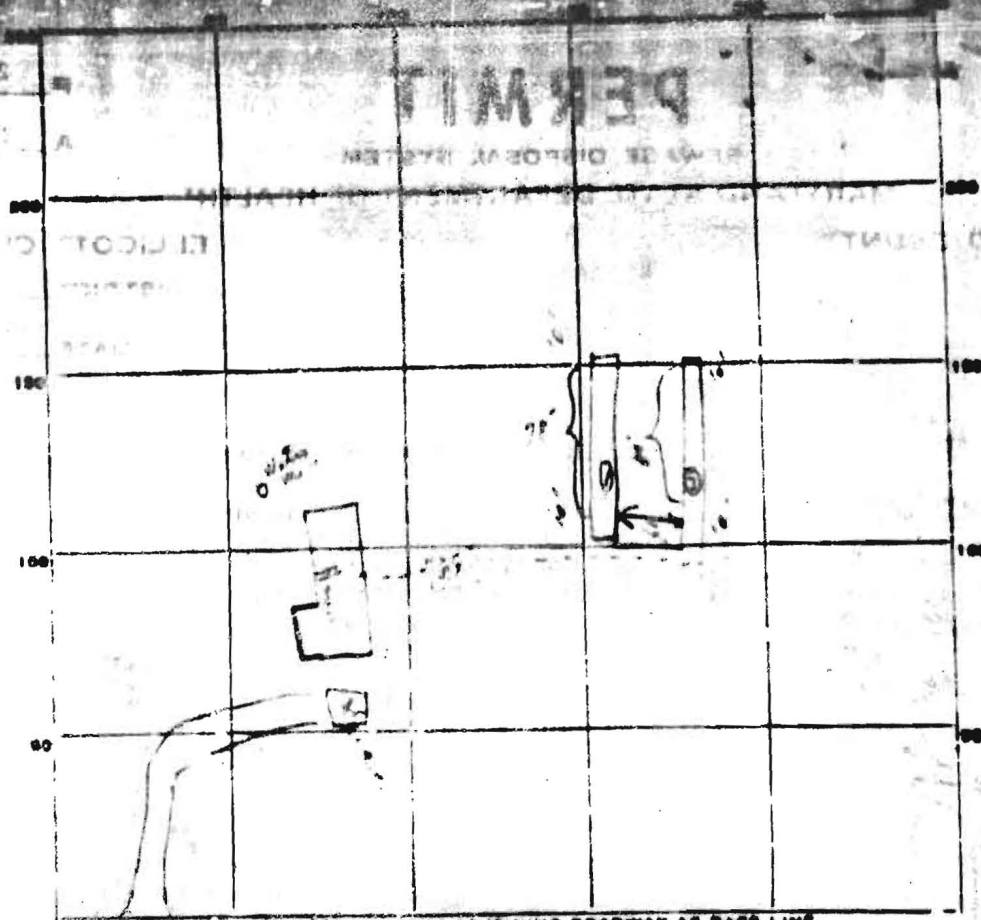

INDICATE NORTH - NAME ADJOINING ROADWAY AS BASE LINE.

PERMIT CARD _____

SEPTIC TANK, LEVEL _____

DISTRIBUTION BOX, LEVEL _____

TILE FIELD, DEPTH 10 FT. TRENCH WIDTH 1 FT.

GRAVEL DEPTH 2 IN. TOTAL LENGTH 10 FT.

NUMBER OF TRENCHES 2 TOTAL BOTTOM AREA _____

SEEPAGE PITS, INSIDE DIAMETER _____ FT. DEPTH BELOW INLET _____ FT.

ABSORBENT AREA _____ SQ. FT.

REMARKS

3/30/25 (2) Trenches (10' x 1') (1' x 1') (1' x 1')
1/3/27
after emergency

DATE SYSTEM APPROVED _____

INSPECTOR _____

PERMIT

SEWER DISPOSAL SYSTEM

COUNTY _____
 DISTRICT _____
 CITY _____
 STATE _____

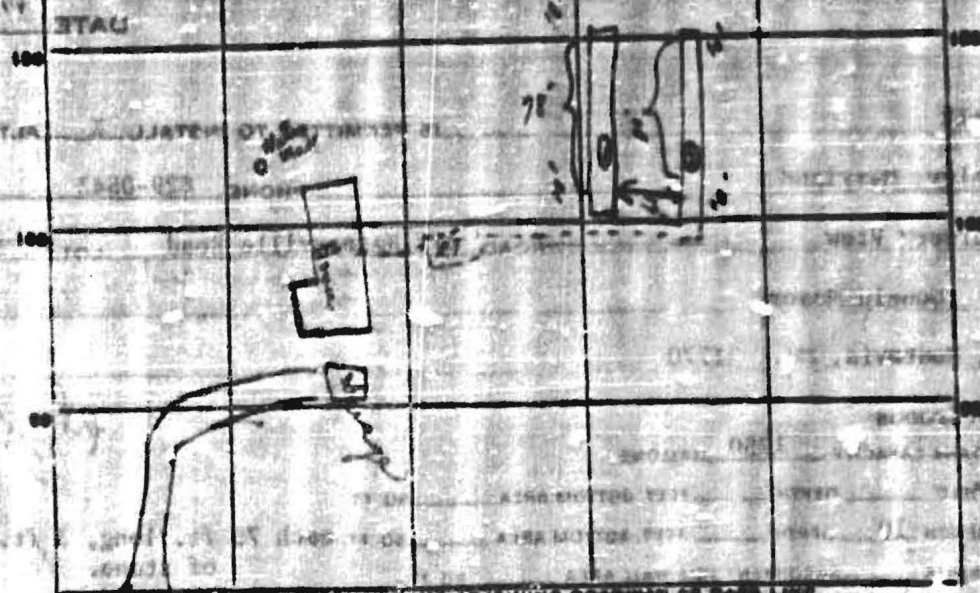

INDICATE NORTH - NAME ADJOINING ROAD OR ST. BELOW LINE.

PERMIT CARD _____
 SEPTIC TANK, LEVEL _____
 DISTRIBUTION BOX, LEVEL _____
 TILE FIELD, DEPTH 10 FT. TRENCH WIDTH 2 FT.
 GRAVEL DEPTH 0 IN. TOTAL LENGTH 70 FT.
 NUMBER OF TRENCHES 2 TOTAL BOTTOM AREA _____
 SEEPAGE PITS, INSIDE DIAMETER _____ FT. DEPTH BELOW INLET _____ FT.

ABSORBENT AREA _____ SQ. FT.

REMARKS Part 1 7/30/78 (2 Trenches approved only) rest of system
not in bill 1/3/79 system in ground
letter of no opinion with supervisor 1/11/79

INSTALLER IS RESPONSIBLE FOR OBTAINING FINAL APPROVAL ON THIS PERMIT

DATE SYSTEM APPROVED _____ INSPECTOR _____

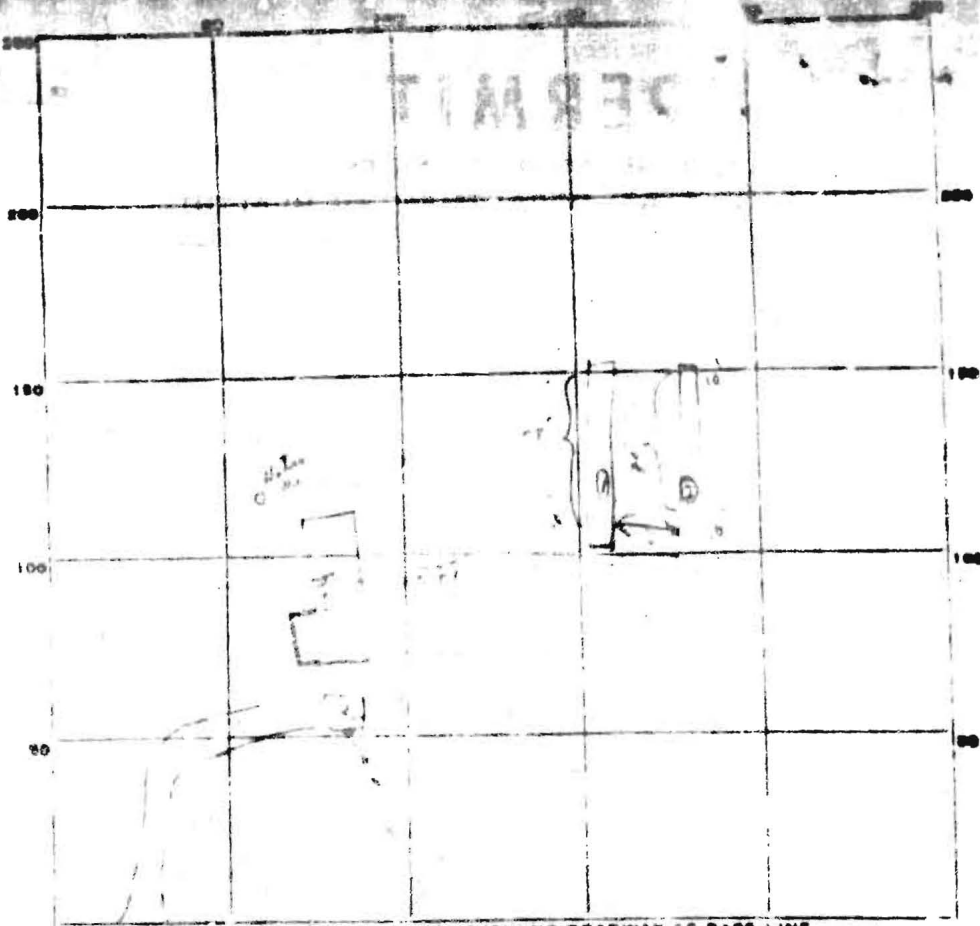

INDICATE NORTH - NAME ADJOINING ROADWAY AS BASE LINE

PERMIT CARD _____

SEPTIC TANK, LEVEL _____

CLEANOUTS _____

DISTRIBUTION BOX, LEVEL _____

TILE FIELD, DEPTH 10 FT. TRENCH WIDTH 1 FT.

GRAVEL DEPTH 1 IN. TOTAL LENGTH 20 FT.

NUMBER OF TRENCHES 2 TOTAL BOTTOM AREA _____

SEEPAGE PITS, INSIDE DIAMETER _____ FT. DEPTH BELOW INLET _____ FT.

ABSORBENT AREA 30 FT.

REMARKS _____

DATE SYSTEM APPROVED _____

INSPECTOR _____