

# APPLICATION

A 09298

P \_\_\_\_\_

SEWAGE DISPOSAL TESTING

MARYLAND STATE DEPARTMENT OF HEALTH

HOWARD COUNTY 750 gal for 3 bedrooms

ELLICOTT CITY

Septic tank - 1000 " " 4 " "  
1,500 " " 5 " "

DISTRICT 5

DATE 10/27/64

Drywell - 100 sq. ft. absorbent sidewalk  
area per bedroom.  
For each drywell 125 ft. from the point where the  
back lot flag and right side line meet and 75 ft.  
from the back lot line as set in plan when  
surveyed from Blount's fence.

TO: THE COUNTY HEALTH OFFICER  
ELLICOTT CITY, MARYLAND

I, HEREBY, APPLY FOR THE NECESSARY TESTS IN ORDER TO CONSTRUCT (OR RECONSTRUCT) A SEWAGE DISPOSAL SYSTEM.

PROPERTY OWNER Anne K. Gray & Susie Kondrup

ADDRESS 5132 Loughboro Rd., Washington 16, D. C. PHONE 363-5335

PROPERTY LOCATION:

SUBDIVISION Beaufort Park LOT NO. 5, Blk. G

ROAD AND DESCRIPTION Blount's <sup>line</sup> fence

OCCUPANT \_\_\_\_\_ PHONE \_\_\_\_\_

PERSON TO CONSTRUCT SYSTEM \_\_\_\_\_

ADDRESS \_\_\_\_\_ PHONE \_\_\_\_\_

SIZE OF LOT 42,448 sq. ft. TYPE BLDG. test per bedroom <sup>X5</sup>  
NUMBER OF BEDROOMS

IF NOT SINGLE RESIDENCE DESCRIBE \_\_\_\_\_

SIGNATURE OF APPLICANT /s/ Gray & Kondrup

APPROVED BY R.D. [Signature] FOR Drywell DATE 11/8/65  
(KIND OF SYSTEM)

REJECTED BY \_\_\_\_\_ FOR \_\_\_\_\_ DATE \_\_\_\_\_  
(KIND OF SYSTEM)

HOLD PENDING FURTHER TESTS \_\_\_\_\_ DATE \_\_\_\_\_

REASONS FOR REJECTION OR HOLDING \_\_\_\_\_

# THIS IS NOT A PERMIT

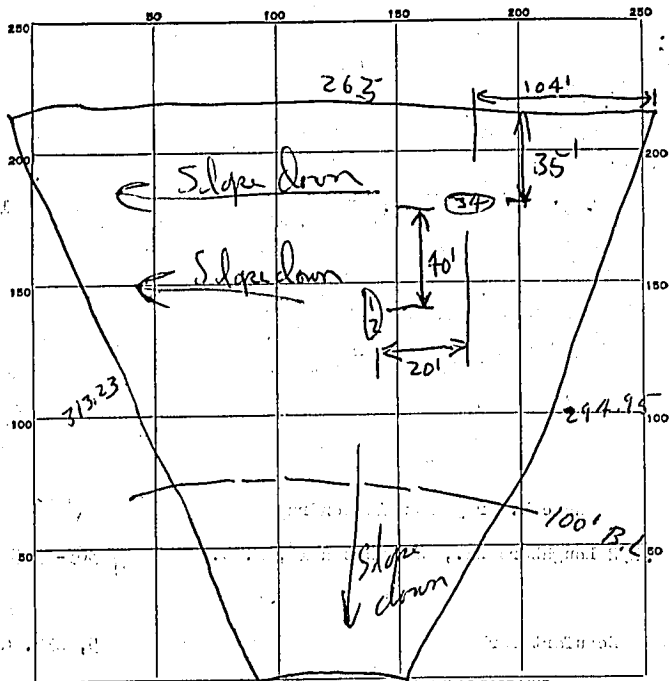

INDICATE NORTH. - NAME ADJOINING ROADWAY AS BASE LINE.

58  
46  
104

*38.2*  
*B. L. Lane*

DATE	TEST NO.	DEPTH	PRE-WET		TEST - 1" DROP		TIME
			START	STOP	START	STOP	
10/28/64	1	8 ft.	400	402	402	409	5 min.
	2	4 ft.	400	403	403	407	4 min.
	3	9 ft.	412	413	413	416	3 min.
	4	4 ft.	412	415	415	420	5 min.

SOIL AUGER FINDING \_\_\_\_\_

TESTED BY *RDF 10/28/64*

REMARKS \_\_\_\_\_

ALSO PRESENT *J. E. [Signature]*

LOT NO. *56*

# APPLICATION

A 09297

SEWAGE DISPOSAL TESTING

P \_\_\_\_\_

MARYLAND STATE DEPARTMENT OF HEALTH

HOWARD COUNTY

ELLICOTT CITY

# BEDROOMS	SIZE TANK	SIZE TILE FIELD	DISTRICT
2	750 gal	300 sqft bottom area	5
3	750 gal	300 sqft bottom area	
4	1000 gal	400 sqft bottom area	

DATE 10/27/64

*Same people bought 59*

Place the tile field 20 ft to 70 ft from the back lot line which is 254 ft long and 80 ft to 140 ft from the right side line as you face the lot from Blount's Lane

TO: THE COUNTY HEALTH OFFICER  
ELLICOTT CITY, MARYLAND

I, HEREBY, APPLY FOR THE NECESSARY TESTS IN ORDER TO CONSTRUCT (OR RECONSTRUCT) A SEWAGE DISPOSAL SYSTEM.

PROPERTY OWNER Anne K. Gray & Susie Kondrup

ADDRESS 5132 Loughboro Rd., Washington 16, D. C. PHONE 363-5335

PROPERTY LOCATION:

SUBDIVISION Beaufort Park LOT NO. 4, Blk. G

ROAD AND DESCRIPTION Blount's Lane

OCCUPANT \_\_\_\_\_ PHONE \_\_\_\_\_

PERSON TO CONSTRUCT SYSTEM \_\_\_\_\_

ADDRESS \_\_\_\_\_ PHONE \_\_\_\_\_

SIZE OF LOT 46,444 sq. ft. TYPE BLDG. test per bedroom  
NUMBER OF BEDROOMS \_\_\_\_\_

IF NOT SINGLE RESIDENCE DESCRIBE \_\_\_\_\_

SIGNATURE OF APPLICANT /s/ Gray & Kondrup

APPROVED BY [Signature] FOR Tiled Field DATE 1/20/65  
(KIND OF SYSTEM)

REJECTED BY \_\_\_\_\_ FOR \_\_\_\_\_ DATE \_\_\_\_\_  
(KIND OF SYSTEM)

HOLD PENDING FURTHER TESTS 220d64 711 DATE \_\_\_\_\_

REASONS FOR REJECTION OR HOLDING 220d64 - Tank located outside of city limits

country 1/20/65 - Tank placed in a place outside of city limits

## THIS IS NOT A PERMIT

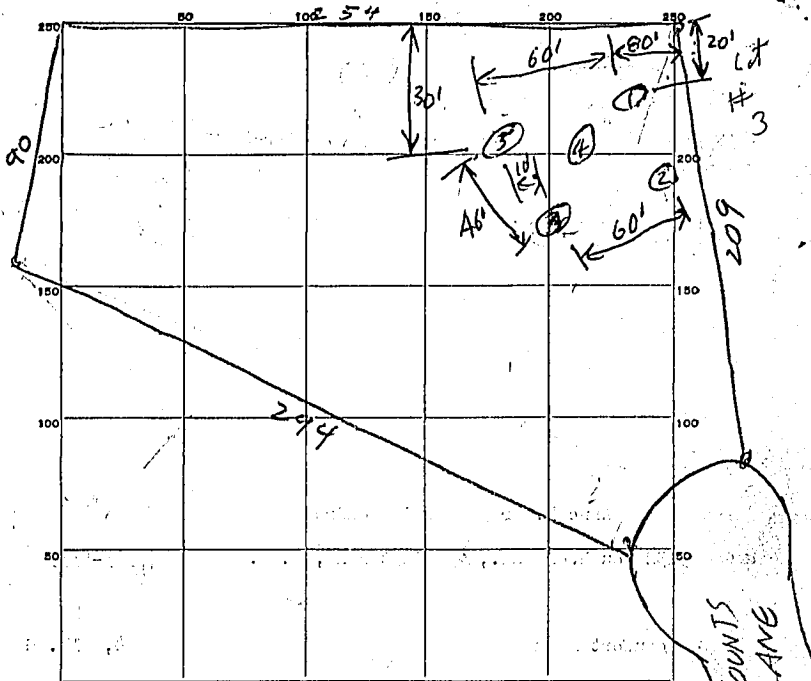

INDICATE NORTH. - NAME ADJOINING ROADWAY AS BASE LINE.

DATE	TEST NO.	DEPTH	PRE-WET		TEST - 1" DROP		TIME
			START	STOP	START	STOP	
10/24	1	3	312	313	313	315	2
"	2	3	313	314	314	317	3
"	3	3	316	317	317	318	1
"	4	9	NO WATER		ALL MICROBES		NO
	5	not test - same type soil					

SOIL AUGER FINDING \_\_\_\_\_

TESTED BY Raymond Hodge

REMARKS \_\_\_\_\_

ALSO PRESENT \_\_\_\_\_

LOT NO. 46