

PERMIT

SEWAGE DISPOSAL SYSTEM

MARYLAND STATE DEPARTMENT OF HEALTH

HOWARD COUNTY

7/11/74
P. 27212 C. 181
A. 18339

ELLCOTT CITY

DISTRICT 1st

DATE 12/12/77

INDEXED

Via Engineering

John P. [unclear]

IS PERMITTED TO INSTALL X ALTER

ADDRESS ELLCOTT CITY, MD.

PHONE

SUBDIVISION Greenwood Estates

ROAD Greenwood Road

LOT 7, Blk. B, Sub. I

PROPERTY OWNER W. J. [unclear] Dobrzy Kowski, Edward D.

ADDRESS

SPECIFICATIONS 4 bedrooms

SEPTIC TANK CAPACITY 1380 GALLONS

DRAIN FIELD _____ DEPTH _____ FEET. BOTTOM AREA _____ SQ. FT.

DEEP TRENCH _____ DEPTH _____ FEET. BOTTOM AREA _____ SQ. FT.

GEEPAGE PITS _____ ABSORBENT SIDE WALL AREA 860 SQ. FT.

INLET PIPE 5 FT. BELOW ORIGINAL GRADE MAXIMUM DEPTH 11 FT. BELOW ORIGINAL GRADE

EFFECTIVE DEPTH AT _____ FT. BELOW ORIGINAL GRADE.

LOCATE DISPOSAL AREA 138 FT. FROM REAR LOT LINE AND 20 FT. FROM RIGHT LOT LINE AS SHOWN WHEN FACING LOT FROM ROAD.

PLANS APPROVED BY Robert V. Korte

DATE 2/9/74

COVER NO WORK UNTIL INSPECTED AND APPROVED

NEITHER THE HOWARD COUNTY COUNCIL NOR THE HEALTH DEPARTMENT IS RESPONSIBLE FOR THE SUCCESSFUL OPERATION OF ANY SYSTEM

NOTE IF TRENCH IS USED CALL FOR INSPECTION BEFORE PLACING GRAVEL IN TRENCH.

NOTE NO DRY WELL SHALL EXCEED 16 FOOT IN DIAMETER

NOTE ALL PIPE FROM HOUSE TO DISPOSAL AREA MUST BE CAST IRON.

PERMIT VOID AFTER THREE YEARS

NOTE INSTALL STAND PIPE ON SEPTIC TANK AND DRY WELL. STAND PIPES MUST BE 6 INCHES IN DIAMETER. CAST IRON, CONCRETE OR TERRAZO ACCEPTED

***INSTALLER IS RESPONSIBLE FOR OBTAINING FINAL APPROVAL ON THIS PERMIT.**

NO. 23

EMG. PERMIT SIGNED AND RETURNED

[Handwritten signature]
[Handwritten number]
[Handwritten note]

18339

PERMIT

SEWERAGE DEPARTMENT

ELLCOTT CITY DISTRICT

100

100

80

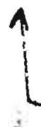

INDICATE NORTH - NAME ADJOINING ROADWAY AS BASE LINE

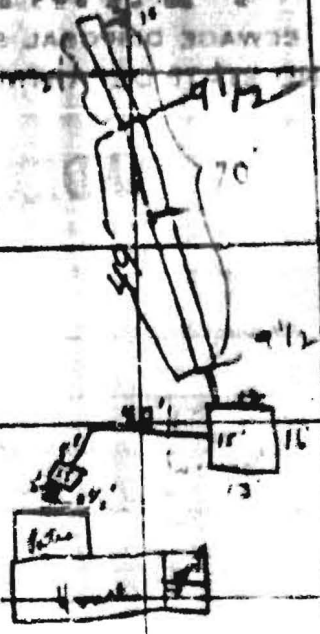

Thomas Kelly St

PERMIT CARD

SEPTIC TANK, LEVEL

CLEANOUTS

DISTRIBUTION BOX, LEVEL

N/A

TILE FIELD, DEPTH 9 1/2 FT. TRENCH WIDTH 12 FT.

GRAVEL DEPTH 6 IN. TOTAL LENGTH 70 FT.

720

NUMBER OF TRENCHES 1 TOTAL BOTTOM AREA 840

SEEPAGE PITS, INSIDE DIAMETER 5' FT. DEPTH BELOW INLET 9 FT.

count only 336

ABSORBENT AREA 7.6 SQ. FT.

REMARKS 4/12/78 - Trench to be lengthened to 70 ft. call for copy when done O.K. &

ground first 50 ft of trench - done 4/17/78 Trench extended to

4/22/78 ground 4/17/78 topsoil on trench, clean up pits

5' feet 49' to 4' feet 21' done

SEWERAGE SYSTEM APPROVED

4/19/78

INSPECTOR

C. B. [Signature]

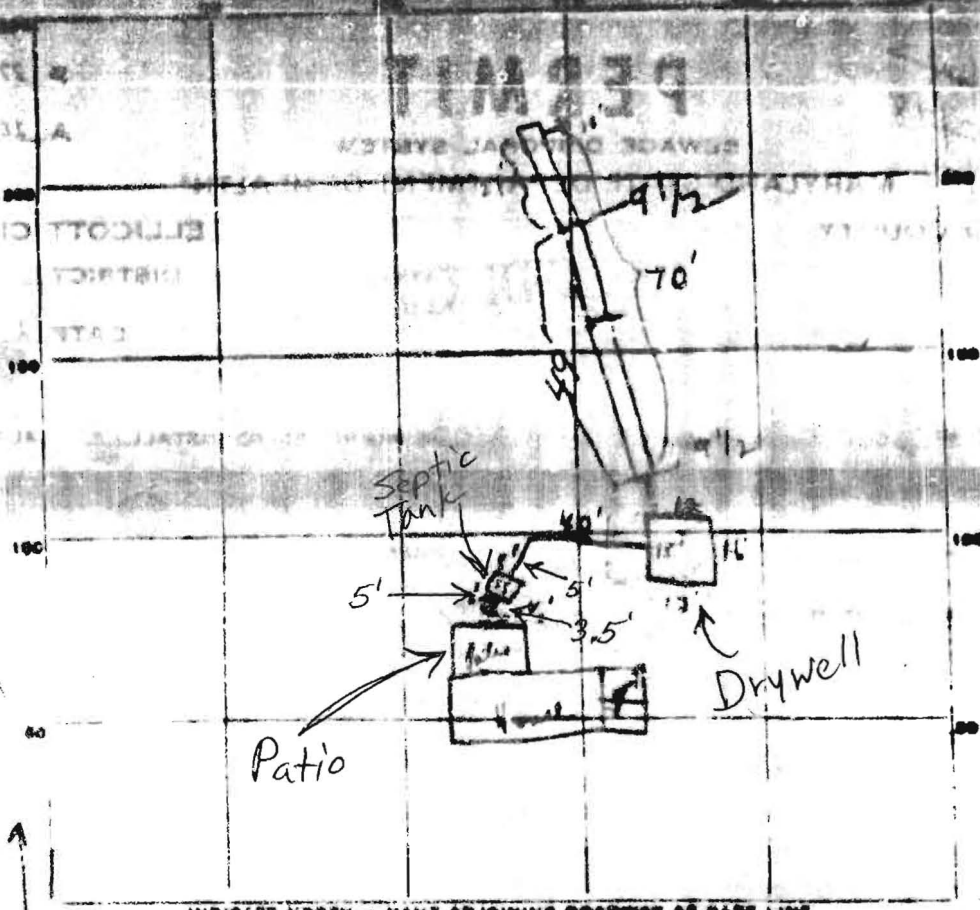

INDICATE NORTH - MAKE ADJOINING ROADWAY AS BASE LINE

PERMIT CARD _____

SEPTIC TANK, LEVEL _____ CLEANOUTS _____

DISTRIBUTION BOX, LEVEL _____

TILE FIELD, DEPTH 4 1/2 FT. TRENCH WIDTH _____ FT.

GRAVEL DEPTH 6 IN. TOTAL LENGTH 70' FT. 120

NUMBER OF TRENCHES 1 TOTAL BOTTOM AREA _____

SEEPAGE PITS, INSIDE DIAMETER 5 1/2 FT. DEPTH BELOW INLET 9 FT. 336

ABSORBENT AREA 7 1/2 SQ. FT.

REMARKS 4-12-78 - Trench to be lengthened to 70 ft - call for copy when done O.K. & ground first 50 ft of trench - sum 4 1/2 in trench extended to 70 ft and 4 1/2 in top in trench, in sand's report

DATE SYSTEM APPROVED 4/12/78 INSPECTOR C. K. [Signature]