

7/18/03 - 10AM

9/16/03 3pm

PUB. SEWER STATUS VERIFIED BY SRK NA

ISSUE DATE: 7/14/2003

P 519050

APPROVAL DATE: 9/16/03

PERMIT INDEXED

A REPAIR

ON-SITE SEWAGE DISPOSAL SYSTEM HOWARD COUNTY HEALTH DEPARTMENT BUREAU OF ENVIRONMENTAL HEALTH

Whitworth Excavating, Inc. 05-389054 IS PERMITTED TO INSTALL ALTER

ADDRESS: 12680 Clarksville Pike PHONE NUMBER: (410) 531-5033

SUBDIVISION: Broadwater Estates LOT NUMBER: 2

ADDRESS: 5673 Chamblis Drive PROPERTY OWNER: _____

SEPTIC TANK CAPACITY (GALLONS): ex 2000

PUMP CHAMBER CAPACITY (GALLONS): NA

NUMBER OF BEDROOMS: 6

SQUARE FEET PER BEDROOM: _____

LINEAR FEET OF TRENCH REQUIRED: 100'

TRENCHES:	Trench to be 2' feet wide. Inlet <u>6'</u> feet below original grade. Bottom maximum depth <u>12'</u> feet below original grade. Effective area begins at <u>6'</u> feet below original grade. <u>6'</u> feet of stone below distribution pipe.
LOCATION:	<u>2' of fill on area at beginning of trench. Will be less further down trench. Keep bottom #</u>
PURPOSE:	In support of a building permit addition. Call for inspection when the ground is opened so sanitarian can recommend repair.

PLANS APPROVED: [Signature] DATE: 7/19/03

NOTE: PERMIT VOID AFTER 2 YEARS

NOTE: CONTRACTOR RESPONSIBLE FOR SCHEDULING A PRE-CONSTRUCTION INSPECTION FOR ALL INSTALLATIONS

NOTE: WATERTIGHT SEPTIC TANKS REQUIRED

NOTE: ALL PARTS OF SEPTIC SYSTEM SHALL BE 100 FEET FROM ANY WATER WELL 7/18/2003 B00142816 POOL HOUSE & GARAGE

NOTE: MANHOLE RISERS REQUIRED ON ALL SEPTIC TANKS AND PUMP CHAMBERS 7/17/2003 B00143065 INGROUND POOL

9/16/2003 B00144000 LP TANK

BUILDING PERMIT SIGNED AND RETURNED

NEITHER THE HOWARD COUNTY COUNCIL NOR THE HEALTH DEPARTMENT IS RESPONSIBLE FOR THE SUCCESSFUL OPERATION OF ANY SYSTEM PERMITTEE RESPONSIBLE FOR OBTAINING FINAL APPROVAL ON THIS PERMIT CALL 410-313-2640 FOR INSPECTION OF SEPTIC SYSTEM

*invert level. Install/replace outlet baffle on S.T.
Use speed levelers in P.B.*

PS19050

HO. 04-3707

NOT TO SCALE

- 1.5' F. 11
- 3' Brown S. CLM
- Orange B. man
- Sand & L. man
- 8' Purple/white Tan
- 15.5' CI L. man

5' Start 11:05
 6' 11:21
 7' 11:38 / 12:40 / 27'

2nd pulled peg
 3rd pulled peg
 no movement
 Added

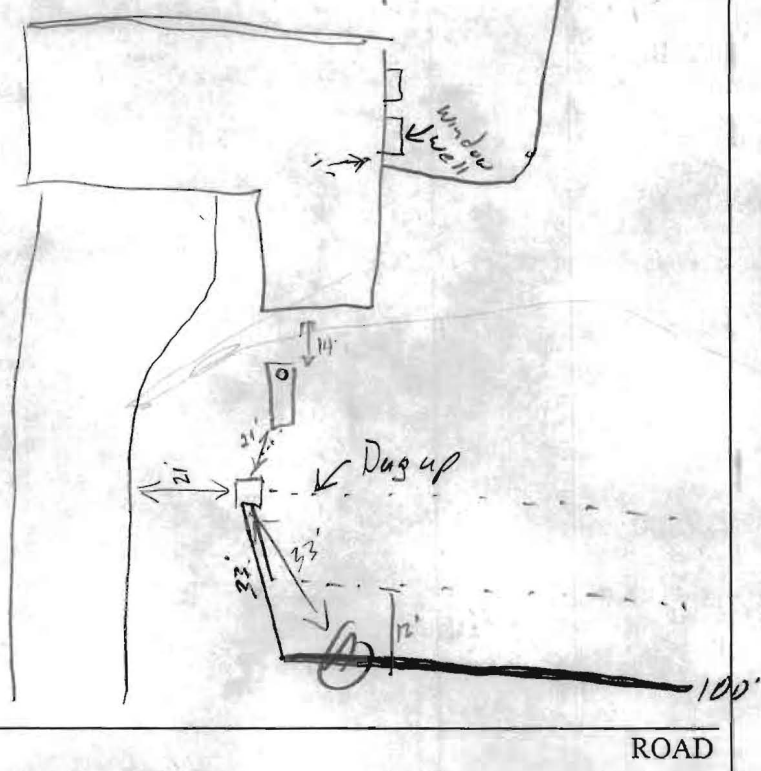

TRENCH/DRAINFIELD DATA		
WIDTH	INLET	BOTTOM
2'	6'	12'
NUMBER OF TRENCHES		1
TOTAL LENGTH		100'
ABSORPTION AREA		600#
DISTRIBUTION BOX LEVEL		<input checked="" type="checkbox"/>
DISTRIBUTION BOX BAFFLE		<input checked="" type="checkbox"/>
DISTRIBUTION BOX PORT		<input type="checkbox"/>

SEPTIC TANK DATA	
SEPTIC TANK 1 LEVEL	
CAPACITY	Ex 2000 GAL
SEAM LOC	
TANK LID DEPTH	
BAFFLES	
BAFFLE FILTER	
MANHOLE LOC	
6" PORT LOC	
WATERTIGHT TEST	
SEPTIC TANK 2 LEVEL	
CAPACITY	GAL
SEAM LOC	
TANK LID DEPTH	
BAFFLES	
BAFFLE FILTER	
MANHOLE LOC	
6" PORT LOC	
WATERTIGHT TEST	

PRE-CONSTRUCTION 7/10/03 Dug up 1st trench. Trench was dry 1' down. Install (1) 100' trench to specs on 10/10/03

INSTALLATION 9/16/03 - Trench installed OK to cover 50

BUILDING PERMIT SIGNED AND RETURNED

FINAL INSPECTOR [Signature] DATE OF APPROVAL 9/16/03

Read Me	Help Me	Map Reset	Zoom Fit	Find Location	Remove Pin	Layer Control	Image Control	Theme Map	Local Print	Plot Request	Email Map	Map Exit

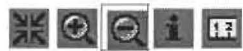

Distance: ft

Zoom: ft



6-10-03 ADJ LOTS - SEPTIC IN FRONT YARDS. TOPO 544
 WELLS AT HIGH ELEV. LEVEL - Well permit approved (KN)

Disclaimer: Howard County, Maryland assumes no responsibility for the accuracy of this map or the information contained herein or derived therefrom. The buyer and/or user assumes all risks and liabilities whatsoever resulting from or arising out of the use of this map. There are no oral agreements or warranties relating to this sale and/or use of this map.

Tuesday, June 10 2003 | 2:05:53 PM | @795

Map Legends

State Route	US Route	Interstate Route	County Line	Property Line
Contour Lines	400 Contour Label	Spot Elev.		

Contacts: John Bussiere (x3044) Virginia Peterman (x3659) Yut Phasukyued (x3093) Robert Slivinsky (x3094)