

4/20/73

71 6-26-73
du

PERMIT

SEWAGE DISPOSAL SYSTEM

18600
A 18716

MARYLAND STATE DEPARTMENT OF HEALTH

HOWARD COUNTY

ELLICOTT CITY

INDEXED

DISTRICT 3rd

DATE 6/21/73

Jack Fyock

IS PERMITTED TO INSTALL ALTER

ADDRESS Tom Oaks Road, Glenelg, Maryland PHONE 286-2939

A SEWAGE DISPOSAL SYSTEM LOCATED AT _____

SUBDIVISION Woodmark ROAD Benson Branch Road LOT 47, Blk. B, E

PROPERTY OWNER Mark A. Wakefield, Jr. Rebecca & Steven Gershtman

ADDRESS Mt. Albert Road, Ellicott City, Maryland 21043

SPECIFICATIONS 3 bedrooms

DRAIN FIELD _____ DEPTH _____ FEET, BOTTOM AREA _____ SQ. FT.

SEEPAGE PITS _____ ABSORBENT SIDE-WALL AREA _____ SQ. FT.

SEPTIC TANK CAPACITY 1000 GALLONS

FOR GARBAGE GRINDER, INCREASE DISPOSAL AREA 22% & TANK CAPACITY 50%.

OTHER DRY WELL - 300 sq. ft. sidewall area below the inlet with the inlet no deeper than 4 ft. and the dry well no deeper than 10 ft. Place the dry well 50 ft. from the front lot line and 75 ft. from the right side of the lot as seen when facing the lot from Benson Branch Road.

NOTE: ALL PIPE FROM HOUSE TO DRY WELL MUST BE CAST IRON.
PERMIT VOID AFTER THREE YEARS.

NOTE: INSTALL STAND PIPE ON SEPTIC TANK AND DRY WELL.

PLANS APPROVED BY Raymond Hodges DATE 8/31/71

FILL SEPTIC TANK AND DISTRIBUTION BOX WITH WATER BEFORE CALLING FOR AN INSPECTION. COVER NO WORK UNTIL INSPECTED AND APPROVED.

NEITHER THE HOWARD COUNTY COMMISSIONERS, NOR THE HEALTH DEPARTMENT IS RESPONSIBLE FOR THE SUCCESSFUL OPERATION OF ANY SYSTEM.

BLDG. PERMIT SIGNED
AND RETURNED 5/17/90
Serial # 32270
1 Story addition

BLDG. PERMIT SIGNED
AND RETURNED 2/4/76
Serial # 68733
Additions 3-486 units
to include garage

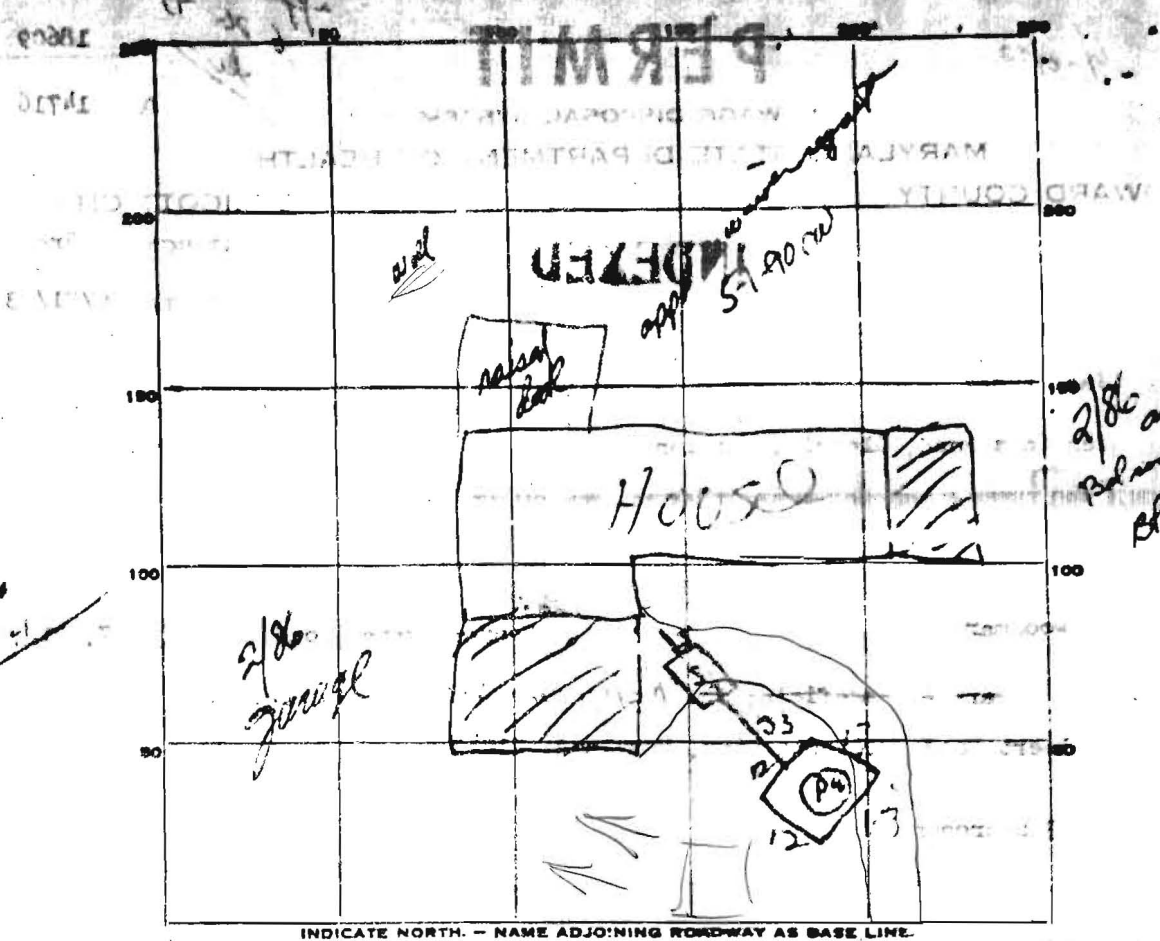

INDICATE NORTH. - NAME ADJOINING ROADWAY AS BASE LINE.

PERMIT CARD 012

SEPTIC TANK, LEVEL 012 CLEANOUTS 012

DISTRIBUTION BOX, LEVEL _____

TILE FIELD, DEPTH _____ FT. TRENCH WIDTH _____ FT.

GRAVEL DEPTH _____ IN. TOTAL LENGTH _____ FT.

NUMBER OF TRENCHES _____ TOTAL BOTTOM AREA _____

SEEPAGE PITS, INSIDE DIAMETER 50 FT. DEPTH BELOW INLET 6 1/2 FT.

ABSORBENT AREA 305 SQ. FT.

Inlet 3.5'

REMARKS _____

DATE SYSTEM APPROVED 6-26-73 IN _____ Jim M...