

LAYOUT 3/12/04 > 9:30.10 INSP 4 _____
 INSP 2 3/15/04 INSP 5 _____
 INSP 3 _____ INSP 6 _____

ISSUE DATE: 3/10/2004
 APPROVAL DATE: 3/15/04

PERMIT INDEXED

P 520088
 A 518997

**ON-SITE SEWAGE DISPOSAL SYSTEM
 HOWARD COUNTY HEALTH DEPARTMENT
 BUREAU OF ENVIRONMENTAL HEALTH
 3525-H ELLICOTT MILLS DRIVE, ELLICOTT CITY, MD 21043**

02-248735

Fogles Septic Clean, Inc IS PERMITTED TO INSTALL ALTER

ADDRESS: 580 Obrecht Rd, Sykesville PHONE NUMBER: 410-795-5670
 SUBDIVISION: John Kuhn LOT NUMBER: 4
 ADDRESS: 2295 Daniels Road PROPERTY OWNER: Winthorpe Developers
 SEPTIC TANK CAPACITY (GALLONS): 1250 OUTLET BAFFLE FILTER REQUIRED
 PUMP CHAMBER CAPACITY (GALLONS): N/A COMPARTMENTED TANK REQUIRED
 NUMBER OF BEDROOMS: 3 ← ?
 SQUARE FEET PER BEDROOM: 180
 LINEAR FEET OF TRENCH REQUIRED: 135 HOUSE SERVED BY PUBLIC WATER

TRENCHES:	Trench to be 3.0 feet wide. Inlet 4.0 feet below original grade. Bottom maximum depth 6.0 feet below original grade. Effective area begins at 4.0 feet below original grade. 2.0 feet of stone below distribution pipe.
LOCATION:	Place the distribution box as shown: 200' from the well and 3' from the right property line. Run two trenches on contour to center of lot as shown.
NOTES:	Precise installation of trenches is critical to allow sufficient room for future repair.

PLANS APPROVED: MER DATE: 10/17/03

NOTES: PERMIT VOID AFTER 2 YEARS
 CONTRACTOR IS RESPONSIBLE FOR SCHEDULING A PRE-CONSTRUCTION INSPECTION FOR ALL INSTALLATIONS
 WATERTIGHT SEPTIC TANKS REQUIRED
 ALL PARTS OF SEPTIC SYSTEM SHALL BE 100 FEET FROM ANY WATER WELL UNLESS SPECIFICALLY AUTHORIZED
 MANHOLE RISERS REQUIRED ON ALL SEPTIC TANKS AND PUMP CHAMBERS UNLESS SPECIFICALLY AUTHORIZED
 CONTRACTOR RESPONSIBLE FOR COMPLIANCE WITH APPLICABLE REGULATIONS, GUIDELINES AND THE TERMS OF THIS PERMIT

**NEITHER THE HOWARD COUNTY COUNCIL NOR THE HEALTH DEPARTMENT IS
 RESPONSIBLE FOR THE SUCCESSFUL OPERATION OF ANY SYSTEM
 PERMITTEE RESPONSIBLE FOR OBTAINING FINAL APPROVAL ON THIS PERMIT**

BUILDING PERMIT SIGNED AND RETURNED
 CALL 410-313-2640 FOR INSPECTION OF SEPTIC SYSTEM
 DO NOT LEAVE ANY REQUEST FOR INSPECTION ON VOICEMAIL

1-2605 800152025 - FRAME WALLS

A518997

NOT TO SCALE

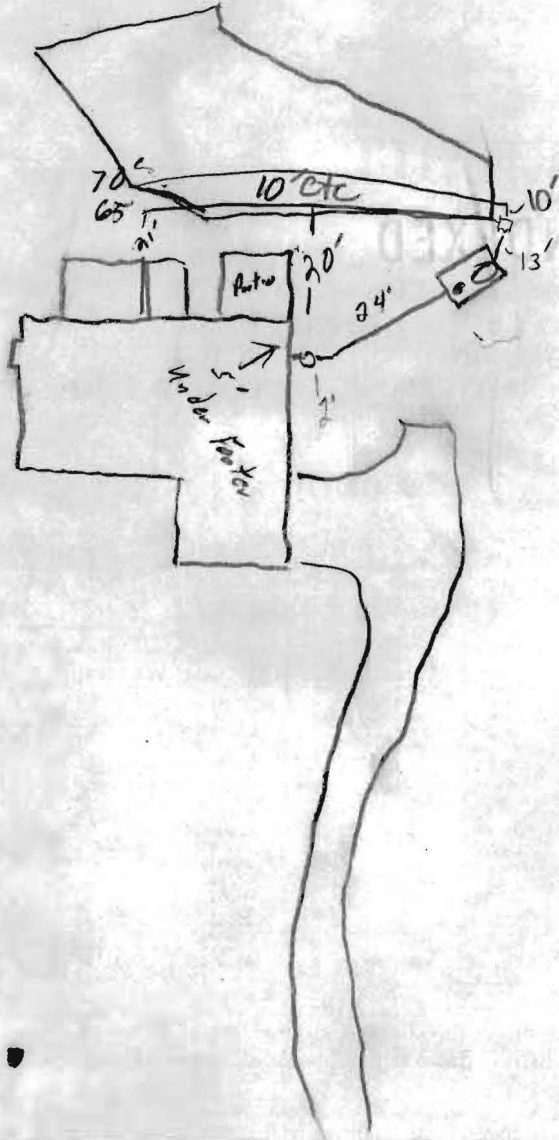

ROAD

TRENCH/DRAINFIELD DATA		
WIDTH	INLET	BOTTOM
3'	4'	6'
NUMBER OF TRENCHES		2
TOTAL LENGTH		135
ABSORPTION AREA		
DISTRIBUTION BOX LEVEL		<input checked="" type="checkbox"/>
DISTRIBUTION BOX BAFFLE		<input checked="" type="checkbox"/>
DISTRIBUTION BOX PORT		na

SEPTIC TANK DATA	
SEPTIC TANK 1 LEVEL	<input checked="" type="checkbox"/>
CAPACITY	1250 GAL
SEAM LOC	Top
TANK LID DEPTH	1-3.5
BAFFLES	<input checked="" type="checkbox"/>
BAFFLE FILTER	<input checked="" type="checkbox"/>
MANHOLE LOC	Back
6" PORT LOC	front
WATERTIGHT TEST	ALL
SEPTIC TANK 2 LEVEL	
CAPACITY	GAL
SEAM LOC	
TANK LID DEPTH	
BAFFLES	
BAFFLE FILTER	
MANHOLE LOC	
6" PORT LOC	
WATERTIGHT TEST	

PRE-CONSTRUCTION 3/12/04 - SRA staked, contours accurate. Install per B.P., tank set (50)

INSTALLATION 3/15/04 D-Box & 2 trenches (70') & (65)'. OK to cover all work (RB)

BUILDING PERMIT SIGNED AND RETURNED

FINAL INSPECTOR *[Signature]*

DATE OF APPROVAL 3/15/04

Approved Septic System Plan
Howard County Health Department

Mark R. Skin
Signature

10/17/03
Date

GENERAL NOTE
1. REFERENCE TO LIMIT OF EXISTING...

LOT 5

EXISTING HOUSE #2287

EXISTING WELL

PLAN BY FCC
1:40

WELL TAG No. HO 943779

EXISTING WELL

EXISTING HOUSE

EXISTING WELL

ASSUMED

