

2295 Daniels Rd

(1957) Pg 325 Master Tudy Book 1

DEPARTMENT OF INSPECTIONS, LICENSES AND PERMITS 3430 COURT HOUSE DRIVE ELLICOTT CITY, MD 21043 PERMITS (410)313-2455 INSPECTIONS (410)313-1810 AUTOMATED INFORMATION (410) 313-3800	HOWARD COUNTY PERMIT APPLICATION	PERMIT NUMBER: B00144290 <i>me</i>
---	---	--

Building Address ~~2295~~ Daniels Road
 Elliott City, MD 21043

Suite/Apt. #: _____ SDP/WP/Petition #: _____

Census Tract 6021 Subdivision John C Kubler

Section _____ Area _____ Lot 4

Tax Map 11 Parcel 177 Grid 7

Zoning R20 Map Coordinates 12E2 Lot size _____

Property Owner's Name Winthrop D. Winthrop

Address PO Box 279

City Highland State MD Zip Code 20777

Home Phone _____ Work Phone 301 854-1091

Applicant's Name & Mailing Address, (if other than stated hereon):

Phone 301-854-1091 Fax 301-854-1091

Existing Use Vacant Lot

Proposed Use SFD

Estimated Construction Cost \$ 250,000

Description of Work To Construct SFD

3 bedroom - 2 1/2 baths

2 car garage connect front unit

Contractor Company Winthrop Development

Contact Person _____

Address PO Box 279

City Highland State MD Zip Code 20777

License No. 900

Phone _____ Fax 301 854-1091

Occupant or Tenant _____

Contact Name _____

Address _____

City _____ State _____ Zip Code _____

Phone _____ Fax _____

Engineer or Architect Company _____

Contact Person _____

Address _____

City _____ State _____ Zip Code _____

Phone _____ Fax _____

BUILDING DESCRIPTION - COMMERCIAL

BUILDING DESCRIPTION - RESIDENTIAL

Building Characteristics	Utilities
Height: _____	Water Supply: _____ Public <input type="checkbox"/> Private <input type="checkbox"/>
No. of stories: _____	Sewage Disposal: _____ Public <input type="checkbox"/> Private <input type="checkbox"/>
Gross area, sq. ft. per floor: _____	Electric Yes <input type="checkbox"/> No <input type="checkbox"/> Gas Yes <input type="checkbox"/> No <input type="checkbox"/>
Use group: _____	Heating System: _____ Electric <input type="checkbox"/> Oil <input type="checkbox"/> Natural Gas <input type="checkbox"/> Propane Gas <input type="checkbox"/>
Construction type: _____ Reinforced Concrete <input type="checkbox"/> Structural Steel <input type="checkbox"/> Masonry <input type="checkbox"/> Wood Frame <input type="checkbox"/>	Sprinkler system: N/A <input type="checkbox"/> Full <input type="checkbox"/> Partial <input type="checkbox"/> Other Suppression <input type="checkbox"/> # of Heads _____
State Certified Modular <input type="checkbox"/>	

Building Characteristics	Utilities
SF Dwelling <input checked="" type="checkbox"/> SF Townhouse <input type="checkbox"/> Depth _____ Width _____	Water Supply: _____ Public <input type="checkbox"/> Private <input checked="" type="checkbox"/>
1st floor: _____	Sewage Disposal: _____ Public <input type="checkbox"/> Private <input checked="" type="checkbox"/>
2nd floor: _____	Electric Yes <input type="checkbox"/> No <input type="checkbox"/> Gas Yes <input type="checkbox"/> No <input checked="" type="checkbox"/>
Basement: _____	Heating System: _____ Electric <input type="checkbox"/> Oil <input type="checkbox"/> Natural Gas <input type="checkbox"/> Propane Gas <input type="checkbox"/>
Finished Basement <input type="checkbox"/> Unfinished Basement <input checked="" type="checkbox"/> Crawl space <input type="checkbox"/> Slab on Grade <input type="checkbox"/> No. of Bedrooms 3	Sprinkler system: N/A <input type="checkbox"/> NFPA #13D <input type="checkbox"/> NFPA #13R <input type="checkbox"/> Other: _____
Multi-family dwellings: No. of efficiency units: _____ No. of 1 BR units: _____ No. of 2 BR units: _____ No. of 3 BR units: _____	State Certified Modular <input type="checkbox"/> Manufactured Home <input type="checkbox"/>
Other Structure: _____ Dimensions: _____ Footings: _____ Roof: _____	

THE UNDERSIGNED HEREBY CERTIFIES AND AGREES AS FOLLOWS: (1) THAT HE/SHE IS AUTHORIZED TO MAKE THIS APPLICATION; (2) THAT THE INFORMATION IS CORRECT; (3) THAT HE/SHE WILL COMPLY WITH ALL REGULATIONS OF HOWARD COUNTY WHICH ARE APPLICABLE THERETO; (4) THAT HE/SHE WILL PERFORM NO WORK ON THE ABOVE REFERENCED PROPERTY NOT SPECIFICALLY DESCRIBED IN THIS APPLICATION; (5) THAT HE/SHE GRANTS COUNTY OFFICIALS THE RIGHT TO ENTER ONTO THIS PROPERTY FOR THE PURPOSE OF INSPECTING THE WORK PERMITTED AND POSTING NOTICES.

Applicant's Signature _____

Print Name _____
Date 9-29-03

Title/Company _____
OK MR 10/17/03

Checks payable to: DIRECTOR OF FINANCE OF HOWARD COUNTY
 ** PLEASE WRITE NEATLY AND LEGIBLY **

54'

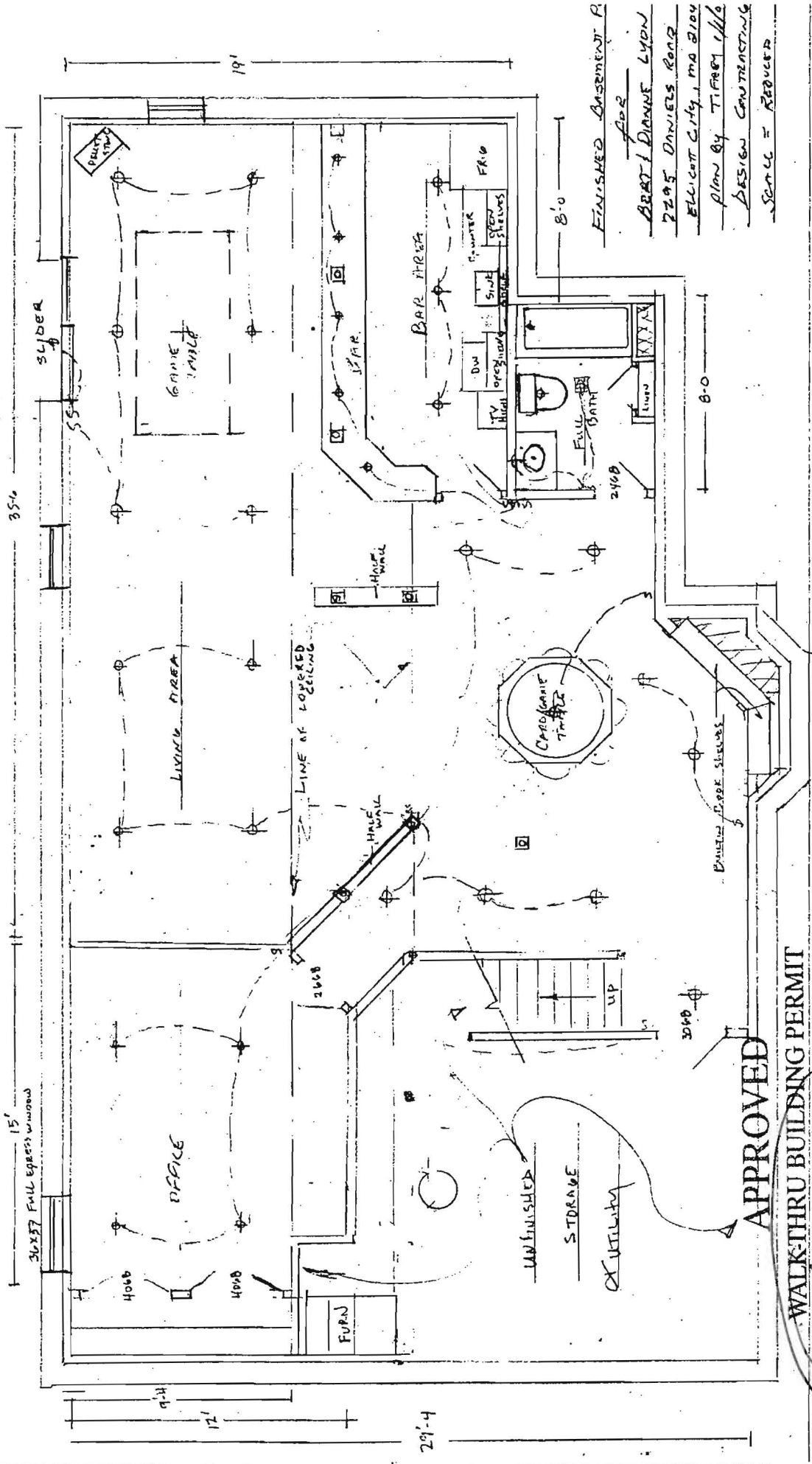

FINISHED BASEMENT FLOOR
 ART DIANE LYON
 2295 DANIELS ROAD
 ELICOTT CITY, MD 21041
 PLAN BY TIFANY WILCOX
 DESIGN CONSTRUCTION
 SCALE = REDUCED

APPROVED

WALK-THRU BUILDING PERMIT

BP# 100152005 A# 518997

APP. SAN. DATE: 1/26/05

DESC. OF WORK: finished basement
 TO COME. No increase in bedrooms