

10613 HUNTING LANE

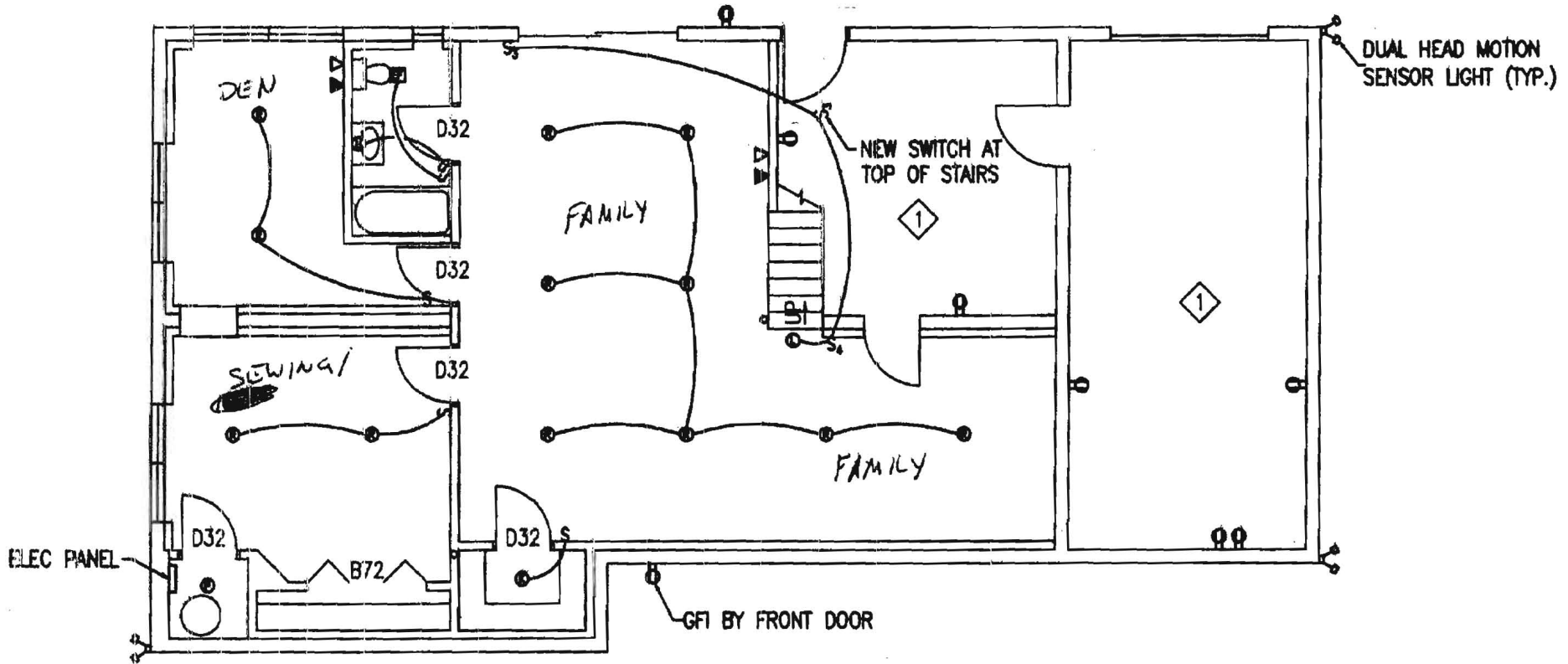

ELEC PANEL

DEN

SEWING

FAMILY

FAMILY

NEW SWITCH AT TOP OF STAIRS

DUAL HEAD MOTION SENSOR LIGHT (TYP.)

GFI BY FRONT DOOR

LEGEND

- RECESSED MOUNTED LIGHT
- ⊙ SURFACE MOUNTED LIGHT
- ⊙ KEYLESS LIGHT
- ⊙ PULLCHAIN LIGHT
- S SWITCH
- ⊙ RECEPTACLE
- ▽ PHONE OUTLET
- ▽ CABLE TV OUTLET

NOTE: ALL DIMMENSIONS ARE APPROXIMATE AND SUBJECT TO FIELD VERIFICATION.

◇ 1 UNFINISHED SPACE.

PROPOSED BASEMENT PLAN



SCALE: 1/8" = 1'-0"

800143154
7/23/03 JTB
Interoc modification
only No increase in bedroom