

APPLICATION

FOR PERCOLATION TESTING AND SITE EVALUATION

TEST DATE(S) 5/20/05 TEST TIME 10 AM A/P 522448
AGENCY REVIEW: _____ DATE 5/6/05

DO NOT WRITE ABOVE THIS LINE

I HEREBY APPLY FOR THE NECESSARY TESTING/EVALUATION PRIOR TO ISSUANCE OF SEWAGE DISPOSAL SYSTEM PERMIT(S) TO:

CHECK AS NEEDED:

- CONSTRUCT NEW SEPTIC SYSTEM(S)
- REPAIR/ADD TO AN EXISTING SEPTIC SYSTEM
- REPLACE AN EXISTING SEPTIC SYSTEM

CHECK AS NEEDED:

- NEW STRUCTURE(S)
- ADDITION TO AN EXISTING STRUCTURE
- REPLACE AN EXISTING STRUCTURE

CHECK ONE:

- CREATE NEW LOT(S)
- BUILD ON AN EXISTING LOT IN A SUBDIVISION
- BUILD ON AN EXISTING PARCEL OF RECORD

IS THE PROPERTY WITHIN 2500' OF ANY RESERVOIR?

- YES
- NO

THE TYPE OF STRUCTURE IS:

- RESIDENTIAL WITH 5 ~~BEDROOMS~~ BEDROOMS IN THE ~~EXISTING~~ STRUCTURE (NOTE UNKNOWN IF APPROPRIATE)
- COMMERCIAL (PROVIDE DETAIL OF NUMBERS AND TYPES OF EMPLOYEES/CUSTOMERS ON ACCOMPANYING PLAN)
- INSTITUTIONAL/GOVERNMENT (PROVIDE DETAIL OF NUMBERS AND TYPES OF EMPLOYEES/USERS ON ACCOMPANYING PLAN)

PROPERTY OWNER(S) Mr + Mrs. Andrew P Wetten

DAYTIME PHONE 410 489-6578 CELL _____ FAX _____

MAILING ADDRESS 2920 Rt 32 West Friendship Md 21794
STREET CITY/TOWN STATE ZIP

APPLICANT Charles M. Jenkins T/A Jenkins Bros Septic Svc Inc

DAYTIME PHONE 410 465-6646 CELL 410-971-8104 FAX 410 532-1100

MAILING ADDRESS 7670 Smiths Private Rd Sykesville, Md 21784
STREET CITY/TOWN STATE ZIP

APPLICANT'S ROLE: DEVELOPER BUILDER BUYER RELATIVE/FRIEND REALTOR CONSULTANT
CONTRACTOR

PROPERTY LOCATION
SUBDIVISION/PROPERTY NAME _____ LOT NO. _____

PROPERTY ADDRESS 2920 Route 32 West Friendship, Md 21794
STREET TOWN/POST OFFICE

TAX MAP PAGE(S) _____ GRID _____ PARCEL(S) _____ PROPOSED LOT SIZE _____

AS APPLICANT, I UNDERSTAND THE FOLLOWING: THE SYSTEM INSTALLED SUBSEQUENT TO THIS APPLICATION IS ACCEPTABLE ONLY UNTIL PUBLIC SEWERAGE IS AVAILABLE. THIS APPLICATION IS COMPLETE WHEN ALL APPLICABLE FEES AND A SUITABLE SITE PLAN HAVE BEEN RECEIVED. I ACCEPT THE RESPONSIBILITY FOR COMPLIANCE WITH ALL M.O.S.H.A. AND "MISS UTILITY" REQUIREMENTS. APPROVAL IS BASED UPON SATISFACTORY REVIEW OF A PERC CERTIFICATION PLAN.

TEST RESULTS WILL BE MAILED TO APPLICANT. Charles M Jenkins
SIGNATURE OF APPLICANT

HOWARD COUNTY HEALTH DEPARTMENT, BUREAU OF ENVIRONMENTAL HEALTH, WELL AND SEPTIC PROGRAM
3525-H ELLICOTT MILLS DRIVE, ELLICOTT CITY, MARYLAND 21043-4544 (410) 313-1771 FAX (410) 313-2648
TDD (410) 313-2323 TOLL FREE 1-877-4MD-DHMH

A/P (A)

0
1/2
1 1/2

Brown loam
Yellow Brown loam
Red Orange
Salm
10-15%
coarse cherty
quartzite

6

Red Orange
Salm
30-35%
coarse cherty
quartzite

8

Yellow Salm
40-50%
hard saprolite
& quartzite
hard bottom

11'

0

1'

3'

8'

Brown loam
Red Orange
Salm
Yellow Brown
Salm
25-30%
very weathered
micaceous
strong
saprolite

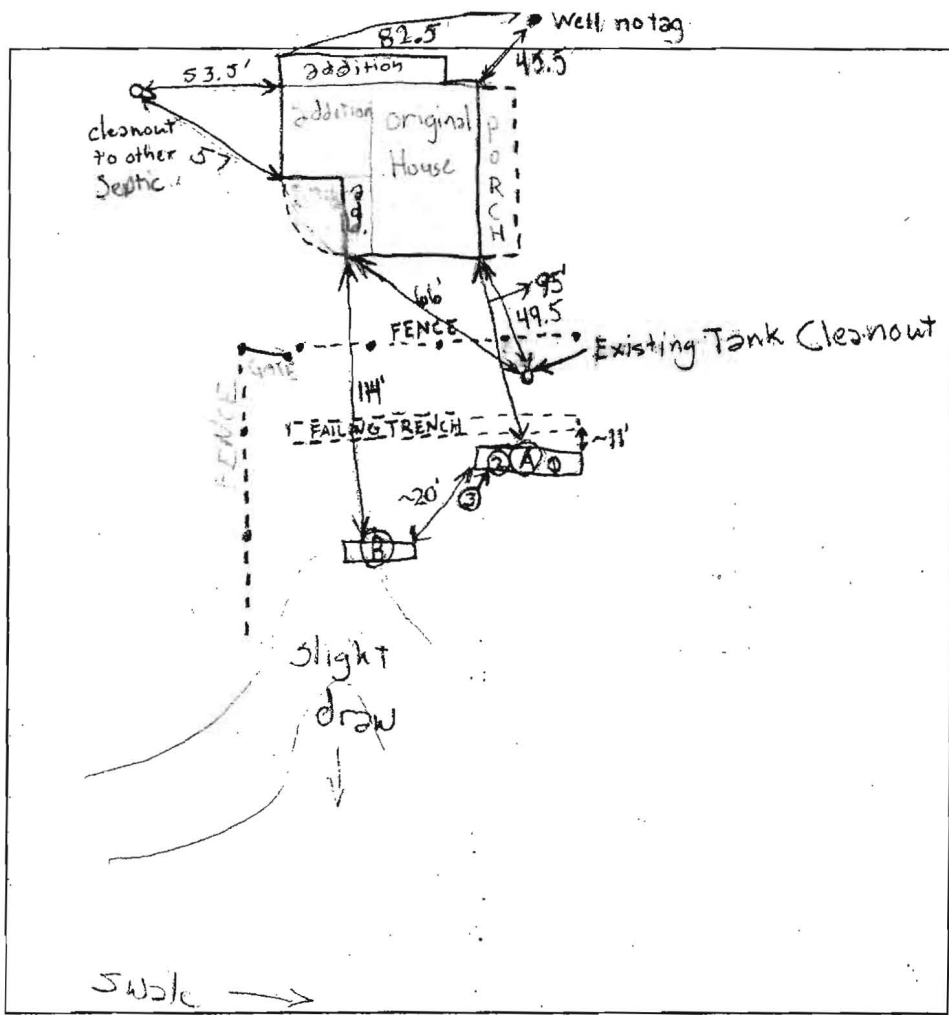

M.D. R.T. 32

DATE	TEST #	DEPTH	START	BREAK 1" DROP	STOP 2" DROP	TIME OF 2nd INCH	P/F/H
5/20/05	A1	11' 11"	Pour in of Hole	Bottom		< 2 min	F
	A2	3' 11"	10:54 ⁴⁵	10:57	11:01	4 min	P
	A3	7' 11"	11:07:15	11:08:30	11:10:20	1:50	H
	B	8'					P

Close to 2
Minutes

REMARKS Shallow trenches to avoid fast perc. times in lower profile (GA)

SANITARIAN GAC & BB BACKHOE Jenkins Bros OTHERS _____

TEST HOLES USED IN SDA (A2) & (B) AVG. PERC TIME _____ SQ. FT/BR 180

TRENCH WIDTH 3' INLET DEPTH 2 MAX. BOT DEPTH 4 EFFECTIVE SW 2'

0
 1/2
 1/2
 6
 8
 11'

A/P
 (A)

Brown loam
 Yellow Brown lm
 Red Orange
 Salm
 10-15%
 coarse cherty
 quartzite

Red Orange
 Salm
 30-35%
 coarse cherty
 quartzite

Yellow Salm
 40-50%
 hard saprolite
 & quartzite
 hard bottom

0
 1'
 3'
 8'

Brown lm
 Red Orange
 Salm
 Yellow Brown
 Salm
 25-30%
 very weathered
 micaceous
 strong
 saprolite

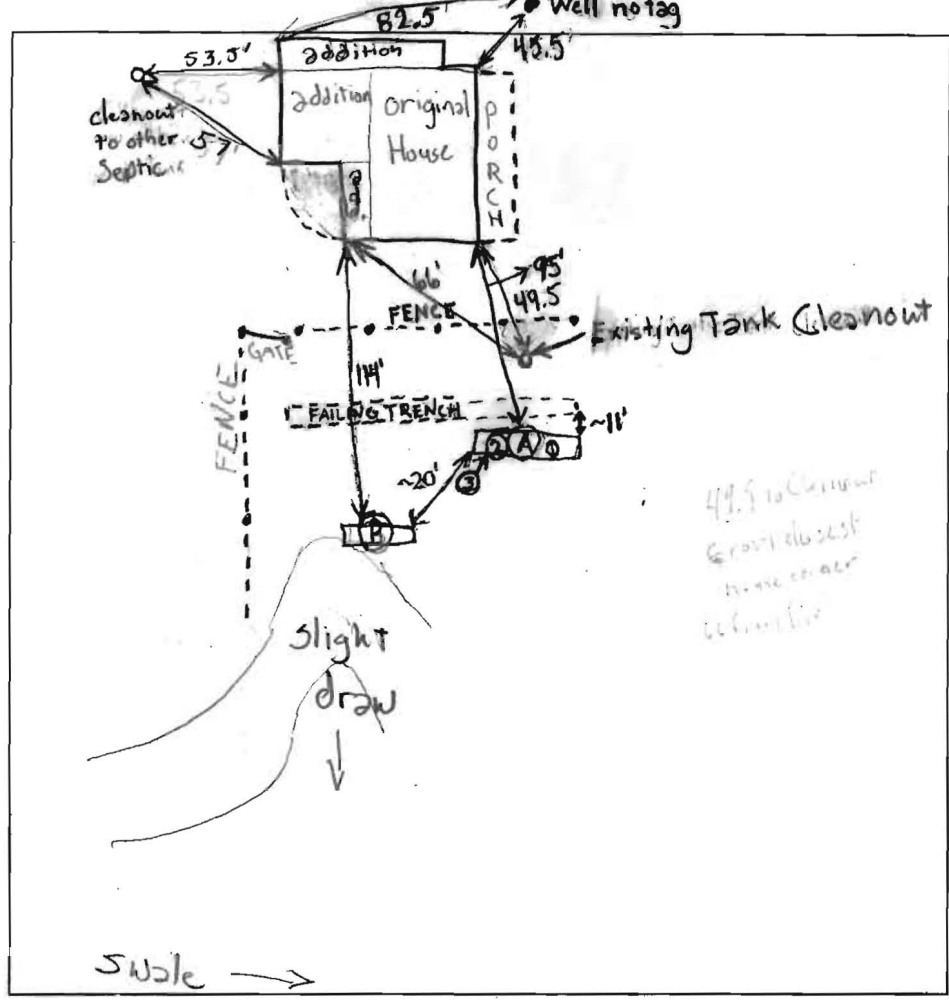

M.D. R.T. 32

DATE	TEST #	DEPTH	START	BREAK 1" DROP	STOP 2" DROP	TIME OF 2nd INCH	P/F/H
5/20/05	A1	11' 11"	Pour in Bottom of Hole			< 2 min	F
	A2	3' 11"	10:54 ⁴⁵	10:57	11:01	4 min	P
	A3	7' 11"	11:07:15	11:08:30	11:10:20	1:50	F
	B	8' v					P

REMARKS Shallow trenches to avoid fast perc. times in lower profile (GAC)

SANITARIAN GAC & BB BACKHOE Jenkins Bros, OTHERS _____

TEST HOLES USED IN SDA (A2) & (B) AVG. PERC TIME _____ SQ. FT/BR 180

TRENCH WIDTH 3' INLET DEPTH 2' MAX. BOT DEPTH 4' EFFECTIVE SW 2'

W.R

A/P _____

Empty rectangular box for notes or data.

Empty rectangular box for notes or data.

Empty rectangular box for notes or data.

Large empty rectangular box for detailed notes or diagrams.

Empty rectangular box for notes or data.

Empty rectangular box for notes or data.

Empty rectangular box for notes or data.

DATE	TEST #	DEPTH	START	BREAK 1" DROP	STOP 2" DROP	TIME OF 2nd INCH	P/F/H

REMARKS _____

SANITARIAN _____ BACKHOE _____ OTHERS _____

TEST HOLES USED IN SDA _____ AVG. PERC TIME _____ SQ. FT/BR _____

TRENCH WIDTH _____ INLET DEPTH _____ MAX. BOT DEPTH _____ EFFECTIVE S/W _____