

# PERMIT

SEWAGE DISPOSAL SYSTEM

MARYLAND STATE DEPARTMENT OF HEALTH

HOWARD COUNTY

ELLICOTT CITY

P 29463

A 23495

DISTRICT 3rd

DATE 1/31/79

INDEXED

Costello Builders \_\_\_\_\_ IS PERMITTED TO INSTALL X ALTER \_\_\_\_\_

ADDRESS \_\_\_\_\_ PHONE \_\_\_\_\_

SUBDIVISION Woodstock Ridge Est. ROAD 10337 Chevy Lane LOT 3-A

PROPERTY OWNER Joseph H. Dillman - No. 1 Area John Warden

ADDRESS 603 Woodhurst Way, Balto., Md.

SPECIFICATIONS 4 bedrooms

SEPTIC TANK CAPACITY 1250 GALLONS

DRAIN FIELD \_\_\_\_\_ DEPTH \_\_\_\_\_ FEET. BOTTOM AREA \_\_\_\_\_ SQ. FT.

DEEP TRENCH \_\_\_\_\_ DEPTH \_\_\_\_\_ FEET. BOTTOM AREA \_\_\_\_\_ SQ. FT.

SEEPAGE PITS \_\_\_\_\_ ABSORBENT SIDE-WALL AREA 144 SQ. FT. per bedroom in dry well.

WELLS \_\_\_\_\_ FT. BELOW ORIGINAL GRADE. MAXIMUM DEPTH 10 FT. BELOW ORIGINAL GRADE

EFFECTIVE DEPTH AT \_\_\_\_\_ FT. BELOW ORIGINAL GRADE.

LOCATE DISPOSAL AREA 235 FT. FROM left LOT (SEE 207 FT. FROM front LOT USE AS REQUIRED) (number of Copy Lines)

FACING LOT FROM Chevy Lane

PLANS APPROVED BY R. Moorefield DATE 12/26/76

COVER NO WORK UNTIL INSPECTED AND APPROVED.

NEITHER THE HOWARD COUNTY COUNCIL NOR THE HEALTH DEPARTMENT IS RESPONSIBLE FOR THE SUCCESSFUL OPERATION OF ANY SYSTEM.

NOTE: IF TRENCH IS USED CALL FOR INSPECTION BEFORE PLACING BRICK IN TRENCH.

NOTE: NO DRY WELL SHALL EXCEED 16 FOOT IN DIAMETER.

NOTE: ALL PIPE FROM HOUSE TO DISPOSAL AREA MUST BE CAST IRON.

PERMIT VOID AFTER THREE YEARS.

NOTE: INSTALL STAND PIPE ON SEPTIC TANK AND DRY WELL. STAND PIPES MUST BE BRICKS OR CONCRETE. CAST IRON CONCRETE IS TERRA

COTTA ACCEPTED.

SEAL PERMIT SIGNATURE

AND RETURNED

Julia # 28743

Edwards & Johnston Architects

\*INSTALLER IS RESPONSIBLE FOR OBTAINING FINAL APPROVAL ON THIS PERMIT.

Ad. 8485

144  
 54  
 576

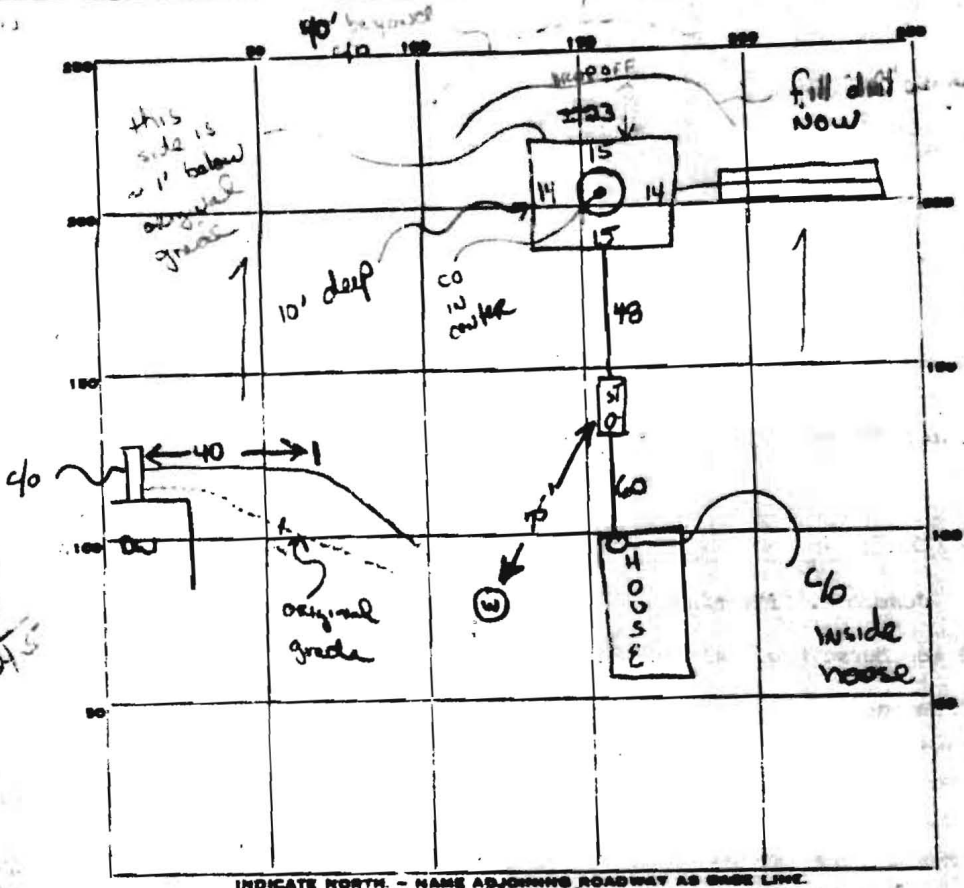

58  
 57  
 406  
 35  
 17  
 215

INDICATE NORTH - NAME ADJOINING ROADWAY AS BASE LINE.

CAVEY LA

PROPERTY OWNER: (signature)  
 SEPTIC TANK, LEVEL: 1250 top end  
 DISTRIBUTION BOX, LEVEL: No

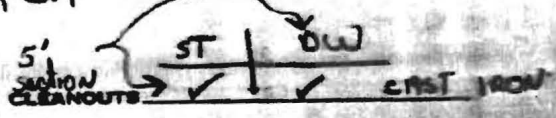

TILE FIELD, DEPTH	<u>10</u>	FT.	TRENCH WIDTH	<u>2</u>	FT.
GRAVEL DEPTH	<u>7</u>	FT.	TOTAL LENGTH	<u>35</u>	FT.
NUMBER OF TRENCHES	<u>1</u>		TOTAL BOTTOM AREA	<u>245</u>	± 245
SEEPAGE FITS, INSIDE DIAMETER	<u>3-10</u>	FT.	DEPTH BELOW BELT	<u>7</u>	FT. ± 406
Total			ABSORBENT AREA	<u>1641</u>	± 641

REMARKS: 6 Feb 79 - worked for stone in trench. Disinfectant (property owner) present during inspection. Septic tank 45' below grade - property owner intends to grade. Driveway led below grade - however, stop drop behind. Recommended to extend grade 40' beyond driveway. OK to backfill call for final when grading complete. (GLK)

7/9/91 SITE INSPECTION BY R. HODGES SHOWS NO EVIDENCE OF MALFUNCTION, GLK'S ISSUES PRESUMABLY CORRECTED.  
 DATE SYSTEM APPROVED: \_\_\_\_\_ INSPECTOR: (signature) 7/11/91