

5/1/03 9:30 5/13/03-11:30-12

PUB. SEWER STATUS VERIFIED BY NA

ISSUE DATE: 4/30/2003

PERMIT

P 518 46-A

APPROVAL DATE: 5/13/03

INDEXED

A REPAIR

ON-SITE SEWAGE DISPOSAL SYSTEM HOWARD COUNTY HEALTH DEPARTMENT BUREAU OF ENVIRONMENTAL HEALTH

05-368288

Hatfields Equipment IS PERMITTED TO INSTALL ALTER

ADDRESS: 13785 Burntwoods Road, Glenelg PHONE NUMBER: 301-854-6172

SUBDIVISION: _____ LOT NUMBER: 5-A

ADDRESS: 12578 Hall Shop Road PROPERTY OWNER: Cynthia Hall

SEPTIC TANK CAPACITY (GALLONS): Ex 1000

PUMP CHAMBER CAPACITY (GALLONS): N/A

NUMBER OF BEDROOMS: 3

SQUARE FEET PER BEDROOM: 180

LINEAR FEET OF TRENCH REQUIRED: 100' (2) 50'

TRENCHES:	Trench to be 2 feet wide. Inlet 3 feet below original grade. Bottom maximum depth 7 feet below original grade. Effective area begins at 3 feet below original grade. 4 feet of stone below distribution pipe.
LOCATION:	Install (2) 50' trenches on contour D.B. in line to D.W. w/ speed leveler up for D.W.
PURPOSE:	Septic system has failed. Call for inspection when ground is opened so sanitarian can recommend repair. Start trenches 50' off fence

PLANS APPROVED: Stuart Oster DATE: 4/30/2003

- NOTE: PERMIT VOID AFTER 2 YEARS
- NOTE: CONTRACTOR RESPONSIBLE FOR SCHEDULING A PRE-CONSTRUCTION INSPECTION FOR ALL INSTALLATIONS
- NOTE: WATERTIGHT SEPTIC TANKS REQUIRED
- NOTE: ALL PARTS OF SEPTIC SYSTEM SHALL BE 100 FEET FROM ANY WATER WELL
- NOTE: MANHOLE RISERS REQUIRED ON ALL SEPTIC TANKS AND PUMP CHAMBERS

NEITHER THE HOWARD COUNTY COUNCIL NOR THE HEALTH DEPARTMENT IS RESPONSIBLE FOR THE SUCCESSFUL OPERATION OF ANY SYSTEM BUILDING PERMITS SIGNED RESPONSIBLE FOR OBTAINING FINAL APPROVAL ON THIS PERMIT AND RETURNED CALL 410-313-2640 FOR INSPECTION OF SEPTIC SYSTEM

530-02 BOD 142147-AG POOL

101004011

NOT TO SCALE

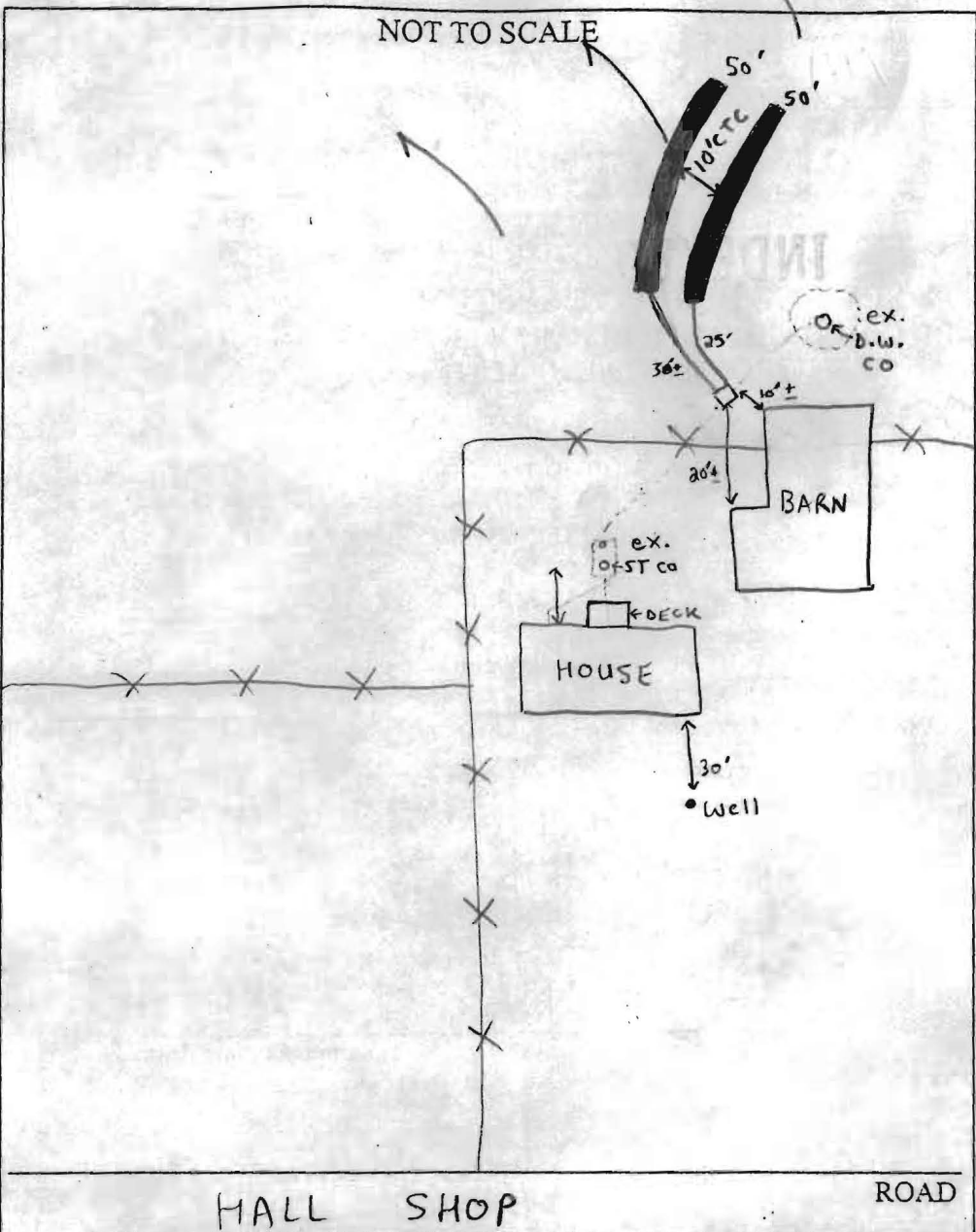

TRENCH/DRAINFIELD DATA		
WIDTH	INLET	BOTTOM
2'	3'	7'
NUMBER OF TRENCHES		2
TOTAL LENGTH		100'
ABSORPTION AREA		200 ft ²
DISTRIBUTION BOX LEVEL		✓
DISTRIBUTION BOX BAFFLE		✓
DISTRIBUTION BOX PORT		NA

SEPTIC TANK DATA	
SEPTIC TANK 1 LEVEL	existing
CAPACITY	1000? GAL
SEAM LOC	mid?
TANK LID DEPTH	?
BAFFLES	OK
BAFFLE FILTER	NA
MANHOLE LOC	NA
6" PORT LOC	front
WATERTIGHT TEST	NA
SEPTIC TANK 2 LEVEL	NA
CAPACITY	↑ GAL
SEAM LOC	↓
TANK LID DEPTH	↓
BAFFLES	↓
BAFFLE FILTER	↓
MANHOLE LOC	↓
6" PORT LOC	↓
WATERTIGHT TEST	↓

PRE-CONSTRUCTION 5/1/03 - DUG PERC HOLE IN LOCATION (A) & (B) SEE PERC TEST SHEET, INSTALL AS DISCUSSED - (SO) SRK

INSTALLATION 5/13/03 - OK TO COVER ALL WORK - (SRK)

BUILDING PERMIT SIGNED AND RETURNED

FINAL INSPECTOR Steven R. Krieg DATE OF APPROVAL 5/13/03

SITE INSPECTION SHEET

OWNER: Cynthia Hall PHONE #: _____

ADDRESS: 12578 Hall Shop CONTRACTOR: _____

WELL TAG #: _____

SUBDIVISION: _____ LOT: _____ COUNTY #: _____

PROPOSAL: 5/30/03 BP 00142147 Locate septic tank
from proposed above-ground pool

LOCATION DIAGRAM

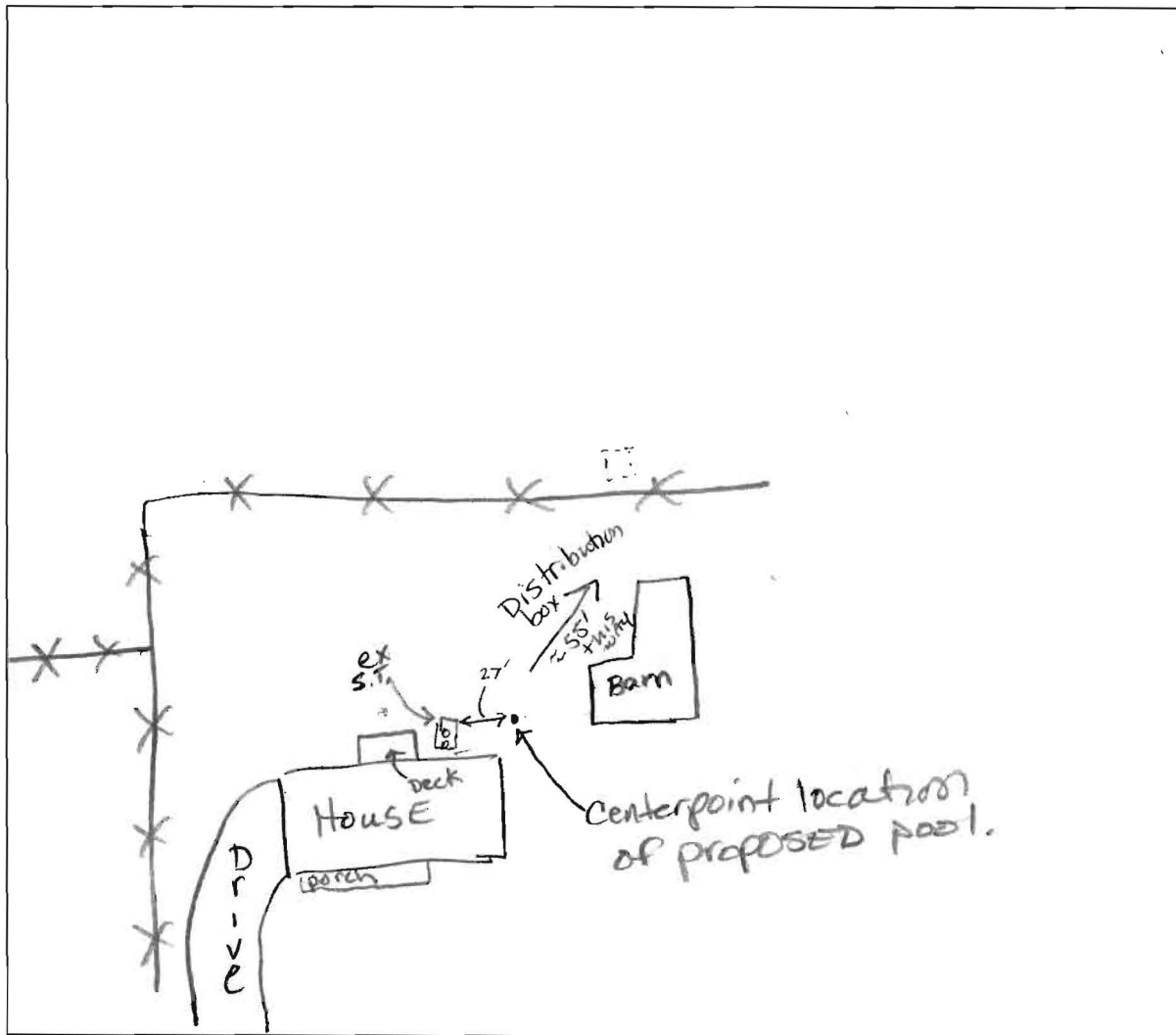

COMMENTS: 5/30/03 Pool 24' in diameter; edge of
pool 13' away from septic tank & > 20' to
distribution box - signed BP. (KN)

DATE: 5/30/03 INSPECTOR: Kacie Norman