

WR-44
4-62

STATE OF MARYLAND

State Office Building
ANNAPOLIS, MARYLAND 21401

DEPARTMENT OF
WATER RESOURCES

THIS REPORT
MUST BE SUBMITTED
WITHIN 30 DAYS
AFTER COMPLETION
OF THE WELL

WELL COMPLETION REPORT

A09036

WELL DESCRIPTION

WELL LOG

State the kind of formations penetrated, their color, their depth, their thickness, and if water-bearing

CASING AND SCREEN RECORD

State the kind and size and position of casing, liner, shoe, screen, and other accessories (if no casing used, give diameter of well)

WELL LOG	FEET	DIAM.	TEST
Top Soil	0-40	4 1/2"	0-10'
...	40-60		
...	60-75		
...	75-80		

Permit No. 228 0232
Owner ...
Address ...
Subdivision ...
Section ... Lot ...

PUMPING TEST
Hours Pumped ...
Type of Pump Used ...
Pumping Rate ...
Gallons per Minute ...

WATER LEVEL
Distance from land surface to water
Before Pumping ... Ft.
While Pumping ... Ft.

APPEARANCE OF WATER
Class Fairly Clear
Taste ...
Color ...

Height of Casing Above Land
Surface ... Ft.

PUMP INSTALLED
Type ...
Capacity
Gallons per Minute ...
Gallons per Hour ...
Pump Column Length ... Ft.

LOCATION OF WELL ON LOT
Show permanent structures such as buildings, septic tank, and/or other landmarks and distances not less than 2 distances (measurements) to well.

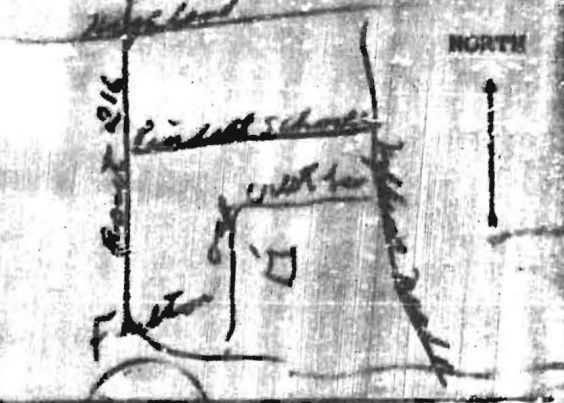

RECEIVED
BY BT 7 AM 11/2/69
DEPARTMENT OF
WATER RESOURCES

HEALTH
JANUARY 1970
28 MAR 1970

DATE WELL WAS COMPLETED

Sept 10 1969

I hereby affirm that this report contains no willful misrep, omissions or falsifications and that information given in this report is true, accurate and complete to the best of my knowledge and belief.

Frederick Brown Well Driller

Well Driller License No.: 113