

4/28/03 - 2pm

4/25/03 3:30 7/4

PUB. SEWER STATUS VERIFIED BY SAK NA

ISSUE DATE: 4/21/2003

P 518627-A

APPROVAL DATE: 4/28/03

A REPAIR

# PERMIT INDEXED

## ON-SITE SEWAGE DISPOSAL SYSTEM HOWARD COUNTY HEALTH DEPARTMENT BUREAU OF ENVIRONMENTAL HEALTH

04-31191

Fogles Septic Clean, Inc IS PERMITTED TO INSTALL  ALTER

ADDRESS: 580 Obrecht Road PHONE NUMBER: 410-795-5670

SUBDIVISION: MILL GREEN LOT NUMBER: 1

ADDRESS: 3312 Hipsley Mill Road PROPERTY OWNER: George Chandler

SEPTIC TANK CAPACITY (GALLONS): Ex 750gal

PUMP CHAMBER CAPACITY (GALLONS): N/A

NUMBER OF BEDROOMS: 3

SQUARE FEET PER BEDROOM: 240'

LINEAR FEET OF TRENCH REQUIRED: 150'

TRENCHES:	Trench to be <u>3</u> feet wide. Inlet <u>6</u> feet below original grade. Bottom maximum depth <u>8</u> feet below original grade. Effective area begins at <u>6</u> feet below original grade. <u>2</u> feet of stone below distribution pipe.
LOCATION:	<u>KEEP Ex D-Well as storage. Run pipe to d. box &amp; 2-75' trenches; 12 CTC.</u>
PURPOSE:	Septic system has failed and one bedroom addition is being built. Call for inspection when ground is opened so sanitarian can recommend repair.

PLANS APPROVED: (KN)

DATE: 4-23-03

- NOTE: PERMIT VOID AFTER 2 YEARS
- NOTE: CONTRACTOR RESPONSIBLE FOR SCHEDULING A PRE-CONSTRUCTION INSPECTION FOR ALL INSTALLATIONS
- NOTE: WATERTIGHT SEPTIC TANKS REQUIRED
- NOTE: ALL PARTS OF SEPTIC SYSTEM SHALL BE 100 FEET FROM ANY WATER WELL
- NOTE: MANHOLE RISERS REQUIRED ON ALL SEPTIC TANKS AND PUMP CHAMBERS

**NEITHER THE HOWARD COUNTY COUNCIL NOR THE HEALTH DEPARTMENT IS RESPONSIBLE FOR THE SUCCESSFUL OPERATION OF ANY SYSTEM PERMITTEE RESPONSIBLE FOR OBTAINING FINAL APPROVAL ON THIS PERMIT BUILDING PERMIT SIGNED 313-2640 FOR INSPECTION OF SEPTIC SYSTEM AND RETURNED**

4-28-03 800140139 - BDRM ADDITION

P518627-A

NOT TO SCALE

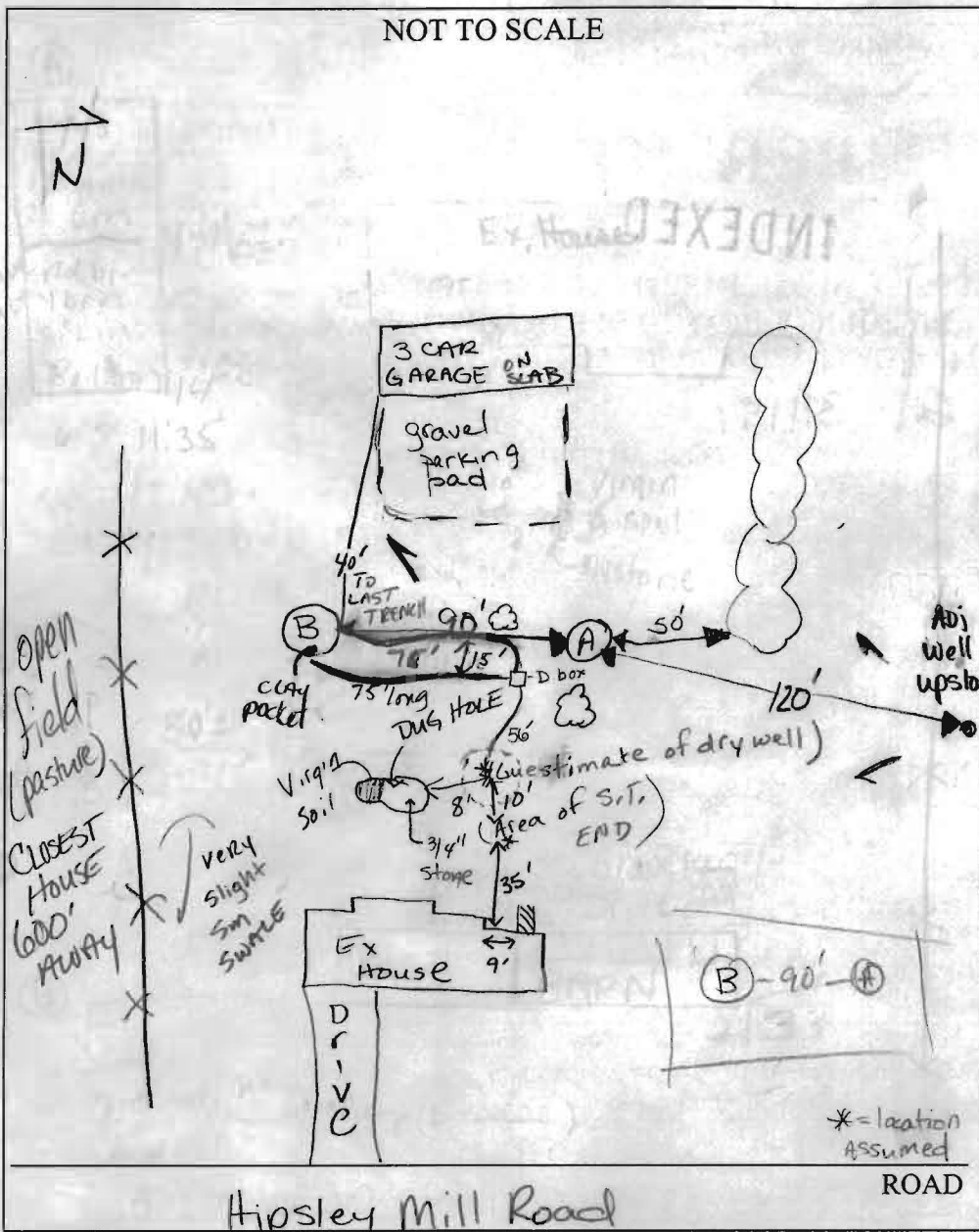

TRENCH/DRAINFIELD DATA		
WIDTH	INLET	BOTTOM
3	6	8
NUMBER OF TRENCHES		2
TOTAL LENGTH		150'
ABSORPTION AREA		
DISTRIBUTION BOX LEVEL		yes
DISTRIBUTION BOX BAFFLE		yes
DISTRIBUTION BOX PORT		N/A

SEPTIC TANK DATA		
SEPTIC TANK 1 LEVEL Ex Tank		
CAPACITY	750	GAL
SEAM LOC	TOP	
TANK LID DEPTH	3'	
BAFFLES	yes	
BAFFLE FILTER	No	
MANHOLE LOC	middle	
6" PORT LOC		
WATERTIGHT TEST	NA	
SEPTIC TANK 2 LEVEL NA		
CAPACITY		GAL
SEAM LOC		
TANK LID DEPTH		
BAFFLES		
BAFFLE FILTER		
MANHOLE LOC		
6" PORT LOC		
WATERTIGHT TEST		

PRE-CONSTRUCTION 4-23-03 DRYWELL FULL; Perc hole at edge of drywell  
 of gravel began pouring in at 4'. Filled hole. Digging  
 INSTALLATION in backyard for trench system specs.  
 Surrounding wells NOT AN ISSUE, Adj LOT'S well  
 upslope & >100' away. SEE SOIL PROFILES FOR TEST  
 HOLES A & B. Homogeneous soils OF CLM to ~5', transition to G,  
 then silm w/ small saprolite frags ~25% below 6'. Perc  
 time avg. 16 min, INSTALL AS DISCUSSED SEE SPECS ON FRONT- (KN)  
 4-25-03 Pumped S.T., replaced pipe between s.t. + Dry well. Shot to 15' etc  
 Plenty of repair area. OK TO COVER 1st trench. 2nd trench should be like  
 FINAL INSPECTOR Race Noonan DATE OF APPROVAL 4/28/03  
 shown: verify. (KN) 4/28/03 OK TO cover 2nd trench (KN)