

*1st
Revised
11/1/68*

PERMIT

SEWAGE DISPOSAL SYSTEM

MARYLAND STATE DEPARTMENT OF HEALTH

HOWARD COUNTY

ELLICOTT CITY

INDEXED

DISTRICT 3

DATE 11/8/71

Sender Woodmark, Inc.

IS PERMITTED TO INSTALL SEWER AFTER

ADDRESS RD #2, Dayton, Md.

PHONE 286-3408

A SEWAGE DISPOSAL SYSTEM LOCATED AT _____

SUBDIVISION Woodmark

OWNER OWNER of Madison Rd. Lot 2, Blk. F, Subd. 4
S Carroll Hill Rd.

PROPERTY OWNER Woodmark, Inc.

ADDRESS _____

SPECIFICATIONS 3 Bedrooms

DRAIN FIELD _____ DEPTH _____ FEET. BOTTOM AREA _____ SQ. FT.

SEEPAGE PITS _____ ABSORBENT SIDE-WALL AREA _____ SQ. FT.

SEPTIC TANK CAPACITY 1000 GALLONS

FOR GARBAGE GRINDER, INCREASE DISPOSAL AREA 22% & TANK CAPACITY 50%.

OTHER Dry Well - 125 sq. ft. absorbent sidewall area per bedroom to begin below inlet pipe. Inlet pipe 4 ft. below original grade. Max. depth permitted for dry well is 10 ft. below original grade. Place dry well 80 ft. from rear lot line and 40 ft. from left sideline as seen when facing from Carroll Hill Rd.

NOTE: ALL PIPE FROM HOUSE TO SEPTIC TANK MUST BE CAST IRON.

PERMIT VOID AFTER THREE YEARS.

NOTE: INSTALL STAND PIPE ON SEPTIC TANK AND DRY WELL.

PLANS APPROVED BY D. W. Monaghan

DATE 11/4/68

FILL SEPTIC TANK AND DISTRIBUTION BOX WITH WATER BEFORE CALLING FOR AN INSPECTION. COVER NO WORK UNTIL INSPECTED AND APPROVED.

NEITHER THE HOWARD COUNTY COMMISSIONERS NOR THE HEALTH DEPARTMENT IS RESPONSIBLE FOR THE SUCCESSFUL OPERATION OF ANY SYSTEM.

A 13118

CARROLL MILL RD

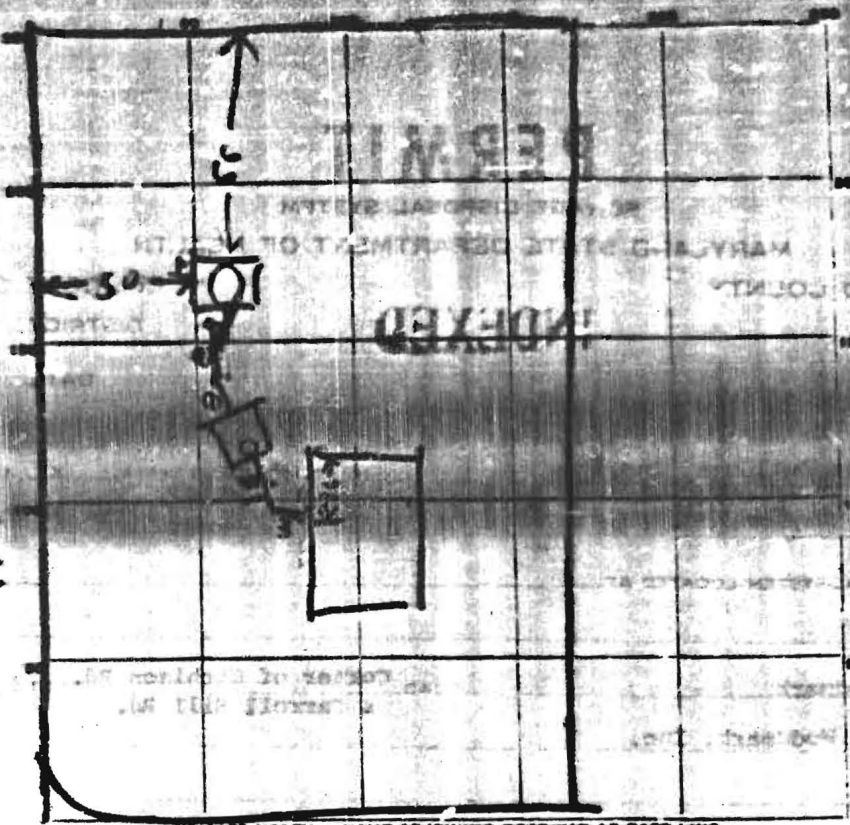

INDICATE NORTH - NAME ADJOINING HIGHWAY AS BASE LINE
ETCHISON RD

PERMIT CARD _____

SEPTIC TANK, LEVEL OK 1000 Concrete CLEANOUTS OK

DISTRIBUTION BOX, LEVEL _____

TILE FIELD, DEPTH _____ FT. TRENCH WIDTH _____ FT.

GRAVEL DEPTH _____ IN TOTAL LENGTH _____ FT.

NUMBER OF TRENCHES _____ TOTAL BOTTOM AREA _____

SEEPAGE PITS, INSIDE DIAMETER 17 FT. DEPTH BELOW INLET 7 FT.

ABSORBENT AREA 441 SQ. FT. counting stone

REMARKS 1/3/71 - Day Well 1' and 4' below grade
Perimeter of Day Well 53 FT
3.75 sq ft. apron for 3 bedrooms
Well not yet installed

DATE SYSTEM APPROVED 1/3/71 INSPECTOR Raymond Hodges

Existing grade
Finish grade

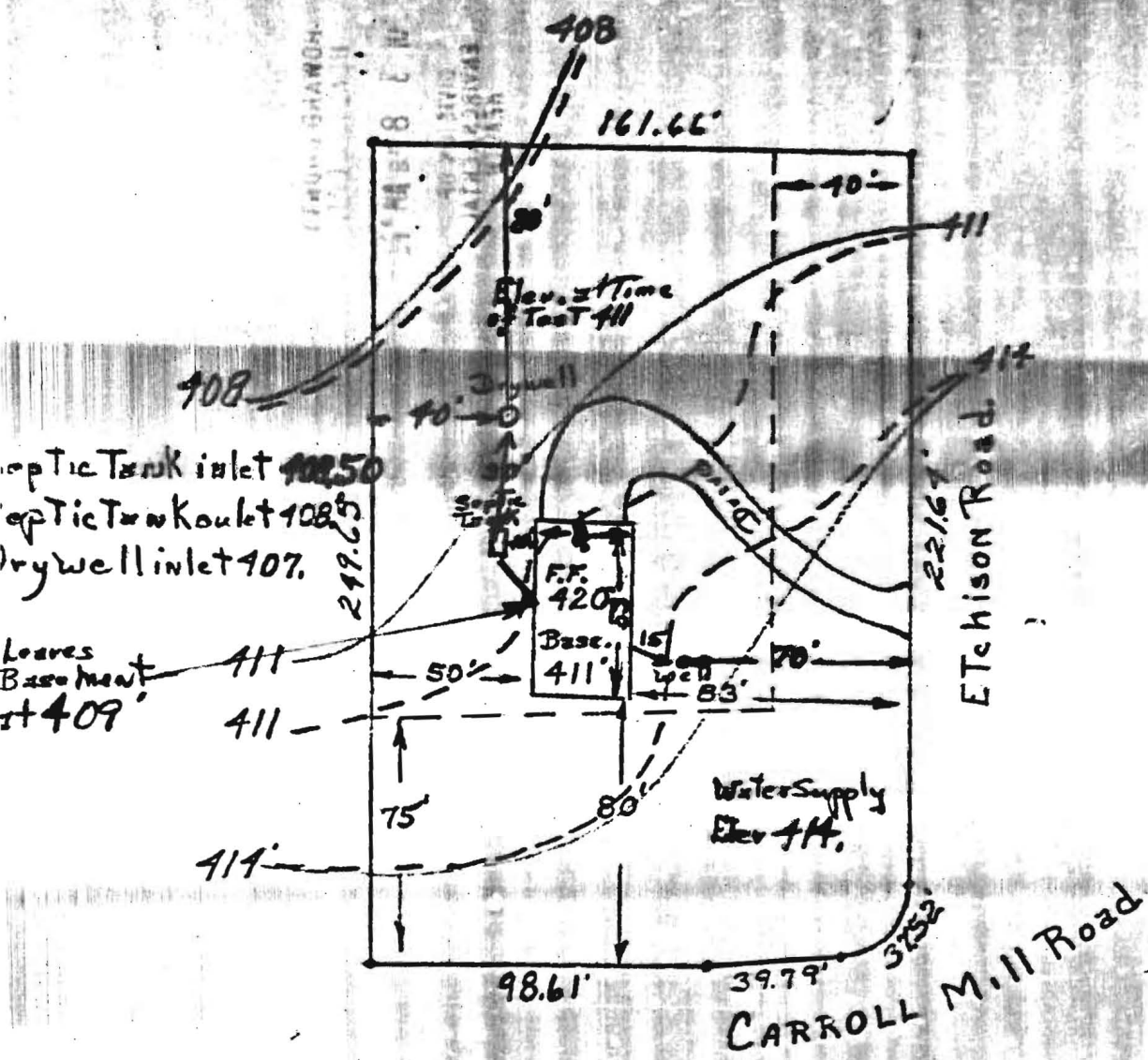

Scale 1" = 50'

Donald L Mitchell
 Lot 2 B1K. F. Sec. 4
 Woodmark Sub.
 730-7405

Souder Builders Inc
 RD #2 Dayton Md
 286-3408