

11/11/78
11/14/78
11/16/78

off 11.14.78
11/1/78 C.O.
e.B.W.

PERMIT

P 29077
A 25703

SEWAGE DISPOSAL SYSTEM

MARYLAND STATE DEPARTMENT OF HEALTH*

HOWARD COUNTY

ELLICOTT CITY

DISTRICT 3rd

INDEXED

DATE 10/18/78

Mr. Rodney Dize IS PERMITTED TO INSTALL X ALTER

ADDRESS _____ PHONE _____

SUBDIVISION _____ ROAD 12455 Howard Lodge Road LOT 6

PROPERTY OWNER Mr. Rodney Dize

ADDRESS same as above

SPECIFICATIONS 4 bedrooms

SEPTIC TANK CAPACITY 1250 GALLONS

DRAIN FIELD _____ DEPTH _____ FEET. BOTTOM AREA _____ SQ. FT.

DEEP TRENCH _____ DEPTH _____ FEET. BOTTOM AREA _____ SQ. FT.

SEEPAGE PITS _____ ABSORBENT SIDE-WALL AREA 172 SQ. FT. per bedroom in system.

INLET PIPE 2 1/2 FT. BELOW ORIGINAL GRADE. MAXIMUM DEPTH 9 FT. BELOW ORIGINAL GRADE

EFFECTIVE DEPTH AT _____ FT. BELOW ORIGINAL GRADE.

LOCATE DISPOSAL AREA 175 FT. FROM front LOT LINE AND 70 FT. FROM left LOT LINE AS SEEN WHEN

FACING LOT FROM Howard Lodge Road.

Begin the trench 5 ft. from the edge of the dry well and follow the contour of the land. The trench will be 2 ft. wide, 9 ft. deep, and contain 6 1/2 ft. of stone.

total sq. ft. - 688

PLANS APPROVED BY Moorefield DATE 1977

COVER NO WORK UNTIL INSPECTED AND APPROVED.

NEITHER THE HOWARD COUNTY COUNCIL NOR THE HEALTH DEPARTMENT IS RESPONSIBLE FOR THE SUCCESSFUL OPERATION OF ANY SYSTEM.

NOTE: IF TRENCH IS USED CALL FOR INSPECTION BEFORE PLACING GRAVEL IN TRENCH.

NOTE: NO DRY WELL SHALL EXCEED 15 FOOT IN DIAMETER.

NOTE: ALL PIPE FROM HOUSE TO DISPOSAL AREA MUST BE CAST IRON.

PERMIT VOID AFTER THREE YEARS.

NOTE: INSTALL STAND PIPE ON SEPTIC TANK AND DRY WELL. STAND PIPES MUST BE 6 INCHES IN DIAMETER. CAST IRON, CONCRETE OR TERRA COTTA ACCEPTED.

BLDG. PERMIT SIGNED
AND RETURNED 8/28/80
Smith # 44209
Pole Barn

A 25703

***INSTALLER IS RESPONSIBLE FOR OBTAINING FINAL APPROVAL ON THIS PERMIT.**

8-28-80 Pole Barn B.P. App. # 44209

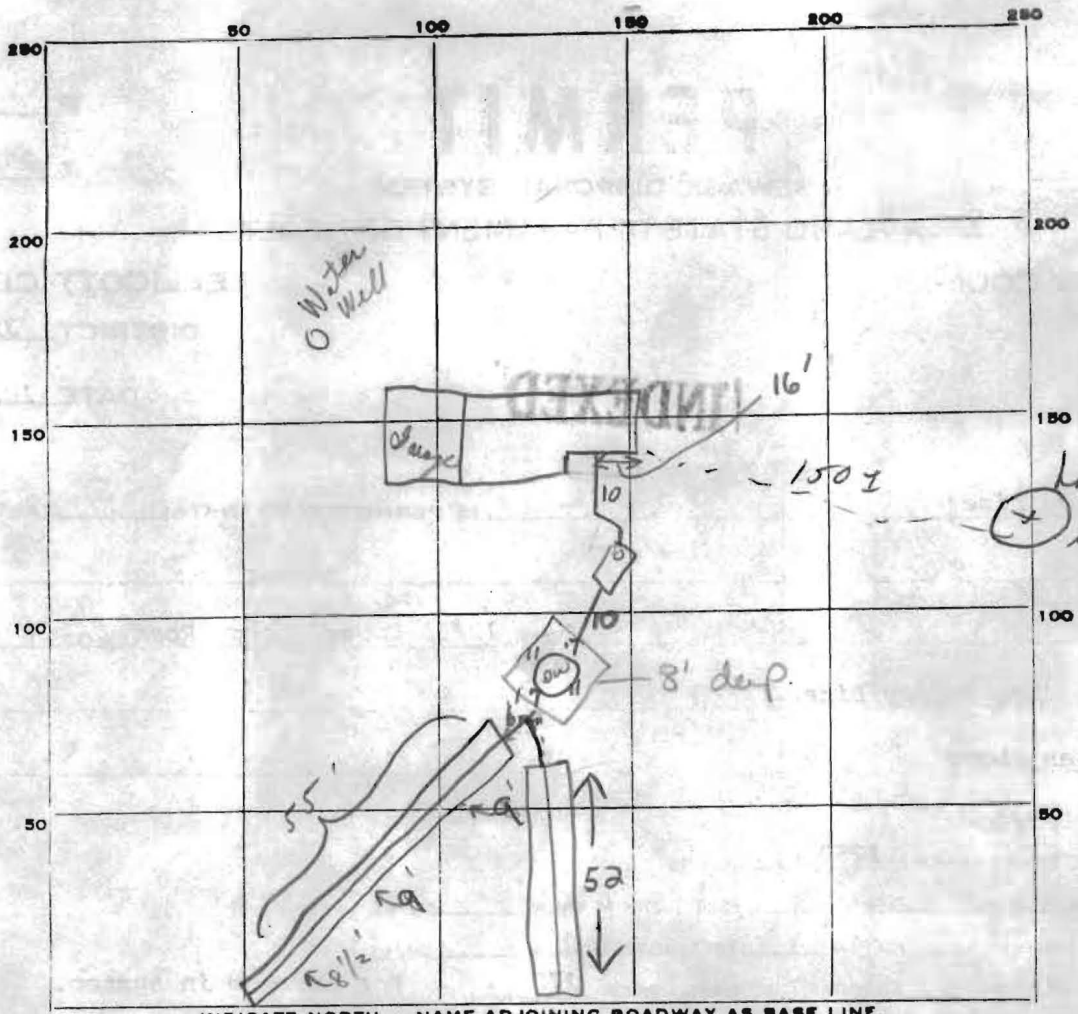

3350
 105
 + 6.5

 525
 630
 683
 5.5
 + 180

 185

INDICATE NORTH. - NAME ADJOINING ROADWAY AS BASE LINE.

11/1/78 Howard Lodge
 (Use stop work + correct
 in window)

S.T. | D.W.

PERMIT CARD _____

SEPTIC TANK, LEVEL ? large _____

CLEANOUTS OK | ² be installed

DISTRIBUTION BOX, LEVEL Na _____

Trench
 TILE FIELD, DEPTH 9 FT. TRENCH WIDTH _____ FT.

GRAVEL DEPTH 1 FT. TOTAL LENGTH 107 FT.

NUMBER OF TRENCHES 2 TOTAL BOTTOM AREA 683

SEEPAGE PITS, INSIDE DIAMETER ^{outside perimeter} 36 FT. DEPTH BELOW INLET 5.5 FT. ± 198

ABSORBENT AREA _____ SQ. FT.

REMARKS 11/1/78 Stop work - spoke to Digo state
 recommend go by house plans 4/07 contact
 supervisor. Septic tank too high (out of ground)
 + dig well - range 1 completely out of ground needs to be
 deeper + trench 55' only 8' deep. Partial - nothing apparent
 6/20/78 = Call for final when gravel is added to trenches. (GLK)

DATE SYSTEM APPROVED 11/14/78

INSPECTOR *du Monagh*