

MILLER'S MILL ROAD

TO ROUTE NO. 87
2,000 FT ±

STATE ROAD

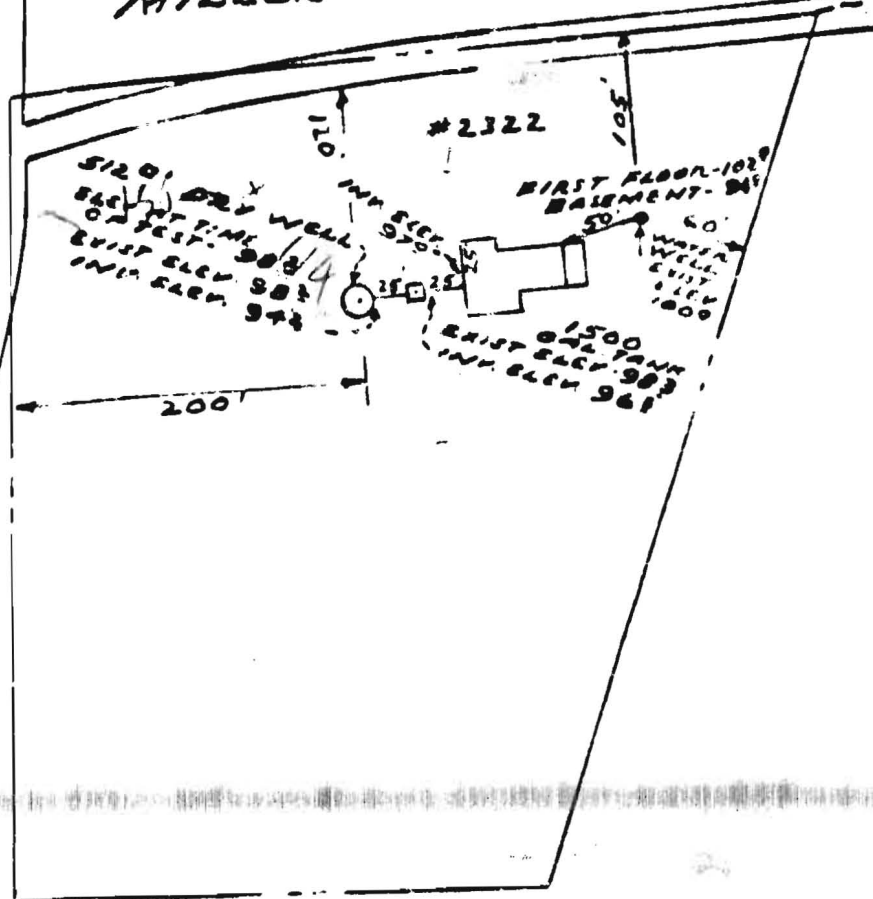

PLAT SHOWING SEPTIC SYSTEM
 MILLERS MILL ROAD
 4TH DISTRICT
 WOODBINE
 HOWARD CO, MD

11 10 55 W4.1

Handwritten signature
 15 9/1/80
 REVISED JULY 10, 1974.

SPEITZMAN FARON & ASSOCIATES INC.

Suite 63 Investment Bldg.
 Towson, Maryland 21204