

PUB. SEWER STATUS VERIFIED BY _____

ISSUE DATE: _____

PERMIT

P 518570-C

APPROVAL DATE: _____

A re-index

INDEXED

ON-SITE SEWAGE DISPOSAL SYSTEM HOWARD COUNTY HEALTH DEPARTMENT BUREAU OF ENVIRONMENTAL HEALTH

OS-343895

IS PERMITTED TO INSTALL ALTER

ADDRESS: _____ PHONE NUMBER: _____

SUBDIVISION: _____ LOT NUMBER: _____

ADDRESS: 13945 Triadelphia Road PROPERTY OWNER: Alvin Francis

SEPTIC TANK CAPACITY (GALLONS): _____

PUMP CHAMBER CAPACITY (GALLONS): _____

NUMBER OF BEDROOMS: _____

SQUARE FEET PER BEDROOM: _____

LINEAR FEET OF TRENCH REQUIRED: _____

TRENCHES:	Trench to be _____ feet wide. Inlet _____ feet below original grade. Bottom maximum depth _____ feet below original grade. Effective area begins at _____ feet below original grade. _____ feet of stone below distribution pipe.
LOCATION:	
PURPOSE:	Re-index file, building permit addition approved 4/1/03

PLANS APPROVED: _____ DATE: _____

- NOTE: PERMIT VOID AFTER 2 YEARS
- NOTE: CONTRACTOR RESPONSIBLE FOR SCHEDULING A PRE-CONSTRUCTION INSPECTION FOR ALL INSTALLATIONS
- NOTE: WATERTIGHT SEPTIC TANKS REQUIRED
- NOTE: ALL PARTS OF SEPTIC SYSTEM SHALL BE 100 FEET FROM ANY WATER WELL
- NOTE: MANHOLE RISERS REQUIRED ON ALL SEPTIC TANKS AND PUMP CHAMBERS

NEITHER THE HOWARD COUNTY COUNCIL NOR THE HEALTH DEPARTMENT IS RESPONSIBLE FOR THE SUCCESSFUL OPERATION OF ANY SYSTEM PERMITTEE RESPONSIBLE FOR OBTAINING FINAL APPROVAL ON THIS PERMIT CALL 410-313-2640 FOR INSPECTION OF SEPTIC SYSTEM

P 518570-C

Initial approved
9/20/72

PERMIT

SEWAGE DISPOSAL SYSTEM

2054
A 01483

MARYLAND STATE DEPARTMENT OF HEALTH

HOWARD COUNTY

ELLICOTT CITY

DISTRICT 5th

INDEXED

DATE 9/17/72

William Hopkins

IS PERMITTED TO INSTALL ALTER

ADDRESS Jennings Chapel Rd., Florence, Md.

PHONE 489-4711

A SEWAGE DISPOSAL SYSTEM LOCATED AT

13945 Triadelphia Rd

SUBDIVISION

ROAD Triadelphia Road & Lanthicum Road

LOT

PROPERTY OWNER

Alvin Branch

ADDRESS

3470 Vollmerhausen Road, Savage, Md.

SPECIFICATIONS

4 bedrooms

DRAIN FIELD _____ DEPTH _____ FEET. BOTTOM AREA _____ SQ. FT.

SEEPAGE PITS _____ ABSORBENT SIDE-WALL AREA _____ SQ. FT.

SEPTIC TANK CAPACITY 1250 GALLONS

FOR GARBAGE GRINDER, INCREASE DISPOSAL AREA 22% & TANK CAPACITY 80%.

OTHER DRY WELL - 12 ft. diameter - 4 1/2 ft. effective area below the first 4 1/2 ft. of non-absorbent ground. Come off dry well with trench 50 ft. long. 9 ft. deep - 4 1/2 ft. of gravel under pipe. Call for inspection of trench before gravel is installed. Place dry well 180 ft. from front lot line and 40 ft. from left side line as seen when facing lot line from Triadelphia Road. Run trench to right of dry well.

NOTE: INSTALL STAND PIPE ON SEPTIC TANK AND DRY WELL.

PERMIT VOID AFTER THREE YEARS.

NOTE: ALL PIPE FROM HOUSE TO SEPTIC TANK MUST BE CAST IRON.

PLANS APPROVED BY

Palmer F. Mine

DATE

1/11/72

FILL SEPTIC TANK AND DISTRIBUTION BOX WITH WATER BEFORE CALLING FOR AN INSPECTION. COVER NO WORK UNTIL INSPECTED AND APPROVED.

NEITHER THE HOWARD COUNTY COMMISSIONERS NOR THE HEALTH DEPARTMENT IS RESPONSIBLE FOR THE SUCCESSFUL OPERATION OF ANY SYSTEM.

A 11853

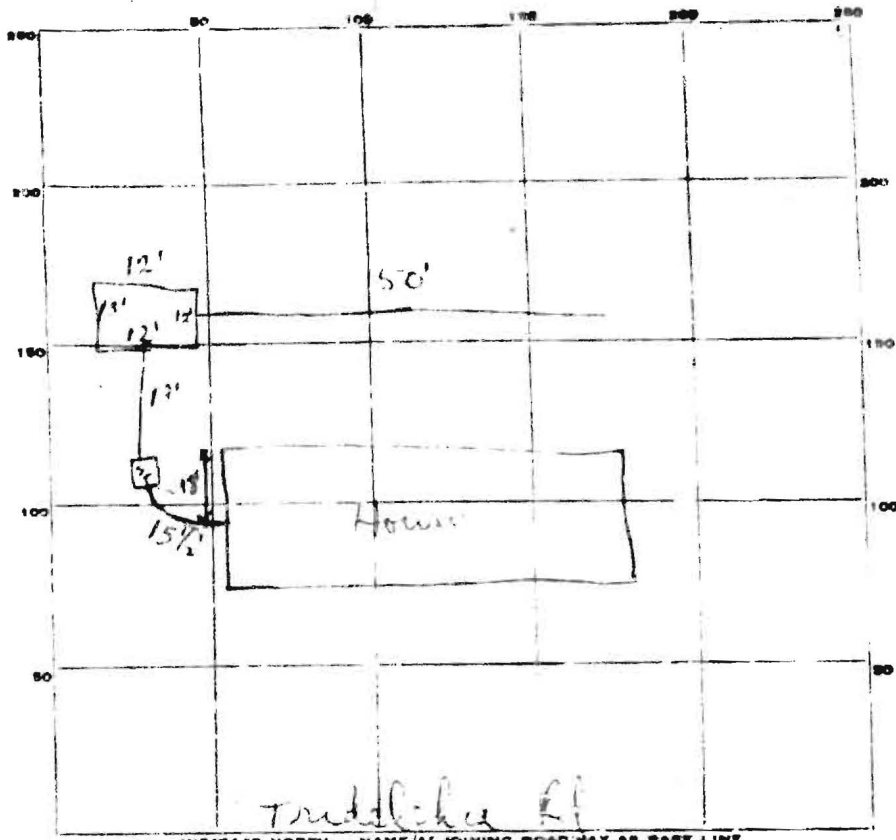

$$\begin{array}{r} 40 \\ 196 \\ 25 \\ \hline 421 \\ 671 \end{array}$$

INDICATE NORTH - NAME ADJOINING ROAD WAY AS BASE LINE.

PERMIT CARD (61)
 SEPTIC TANK, LEVEL (OK) 4' deep CLEANOUTS (OK)
 DISTRIBUTION BOX, LEVEL _____
dry well trench 4 1/2' deep TRENCH WIDTH 2 FT.
 GRAVEL D. PTH. _____ IN. TOTAL LENGTH 50' FT.
 NUMBER OF TRENCHES 1 TOTAL side AREA _____
 SEEPAGE PITS, INSIDE DIAMETER Perimeter 49' FT. DEPTH BELOW INLET 4 1/2' FT.
 ABSORBENT AREA 671 SQ. FT.

REMARKS (OK) (117.5) 9/1/72
(OK) to close - except from house to ~~house~~ septic tank -
call when all pipe installed -

DATE SYSTEM APPROVED 9/1/72 INSPECTOR [Signature]

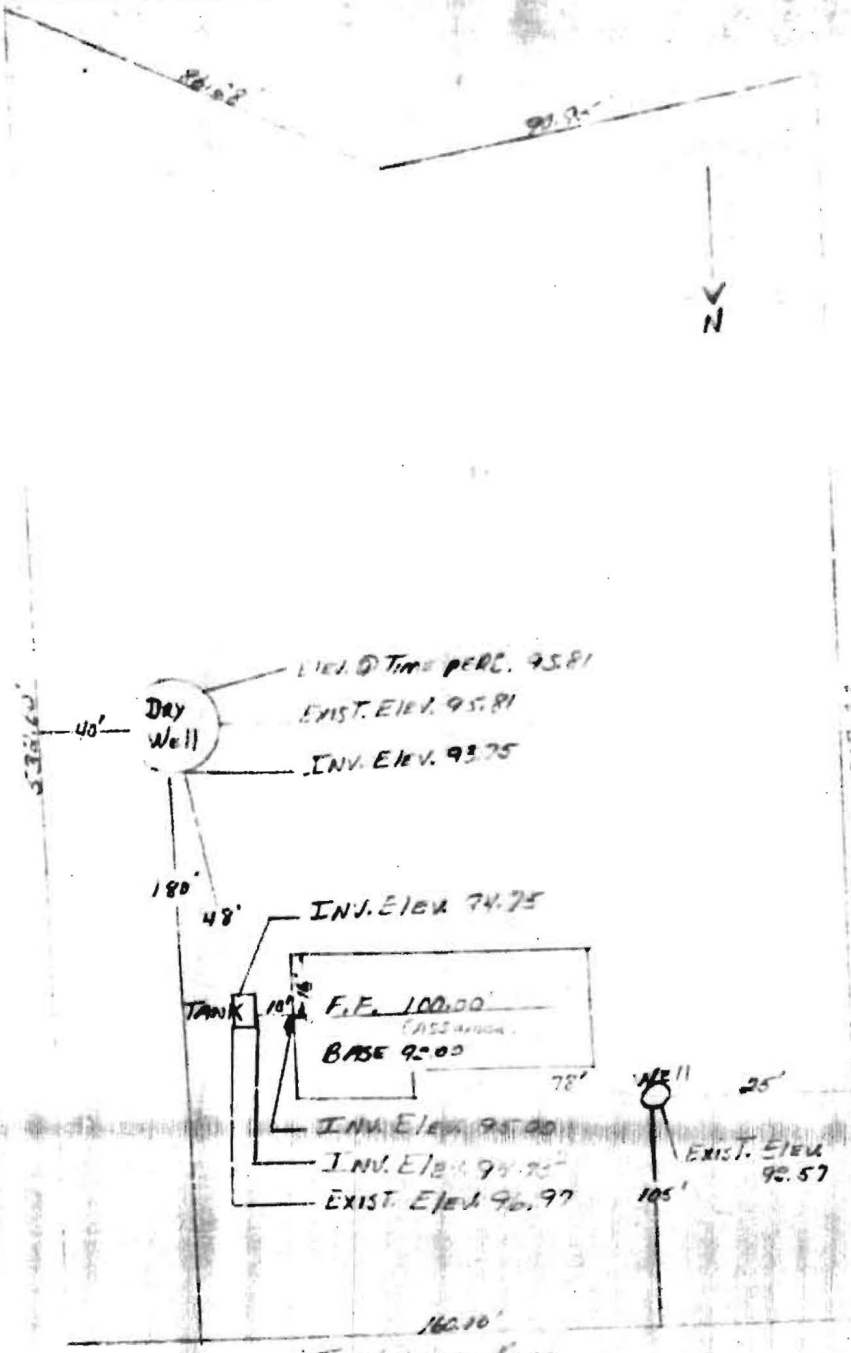

LIQ. @ TIME PERC. 95.81
 EXIST. ELEV. 95.81
 INV. ELEV. 93.75

INJ. ELEV. 74.75
 F.F. 100.00
 (ASSUMED)
 BASE 92.00
 INV. ELEV. 95.00
 INV. ELEV. 94.75
 EXIST. ELEV. 92.57

16.00"
 TRANSMISSION PIPE

238-72
 OK
 [Signature]

SEPTIC SYSTEM

478-1674

Alvin D. Smith