

LAYOUT 1/28/03 9:30 INSP 4 _____
 INSP 2 _____ INSP 5 _____
 INSP 3 _____ INSP 6 _____

INDEXED

ISSUE DATE: 1/28/2003 P 518522
 EVAL APPROVAL DATE: 1/28/03 A REPAIR
PERMIT SYSTEM EVAL.

**ON-SITE SEWAGE DISPOSAL SYSTEM
 HOWARD COUNTY HEALTH DEPARTMENT
 BUREAU OF ENVIRONMENTAL HEALTH
 05-362105**

Jack Fyock Septic Service IS PERMITTED TO INSTALL ALTER

ADDRESS: PO Box 89, Glenelg, MD 21737 PHONE NUMBER: 410-988-9270

SUBDIVISION: _____ LOT NUMBER: _____

ADDRESS: 14034 Brighton Dam Road PROPERTY OWNER: Michelle Martin

SEPTIC TANK CAPACITY (GALLONS): existing 750-1000 OUTLET BAFFLE FILTER REQUIRED

PUMP CHAMBER CAPACITY (GALLONS): NA COMPARTMENTED TANK REQUIRED

NUMBER OF BEDROOMS: 3

SQUARE FEET PER BEDROOM: NA

LINEAR FEET OF TRENCH REQUIRED: NA

**BUILDING PERMIT SIGNED
 AND RETURNED
 2-6-03 800 138 738 - JG PRL**

TRENCHES:	Trench to be feet wide. Inlet feet below original grade. Bottom maximum depth feet below original grade. Effective area begins at feet below original grade. feet of stone below distribution pipe.
LOCATION:	
NOTES:	In support of building permit. Call for inspection when ground is opened so sanitarian can recommend repair. / <u>system evaluation.</u>

SYSTEM EVAL:
 PLANS APPROVED: Steven R. Krieg DATE: 1/28/03

- NOTE: PERMIT VOID AFTER 2 YEARS
- NOTE: CONTRACTOR RESPONSIBLE FOR SCHEDULING A PRE-CONSTRUCTION INSPECTION FOR ALL INSTALLATIONS
- NOTE: WATERTIGHT SEPTIC TANKS REQUIRED
- NOTE: ALL PARTS OF SEPTIC SYSTEM SHALL BE 100 FEET FROM ANY WATER WELL
- NOTE: MANHOLE RISERS REQUIRED ON ALL SEPTIC TANKS AND PUMP CHAMBERS UNLESS SPECIFICALLY AUTHORIZED

NEITHER THE HOWARD COUNTY COUNCIL NOR THE HEALTH DEPARTMENT IS RESPONSIBLE FOR THE SUCCESSFUL OPERATION OF ANY SYSTEM PERMITTEE RESPONSIBLE FOR OBTAINING FINAL APPROVAL ON THIS PERMIT CALL 410-313-2640 FOR INSPECTION OF SEPTIC SYSTEM

05/8522

NOT TO SCALE

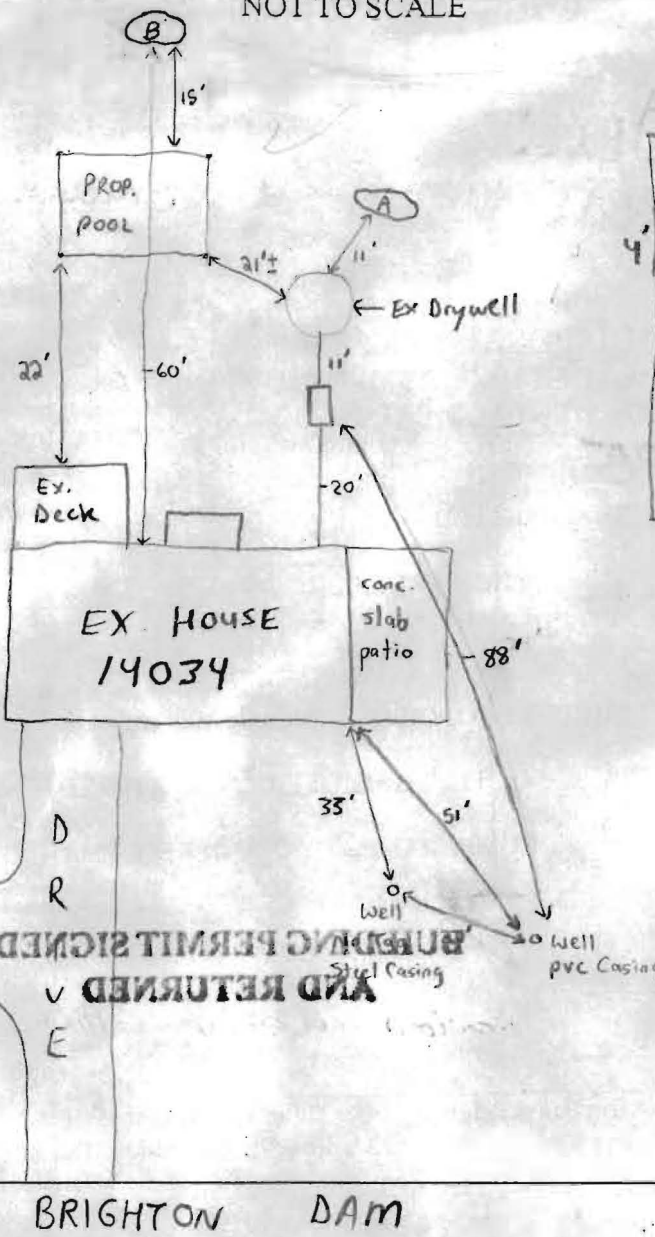

TRENCH/DRAINFIELD DATA		
WIDTH	INLET	BOTTOM
NA	NA	NA
NUMBER OF TRENCHES		NA
TOTAL LENGTH		NA
ABSORPTION AREA		NA
DISTRIBUTION BOX LEVEL		NA
DISTRIBUTION BOX BAFFLE		NA
DISTRIBUTION BOX PORT		NA

SEPTIC TANK DATA	
SEPTIC TANK 1 LEVEL	✓
CAPACITY	750-1000 GAL
SEAM LOC	mid
TANK LID DEPTH	1-2'
BAFFLES	OK Outlet Baffle
BAFFLE FILTER	NA
MANHOLE LOC	No
6" PORT LOC	
WATERTIGHT TEST	NA
SEPTIC TANK 2 LEVEL	NA
CAPACITY	
SEAM LOC	
TANK LID DEPTH	
BAFFLES	
BAFFLE FILTER	
MANHOLE LOC	
6" PORT LOC	
WATERTIGHT TEST	

Repl. w/ PVC

PRE-CONSTRUCTION

SYSTEM EVAL
 INSTALLATION 1/28/03 - MET CONTRACTOR AT SITE, EXISTING TANK & DRYWELL EXCAVATED, TANK IN GOOD CONDITION, DRYWELL HAS ABOUT 6-7' OF EFFLUENT & IS APPROXIMATELY 10-12' DEEP, PERC HOLE (A) NEAR EX. DRYWELL - CONFIRMS THE PRESENCE OF GOOD SOILS, PERC HOLE (B) ESTABLISHES SOME REPAIR AREA FOR FUTURE TRENCHES ON CONTOUR, OK TO APPROVE BP FOR POOL. (SRK)

*IT WILL BE NECESSARY TO DETERMINE LOCATION OF WELL FOR HOUSE IMMEDIATELY BEHIND 14034 PRIOR TO FUTURE REPAIR FOR 14034

FINAL INSPECTOR Steven R. Krieg DATE OF APPROVAL 1/28/03
 EVALUATING _____ EVALUATION _____

