

PERMIT

SEWAGE DISPOSAL SYSTEM

MARYLAND STATE DEPARTMENT OF HEALTH

HOWARD COUNTY

ELLICOTT CITY

DISTRICT 4

INDEXED

DATE 9/23/72

*1425/72
OK*

Donald Pickett IS PERMITTED TO INSTALL ALTER X

ADDRESS Watersville Road, MS. Hwy. 211 PHONE 833-0543

A SEWAGE DISPOSAL SYSTEM LOCATED AT _____

SUBDIVISION _____ ROAD Pearl Road LOT _____

PROPERTY OWNER Clyde Korfak off Rt. 27 - lot house on left of Pearl
Shop Rd.

ADDRESS _____

SPECIFICATIONS

DRAIN FIELD _____ DEPTH _____ FEET, BOTTOM AREA _____ SQ. FT.

SEEPAGE PITS _____ ABSORBENT SIDE-WALL AREA _____ SQ. FT.

SEPTIC TANK CAPACITY _____ GALLONS

FOR GARBAGE GRINDER, INCREASE DISPOSAL AREA AND TANK CAPACITY SEE _____

OTHER SEPAE - 30 ft. trench - 10 ft. deep with 4 ft. stone - 2 ft. wide

CALL FOR INSPECTION WHEN TRENCH IS OPENED BEFORE ANY GRAVEL IS INSTALLED.

PLANS APPROVED BY D. W. Moraghan DATE 9/27/72

FILL SEPTIC TANK AND DISTRIBUTION BOX WITH WATER BEFORE CALLING FOR AN INSPECTION. COVER NO WORK UNTIL INSPECTED AND APPROVED.

NEITHER THE HOWARD COUNTY COMMISSIONERS NOR THE HEALTH DEPARTMENT IS RESPONSIBLE FOR THE SUCCESSFUL OPERATION OF ANY SYSTEM.

*P
17358*

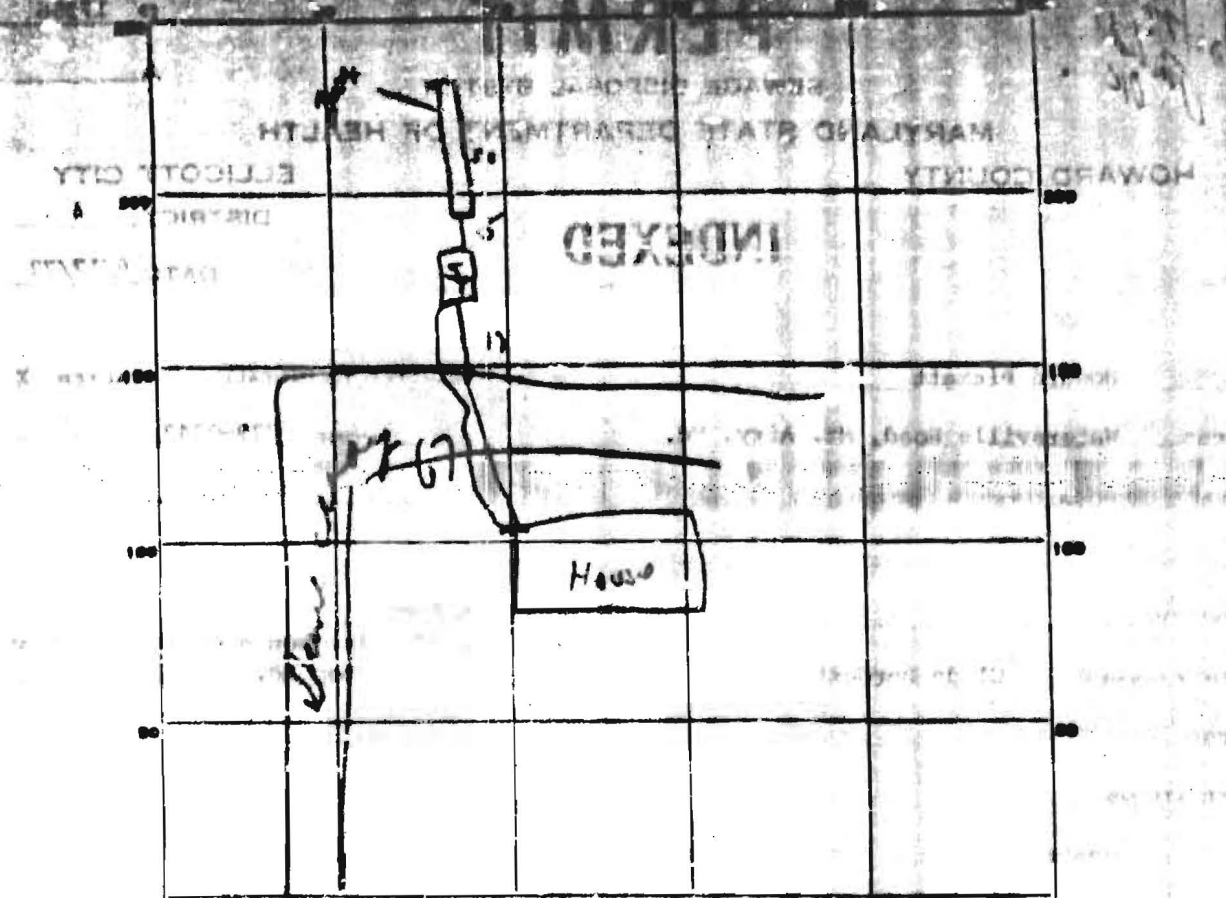

INDICATE NORTH - NAME ADJOINING ROADWAY AS BASE LINE.
Penn Shop P.

PERMIT CARD OK

SEPTIC TANK, LEVEL OK CLEANOUTS 0/4

DISTRIBUTION BOX, LEVEL _____

TILE FIELD, DEPTH 10 FT. TRENCH WIDTH 2 FT.

GRAVEL DEPTH 84 IN. TOTAL LENGTH 50 FT.

NUMBER OF TRENCHES _____ TOTAL BOTTOM AREA 100

SEEPAGE PITS, INSIDE DIAMETER _____ FT. DEPTH BELOW INLET _____ FT.

ABSORBENT AREA 600 SQ. FT. *in trench*

REMARKS *12/26/72 - pit to put gravel in trench - install cleanout pipe on tank to grade level - install all pipe then call for final when job is complete to DEP*

1/11/73 - mechanical job - house now connected to trench tank + trench cut up into 2 trenches

DATE SYSTEM APPROVED 1/11/73 INSPECTOR Dwight M. ...



Maryland Department of Assessments and Taxation
HOWARD COUNTY
Real Property Data Search

[Go Back](#)
[View Map](#)
[New Search](#)

District - 04 Account Number - 310721

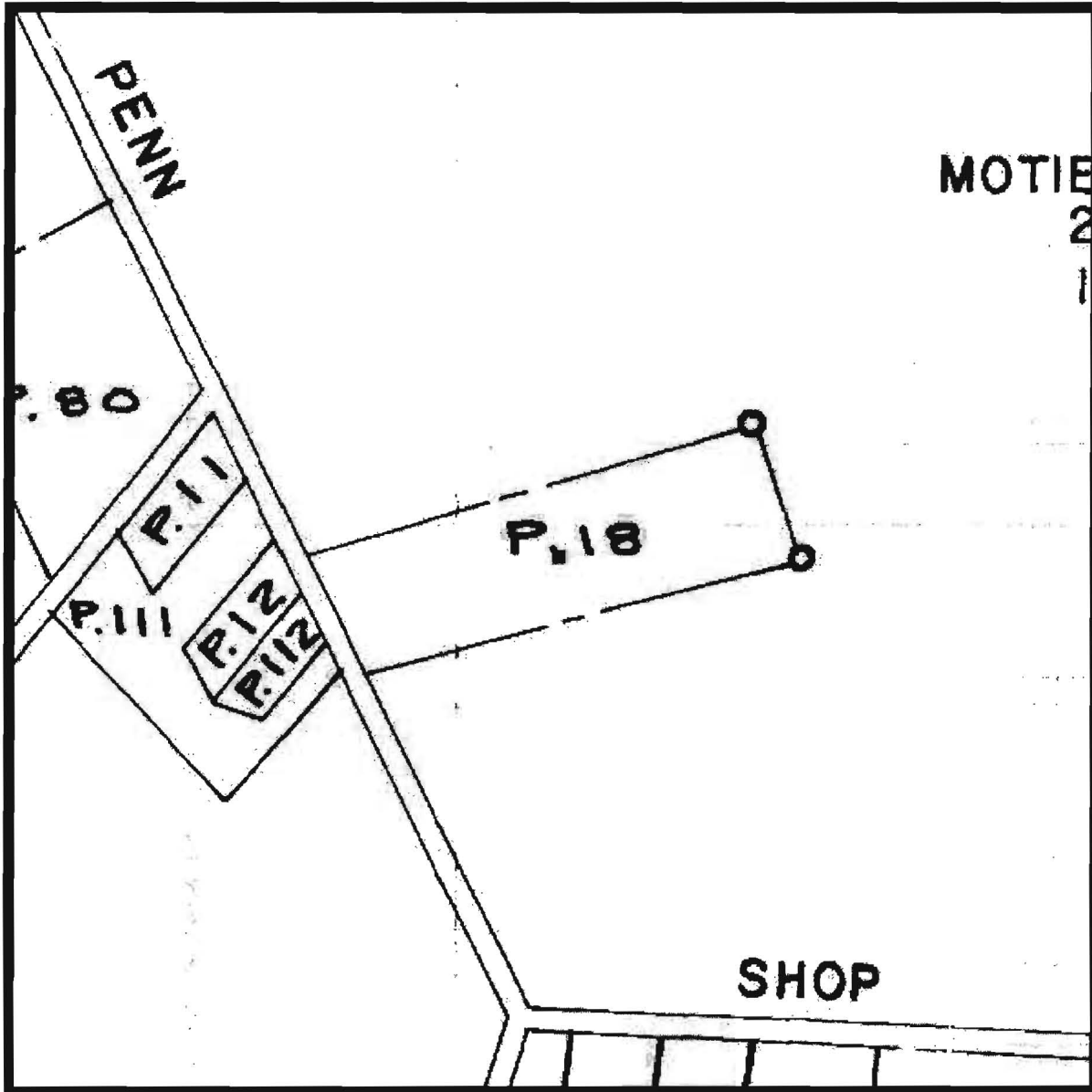

Property maps provided courtesy of the Maryland Department of Planning ©2001.
For more information on electronic mapping applications, visit the Maryland Department of Planning
web site at www.mdp.state.md.us

[Click here for a plain text ADA compliant screen.](#)

| | | |
|---|---|---|
|  | Maryland Department of Assessments and Taxation HOWARD COUNTY Real Property Data Search | Go Back View Map New Search |
|---|---|---|

Account Identifier: District - 04 Account Number - 310721

Owner Information

| | | | |
|-------------------------|--|-----------------------------|----------------------|
| Owner Name: | RAY ROLAND RAY JANET | Use: | RESIDENTIAL |
| | | Principal Residence: | NO |
| Mailing Address: | 26804 HOWARD CHAPEL DR DAMASCUS MD 20872-1247 | Deed Reference: | 1) / 5166/ 533 2) |

Location & Structure Information

| | | |
|-------------------------------------|---------------|----------------------------------|
| Premises Address | Zoning | Legal Description |
| 18790 PENN SHOP RD MT AIRY 21771 | RCDEO | 2.25 ACRES 18790 PENN SHOP RD |

| | | | | | | | | | |
|-----|------|--------|--------------|-------------|---------|-------|-----|-------|-----------|
| Map | Grid | Parcel | Sub District | Subdivision | Section | Block | Lot | Group | Plat No: |
| 6 | 3 | 18 | | | | | | 81 | Plat Ref: |

| | | |
|--------------------------|----------------------------------|--------------------------------|
| Special Tax Areas | Town Ad Valorem Tax Class | NO A/V, NO M/P, RURAL FIRE TAX |
|--------------------------|----------------------------------|--------------------------------|

| | | | |
|--------------------------------|----------------------|---------------------------|-------------------|
| Primary Structure Built | Enclosed Area | Property Land Area | County Use |
| 1900 | 1,532 SF | 2.25 AC | |

| | | | |
|----------------|-----------------|---------------|------------------|
| Stories | Basement | Type | Exterior |
| 2 | NO | STANDARD UNIT | ASBESTOS SHINGLE |

Value Information

| | Base Value | Value As Of 01/01/2002 | Phase-in Assessments As Of 07/01/2002 | Phase-in Assessments As Of 07/01/2003 |
|---------------------------|------------|------------------------|---------------------------------------|---------------------------------------|
| Land: | 82,500 | 102,500 | | |
| Improvements: | 44,600 | 51,980 | | |
| Total: | 127,100 | 154,480 | 136,226 | 145,352 |
| Preferential Land: | 0 | 0 | 0 | 0 |

Transfer Information

| | | |
|------------------------------------|---------------------------|-------------------------|
| Seller: MCTHENIA MARY JANE | Date: 08/07/2000 | Price: \$112,000 |
| Type: NOT ARMS-LENGTH | Deed1: / 5166/ 533 | Deed2: |
| Seller: BURDETTE CLYDE & WF | Date: 03/09/2000 | Price: \$0 |
| Type: NOT ARMS-LENGTH | Deed1: / 5032/ 644 | Deed2: |
| Seller: | Date: | Price: |
| Type: | Deed1: | Deed2: |

Exemption Information

| | | | |
|-----------------------------------|--------------|------------|------------|
| Partial Exempt Assessments | Class | 07/01/2002 | 07/01/2003 |
| County | 000 | 0 | 0 |
| State | 000 | 0 | 0 |
| Municipal | 000 | 0 | 0 |

| | |
|-----------------------|-------------------------------|
| Tax Exempt: NO | Special Tax Recapture: |
| Exempt Class: | * NONE * |