

LAYOUT \_\_\_\_\_ INSP 4 \_\_\_\_\_  
INSP 2 \_\_\_\_\_ INSP 5 \_\_\_\_\_  
INSP 3 \_\_\_\_\_ INSP 6 \_\_\_\_\_

ISSUE DATE: 11/17/05

P 523688

APPROVAL DATE: 10/19/06

A 518503

# PERMIT

INDEXED

TAX ID #05-344026

## ON-SITE SEWAGE DISPOSAL SYSTEM HOWARD COUNTY HEALTH DEPARTMENT BUREAU OF ENVIRONMENTAL HEALTH

Fogle's Septic Clean, Inc. IS PERMITTED TO INSTALL  ALTER

ADDRESS: 580 Obrecht Rd., Sykesville 21784 PHONE NUMBER: 410-795-5670

SUBDIVISION: Beaufort Park Estates LOT NUMBER: 9

ADDRESS: 8532 Edenton Road PROPERTY OWNER: Miriam Brescia

SEPTIC TANK CAPACITY (GALLONS): 1250 OUTLET BAFFLE FILTER REQUIRED

PUMP CHAMBER CAPACITY (GALLONS): 1250 COMPARTMENTED TANK REQUIRED

NUMBER OF BEDROOMS: 4

SQUARE FEET PER BEDROOM: 180

LINEAR FEET OF TRENCH REQUIRED: 101 HOUSE SERVED BY PUBLIC WATER

TRENCHES:	Trench to be 3.0 feet wide. Inlet <sup>4</sup> 1.5 feet below original grade. Bottom maximum depth 8.0 feet below original grade. Effective area begins at 4.0 feet below original grade. 4.0 feet of stone below distribution pipe.
LOCATION:	Approved SDA located on Lot #2 on Beaufort Drive. Lot #2 & Lot #9 sharing septic system.
NOTES:	Pretreatment system-nitrogen reduction installed after building construction and before U&O. Before filling in Lot#2 call for a trench inspection.

PLANS APPROVED: Sara Fegel Reviewed by: \_\_\_\_\_ DATE: 11/15/05

NOTES: PERMIT VOID AFTER 2 YEARS  
CONTRACTOR IS RESPONSIBLE FOR SCHEDULING A PRE-CONSTRUCTION INSPECTION FOR ALL INSTALLATIONS  
WATERTIGHT SEPTIC TANKS REQUIRED  
ALL PARTS OF SEPTIC SYSTEM SHALL BE 100 FEET FROM ANY WATER WELL UNLESS SPECIFICALLY AUTHORIZED  
MANHOLE RISERS REQUIRED ON ALL SEPTIC TANKS AND PUMP CHAMBERS UNLESS SPECIFICALLY AUTHORIZED  
CONTRACTOR RESPONSIBLE FOR COMPLIANCE WITH APPLICABLE REGULATIONS, GUIDELINES AND THE TERMS OF THIS PERMIT

**NEITHER THE HOWARD COUNTY COUNCIL NOR THE HEALTH DEPARTMENT IS  
RESPONSIBLE FOR THE SUCCESSFUL OPERATION OF ANY SYSTEM  
PERMITTEE RESPONSIBLE FOR OBTAINING FINAL APPROVAL ON THIS PERMIT  
ALL 410-313-1771 FOR INSPECTION OF SEPTIC SYSTEM**

**BUILDING PERMIT SIGNED**

**AND RETURNED**

6/22/06 B 00160127 1000 GAL 4G LP TANK

A 518503

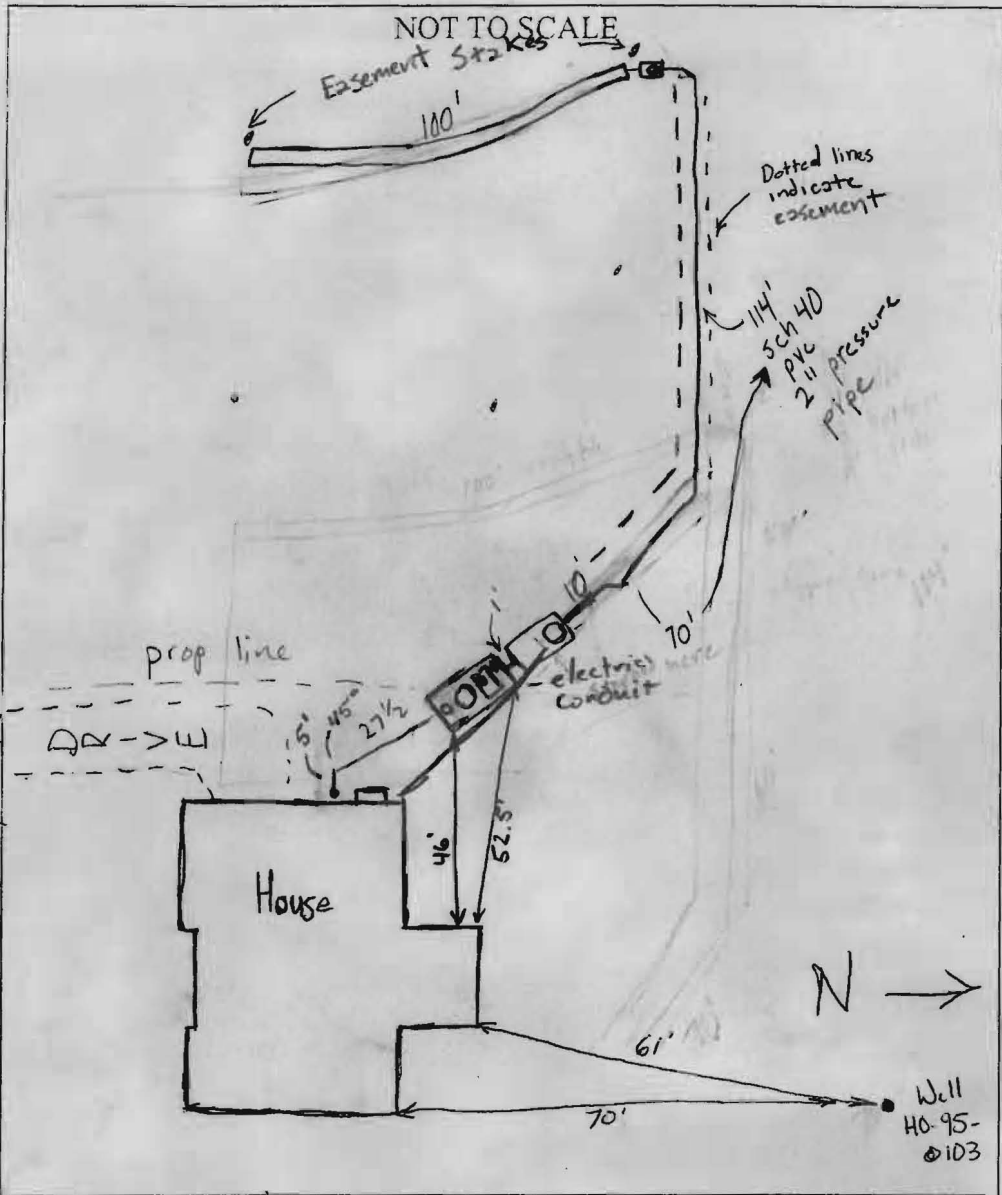

TRENCH/DRAINFIELD DATA		
WIDTH	INLET	BOTTOM
3'	4'	8'
NUMBER OF TRENCHES	1	
TOTAL LENGTH	100'	
ABSORPTION AREA	400 + Bottom	
DISTRIBUTION BOX LEVEL	yes	
DISTRIBUTION BOX BAFFLE	yes	
DISTRIBUTION BOX PORT	yes	

SEPTIC TANK DATA		
SEPTIC TANK 1 LEVEL <u>yes</u>		
W/	CAPACITY	1500 GAL
M	SEAM LOC	Top
3	TANK LID DEPTH	3-4'
two	BAFFLES	Yes
to	BAFFLE FILTER	N/A
be	MANHOLE LOC	MID
75	6" PORT LOC	Outlet
D	WATERTIGHT TEST	N/A
3	SEPTIC TANK 2 LEVEL <u>Yes</u>	
0	CAPACITY	1500 GAL
	SEAM LOC	Top
	TANK LID DEPTH	4-5' to be reduced
	BAFFLES	N/A
	BAFFLE FILTER	N/A
	MANHOLE LOC	Outlet
	6" PORT LOC	N/A
	WATERTIGHT TEST	N/A

10/19/06 Streamline finished system (BB)

PRE-CONSTRUCTION 12/20/2005 Layout install 1 trench on contour across topmost portion of the easement (GAC) 12/22/2005

INSTALLATION Trench finished ok to backfill trench (GAC) D-Box installed along with some 2" line. this to be left open until tied into w/ more 2". (GAC) 12/23/05 Another 130' of 2" pvc installed to near the property line within access easement. OK to cover until work to be resumed after foundation/framing complete. (GAC)

OK for BP Signature. 4/27/06 Microfast Tank and pump tank set, everything connected, needs house connection, pump & alarm and startup test. (GAC) 10/10/06 Pump and high water alarm

FINAL INSPECTOR B. Baker DATE OF APPROVAL 10/19/2006

working. aerator working properly. aerator alarm not working. Needs to be hooked up by Streamline. (BB)