

NOTES:

1. This plat is not to be relied upon for the established or location of fences, garages, buildings, or other existing or future improvements.
2. This plat does not provide for accurate identification of property boundary lines, but such identification may not be required for the transfer of title or securing financing or refinancing.
3. This plat was prepared in accordance with the plat of subdivision and/or deed as recorded in the Land Records of the county in which the property is located.
4. The title report was not furnished; The property shown hereon is subject to easements and right-of-way(s) of record.
5. The location and size of improvements shown hereon are approximate and are for informational purposes only and details of the site not shown hereon are not considered significant by this office and thus are not shown.
6. Legend: OH.- building overhang; D.- deck; S.- stoop; W.- walkway; P.- patio; AW.- aerial wire(s); P.L.- property line; BW.- bay window; CHM.- chimney; WW.- window well; SW.- stairwell; G.- gas meter; OR.- oriel.
7. Accuracy of apparent setback distance = 2:1

Note: This property lies within Flood Zone C, an area of Minimal flooding, as established by the National Flood Insurance Program, (F.E.M.A.)

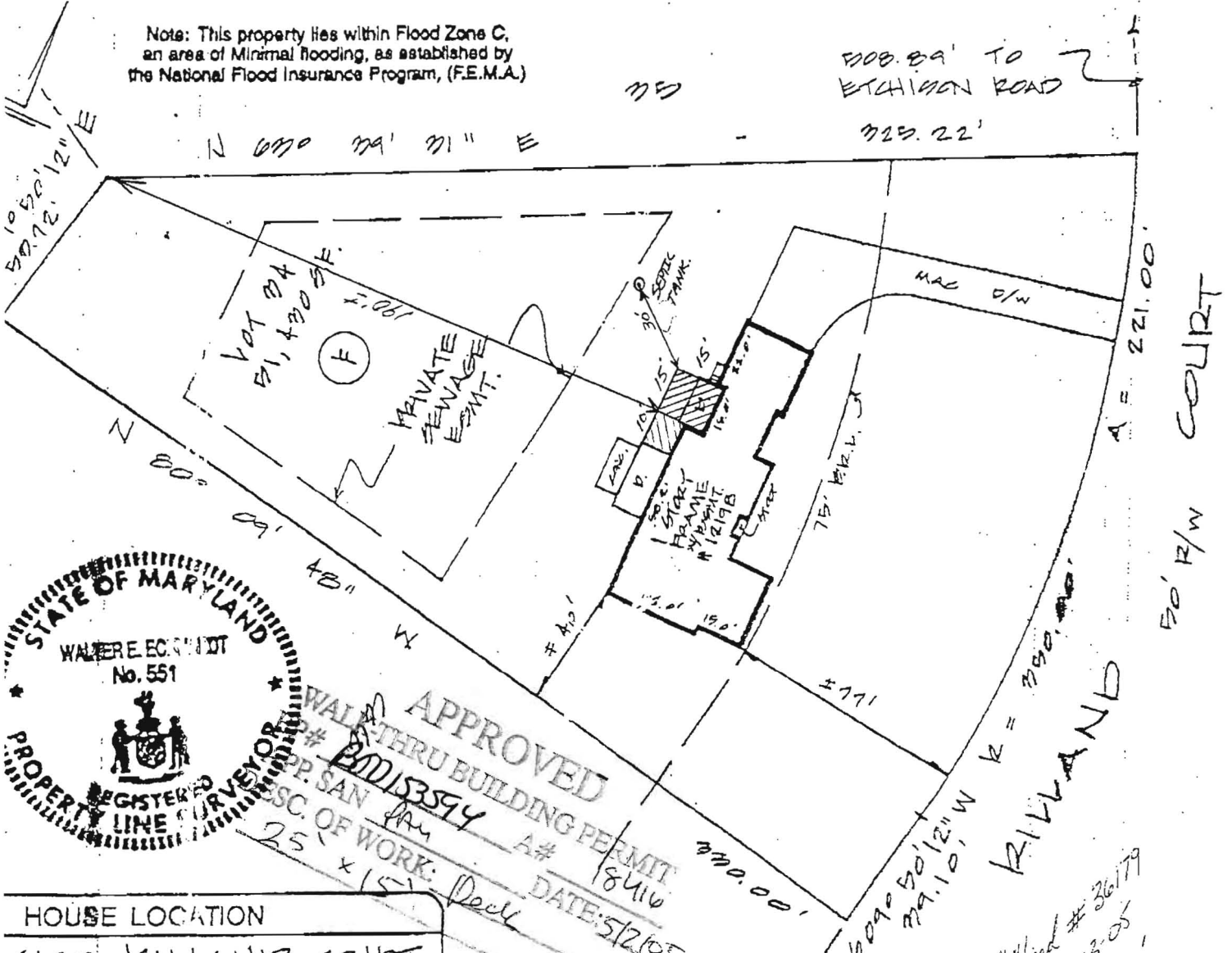

APPROVED
 THROUGH BUILDING PERMIT
 # 20153594
 DATE: 5/2/05
 A# 18410

HOUSE LOCATION
 2198 RIVVAND COURT
 LOT 24, BLOCK F
 WOODMARIK
 SECTION 11
 SHEET 2 OF 2
 PAT. BOOK No. 29, PG. 64
 3RD District
 Howard County, Maryland

C.P. No. 4400AA 0022 B
 MAP KEY: DEC 4, 1980

CERTIFICATION:
 I certify, to the best of my knowledge and belief, that the existing visible improvements shown hereon have been established by accepted land surveying practices and that unless otherwise shown there are no visible encroachments.
 [Signature]
 Walter E. Eckhardt
 Property Line Surveyor, Md. Reg. No. 551

MSI METROPOLITAN SURVEYING, INC.
 11262 Georgia Ave. • Suite 102
 Wheaton, MD 20902
 (301) 929-8199
 FAX: (301) 929-8197