

# PERMIT

P 30445

A 30375

SEWAGE DISPOSAL SYSTEM

MARYLAND STATE DEPARTMENT OF HEALTH\*

HOWARD COUNTY

ELLICOTT CITY

DISTRICT 4th

INDEXED

DATE 1/3/80

INSTALLED  
NOT APPROVED

1/4/80 (CW)

Thompson's Plumbing & Heating.

IS PERMITTED TO INSTALL  ALTER

ADDRESS \_\_\_\_\_ PHONE 465-8818

SUBDIVISION \_\_\_\_\_ ROAD 14898 Bushy Park Road LOT \_\_\_\_\_

PROPERTY OWNER Dorothy Hackett

ADDRESS \_\_\_\_\_

SPECIFICATIONS 3 bedrooms (only 2 bedrooms in house)

SEPTIC TANK CAPACITY 1000 GALLONS

DRAIN FIELD \_\_\_\_\_ DEPTH \_\_\_\_\_ FEET, BOTTOM AREA \_\_\_\_\_ SQ. FT.

DEEP TRENCH \_\_\_\_\_ DEPTH \_\_\_\_\_ FEET, BOTTOM AREA \_\_\_\_\_ SQ. FT.

SEEPAGE PITS \_\_\_\_\_ ABSORBENT SIDE-WALL AREA \_\_\_\_\_ SQ. FT.

INLET PIPE 5 FT. BELOW ORIGINAL GRADE. MAXIMUM DEPTH 11 FT. BELOW ORIGINAL GRADE

EFFECTIVE DEPTH AT \_\_\_\_\_ FT. BELOW ORIGINAL GRADE.

LOCATE DISPOSAL AREA \_\_\_\_\_ FT. FROM \_\_\_\_\_ LOT LINE AND \_\_\_\_\_ FT. FROM \_\_\_\_\_ LOT LINE AS SEEN WHEN

FACING LOT FROM

OLD HOUSE DEMOLISHED

Locate the dry well 80 ft. from the rear of the existing house and 55 ft. from the right property line as seen from the road. The invert will enter the dry well at 5 ft. below original grade and the maximum depth of the dry well will not exceed 11 ft. below original grade. The dry well will be constructed 13' X 13' square for a sidewall area of 312 sq. ft. Begin the trench after a 5 ft. earth buffer. The trench will be dug 2 ft. wide, 11 ft. deep, 15 ft. long, and contain 6 ft. of stone. The trench will follow the contour of the land.

PLANS APPROVED BY Robert A. DeMarco and Donald W. Monaghan DATE 10/26/79

COVER NO WORK UNTIL INSPECTED AND APPROVED.

NEITHER THE HOWARD COUNTY COUNCIL NOR THE HEALTH DEPARTMENT IS RESPONSIBLE FOR THE SUCCESSFUL OPERATION OF ANY SYSTEM.

NOTE: IF TRENCH IS USED CALL FOR INSPECTION BEFORE PLACING GRAVEL IN TRENCH.

NOTE: NO DRY WELL SHALL EXCEED 15 FOOT IN DIAMETER.

NOTE: ALL PIPE FROM HOUSE TO DISPOSAL AREA MUST BE CAST IRON.

PERMIT VOID AFTER THREE YEARS.

NOTE: INSTALL STAND PIPE ON SEPTIC TANK AND DRY WELL. STAND PIPES MUST BE 6 INCHES IN DIAMETER. CAST IRON, CONCRETE OR TERRA COTTA ACCEPTED.

**\*INSTALLER IS RESPONSIBLE FOR OBTAINING FINAL APPROVAL ON THIS PERMIT.**

A 30375

19  
6  
114

55  
6  
330

67  
114  
179

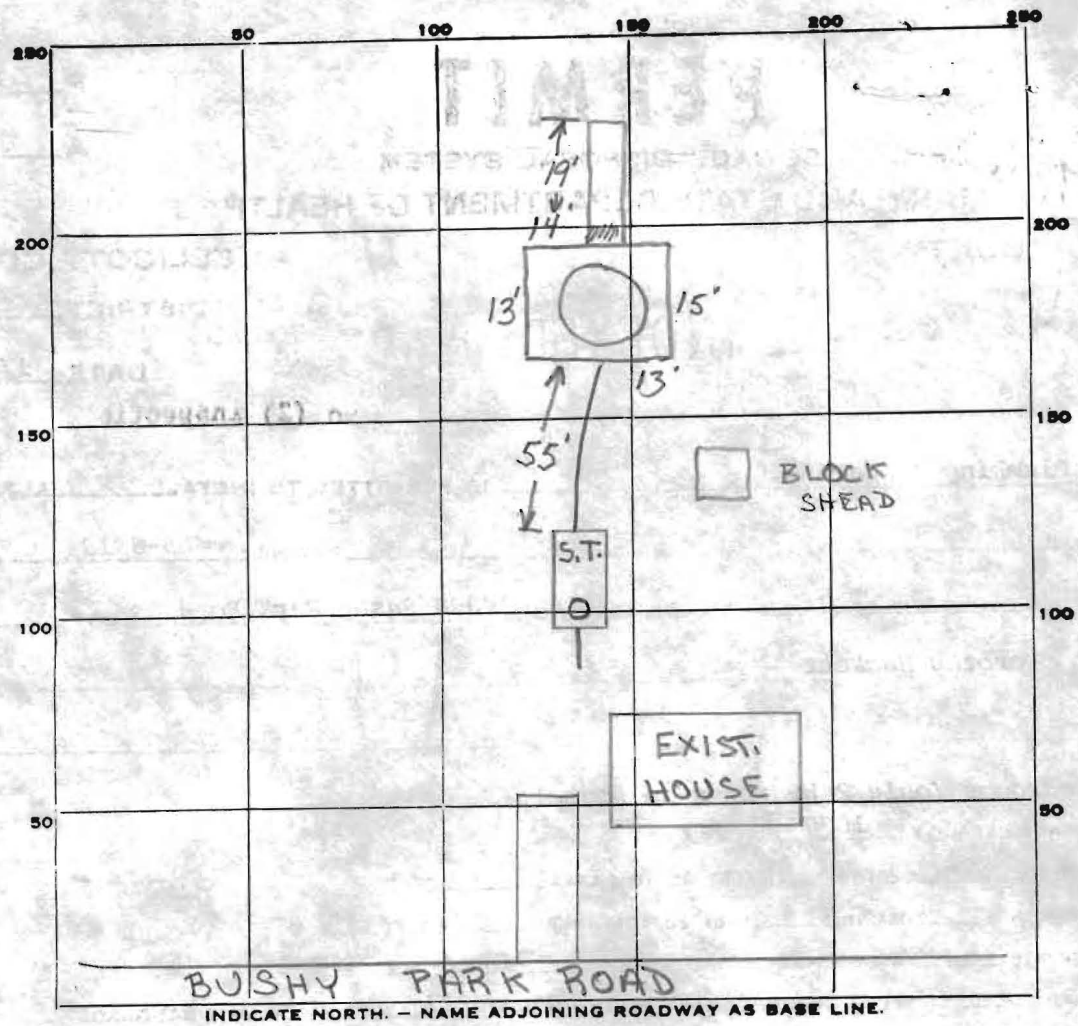

BUSHY PARK ROAD  
INDICATE NORTH. - NAME ADJOINING ROADWAY AS BASE LINE.

PERMIT CARD OK

SEPTIC TANK, LEVEL ✓

CLEANOUTS	SEPTIC TANK	DRY WELL
	TERRA COTTA ✓	TERRA COTTA ✓

DISTRIBUTION BOX, LEVEL N.A.

TILE FIELD, DEPTH 11 FT. TRENCH WIDTH 2 FT.

GRAVEL DEPTH \_\_\_\_\_ IN. TOTAL LENGTH 19 FT.

NUMBER OF TRENCHES 1 TOTAL BOTTOM AREA 38

SEEPAGE PITS, INSIDE DIAMETER 55 FT. DEPTH BELOW INLET 6 FT.

ABSORBENT AREA 330 SQ. FT. + one side of trench

REMARKS 1/4/80 - OK TO ADD GRAVEL TO TRENCH - CALL WHEN READY R.D.

1 install plugs on cleanout (bats)

2 install paper in trench & cover

3 call for final insp when house is connected to tank

NO FURTHER INSP AS OF 7/95 - INDEX AS IF APPROVED (CW)

DATE SYSTEM APPROVED 1/4/80

INSPECTOR R.D. / CW