

# PERMIT

P 01406

SEWAGE DISPOSAL SYSTEM

A 00997

MARYLAND STATE DEPARTMENT OF HEALTH

HOWARD COUNTY

ELLICOTT CITY

*Approved File 7/27/59*

DISTRICT 6

**INDEXED**

DATE 7-20-59

Allen Bahr IS PERMITTED TO INSTALL  ALTER

ADDRESS 1241 Sulphur Spring Rd., Arbutus 2<sup>nd</sup>, Md. PHONE Ci. 2-6770

A SEWAGE DISPOSAL SYSTEM LOCATED AT

SUBDIVISION Donleigh ROAD Greenleigh Dr. LOT 5 E

PROPERTY OWNER Mt. Rolling Development Corp.

ADDRESS Court Ave., Ellicott City

SPECIFICATIONS

DRAIN FIELD  DEPTH FEET, BOTTOM AREA 300 SQ. FT.

SEEPAGE PITS ABSORBENT SIDE-WALL AREA SQ. FT.

SEPTIC TANK CAPACITY 750 GALLONS

FOR GARBAGE GRINDER, INCREASE DISPOSAL AREA 22% & TANK CAPACITY 50%

OTHER Place part of the tile field 90 - 100 feet from Greenleigh Drive near the center of the lot.

PLANS APPROVED BY Raymond Hodges DATE 5-26-59

FILL SEPTIC TANK AND DISTRIBUTION BOX WITH WATER BEFORE CALLING FOR AN INSPECTION. COVER NO WORK UNTIL INSPECTED AND APPROVED.

NEITHER THE HOWARD COUNTY COMMISSIONERS NOR THE HEALTH DEPARTMENT IS RESPONSIBLE FOR THE SUCCESSFUL OPERATION OF ANY SYSTEM.

100997

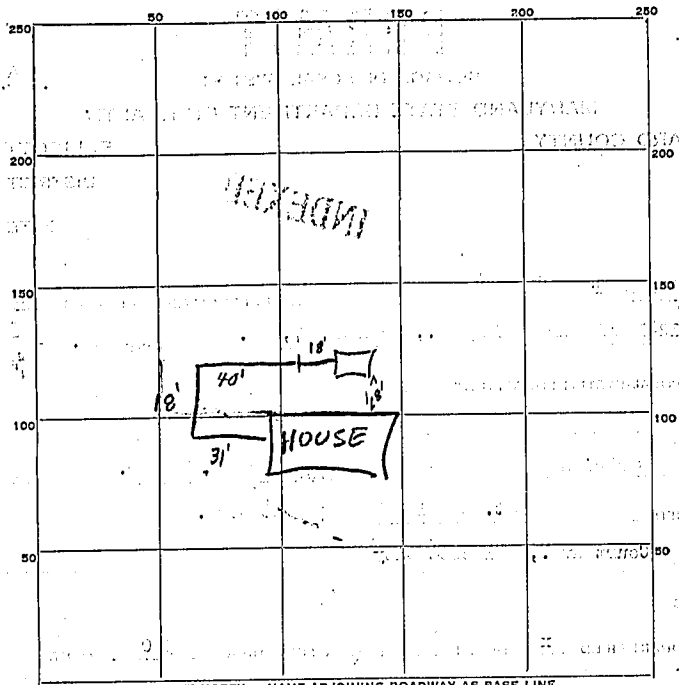

INDICATE NORTH. - NAME ADJOINING ROADWAY AS BASE LINE.

40  
18  
31  
89  
3.2  
178

PERMIT CARD YES man present 267

SEPTIC TANK, LEVEL OK 750 CLEANOUTS OK 8" 2848

DISTRIBUTION BOX, LEVEL \_\_\_\_\_

TILE FIELD, DEPTH 3-6 FT. TRENCH WIDTH 3.2 FT.

GRAVEL DEPTH 1 IN. TOTAL LENGTH 89 FT.

NUMBER OF TRENCHES 1 TOTAL BOTTOM AREA 285

SEEPAGE PITS, INSIDE DIAMETER \_\_\_\_\_ FT. DEPTH BELOW INLET \_\_\_\_\_ FT.

ABSORBENT AREA \_\_\_\_\_ SQ. FT.

REMARKS 2-3" over pipe at least 2' under pipe  
15 ft between two parallel parts of  
Trench  
Lot to be graded.  
Location OK

DATE SYSTEM APPROVED 7/27/59 INSPECTOR Raymond  
Hodgson