

11/7/02 - 11AM 10/14/03 - 2:30

PUB. SEWER STATUS VERIFIED BY SRVNA

ISSUE DATE: 10/29/2002
APPROVAL DATE: 10/14/03

PERMIT INDEXED

P 517979-B
A REPAIR

ON-SITE SEWAGE DISPOSAL SYSTEM HOWARD COUNTY HEALTH DEPARTMENT BUREAU OF ENVIRONMENTAL HEALTH

04-332857

Fogles Septic Clean, Inc w/spunky IS PERMITTED TO INSTALL ALTER

ADDRESS: 580 Obrecht Road, Sykesville PHONE NUMBER: 410-795-5670

SUBDIVISION: Forsythe Heights LOT NUMBER: 14-C

ADDRESS: 1389 Hoods Mill Road PROPERTY OWNER: John Credle

SEPTIC TANK CAPACITY (GALLONS): Ex 1000 gal

PUMP CHAMBER CAPACITY (GALLONS): N/A

NUMBER OF BEDROOMS: 3

SQUARE FEET PER BEDROOM: 210

LINEAR FEET OF TRENCH REQUIRED: 100'

TRENCHES:	Trench to be <u>3</u> feet wide. Inlet <u>3</u> feet below original grade. Bottom maximum depth <u>6</u> feet below original grade. Effective area begins at <u>3</u> feet below original grade. <u>3</u> feet of stone below distribution pipe.
LOCATION:	<u>(2) 50' Trenches at (C) perc hole on contour</u>
PURPOSE:	Existing septic system has failed. Call for inspection when ground is opened so sanitarian can recommend repair.

PLANS APPROVED: [Signature] DATE: 11/7/02

- NOTE: PERMIT VOID AFTER 2 YEARS
- NOTE: CONTRACTOR RESPONSIBLE FOR SCHEDULING A PRE-CONSTRUCTION INSPECTION FOR ALL INSTALLATIONS
- NOTE: WATERTIGHT SEPTIC TANKS REQUIRED
- NOTE: ALL PARTS OF SEPTIC SYSTEM SHALL BE 100 FEET FROM ANY WATER WELL
- NOTE: MANHOLE RISERS REQUIRED ON ALL SEPTIC TANKS AND PUMP CHAMBERS

NEITHER THE HOWARD COUNTY COUNCIL NOR THE HEALTH DEPARTMENT IS RESPONSIBLE FOR THE SUCCESSFUL OPERATION OF ANY SYSTEM PERMITTEE RESPONSIBLE FOR OBTAINING FINAL APPROVAL ON THIS PERMIT CALL 410-313-2640 FOR INSPECTION OF SEPTIC SYSTEM

517979-B

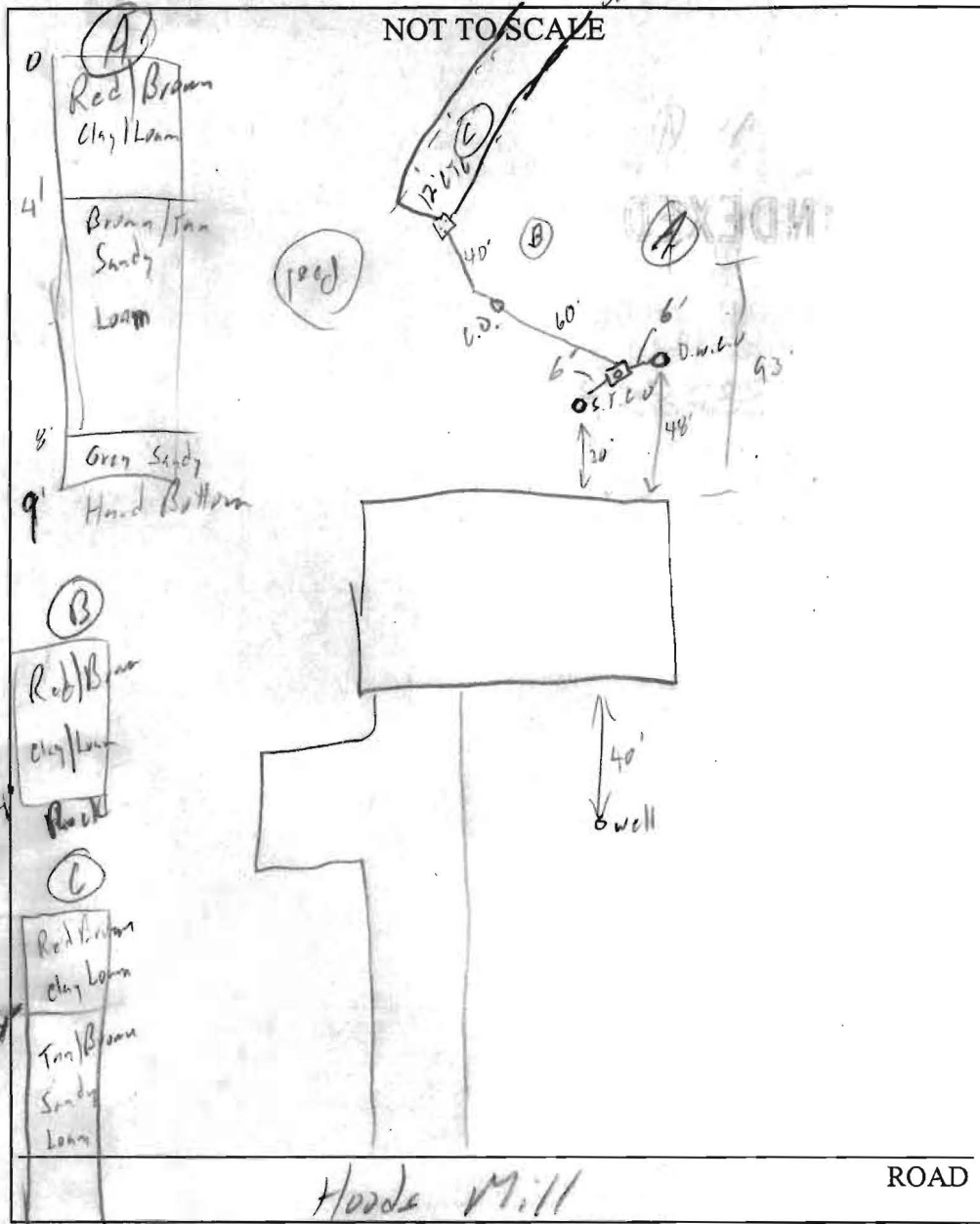

TRENCH/DRAINFIELD DATA		
WIDTH	INLET	BOTTOM
3'	3'	6'
NUMBER OF TRENCHES		2
TOTAL LENGTH		100'
ABSORPTION AREA		300sq
DISTRIBUTION BOX LEVEL		<input checked="" type="checkbox"/>
DISTRIBUTION BOX BAFFLE		<input checked="" type="checkbox"/>
DISTRIBUTION BOX PORT		<input checked="" type="checkbox"/>

SEPTIC TANK DATA	
SEPTIC TANK 1 LEVEL	
CAPACITY	Ex 1000 GAL
SEAM LOC	Mid
TANK LID DEPTH	2'
BAFFLES	Back
BAFFLE FILTER	
MANHOLE LOC	Back
6" PORT LOC	
WATERTIGHT TEST	
SEPTIC TANK 2 LEVEL	
CAPACITY	_____ GAL
SEAM LOC	_____
TANK LID DEPTH	_____
BAFFLES	_____
BAFFLE FILTER	_____
MANHOLE LOC	_____
6" PORT LOC	_____
WATERTIGHT TEST	_____

15' PRE-CONSTRUCTION 11/7/02 - See Perc Sheet

INSTALLATION 10/14/03 - Install per specs. Place a speed lever to D.W. side turn all the way up. DK to cover all work (SB)

FINAL INSPECTOR *[Signature]* DATE OF APPROVAL 10/14/03

PERMIT

SEWAGE DISPOSAL SYSTEM

MARYLAND STATE DEPARTMENT OF HEALTH

HOWARD COUNTY

INDEXED

ELLIOTT CITY

DISTRICT 04

DATE 6/19/75

OFF. 10-10-70
P. 24095
A. 21516

Wanaco Construction Company

IS PERMITTED TO INSTALL ALTER

ADDRESS 2111 Rockwell Avenue, Baltimore, Md. 21228 PHONE 786-8221

A SEWAGE DISPOSAL SYSTEM LOCATED AT _____

SUBDIVISION (Forestyle Heights) ROAD 1350 Route 97 LOT 14C

PROPERTY OWNER John Cudde Cudde

ADDRESS 6827 Fox Meadow Road, Baltimore, Md. 21227 Phone: 244-8388 992-7580

SPECIFICATIONS 3 bedrooms

DRAIN FIELD _____ DEPTH _____ FEET, BOTTOM AREA _____ SQ. FT.

SEEPAGE PITS _____ ABSORBENT SIDE-WALL AREA _____ SQ. FT.

SEPTIC TANK CAPACITY 1500 GALLONS

FOR BARBARE SLINDER, INCREASE DISPOSAL AREA 25% & TANK CAPACITY 50%.

OTHER DRY WELL AND TRENCH - Dry well to have 200 sq. ft. absorbent sidewall area. Inlet at 4 ft. and minimum depth 18 ft. Lucas dry well 25 ft. from rear of lot. Trench to be 40 ft. long for a sidewall area of 200 sq. ft. Trench to run through the front of lot. CALL FOR INSPECTION OF TRENCH BEFORE PLACING STONE IN TRENCH.

NOTE: ALL PIPE MUST BE TO DISPOSAL SYSTEM MUST BE CAST IRON. PERMIT VOID AFTER THREE YEARS.

NOTE: INSTALL STAIN PIPE ON SEPTIC TANK AND DRY WELL. STAIN PIPE MUST BE 6 INCHES IN DIAMETER. CAST IRON, CONCRETE OR TERRA COTTA ACCEPTED.

PLANS APPROVED BY David J. O'Neill DATE 6/19/75

FILL SEPTIC TANK AND DISTRIBUTION BOX WITH WATER BEFORE CALLING FOR AN INSPECTION. COVER NO WORK UNTIL INSPECTED AND APPROVED.

NEITHER THE HOWARD COUNTY COMMISSIONERS NOR THE HEALTH DEPARTMENT IS RESPONSIBLE FOR THE SUCCESSFUL OPERATION OF ANY SYSTEM.

21516

A 81576

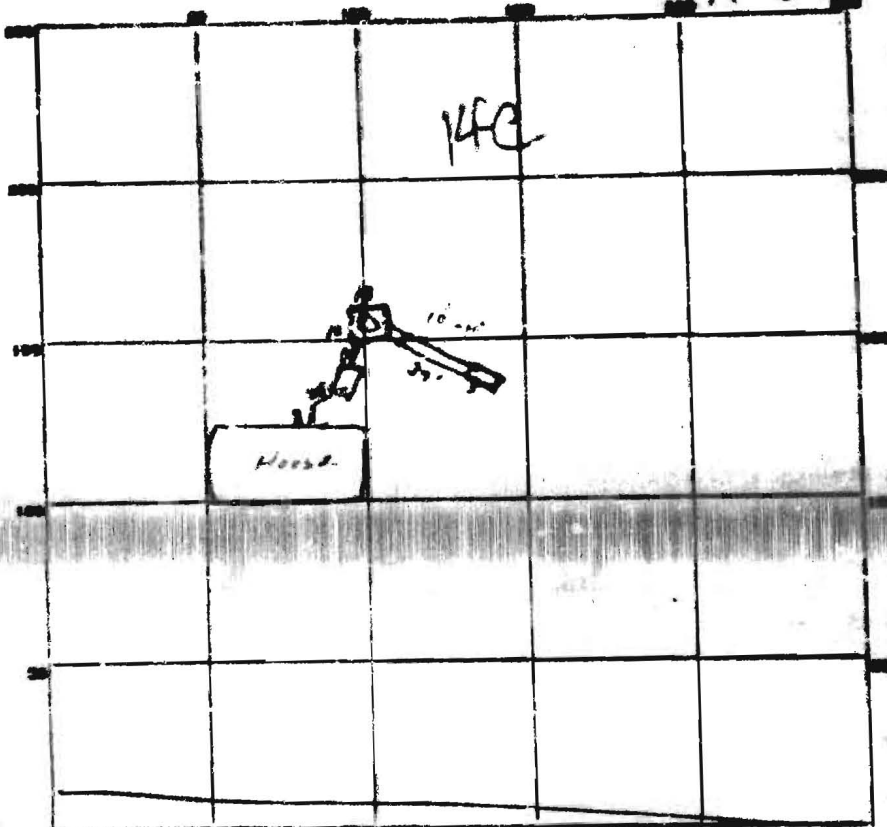

INCREASE WIDTH - ROAD ADJOINING ROADWAY AS EDGE LINE.
AT 97

PERMIT CARD 21

SEPTIC TANK, LEVEL OK

CLEARNOUTS OK

DISTRIBUTION BOX, LEVEL _____

TILE FIELD, DEPTH 11 FT. TRENCH WIDTH 2 FT.

GRAVEL DEPTH 22 IN. TOTAL LENGTH 40 FT.

NUMBER OF TRENCHES 1 TOTAL BOTTOM AREA 80

DEEPAGE PITS, INSIDE DIAMETER 40" FT. DEPTH BELOW INLET 7 FT.

ABSORBENT AREA 280 SQ. FT.
240 sq ft in trench } 520 sq ft

REMARKS _____

DATE SYSTEM APPROVED 12-16-76

INSPECTOR Bill Young