

8/12/77
8/11/77
8/11/77

PERMIT

26395
1976

SEWAGE DISPOSAL SYSTEM

MARYLAND STATE DEPARTMENT OF HEALTH
HOWARD COUNTY

ELLICOTT CITY
DISTRICT SET 1 4th

INDEXED

DATE 7/1/77

Jim Bristleton IS PERMITTED TO INSTALL X ALTER

ADDRESS _____ PHONE _____

A SEWAGE DISPOSAL SYSTEM LOCATED AT _____

SUBDIVISION Charles Beakes - Section II 3259 ROAD Bowman Circle LOT 6D

PROPERTY OWNER John Finnegan

ADDRESS Northwood Road, Ellicott City, MD 21120

SPECIFICATIONS

DRAIN FIELD _____ DEPTH _____ FEET, BOTTOM AREA _____ SQ. FT.

SEEPAGE PITS _____ AROUND PERIMETER SIDE WALL AREA _____ SQ. FT.

SEPTIC TANK CAPACITY 1250 GALLONS

FOR GARBAGE GRINDER, INCREASE DISPOSAL AREA 25% & TANK CAPACITY 50%.

OTHER: The trench will begin at a point 15 feet in from the left property line, 25 feet from the road, 4,200 feet in from the road edge. The trench will follow the contour of the land & be 2 feet wide, 18 feet deep, with 1 foot of stone. There will be no less than 175 feet of sidewall per bedroom.

NOTE: NO TRENCH IS TO EXCEED 75 FEET IN LENGTH, AND ALL TRENCHES ARE TO BE CONNECTED IN SERIES, BRANCHING PIPELINES TO EACH OTHER, AND SPACING NO CLOSER THAN 20 FEET, CENTER TO CENTER.

NOTE: CALL FOR INSPECTION BEFORE GRAVEL IS INSTALLED.

NOTE: INSTALL STAND PIPE ON SEPTIC TANK. STAND PIPES MUST BE 6 INCHES IN DIAMETER. CAST

IRONS APPROVED BY Robert T. Moorefield DATE 2/19/76

IRON, CONCRETE OR TERRA COTTA SCRIPTED. PERMIT VOID AFTER THREE YEARS.

ALL SEPTIC TANK AND DISTRIBUTION BOX WITH WATER BEFORE CALLING FOR AN INSPECTION. COVER NO WORK UNTIL INSPECTED AND APPROVED.

NOTE: ALL PIPE FROM HOUSE TO DISPOSAL AREA MUST BE CAST IRON.

NEITHER THE HOWARD COUNTY COMMISSIONERS NOR THE HEALTH DEPARTMENT IS RESPONSIBLE FOR THE SUCCESSFUL OPERATION OF ANY SYSTEM.

BLDG. PERMIT SIGNED AND RETURNED 1/22/77

Serial No. 38231

Pool Permit

19125

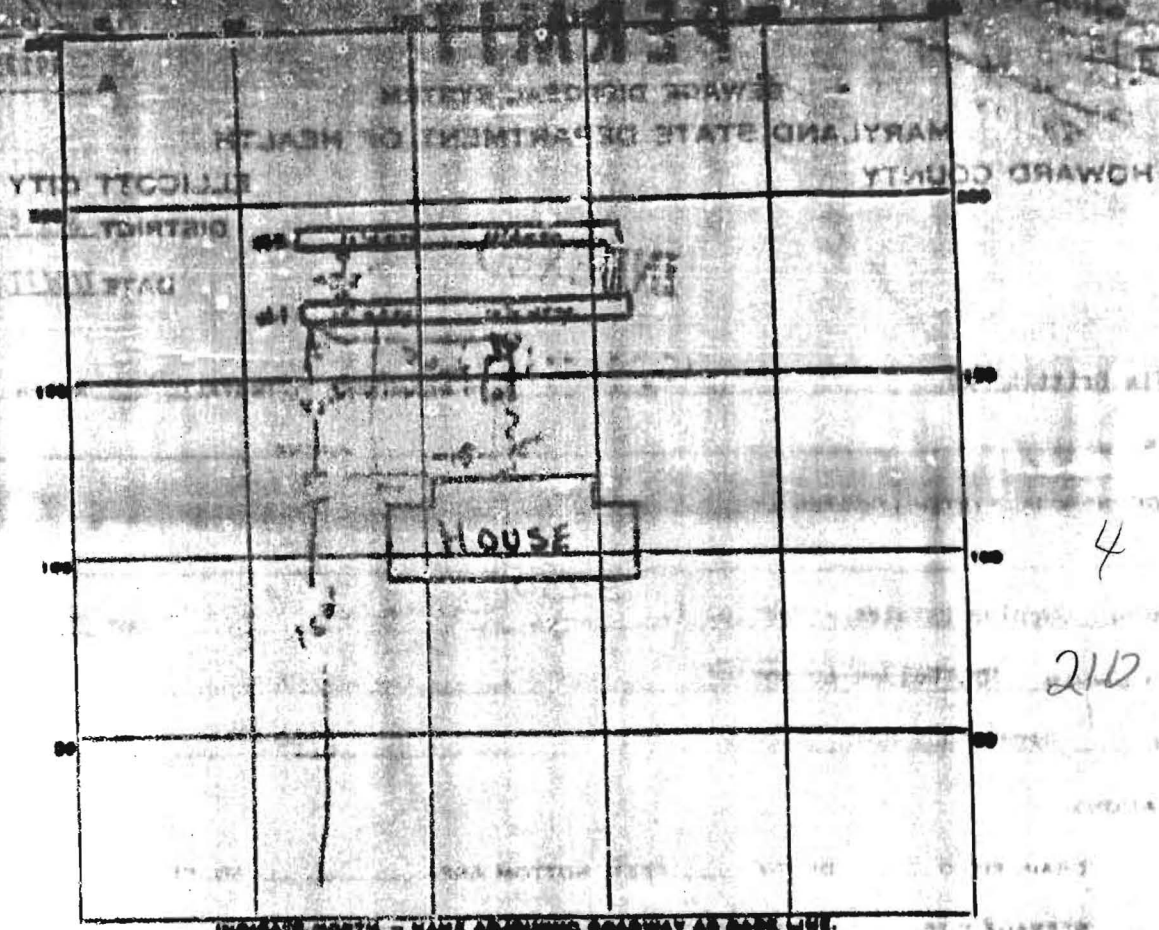

INDICATE NORTH - NAME ABSORBING ROADWAY AS BASE LINE.
Gwenlee Circle

4
210

PERMIT CARD No

SEPTIC TANK, LEVEL CLEANOUTS

DISTRIBUTION BOX, LEVEL NA

TILE FIELD, DEPTH 10-11 FT. TRENCH WIDTH 2 FT.

GRAVEL DEPTH 5-6' TOTAL LENGTH 201 FT. #2

NUMBER OF TRENCHES 2 TOTAL ABSORBENT AREA 445 SQ. FT.

SEEPAGE PITS, INSIDE DIAMETER NA FT. DEPTH BELOW INLET 17.1 FT.

ABSORBENT AREA 445 SQ. FT.

REMARKS 8/19/72 OK to repair and install #1
8/10/79 OK to paper and backfill ditch #2 First
20' #1
NOTE REPAIR First #1

DATE SYSTEM APPROVED 7/11/79 INSPECTOR APJW