

LAYOUT _____ INSP 4 _____

INSP 2 _____ INSP 5 _____

INSP 3 _____ INSP 6 _____

ISSUE DATE: _____

APPROVAL DATE: _____

PERMIT

INDEXED

P _____

A 517958-A

ON-SITE SEWAGE DISPOSAL SYSTEM HOWARD COUNTY HEALTH DEPARTMENT BUREAU OF ENVIRONMENTAL HEALTH

04-322320

_____ IS PERMITTED TO INSTALL ALTER

ADDRESS: _____ PHONE NUMBER: _____

SUBDIVISION: _____ LOT NUMBER: _____

ADDRESS: 3630 Daisy Road PROPERTY OWNER: Norman E Mason Jr.

SEPTIC TANK CAPACITY (GALLONS): _____ OUTLET BAFFLE FILTER REQUIRED

PUMP CHAMBER CAPACITY (GALLONS): _____ COMPARTMENTED TANK REQUIRED

NUMBER OF BEDROOMS: _____

SQUARE FEET PER BEDROOM: _____

LINEAR FEET OF TRENCH REQUIRED: _____

TRENCHES:	Trench to be _____ feet wide. Inlet _____ feet below original grade. Bottom maximum depth _____ feet below original grade. Effective area begins at _____ feet below original grade. _____ feet of stone below distribution pipe.
LOCATION:	
NOTES:	

PLANS APPROVED: _____ DATE: _____

NOTE: PERMIT VOID AFTER 2 YEARS

NOTE: CONTRACTOR RESPONSIBLE FOR SCHEDULING A PRE-CONSTRUCTION INSPECTION FOR ALL INSTALLATIONS

NOTE: WATERTIGHT SEPTIC TANKS REQUIRED

NOTE: ALL PARTS OF SEPTIC SYSTEM SHALL BE 100 FEET FROM ANY WATER WELL

NOTE: MANHOLE RISERS REQUIRED ON ALL SEPTIC TANKS AND PUMP CHAMBERS UNLESS SPECIFICALLY AUTHORIZED

NEITHER THE HOWARD COUNTY COUNCIL NOR THE HEALTH DEPARTMENT IS RESPONSIBLE FOR THE SUCCESSFUL OPERATION OF ANY SYSTEM PERMITTEE RESPONSIBLE FOR OBTAINING FINAL APPROVAL ON THIS PERMIT

BUILDING PERMIT SIGNED CALL 410-313-2640 FOR INSPECTION OF SEPTIC SYSTEM

AND RETURNED

10/9/2002 B00138813 STORAGE BUILDING

A517958-A

10/11/74

PERMIT

P. 20542

A. 16187

SEWAGE DISPOSAL SYSTEM

MARYLAND STATE DEPARTMENT OF HEALTH

HOWARD COUNTY

ELLICOTT CITY

INDEXED

DISTRICT 4

DATE 8/13/74

10/11/74

William Hopkins IS PERMITTED TO INSTALL ALTER

ADDRESS Jennings Chapel Road, Woodbine, Md. PHONE 488-6313

A SEWAGE DISPOSAL SYSTEM LOCATED AT

SUBDIVISION ROAD 3630 Daisy (see appl. LOT 1
for better directions)

PROPERTY OWNER ROBERT E. HATCH, Jr.

ADDRESS

SPECIFICATIONS - 3 bedrooms

DRAIN FIELD DEPTH FEET BOTTOM AREA SQ. FT.

SEEPAGE PITS ABSORBENT SIDE-WALL AREA SQ. FT.

SEPTIC TANK CAPACITY 1,000 GALLONS

FOR GARBAGE GRINDER, INCREASE DISPOSAL AREA 22% & TANK CAPACITY 20%.

OTHER Dry well - 120 sq. ft. absorbent sidewall area per bedroom to begin below the first 4 ft. of original grade. Max. depth permitted for dry well is 12 ft. below original grade. Place dry well 150 ft. from front lot line and 120 ft. from left sideline as seen when facing lot from Daisy Road.

NOTE: ALL PIPE FROM HOUSE TO DRY WELL MUST BE CAST IRON.
PERMIT VOID AFTER THREE YEARS.
NOTE: INSTALL STAND PIPE ON SEPTIC TANK AND DRY WELL.

PLANS APPROVED BY D. W. Monaghan DATE 4/17/73

FILL SEPTIC TANK AND DISTRIBUTION BOX WITH WATER BEFORE CALLING FOR AN INSPECTION. COVER NO WORK UNTIL INSPECTED AND APPROVED

NEITHER THE HOWARD COUNTY COMMISSIONERS NOR THE HEALTH DEPARTMENT IS RESPONSIBLE FOR THE SUCCESSFUL OPERATION OF ANY SYSTEM.

A 16187

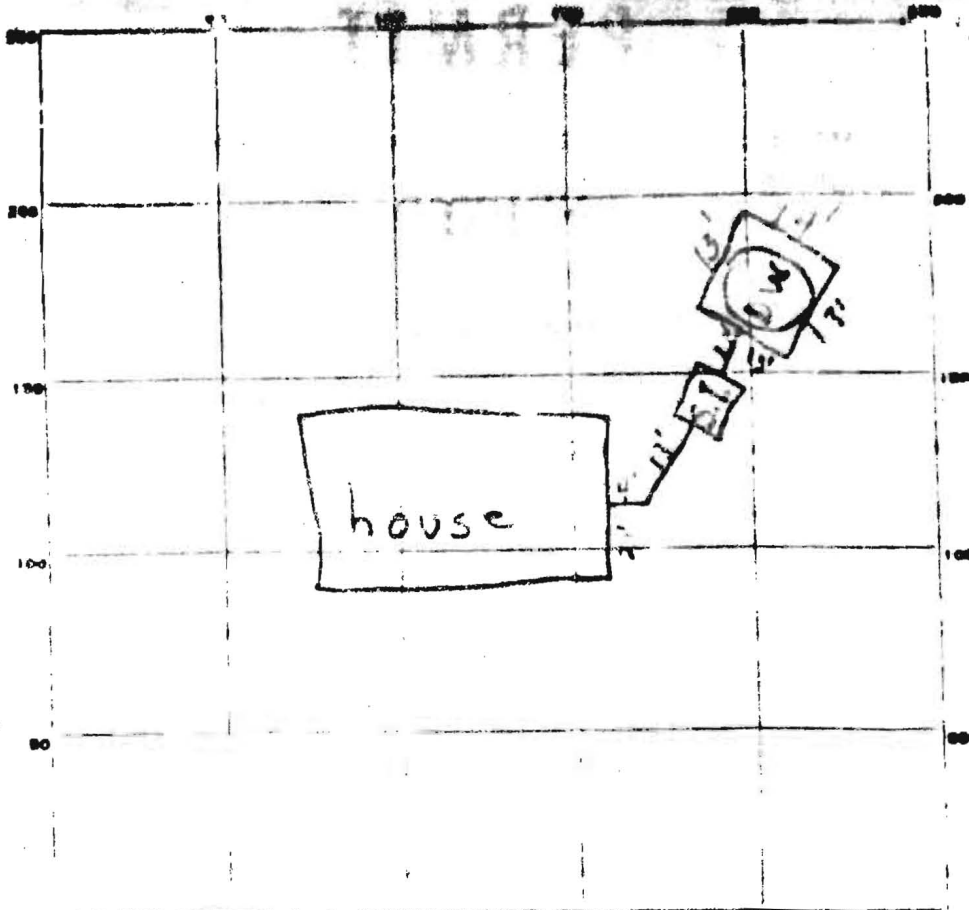

INDICATE NORTH - NAME ADJOINING ROADWAY AS BASE LINE

PERMIT CARD signed *Daisy Rd.* all work *ST / D.W.*
 SEPTIC TANK, LEVEL CLEANOUTS

DISTRIBUTION BOX, LEVEL _____
 TILE FIELD, DEPTH _____ FT. TRENCH WIDTH _____ FT.

GRAVEL DEPTH _____ IN. TOTAL LENGTH _____ FT.
 NUMBER OF TRENCHES _____ TOTAL BOTTOM AREA _____

34
72
46

SEE PAGE PITS, ^{OUTSIDE} INSIDE DIAMETER 54 FT. DEPTH BELOW INLET 7 1/2 FT.
 ABSORBENT AREA 405 SQ. FT.

REMARKS 13/14/74 Dotted at 115' S.S.

DATE SYSTEM APPROVED 11/4/74 INSPECTOR F.S.H. I.C.B.S.