

C1 14269

SEQUENCE NO. (MDE USE ONLY)

STATE OF MARYLAND WELL COMPLETION REPORT

THIS REPORT MUST BE SUBMITTED WITHIN 45 DAYS AFTER WELL IS COMPLETED.

COUNTY NUMBER 13 P12330

(THIS NUMBER IS TO BE PUNCHED IN COLS. 3-6 ON ALL CARDS)

ST/CO USE ONLY DATE Received

DATE WELL COMPLETED 10-24-02

Depth of Well 145 (TO NEAREST FOOT)

PERMIT NO. FROM "PERMIT TO DRILL WELL" HO-94-3518

OWNER Hart James STREET OR RFD 7529 Greenwood Dr. TOWN Highland SUBDIVISION Greenwood Farms SECTION LOT 48

WELL LOG

Not required for driven wells

STATE THE KIND OF FORMATIONS PENETRATED, THEIR COLOR, DEPTH, THICKNESS AND IF WATER BEARING

Table with columns: DESCRIPTION, FEET (FROM, TO), check if water bearing. Includes entries for Sand and Gray Mica Rock.

GROUTING RECORD

WELL HAS BEEN GROUTED (Y) (N) TYPE OF GROUTING MATERIAL (C) (M) (B) (C) NO. OF BAGS 13 NO. OF POUNDS 1332

CASING RECORD

MAIN CASING TYPE (S) (T) (C) (O) (P) (L) (J) (S) Nominal diameter top (main) casing (nearest inch) 6 Total depth of main casing (nearest foot) 46

OTHER CASING (if used)

Table for OTHER CASING with columns for diameter and depth.

SCREEN RECORD

screen type or open hole (S) (T) (B) (R) (H) (O) (P) (L) (J) (S) DIAMETER OF SCREEN (NEAREST INCH) 44

NUMBER OF UNSUCCESSFUL WELLS: 0

WELL HYDROFRACTURED (Y) (N)

- A A WELL WAS ABANDONED AND SEALED WHEN THIS WELL WAS COMPLETED
E ELECTRIC LOG OBTAINED
P TEST WELL CONVERTED TO PRODUCTION WELL

I HEREBY CERTIFY THAT THIS WELL HAS BEEN CONSTRUCTED IN ACCORDANCE WITH COMAR 26.04.04 "WELL CONSTRUCTION" AND IN CONFORMANCE WITH ALL CONDITIONS STATED IN THE ABOVE CAPTIONED PERMIT...

DRILLERS LIC. NO. 1 M S D 024 1 DRILLERS SIGNATURE Joseph E. Mayne

LIC. NO. 1 D

SITE SUPERVISOR (sign. of driller or journeyman responsible for sitework if different from permittee)

GRAVEL PACK IF WELL DRILLED WAS FLOWING WELL INSERT F IN BOX 68

MDE USE ONLY (NOT TO BE FILLED IN BY DRILLER) T (E.R.O.S.) W Q

TELESCOPE CASING LOG INDICATOR OTHER DATA

C 3

PUMPING TEST

HOURS PUMPED (nearest hour) 3 PUMPING RATE (gal. per min.) 20 METHOD USED TO MEASURE PUMPING RATE Bucket WATER LEVEL (distance from land surface) BEFORE PUMPING 39 ft. WHEN PUMPING 52 ft. TYPE OF PUMP USED (for test) (A) air (P) piston (T) turbine (C) centrifugal (R) rotary (O) other (describe below) (J) jet (S) submersible

PUMP INSTALLED

DRILLER INSTALLED PUMP (YES) (NO) IF DRILLER INSTALLS PUMP, THIS SECTION MUST BE COMPLETED FOR ALL WELLS. TYPE OF PUMP INSTALLED PLACE (A,C,J,P,R,S,T,O) IN BOX 29. CAPACITY: GALLONS PER MINUTE (to nearest gallon) 31 35 PUMP HORSE POWER 37 41 PUMP COLUMN LENGTH (nearest ft.) 43 47 CASING HEIGHT (circle appropriate box and enter casing height) (+) above ( ) below LAND SURFACE 2 (nearest foot)

LOCATION OF WELL ON LOT SHOW PERMANENT STRUCTURE SUCH AS BUILDING, SEPTIC TANKS, AND /OR LANDMARKS AND INDICATE NOT LESS THAN TWO DISTANCES (MEASUREMENTS TO WELL)

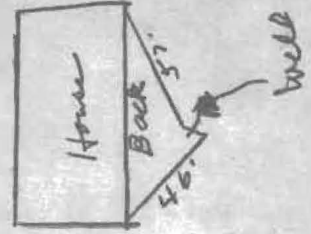

B 1 7956

SEQUENCE NO. (MDE USE ONLY)

STATE OF MARYLAND APPLICATION FOR PERMIT TO DRILL WELL

STATE PERMIT NUMBER

40-94-3518

W517957 please type

fill in this form completely

Date Received (APA)

10/9/2002

OWNER INFORMATION

Hart James

7529 Greenwood Dr.

Highland Md

B 3

LOCATION OF WELL

Howard

Greenwood Farms

SECTION 3 LOT 48

Highland

MILES FROM TOWN (enter 0 if in town) 2 1/2

DRILLER INFORMATION

Joseph L. Wayne M SD 24

Joseph L. Wayne Well Drilling

5512 Ridge Rd Mt Airy Md 21771

Joseph L. Wayne 10/7/02

B 4

DIRECTION OF WELL FROM TOWN (CIRCLE BOX)

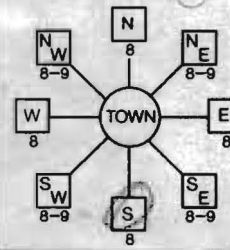

7529 Greenwood Dr.

ON WHICH SIDE OF ROAD (CIRCLE APPROPRIATE BOX)

140

DISTANCE FROM ROAD ENTER FT OR MI 38 39

TAX MAP: 40 BLK: 18 PARCEL 157

WELL INFORMATION

APPROX. PUMPING RATE (GAL. PER MIN.) 5

AVERAGE DAILY QUANTITY NEEDED (GAL. PER DAY) 500

USE FOR WATER (CIRCLE APPROPRIATE BOX)

- DOMESTIC POTABLE SUPPLY & RESIDENTIAL IRRIGATION
FARMING (LIVESTOCK WATERING & AGRICULTURAL IRRIGATION)
INDUSTRIAL, COMMERCIAL, DEWATERING
PUBLIC WATER SUPPLY WELL
TEST, OBSERVATION, MONITORING
GEO-THERMAL

NOT TO BE FILLED IN BY DRILLER HEALTH DEPARTMENT APPROVAL

Howard 13 P12330

COUNTY NAME COUNTY NO. STATE SIGNATURE INSERT S

DATE ISSUED 10/10/2002 Brian Baber 10/10/2003

NORTH GRID 484 000 EAST GRID 815 000

APPROXIMATE DEPTH OF WELL 260 FEET

APPROXIMATE DIAMETER OF WELL 6 INCH

METHOD OF DRILLING (circle one)

BORED (or Augered) JETTED Jetted & DRIVEN

AIR-ROTary AIR-PERcussion ROTARY (Hydraulic Rotary)

CABLE REVerse-ROTary DRive-POINT

REPLACEMENT OR DEEPEMED WELLS (CIRCLE APPROPRIATE BOX)

- THIS WELL WILL NOT REPLACE AN EXISTING WELL
THIS WELL WILL REPLACE A WELL THAT WILL BE ABANDONED AND SEALED
THIS WELL WILL REPLACE A WELL THAT WILL BE USED AS A STANDBY-CONTACT LOCAL APPROVING AUTHORITY FOR POLICY ON STANDBY WELLS
THIS WELL WILL DEEPEAN AN EXISTING WELL

PERMIT NUMBER OF WELL TO BE REPLACED OR DEEPEMED (IF AVAILABLE)

Not to be filled in by driller (MDE OR COUNTY USE ONLY)

APPROP. PERMIT NUMBER G PERMIT No. 40-94-3518

SHOW MAJOR FEATURES OF BOX & LOCATE WELL WITH AN X

- SOURCES OF DRILLING WATER
1. well
2.
3.

WRITE THE BOX NUMBER FROM THE MAP HERE

8105 4804

DRAW A SKETCH BELOW SHOWING LOCATION OF WELL IN RELATION TO NEARBY TOWNS AND ROADS AND GIVE DISTANCE FROM WELL TO NEAREST ROAD JUNCTION

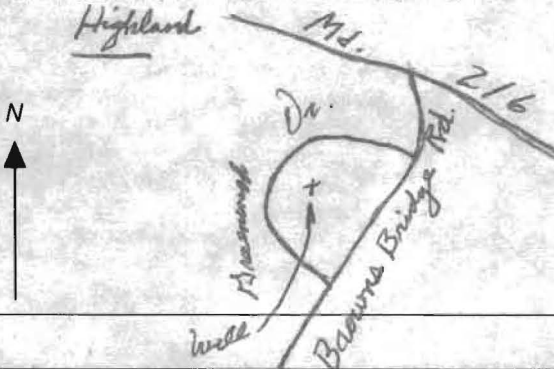

**HOWARD COUNTY HEALTH DEPARTMENT  
BUREAU OF ENVIRONMENTAL HEALTH  
WATER AND SEWERAGE PROGRAM  
TEL: (410)313-2640 FAX: (410)313-2648**

**Information Form for the Installation of the Well Pump, Pitless Adapter, and Supply Piping**

**NOTE: The installer is responsible for requesting an inspection prior to 9 am on the day of the desired inspection. No work is to be covered until approved by the Health Department. All installations must comply with the National Standard Plumbing Code (NSPC, as amended locally) and COMAR 26.04.04 (MD Well Construction Regulations). Submission of a complete form is required prior to Use and Occupancy approval.**

Company Name: \_\_\_\_\_ Telephone #: \_\_\_\_\_  
Address: \_\_\_\_\_  
\_\_\_\_\_

(Must circle one) Licensed Plumber      Licensed Well Driller      Licensed Well Pump Installer

License # and name of individual responsible for the field installation:

Name (Print): \_\_\_\_\_ License# \_\_\_\_\_

**\*A licensed individual must perform the actual installation. Apprentices must be under the direct supervision of a licensed journeyman or master plumber, pump installer or well driller. Licenses may be subjected to field verification.**

Name of Property Owner: \_\_\_\_\_ Telephone #: \_\_\_\_\_  
Subdivision: Greenwood Farms Lot #: 48 Well Tag #: HO-94-3518 ✓  
Site Address: 7529 Greenwood Farms

**Submersible Pump Data**

Make: \_\_\_\_\_  
Model #: \_\_\_\_\_  
Pump Capacity \_\_\_\_\_ GPM  
Well Yield: \_\_\_\_\_ GPM

**Pitless Adapter**

Make: \_\_\_\_\_  
Model#: \_\_\_\_\_  
Depth: \_\_\_\_\_ (36" min)  
NSF approved: \_\_\_\_\_

**Well Cap and Electric Conduit**

Two piece watertight cap: \_\_\_\_\_  
Screened, vented well cap: \_\_\_\_\_  
Cap secured to casing: \_\_\_\_\_  
Conduit min 18" B.G.: \_\_\_\_\_  
Conduit secured to well cap: \_\_\_\_\_

Depth of well encountered at time of pump installation: \_\_\_\_\_ (feet)  
If pump capacity exceeds well yield, a low water cut off switch is required by NSPC 1990 Section 17.8.4  
Torque arrestors or Cable guards are required - Must circle one  
Safety rope, if used, attached to inside of well casing with eye bolt \_\_\_\_\_

**Piping to house**

Type: \_\_\_\_\_  
PSI: \_\_\_\_\_ (160 psi min)  
Depth of supply line: \_\_\_\_\_ (36" min)

**House Connection**

PVC sleeved to undisturbed soil at wall penetration: \_\_\_\_\_  
Approximate length of sleeve: \_\_\_\_\_  
Sleeve caulked and sealed properly: \_\_\_\_\_

**The water supply line is required to be at least ten feet from the septic tank, pump chamber, sewage piping, distribution box, drainfields, and sewage reserve area. If this cannot be accomplished, contact this office for approval prior to installation.**

\_\_\_\_\_  
Signature of company representative responsible for installation      date

**For Health Department Use Only - Not to be completed by Installer**

Date Insp. Requested: 11/6/02 2pm      Date Insp. Approved: 11/6/02 (SD)  
Inspection Data: Pitless adapter and water supply line at least 36" below grade ✓  
Two piece cap installed and attached to casing securely ✓  
Elec. conduit extends at least 18" below grade/attached to cap properly ✓  
Safety rope installed inside of well casing ✓  
Correct well tag attached properly and casing 8" above finished grade ✓  
Water supply line sleeved adequately at house connection Conn to ex. line  
Adequate grout observed below pitless adapter ✓

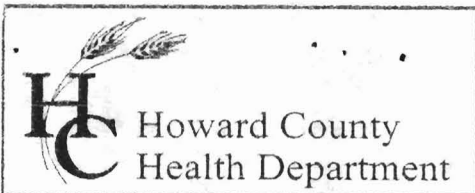

3525 H Ellicott Mills Drive, Ellicott City, MD 21043  
(410) 313-2640 Fax (410) 313-2648  
TDD (410) 313-2323 Toll Free 1-866-313-6300  
website: www.hchealth.org

Penny E. Borenstein, M.D., M.P.H., Health Officer

November 18, 2002

James Hart  
7529 Greenwood Drive  
Highland, MD 21777

RE: **Replacement Well Issues**  
7529 Greenwood Drive  
Well Permit # HO-94-3518

Dear Mr. Hart:

Our office is requesting that you contact the Community Environmental Health Program at (410) 313-1773 to schedule water sampling for the referenced replacement well once it is hooked up to your home (required by the Maryland Well Construction Regulation COMAR 26.04.04). There is currently no charge for the well line inspection and water sampling.

It is preferred that the sample be collected by a certified health official from the primary indoor drinking tap, but if suitable scheduling is not possible, the sample may be taken from an outside tap to complete your sampling obligation. However, the potential for unsuccessful sample results increases when samples are collected from taps exposed to the outside environment.

**Failure to confirm the potability of this well water supply by completion of documentation or water sampling requirements could result in the issuance of an order to abandon and seal the replacement well in accordance with COMAR 26.04.04.**

If you have any questions, or would like to discuss these matters further please call me at (410) 313-1771. Thank you for your attention to these important matters.

Respectfully,

*Kacie Noonan*  
Kacie Noonan, Sanitarian  
Well and Septic Program

cc: Community Environmental Health Program  
File

0517957

OK SRK  
7/18/03

MARYLAND DEPARTMENT OF THE ENVIRONMENT, WATER MANAGEMENT ADMINISTRATION  
2500 BROENING HIGHWAY, BALTIMORE, MARYLAND 21224, (410) 631-3784

\*\*\*\*\*  
WATER WELL ABANDONMENT-SEALING REPORT FORM  
\*\*\*\*\*

SUBMIT COPIES OF COMPLETED FORM TO:

- \* COUNTY ENVIRONMENT AGENCY (contact MDE, WMA if address needed)
- \* WELL OWNER
- \* MDE, WATER MANAGEMENT ADMINISTRATION, WELL PROGRAM

DATE WELL ABANDONED: 7-2-03 (month/day/year)

\* PERMIT NUMBER OF ABANDONED WELL (if any) none

\* PERMIT NUMBER OF REPLACEMENT WELL 710 - 94 - 3518

\* PERSON ABANDONING WELL: Joseph L. Mayne

WELL DRILLERS LICENSE NUMBER: 024

CIRCLE: MWD/MSD/MGD

\* OWNER'S NAME: James Hart

SITE LOCATION MAP

\* WELL LOCATION:  
 COUNTY: Howard  
 NEAREST TOWN: Highland  
 TAX MAP 40 BLOCK 18 PARCEL 157  
 SUBDIVISION: Greenwood Farms  
 SECTION: \_\_\_\_\_ LOT: 48  
 NEAREST ROAD: 2529 Greenwood Dr.

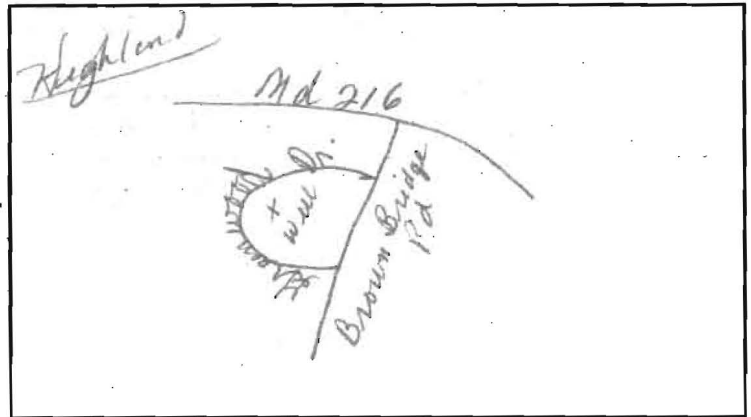

\* TYPE OF WELL BEING ABANDONED:

- DRILLED      \_\_\_\_\_ JETTED  
 \_\_\_\_\_ BORED/AUGERED      \_\_\_\_\_ HAND DUG  
 \_\_\_\_\_ OTHER (specify) \_\_\_\_\_

\* USE CODE:

- DOMESTIC      \_\_\_\_\_ MUNICIPAL/PUBLIC  
 \_\_\_\_\_ IRRIGATION      \_\_\_\_\_ INDUSTRIAL  
 \_\_\_\_\_ TEST/OBSERVATION      \_\_\_\_\_ GEOTHERMAL

\* TYPE OF CASING:

- STEEL      \_\_\_\_\_ PLASTIC  
 \_\_\_\_\_ CONCRETE      \_\_\_\_\_ OTHER (specify) \_\_\_\_\_

\* SIZE OF CASING: 6 INCHES IN DIAMETER

\* DEPTH OF WELL: 28 FEET DEEP

\* WAS ANY CASING REMOVED? \_\_\_\_\_ YES  NO  
if yes, length removed, in feet: \_\_\_\_\_

\* WAS CASING RIPPED OR PERFORATED? \_\_\_\_\_ YES  NO

LOG OF SEALING MATERIAL

MATERIAL	FEET	
	FROM	TO
Cement	0	10
Washed gravel	10	28
VOLUME OF MATERIAL USED		

SIGNATURE-MASTER WELL DRILLER OR SUPERVISING SANITARIAN Joseph L. Mayne

LICENSE # MSD024

MWD/MSD/MGD CIRCLE ONE

DATE 7-11-03

