

1/19/95  
cjo. em

# PERMIT

## SEWAGE DISPOSAL SYSTEM

### DEPARTMENT OF HEALTH AND MENTAL HYGIENE

1/19/95  
O.P.C.O. no  
P 50489A  
m/hor No.  
A REPAIR *utility*

#### HOWARD COUNTY HEALTH DEPARTMENT

BUREAU OF ENVIRONMENTAL HEALTH  
~~XXXXXXXX~~ 313-2640

INDEXED

DISTRICT \_\_\_\_\_

DATE 4/23/95

DATE SYSTEM APPROVED 1/19/95

INSPECTOR CBH

Jenkins Brothers IS PERMITTED TO INSTALL \_\_\_\_\_ ALTER X

ADDRESS 7670 Smith's Private Road, Sykesville, Maryland 21784 PHONE 461-9282

SUBDIVISION \_\_\_\_\_ LOT \_\_\_\_\_ ROAD 8450 Church Lane Road

PROPERTY OWNER \_\_\_\_\_ Foreman  
8450 Church Lane Road

ADDRESS \_\_\_\_\_

SEPTIC TANK CAPACITY 1000 GALLONS DIRECTIONS: Off Rogers Avenue before Route 70

NUMBER OF BEDROOMS 3 (2) Bedrooms

\_\_\_\_\_ SQUARE FEET PER BEDROOM

LINEAR FEET OF TRENCH REQUIRED \_\_\_\_\_

REPAIR - PURPOSE - SEPTIC SYSTEM HAS FAILED.

Call for inspection when ground is opened so sanitarian can recommend repair. 01/18/95

Note: (1) The septic system, ok, per Mr. C. Jenkins;  
(2) Replaced collapsed sewer pipe after septic tank and new dist. box and pipe to drain fields, only. Please see back.

PLANS APPROVED BY CBH at site for Mr. C. "W" DATE 1/19/95

COVER NO WORK UNTIL INSPECTED AND APPROVED

NEITHER THE HOWARD COUNTY COUNCIL NOR THE HEALTH DEPARTMENT IS RESPONSIBLE FOR THE SUCCESSFUL OPERATION OF ANY SYSTEM

NOTE: CLEANOUT REQUIRED EVERY 70 FEET OF SEWER LINE AND/OR AT 90° SWEEPS IN LINES FROM HOUSE TO DRAIN FIELDS, 90° ELBOWS NOT ACCEPTABLE.

NOTE: ALL PARTS OF SEPTIC SYSTEMS (I.E. TANK, DISTRIBUTION BOX TRENCHES) TO BE 100 FEET FROM WELL (UNLESS OTHERWISE SPECIFICALLY AUTHORIZED)

NOTE: IF DEEP TRENCH(ES) ARE USED CALL FOR INSPECTION BEFORE AND AFTER PLACING GRAVEL IN TRENCH(ES)

NOTE: NO DRY WELL SHALL EXCEED 15 FOOT IN DIAMETER NO ABSORPTION TRENCH TO EXCEED 100 FEET IN LENGTH

NOTE: ALL PIPE FROM HOUSE TO SEPTIC TANK MUST BE CAST IRON OR SCHEDULE 35/40 PVC OR ABS

PERMIT VOID AFTER TWO YEARS

NOTE: INSTALL STAND PIPE ON SEPTIC TANK AND DRY WELL STAND PIPES MUST BE 6 INCHES IN DIAMETER CAST IRON. CONCRETE OR TERRA COTTA OR PVA OR ABS ACCEPTED. IF TOP OF SEPTIC TANK IS DEEPER THAN 3 FEET. MANHOLE TO GRADE REQUIRED.

NOTE: DISTRIBUTION BOXES MUST HAVE BAFFLES

**\*INSTALLER IS RESPONSIBLE FOR OBTAINING FINAL APPROVAL ON THIS PERMIT**

P 50489A

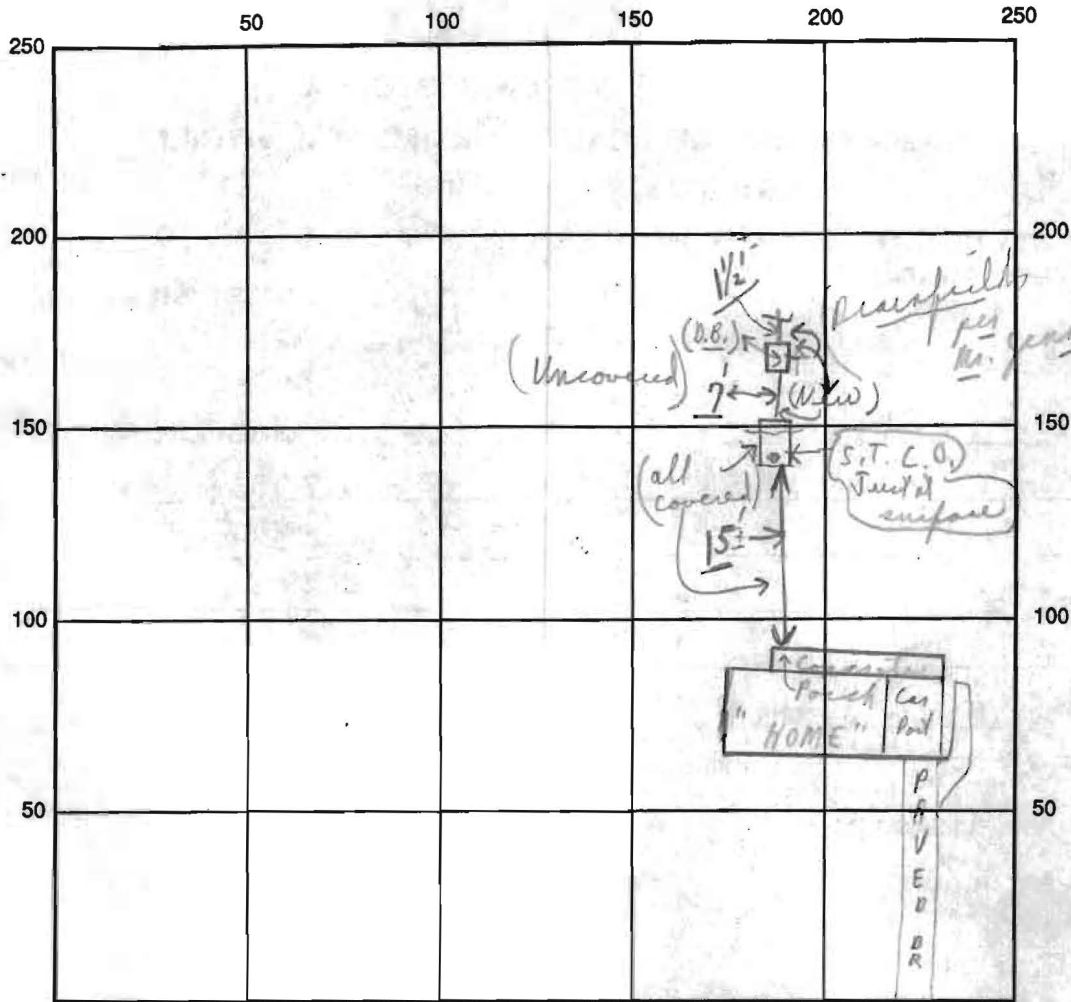

INDICATE NORTH - NAME ADJOINING ROADWAY AS BASE LINE

← CHURCH ROAD →

SEPTIC TANK LEVEL Existing CLEANOUTS Existing

DISTRIBUTION BOX LEVEL (New)

DRAIN FIELD/TITLE DEPTH 2 FT. TRENCH WIDTH 15 FT. INLET DEPTH 15 FT.

EFFECTIVE GRAVEL DEPTH 15 FT. TOTAL LENGTH 15 FT.

NUMBER OF TRENCHES 1 ONE SIDEWALL/BOTTOM AREA 150 SQ. FT.

DRYWALL INSIDE DIAMETER 15 FT. EFFECTIVE DEPTH BELOW INLET 15 FT.

ABSORBENT AREA 150 SQ. FT.

REMARKS: (2<sup>nd</sup> stop) 1/19/95 Replaced old pipe from septic tank to dist. box; distribution box - new; and saw 1 1/2" new pipe at dist box; Final on repair; chd (Work all done at arrival on 2<sup>nd</sup> stop) chd

DATE SYSTEM APPROVED 1/19/95 INSPECTOR Charles Bryan Stricker  
per above