

# APPLICATION

SEWAGE DISPOSAL TESTING

A 28862

STATE OF MARYLAND - DEPARTMENT OF HEALTH AND MENTAL HYGIENE

P \_\_\_\_\_

HOWARD COUNTY HEALTH DEPARTMENT  
ENVIRONMENTAL HEALTH SERVICES  
P.O. BOX 476 ELLICOTT, MARYLAND 21043  
TELEPHONE: 992-2330

DISTRICT 4th

DATE 9/15/78

TO: THE COUNTY HEALTH OFFICER  
ELLICOTT CITY, MARYLAND

I, HEREBY, APPLY FOR THE NECESSARY TEST IN ORDER TO CONSTRUCT (OR RECONSTRUCT) A SEWAGE DISPOSAL SYSTEM.

PROPERTY OWNER Estate of Sylvan Manger STEPHEN MILLER

ADDRESS \_\_\_\_\_ PHONE \_\_\_\_\_

PROPERTY LOCATION:

SUBDIVISION Countryside S/D 3551 COUNTRY SIDE DR. LOT NO. 8

ROAD AND DESCRIPTION Route 97

SIZE OF LOT 3 acres m/1 TYPE BLDG. 3 or 4 bedrooms

THE SYSTEM INSTALLED UNDER THIS APPLICATION IS ACCEPTABLE ONLY UNTIL PUBLIC FACILITIES BECOME AVAILABLE.

I FULLY UNDERSTAND THE FEE CONNECTED WITH THE FILING OF THIS PERC TEST APPLICATION IS NON-REFUNDABLE UNDER ANY CIRCUMSTANCES.

SIGNATURE OF APPLICANT /s/ Bernard Rome

APPROVED BY C. B. Streaker FOR Frenches DATE 11/10/79

REJECTED BY \_\_\_\_\_ FOR \_\_\_\_\_ DATE \_\_\_\_\_

HOLD PENDING FURTHER TESTS \_\_\_\_\_ DATE \_\_\_\_\_

REASONS FOR REJECTION OR HOLDING \_\_\_\_\_

BLDG. PERMIT SIGNED  
AND RETURNED 6/29/80 SK  
# 71177

# THIS IS NOT A PERMIT



242'

Field sheet

SOIL PROFILE

Below clay  
sandy loam

700' ±

910' ±

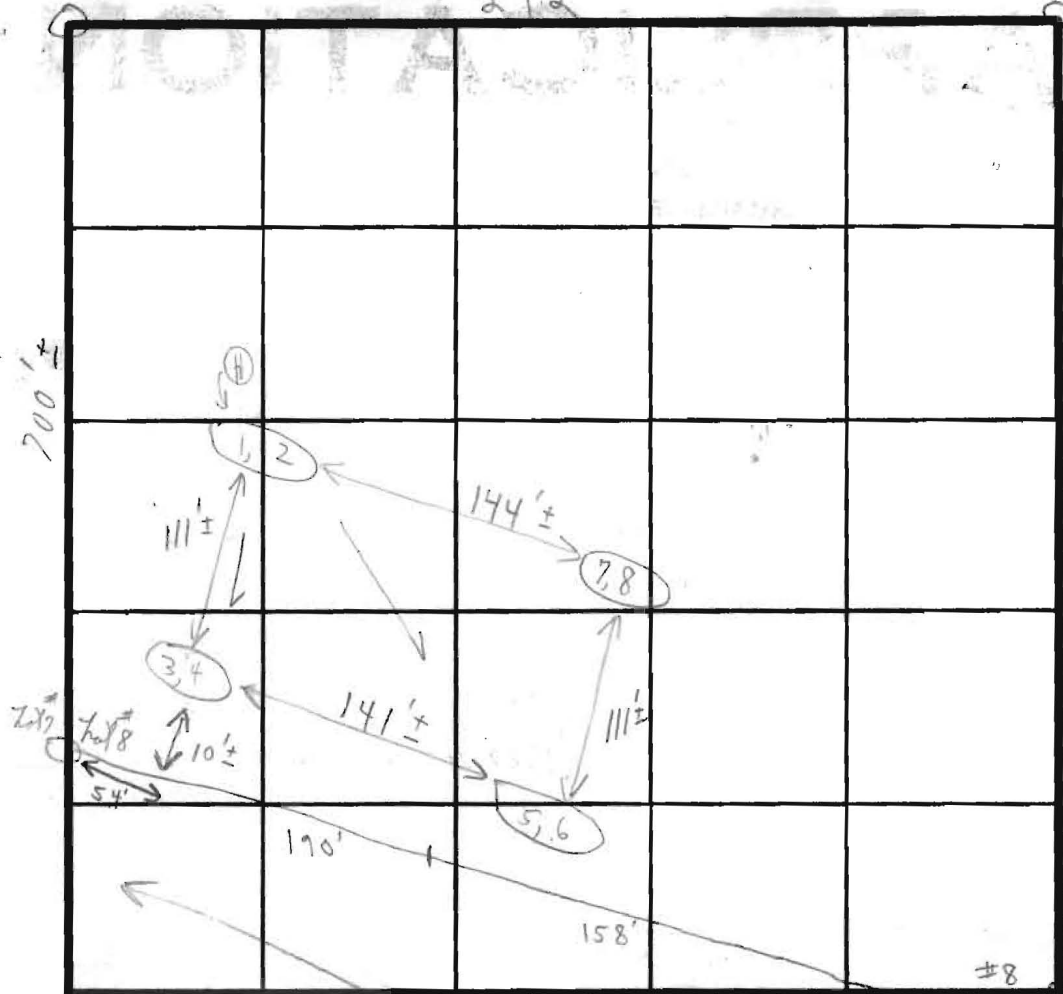

INDICATE NORTH - NAME ADJOINING ROADWAY AS BASE LINE.

Unnamed Road →

DATE	TEST NO.	DEPTH	PRE-WET		TEST - 1" DROP		TIME
			START	STOP	START	STOP	
10/31/78	1	4'	10:00	10:02	10:02	10:05	3 min
	② 2	9'	10:00	10:02	10:02	10:04	2 min
	3	3 1/2'	10:06	10:08	10:08	10:11	3 min
	4	9'	10:06	10:08	10:08	10:12	4 min
	5	4'	9:44	9:45	9:45	9:47	2 min
	6	9'	9:44	9:46	9:46	9:49	3 min
	7	3 1/2'	9:52	9:54	9:54	9:57	3 min
	8	8'	9:52	9:54	9:54	9:56	2 min

{ Highest }

REMARKS Tests in open field { all holes dug at time of arrival

TYPE OF SOIL

TESTED BY C.B.S.

ALSO PRESENT Mr. Rome  
Mr. Pennington