

10/3/02
ASAP

PUB. SEWER STATUS VERIFIED BY Jean Reed

ISSUE DATE: 10/3/2002

PERMIT

P 517946

APPROVAL DATE: _____

INDEXED

A REPAIR

ON-SITE SEWAGE DISPOSAL SYSTEM HOWARD COUNTY HEALTH DEPARTMENT BUREAU OF ENVIRONMENTAL HEALTH

02-209276

Jenkins Brothers IS PERMITTED TO INSTALL ALTER

ADDRESS: 7670 Smiths Private Road PHONE NUMBER: 410-461-9282

SUBDIVISION: _____ LOT NUMBER: _____

ADDRESS: 8450 Church Lane PROPERTY OWNER: Eric Johnson

SEPTIC TANK CAPACITY (GALLONS): _____

PUMP CHAMBER CAPACITY (GALLONS): _____

NUMBER OF BEDROOMS: _____

SQUARE FEET PER BEDROOM: _____

LINEAR FEET OF TRENCH REQUIRED: _____

TRENCHES:	Trench to be _____ feet wide. Inlet _____ feet below original grade. Bottom maximum depth _____ feet below original grade. Effective area begins at _____ feet below original grade. _____ feet of stone below distribution pipe.
LOCATION:	
PURPOSE:	Existing septic system has failed. Call for inspection when ground is opened so sanitarian can recommend repair.

PLANS APPROVED: _____ DATE: _____

- NOTE: PERMIT VOID AFTER 2 YEARS
- NOTE: CONTRACTOR RESPONSIBLE FOR SCHEDULING A PRE-CONSTRUCTION INSPECTION FOR ALL INSTALLATIONS
- NOTE: WATERTIGHT SEPTIC TANKS REQUIRED
- NOTE: ALL PARTS OF SEPTIC SYSTEM SHALL BE 100 FEET FROM ANY WATER WELL
- NOTE: MANHOLE RISERS REQUIRED ON ALL SEPTIC TANKS AND PUMP CHAMBERS

NEITHER THE HOWARD COUNTY COUNCIL NOR THE HEALTH DEPARTMENT IS RESPONSIBLE FOR THE SUCCESSFUL OPERATION OF ANY SYSTEM PERMITTEE RESPONSIBLE FOR OBTAINING FINAL APPROVAL ON THIS PERMIT CALL 410-313-2640 FOR INSPECTION OF SEPTIC SYSTEM

517946

6' - 1/2 minutes 3' 10:45

(A)

NOT TO SCALE

Red Br Heavy Loam and Fill	4'-5.5'
Red Br Loam	5'-5.5'
Tan Sa Loam With a few pockets of close to 50% rock	

14.5'

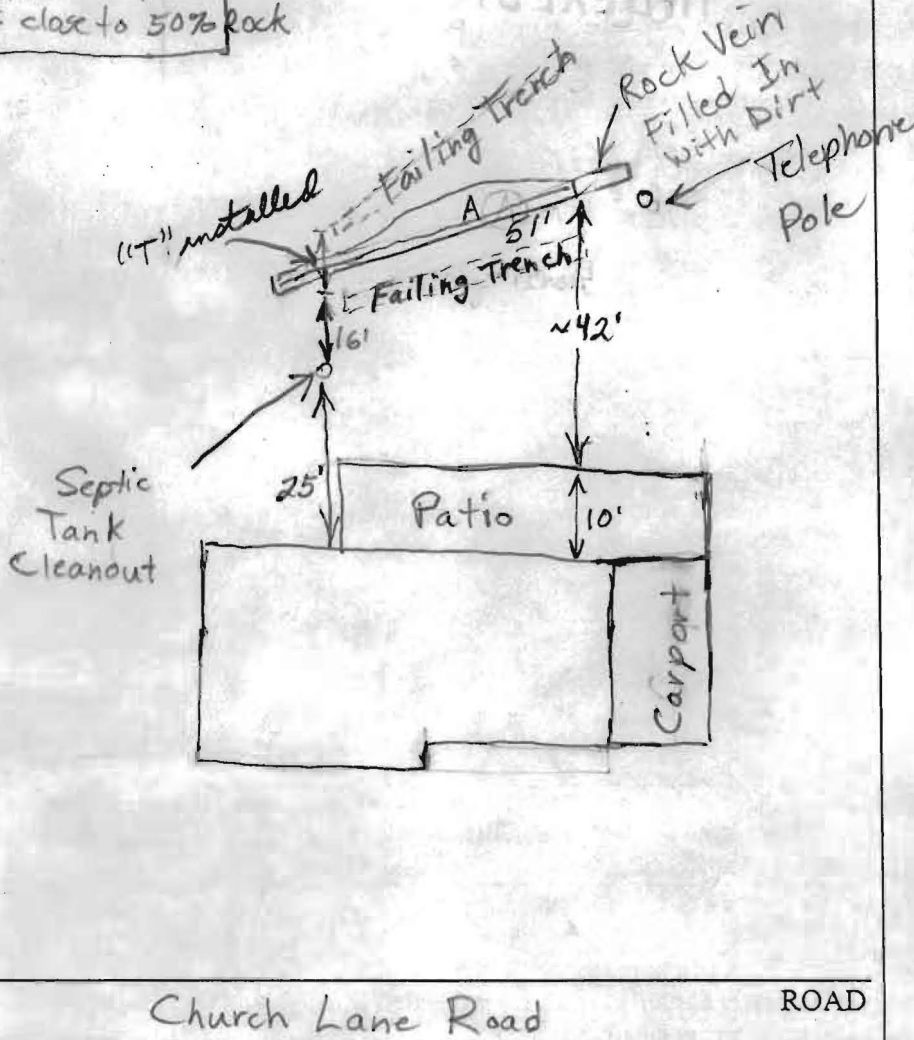

TRENCH/DRAINFIELD DATA		
WIDTH	INLET	BOTTOM
3'-8'	3.5'-5'	10'-11'
NUMBER OF TRENCHES <u>1</u>		
TOTAL LENGTH <u>51'</u>		
ABSORPTION AREA <u>350+</u>		
DISTRIBUTION BOX LEVEL <u>N/A</u>		
DISTRIBUTION BOX BAFFLE <u>N/A</u>		
DISTRIBUTION BOX PORT <u>N/A</u>		

SEPTIC TANK DATA	
SEPTIC TANK 1 LEVEL	<u>Existing</u>
CAPACITY	_____ GAL
SEAM LOC	_____
TANK LID DEPTH	_____
BAFFLES	_____
BAFFLE FILTER	_____
MANHOLE LOC	_____
6" PORT LOC	_____
WATERTIGHT TEST	_____
SEPTIC TANK 2 LEVEL	<u>N/A</u>
CAPACITY	_____ GAL
SEAM LOC	_____
TANK LID DEPTH	_____
BAFFLES	_____
BAFFLE FILTER	_____
MANHOLE LOC	_____
6" PORT LOC	_____
WATERTIGHT TEST	_____

PRE-CONSTRUCTION 10/3/02 To install a 55' trench with stone from 3.5'-10.0'. Trench to be 3' wide. Existing failing installation trenches to be disconnected.

10/3/02 Hit rock vein when digging trench. Told contractor to backfill rock vein with dirt and extend trench in opposite direction. O.K. to install T in trench. 10/3/02 Trench caved in according to contractor. Parts of trench now 8' wide. Not enough stone to fill entire trench to 3.5' (contractor said he dug out caved in dirt). Stone now 3.5' deep in upper part of trench and 5' deep in

FINAL INSPECTOR B. Baker DATE OF APPROVAL 10/3/2002

cave-in. O.K. to cover. (BB)