

9/16/85

9-6-85
Approved
Sid AGLP

PERMIT

SEWAGE DISPOSAL SYSTEM

MARYLAND STATE DEPARTMENT OF HEALTH

HOWARD COUNTY
BUREAU OF ENVIRONMENTAL HEALTH
992-2330

TAX ID# 03-302415

INDEXED

ELLICOTT CITY

DISTRICT 3rd

DATE 8/28/85

P 35922

A 17698

Stanley Souder

IS PERMITTED TO INSTALL ALTER

ADDRESS 7254 Mink Hollow Road

PHONE

SUBDIVISION The Corners

ROAD 13411 Tridelphia Road

6

PROPERTY OWNER

Stanley Souder VERNON ALLISON

ADDRESS

IF GARBAGE GRINDER IS USED INCREASE SEPTIC TANK CAPACITY BY 50% AND ABSORPTION AREA BY 22%.

GARBAGE GRINDER? YES NO

SEPTIC TANK CAPACITY 1000 GALLONS NUMBER OF BEDROOMS 3

TRENCHES - 187 sq. ft. per bedroom. Trench to be 2 feet wide. Inlet 4 feet below original grade. Bottom maximum depth 9 feet below original grade. Effective area begins at 4 feet below original grade. 5 feet of stone below distribution pipe. LOCATION: Start the trenches at a point 170 feet from the lot line along Tridelphia Road and 50 feet from the left side of the lot as seen when facing the lot from Tridelphia Road. Run the trenches along level ground toward the left side of the lot as seen when facing the lot from Tridelphia Road. Okay to use parallel trenches at least 15 feet apart. NOTE: No trench to exceed 100 feet in length. If more than one trench used, a distribution box is required. Call for inspection of trench(s) before and after gravel is installed. Provide 6" - 8" diameter cleanout and cap to grade or above on septic tank.

BLDG. PERMIT OBTAINED

IF BLDG. PERMIT OBTAINED

Serial # 60665

Signature

DATE 8/24/85

PLANS APPROVED BY Raymond Hodges

COVER NO WORK UNTIL INSPECTED AND APPROVED.

NEITHER THE HOWARD COUNTY COUNCIL NOR THE HEALTH DEPARTMENT IS RESPONSIBLE FOR THE SUCCESSFUL OPERATION OF ANY SYSTEM.

NOTE: IF TRENCH IS USED CALL FOR INSPECTION BEFORE AND AFTER PLACING GRAVEL IN TRENCH.

NOTE: NO DRY WELL SHALL EXCEED 15 FOOT IN DIAMETER. NO ABSORPTION TRENCH TO EXCEED 100 FEET IN LENGTH.

NOTE: ALL PIPE FROM HOUSE TO SEPTIC TANK MUST BE CAST IRON OR SCHEDULE 40 PVC OR ABS.

PERMIT VOID AFTER THREE YEARS.

NOTE: INSTALL STAND PIPE ON SEPTIC TANK AND DRY WELL. STAND PIPES MUST BE 6 INCHES IN DIAMETER CAST IRON, CONCRETE OR TERRA COTTA, OR PVC OR ABS ACCEPTED. IF TOP OF SEPTIC TANK IS DEEPER THAN 3 FEET MANHOLE TO GRADE REQUIRED

*INSTALLER IS RESPONSIBLE FOR OBTAINING FINAL APPROVAL ON THIS PERMIT

*CALL 992-2330 FOR INSPECTION OF SEPTIC SYSTEMS.

EH - 2-1082

NOTICE

DATE SYSTEM APPROVED

A 17698

A 517698

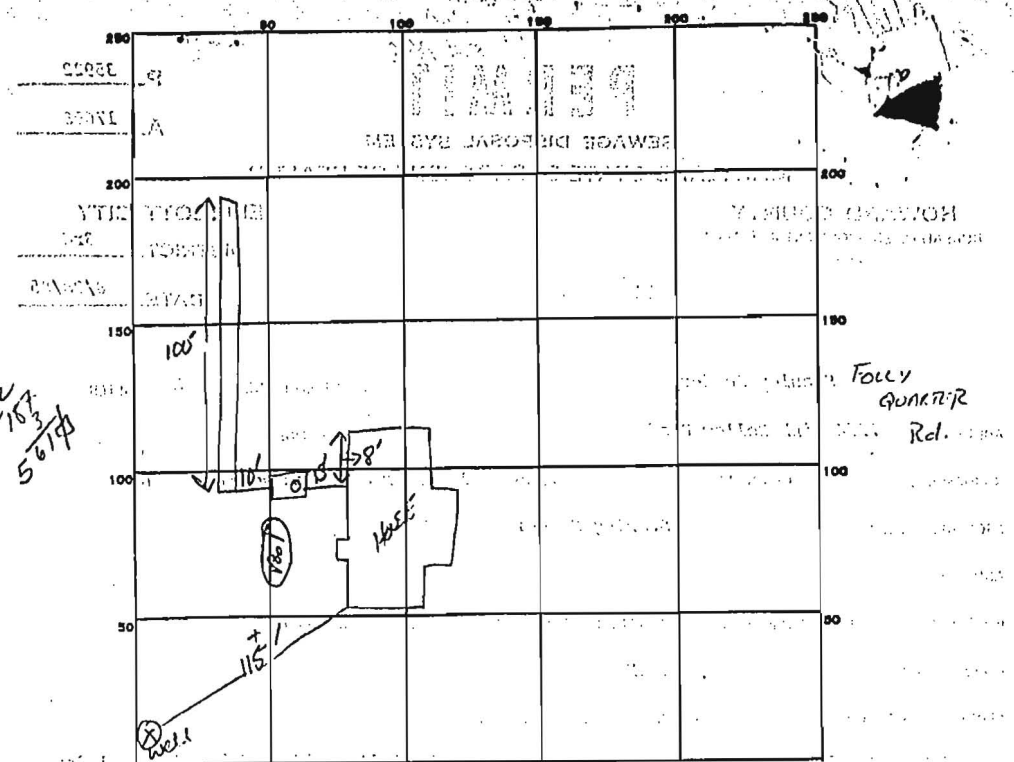

INDICATE NORTH. - NAME ADJOINING ROADWAY AS BASE LINE.

PERMIT CARD

TRADOLPHIA Rd.

SEPTIC TANK, LEVEL 1000 GAL

CLEANOUTS

DISTRIBUTION BOX, LEVEL N/A

TILE FIELD, DEPTH 10 FT. TRENCH WIDTH 2 FT.

INLET 4"

GRAVEL DEPTH 6 FE IN. TOTAL LENGTH 100 FT.

NUMBER OF TRENCHES 1 ONE SIDE WALL TOTAL-BOTTOM AREA 600 sq

SEEPAGE PITS, INSIDE DIAMETER FT. DEPTH BELOW INLET FT.

ABSORBENT AREA 1000 SQ. FT.

REMARKS 9-6-85. OK TO ADD STAKE; OK TO COME WITH WORK SA.

INSTALLER IS RESPONSIBLE FOR OBTAINING NECESSARY PERMITS AND APPROVALS ON THIS PERMIT.

DATE SYSTEM APPROVED

9-6-85

INSPECTOR

S. Abu