

HOUSE CONNECTION REQ'D

2/1/90 NOON

PERMIT

P 46303

SEWAGE DISPOSAL SYSTEM

A 07935

MARYLAND STATE DEPARTMENT OF HEALTH DISTRICT 5th

HOWARD COUNTY
BUREAU OF ENVIRONMENTAL HEALTH
461-9933

HO-88-0471

DATE 08/29/90

DATE SYSTEM APPROVED 4-1

INSPECTOR 41

INDEXED

C. C. Cissel IS PERMITTED TO INSTALL ALTER

ADDRESS 14079 Brighton Dam Road, Clarksville, Md. 21029 PHONE 854-2006

SUBDIVISION Coyne Property ROAD 13454 Clarksville Pike LOT 1

PROPERTY OWNER _____

ADDRESS _____

~~IF GARBAGE GRINDER IS USED, NO SEPTIC TANK CAPACITY BY 50% AND ABSORPTION AREA BY 25%~~

~~GARBAGE GRINDER XXXXX XXXXXXXXXXXXXXXXXXXXXXXXXXXXXXX~~

SEPTIC TANK CAPACITY 1250 GALLONS NUMBER OF BEDROOMS 4

TRENCHES - 180 sq. ft. per bedroom. Trench to be 2.0 feet wide. Inlet 3.0 feet below original grade. Bottom maximum depth 8.0 feet below original grade. Effective area begins at 3.0 feet below original grade. 5.0 feet of stone below distribution pipe.

LOCATION - Place the distribution box 120 feet from the intersection of the rear lot lines (168.0' and 171.21'), 225 feet from the right (153.55') lot line and 90 feet from the left (537.0') lot line as seen when facing the lot from Route 108. Run trenches on contour toward the right and left lot lines.

NOTE - MAINTAIN A MINIMUM OF 100 FEET FROM THE WELL. No trench to exceed 100 feet in length. Provide 6" - 8" diameter cleanout and cap to grade or above on septic tank. 8-27-90 JEN

PLANS APPROVED BY Jane Nadeau cm DATE 08/23/90

COVER NO WORK UNTIL INSPECTED AND APPROVED

NEITHER THE HOWARD COUNTY COUNCIL NOR THE HEALTH DEPARTMENT IS RESPONSIBLE FOR THE SUCCESSFUL OPERATION OF ANY SYSTEM

NOTE: CLEANOUT REQUIRED EVERY 70 FEET OF SEWER LINE AND/OR AT 90° SWEEPS IN LINES FROM HOUSE TO DRAIN FIELDS

NOTE: ALL PARTS OF SEPTIC SYSTEMS (I.E. TANK, DISTRIBUTION BOX, TRENCHES) TO BE 100 FEET FROM WELL (UNLESS OTHERWISE SPECIFICALLY AUTHORIZED)

NOTE: IF DEEP TRENCH(IES) ARE USED CALL FOR INSPECTION BEFORE AND AFTER PLACING GRAVEL IN TRENCH(IES)

NOTE: NO DRY WELL SHALL EXCEED 15 FOOT IN DIAMETER NO ABSORPTION TRENCH TO EXCEED 100 FEET IN LENGTH.

NOTE: ALL PIPE FROM HOUSE TO SEPTIC TANK MUST BE CAST IRON OR SCHEDULE 40 PVC OR ABS

PERMIT VOID AFTER TWO YEARS

NOTE: INSTALL STAND PIPE ON SEPTIC TANK AND DRY WELL. STAND PIPES MUST BE 6 INCHES IN DIAMETER. CAST IRON, CONCRETE OR TERRA COTTA OR PVC OR ABS ACCEPTED. IF TOP OF SEPTIC TANK IS DEEPER THAN 3 FEET, MANHOLE TO GRADE REQUIRED

NOTE: DISTRIBUTION BOXES MUST HAVE BAFFLES

***INSTALLER IS RESPONSIBLE FOR OBTAINING FINAL APPROVAL ON THIS PERMIT**

***CALL 461-9933 FOR INSPECTION OF SEPTIC SYSTEMS.**

P 46303

4088477

BACK

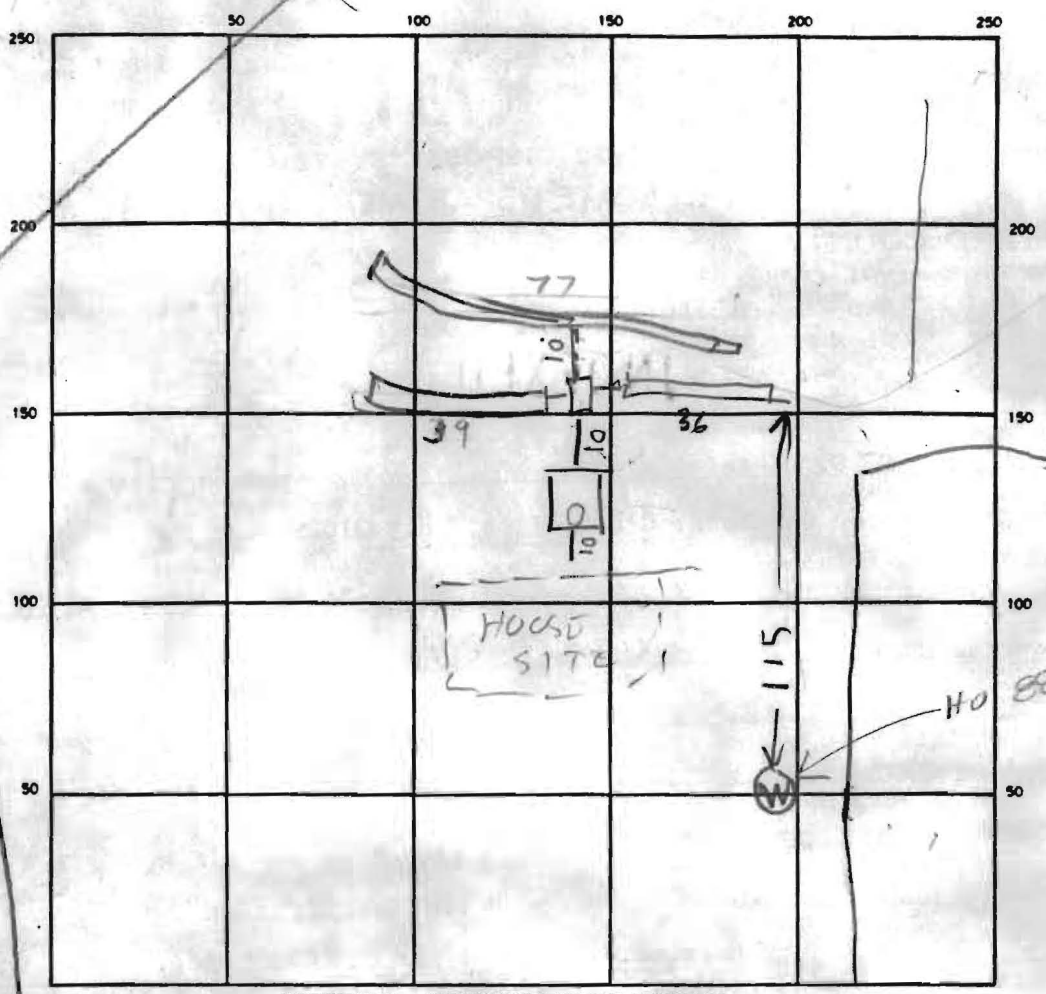

INDICATE NORTH - NAME ADJOINING ROADWAY AS BASE LINE

SEPTIC TANK. LEVEL 1500 CLEANOUTS OK

DISTRIBUTION BOX. LEVEL OK

DRAIN FIELD/TILE FIELD. DEPTH 8 FT. TRENCH WIDTH 2 FT. INLET DEPTH 2 1/2 FT.

EFFECTIVE GRAVEL DEPTH 6.5 FT. TOTAL LENGTH 152 FT.

NUMBER OF TRENCHES 3 ONE SIDEWALL/BOTTOM AREA 989 SQ. FT.

DRYWELL INSIDE DIAMETER _____ FT. EFFECTIVE DEPTH BELOW INLET _____ FT.

ABSORBENT AREA _____ SQ. FT.

6.5
780
912
390

REMARKS 9/10/90 1 PM LOCATION OK. TRENCHES DUG & SOME STONE ADDED
FINISH ADDING STONE & HOOKING UP TRENCHES
9/10/90 4 PM - TRENCHES OK HOOK TANK TO HOUSE
& CALL I (

DATE SYSTEM APPROVED 9/10/90 INSPECTOR [Signature]

355/246
8.7 AC ±

557°10'W

365'

422/292
3.5 AC ±

REAR 22 1/2' AE
25' STRIP: 0 1/2 AC ±
TOTAL 3 AC ±

LOT 2

315' ±

ZONING DEED
480/300
CACS

LOT 1

319/151
1.3 AC ±

Coyne Property

1042.8'

S 42° 15' E

670' ±

3 Act

N 44° 14' E 108' 1/2

N 43° 10' W 304' 5"

370/47
3.5 AC ±

N 43° 20' E 31' 10"

N 43° 12' W 280' 6"

332/107
1.5 AC ±

ZONING B-1

0.3 AC ±

S 41° 35' E 126'

ROUTE 108
STATE ROAD

450'

JOHN COYNE PROPERTY
5TH ELECTION DIST. HOWARD CO. MD
SCALE 1"=100' 7/6/1979

79