

# APPLICATION

A 09957

P \_\_\_\_\_

SEWAGE DISPOSAL TESTING

MARYLAND STATE DEPARTMENT OF HEALTH

HOWARD COUNTY

ELLICOTT CITY

Septic Tank - 750 gal.  
Drywell - 360 sq. ft. absorbent sidewall  
area below inlet pipe. Inlet to be no deeper  
than 4 ft. below original grade.  
Locate drywell 80 ft from BACK lot line and  
21 ft. from left side line as lot is seen when  
facing it from Cherry Tree Drive.

DISTRICT 5

DATE 4/2/65

TO: THE COUNTY HEALTH OFFICER  
ELLICOTT CITY, MARYLAND

I, HEREBY, APPLY FOR THE NECESSARY TESTS IN ORDER TO CONSTRUCT (OR RECONSTRUCT) A SEWAGE DISPOSAL SYSTEM.

PROPERTY OWNER Claude D. Kruh

ADDRESS Clarksville, Maryland PHONE AT 6-3152

PROPERTY LOCATION:

SUBDIVISION Mooresfield LOT NO. 16, Sec. 4

ROAD AND DESCRIPTION Cherry Tree Drive

OCCUPANT \_\_\_\_\_ PHONE \_\_\_\_\_

PERSON TO CONSTRUCT SYSTEM \_\_\_\_\_

ADDRESS \_\_\_\_\_ PHONE \_\_\_\_\_

SIZE OF LOT 125' x 336.2' TYPE BLDG. 3  
NUMBER OF BEDROOMS

IF NOT SINGLE RESIDENCE DESCRIBE \_\_\_\_\_

SIGNATURE OF APPLICANT /s/ P. T. McHenry

APPROVED BY R. Fletcher FOR Drywell DATE 4/19/65  
(KIND OF SYSTEM)

REJECTED BY \_\_\_\_\_ FOR \_\_\_\_\_ DATE \_\_\_\_\_  
(KIND OF SYSTEM)

HOLD PENDING FURTHER TESTS \_\_\_\_\_ DATE \_\_\_\_\_

REASONS FOR REJECTION OR HOLDING \_\_\_\_\_

# THIS IS NOT A PERMIT

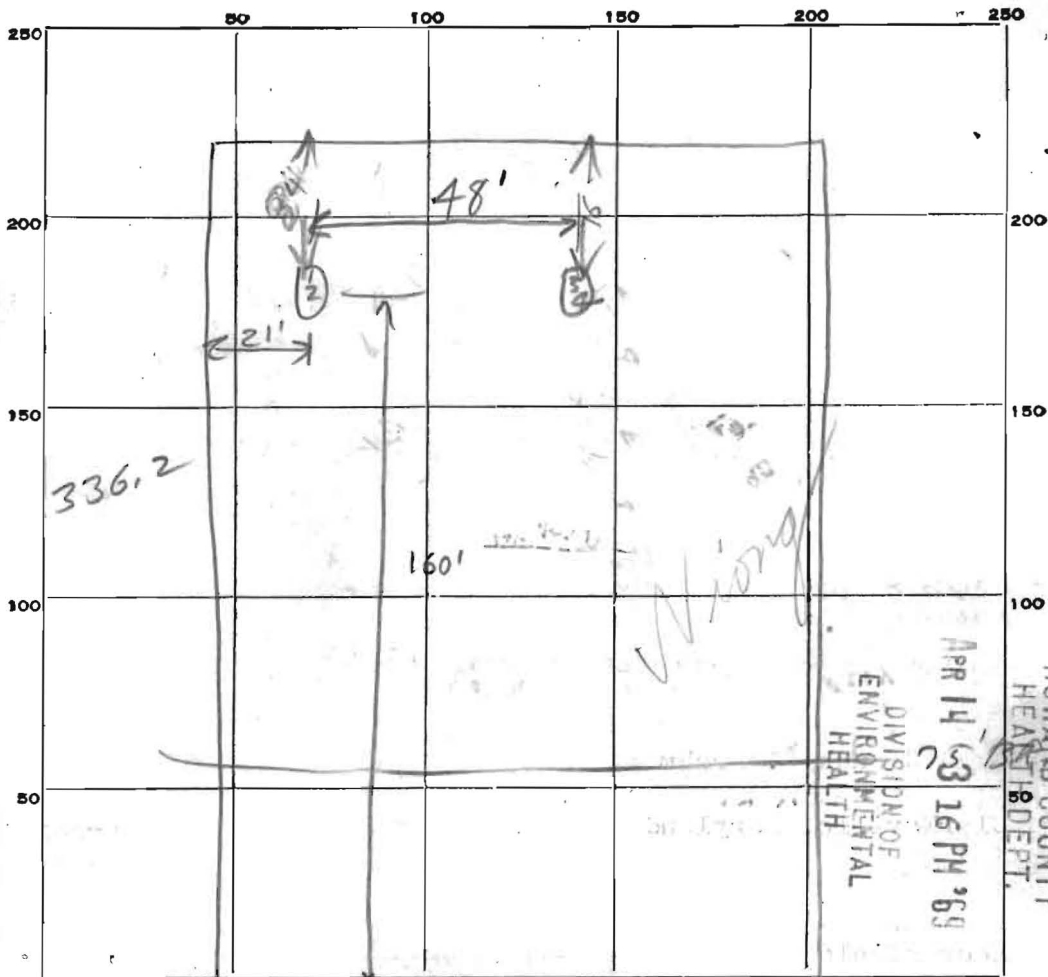

INDICATE NORTH. - NAME ADJOINING ROADWAY AS BASE LINE.

← Cherry Tree Dr. 125.0

DATE	TEST NO.	DEPTH	PRE-WET		TEST - 1" DROP		TIME	
			START	STOP	START	STOP		
4/7/65	1	5 ft.	1157	1158	1158	1202	4 min	
	2	9 1/2 ft.	1158	1200	1200	1206	6 min	
	3	5 ft.	1217	overturn on 1st inch				
	4		1218	1219	1219	1222	3 min	
1-20-69		See back of front sheet to avoid well problems						

11 min  
30  
10  
4/43

SOIL AUGER FINDING 1st 5 1/2 ft. in hole 3/4 claypit

TESTED BY R.D.F. 4/7/65

REMARKS Note IR best - inlet 4 ft below grade (original)

Lot 16, Sec.