

10/28/64

# PERMIT

P 09236

A 08085

SEWAGE DISPOSAL SYSTEM

MARYLAND STATE DEPARTMENT OF HEALTH

HOWARD COUNTY

ELLICOTT CITY

DISTRICT 4

## INDEXED

DATE 10/19/64

Lesell Construction Co. IS PERMITTED TO INSTALL X ALTER

ADDRESS Henryton Road Harriottsville, Md. PHONE Davis 8-2422

A SEWAGE DISPOSAL SYSTEM LOCATED AT Daisy Rd. & Mullinix Rd.

1 1 Mile south of Route 144, Daisy Rd.

SUBDIVISION River JAMES ROAD Daisy Rd. LOT 5 Sec. 3

PROPERTY OWNER Gerald D. Barnes 15829 AE Mullinix Rd

ADDRESS 965 Princeton Terrace, Glen Burnie, Md.

### SPECIFICATIONS

DRAIN FIELD \_\_\_\_\_ DEPTH \_\_\_\_\_ FEET, BOTTOM AREA \_\_\_\_\_ SQ. FT.

REPAGE PITS \_\_\_\_\_ ABSORBENT SIDE-WALL AREA \_\_\_\_\_ SQ. FT.

SEPTIC TANK CAPACITY 1,000 GALLONS

FOR GARBAGE GRINDER, INCREASE DISPOSAL AREA 25% & TANK CAPACITY 50%

OTHER Dry well 12 ft. in diameter by 13 ft. deep below the inlet located

60 ft. off front property line and 70 ft. off left side property line as

seen when facing lot from Mullinix Rd. Locate inlet at 4 ft. below original

grade.

PLANS APPROVED BY James KENNIGAN DATE 4/7/64

FILL SEPTIC TANK AND DISTRIBUTION BOY WITH WATER BEFORE CALLING FOR AN INSPECTION. COVER NO WORK UNTIL INSPECTED AND APPROVED.

NEITHER THE HOWARD COUNTY COMMISSIONERS NOR THE HEALTH DEPARTMENT IS RESPONSIBLE FOR THE SUCCESSFUL OPERATION OF ANY SYSTEM.

Lots 5

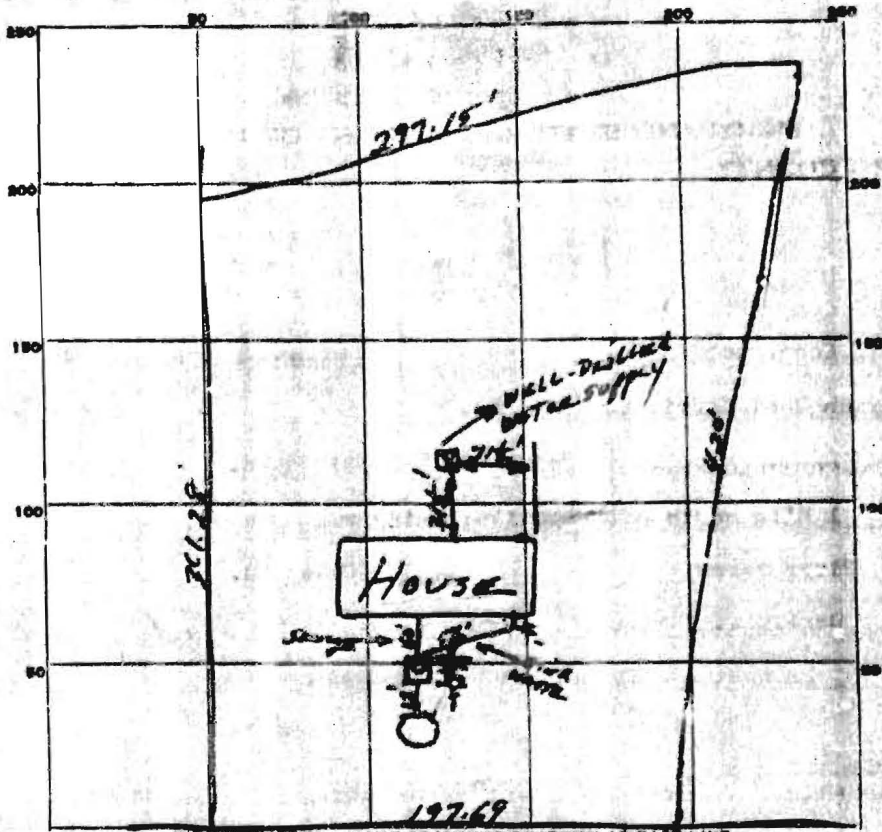

INDICATE NORTH. - NAME ADJACENT ROADWAY AS BASE LINE.  
MULLINX ROAD.

PERMIT CARD yo

SEPTIC TANK, LEVEL 10 mgd concrete CLEANOUTS Plug & slot

DISTRIBUTION BOX, LEVEL none

TILE FIELD, DEPTH \_\_\_\_\_ FT. TRENCH WIDTH \_\_\_\_\_ FT.

GRAVEL DEPTH \_\_\_\_\_ IN. TOTAL LENGTH \_\_\_\_\_ FT.

NUMBER OF TRENCHES \_\_\_\_\_ TOTAL BOTTOM AREA \_\_\_\_\_

SEEPAGE PITS, INSIDE DIAMETER 14 FT. DEPTH BELOW INLET 12 ft. 4 in.

ABSORBENT AREA OK. SQ. FT.

REMARKS \_\_\_\_\_

\_\_\_\_\_

\_\_\_\_\_

\_\_\_\_\_

\_\_\_\_\_

DATE SYSTEM APPROVED 10-28-64

INSPECTOR J. Hennigan

# APPLICATION

SEWAGE DISPOSAL TESTING

A 08085

P \_\_\_\_\_

MARYLAND STATE DEPARTMENT OF HEALTH

HOWARD COUNTY Howard County, Md. & Ellicott City

ELLICOTT CITY

DISTRICT 4

DATE 2/28/64

*9' x 12' well 1/2 ft. below by supply  
about the well located 4 ft. off front  
property line and 20 ft. off left side property  
line as shown when facing lot from Mullin's Road.  
Trench into at 4 ft. below original grade.*

TO: THE COUNTY HEALTH OFFICER  
ELLICOTT CITY, MARYLAND

*1600 gleyto  
Frank*

I HEREBY APPLY FOR THE NECESSARY TESTS IN ORDER TO CONSTRUCT OR RECONSTRUCT A SEWAGE DISPOSAL SYSTEM.

PROPERTY OWNER Gerald D. Barnes

ADDRESS 965 Princeton Terrace, High Springs, Md. PHONE South Ellicott 4-5174

PROPERTY LOCATION:

SUBDIVISION Robert Elder Farm LOT NO. 5, Tr. 1

ROAD AND DESCRIPTION Delany Rd. Mullin's Rd. - 1 mi. each of Rt. 12

OCCUPANT \_\_\_\_\_ PHONE \_\_\_\_\_

PERSON TO CONSTRUCT SYSTEM \_\_\_\_\_

ADDRESS \_\_\_\_\_ PHONE \_\_\_\_\_

SIZE OF LOT 2.143 acres TYPE BLDG. 4

NUMBER OF OCCUPANTS

IF NOT SINGLE RESIDENCE DESCRIBE \_\_\_\_\_

SIGNATURE OF APPLICANT Gerald D. Barnes

APPROVED BY [Signature] FOR [Signature] DATE 4-7-64

REJECTED BY \_\_\_\_\_ FOR \_\_\_\_\_ DATE \_\_\_\_\_

HOLD PENDING FURTHER TESTS \_\_\_\_\_ DATE \_\_\_\_\_

REASONS FOR REJECTION OR HOLDING \_\_\_\_\_

## THIS IS NOT A PERMIT

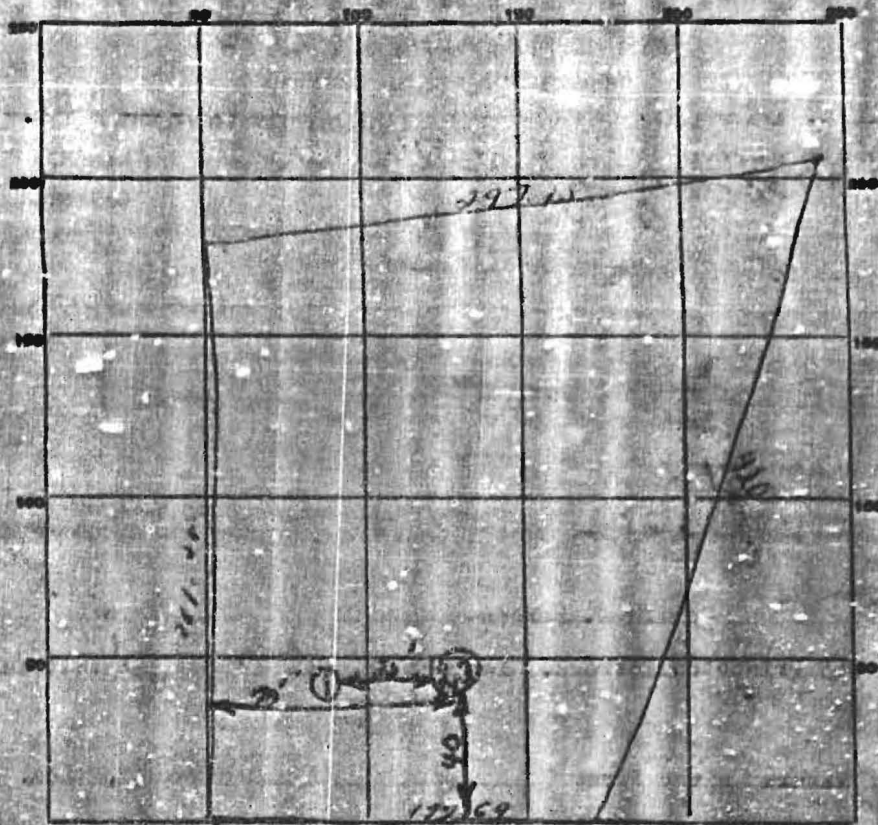

INDICATE NORTH - MARK ADJOINING ROADWAY AS BASE LINE

DATE	TEST NO.	DEPTH	PRE-WET		TEST - 1" DROP		TIME
			START	STOP	START	STOP	
4-7-64	1	4	9:56	10:10	10:10	10:39	272
	2	9	9:58	10:02	10:02	10:07	
	3	4	10:11	5 min			

SOIL AUGER FINDING \_\_\_\_\_

TESTED BY \_\_\_\_\_

REMARKS 172169 N. 1st St. H. Goodman lot 5 1/2 ft

ALSO PRESENT Harold S. ... LOT NO. 5 Section