

12/21/82
12/30/82
3:00 PM
2/8/85 AM

approved 2/8/85
Stayer
P 32383

PERMIT

SEWAGE DISPOSAL SYSTEM

A 32359

MARYLAND STATE DEPARTMENT OF HEALTH*

ELLICOTT CITY
DISTRICT 5th.

HOWARD COUNTY
BUREAU OF ENVIRONMENTAL HEALTH
992-2330

(INDEXED)

DATE 12/27/82

Mr. Randall D. Pickens IS PERMITTED TO INSTALL ALTER

ADDRESS 12186 Route 108, Clarksville, Maryland 21029 PHONE 531-3318

SUBDIVISION Robert Shillinger, ET al ROAD 7158 Brooks Road LOT 13

PROPERTY OWNER Mr. & Mrs. Randall Desmond Pickens

ADDRESS 12186 Route 108
Clarksville, Maryland 21029

IF GARBAGE GRINDER IS USED INCREASE SEPTIC TANK CAPACITY BY 50% AND ABSORPTION AREA BY 22%.

GARBAGE GRINDER? YES NO

SEPTIC TANK CAPACITY 1250 GALLONS NUMBER OF BEDROOMS 4

Dry Well¹ or Dry Well and Trench to contain 135 sq. ft. absorption sidewall per bedroom
Minimum Total sq. ft. in dry well is 540 sq. ft. Inlet 3 1/2 ft. below original grade,
Maximum depth 10 ft. below original grade. Effective area begins at 4 ft. below original
grade. NOTE: If trench is used to make up absorbent area, run the trench on level ground
and leave a 5 ft. earth buffer between drowell and trench. No trench is to exceed 100 ft. in
length. Trench inlet to be same as dry well with 6 1/2 ft. of stone below distribution pipe.
LOCATION: Place drowell at a point 200 feet from the front property line and 135 feet from
right property line as seen when facing property from Brooks Lane. If additional area is
needed, use 5 ft. earth buffer then run trench to required distance along level ground.

PLANS APPROVED BY C. Williams DATE 12/20/82

COVER NO WORK UNTIL INSPECTED AND APPROVED.

NEITHER THE HOWARD COUNTY COUNCIL NOR THE HEALTH DEPARTMENT IS RESPONSIBLE FOR THE SUCCESSFUL OPERATION OF ANY SYSTEM.

NOTE: IF TRENCH IS USED CALL FOR INSPECTION BEFORE AND AFTER PLACING GRAVEL IN TRENCH.

NOTE: NO DRY WELL SHALL EXCEED 15 FOOT IN DIAMETER. NO ABSORPTION TRENCH TO EXCEED 100 FEET IN LENGTH.

NOTE: ALL PIPE FROM HOUSE TO SEPTIC TANK MUST BE CAST IRON OR SCHEDULE 40 PVC OR ABS.

PERMIT VOID AFTER THREE YEARS.

NOTE: INSTALL STAND PIPE ON SEPTIC TANK AND DRY WELL. STAND PIPES MUST BE 6 INCHES IN DIAMETER. CAST IRON, CONCRETE OR TERRA COTTA, OR PVC OR ABS ACCEPTED. IF TOP OF SEPTIC TANK IS DEEPER THAN 3 FEET MANHOLE TO GRADE REQUIRED.

***INSTALLER IS RESPONSIBLE FOR OBTAINING FINAL APPROVAL ON THIS PERMIT**

*CALL 992-2330 FOR INSPECTION OF SEPTIC SYSTEMS.

EH - 2-1082

A
32359

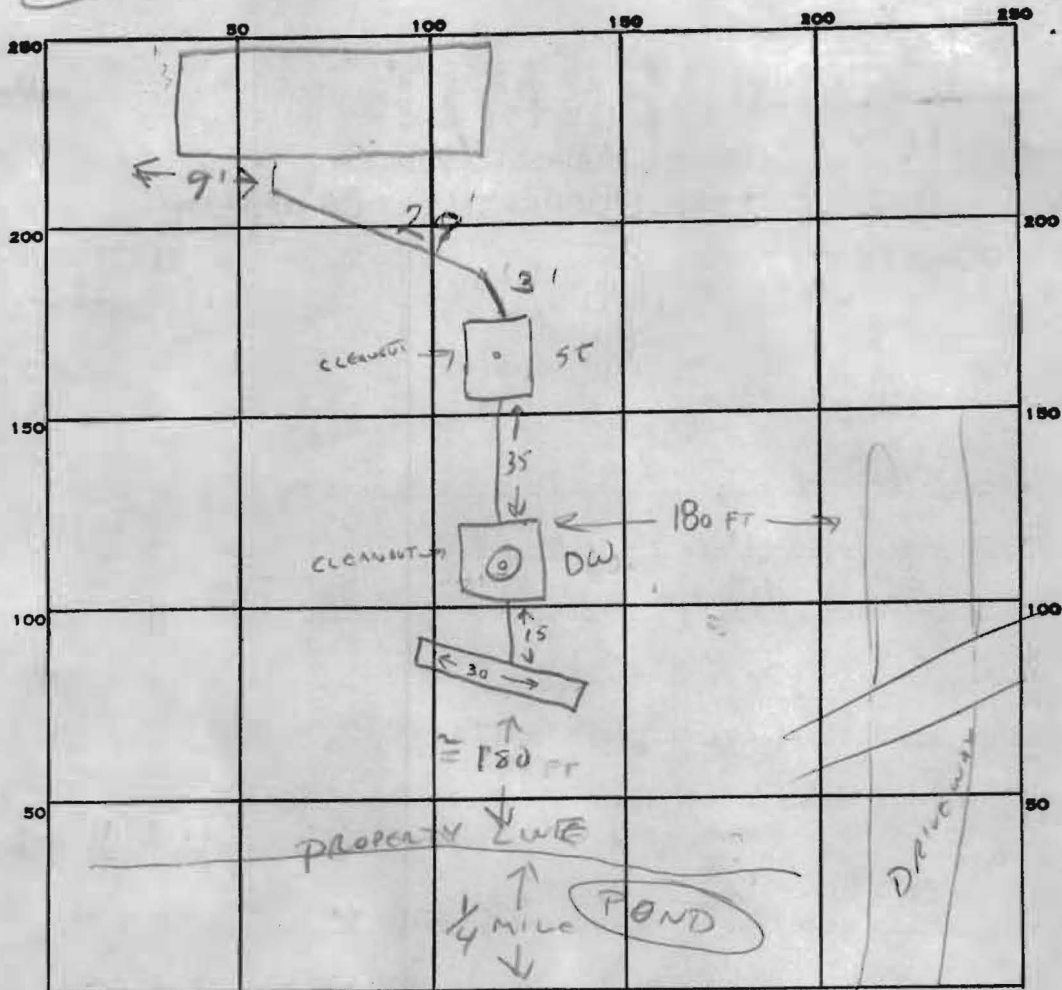

INDICATE NORTH. - NAME ADJOINING ROADWAY AS BASE LINE.

BROOKS RD

PERMIT CARD _____

SEPTIC TANK, LEVEL ✓ 1500

CLEANOUTS ST ✓ DW ✓

DISTRIBUTION BOX, LEVEL _____

TILE FIELD, DEPTH 10 FT. TRENCH WIDTH 2 FT.

GRAVEL DEPTH 6 FT IN. TOTAL LENGTH 30 FT.

NUMBER OF TRENCHES _____ TOTAL BOTTOM AREA _____

SEEPAGE PITS, INSIDE DIAMETER 60 FT. DEPTH BELOW INLET 5 FT.

ABSORBENT AREA 360 SQ. FT.

REMARKS OK TO ADD GRAVEL. - 12-27-82 CW HOUSE NOT BUILT YET.

OK TO TOWER ST + TRENCH. - MUST SEE HOUSE CONNECTION FOR FINAL
12-30-82 CW, Chan

2/8/85 House connection OK. OK to cover all work.

DATE SYSTEM APPROVED 2/8/85

INSPECTOR Stayer

Handwritten calculations:
 180
 + 360

 540
 540

 1080
 30 FT TRENCH