



# APPLICATION

## FOR PERCOLATION TESTING AND SITE EVALUATION

TEST DATE(S) \_\_\_\_\_ TEST TIME \_\_\_\_\_ A/P \_\_\_\_\_

AGENCY REVIEW: \_\_\_\_\_ DATE \_\_\_\_\_

DO NOT WRITE ABOVE THIS LINE

I HEREBY APPLY FOR THE NECESSARY TESTING/EVALUATION PRIOR TO ISSUANCE OF SEWAGE DISPOSAL SYSTEM PERMIT(S) TO:

CHECK AS NEEDED:

- CONSTRUCT NEW SEPTIC SYSTEM(S)
- REPAIR/ADD TO AN EXISTING SEPTIC SYSTEM
- REPLACE AN EXISTING SEPTIC SYSTEM

CHECK AS NEEDED:

- NEW STRUCTURE(S)
- ADDITION TO AN EXISTING STRUCTURE
- REPLACE AN EXISTING STRUCTURE

CHECK ONE:

- CREATE NEW LOT(S)
- BUILD ON AN EXISTING LOT IN A SUBDIVISION
- BUILD ON AN EXISTING PARCEL OF RECORD

IS THE PROPERTY WITHIN 2500' OF ANY RESERVOIR?

- YES
- NO

THE TYPE OF STRUCTURE IS:

- RESIDENTIAL WITH \_\_\_\_\_ PROPOSED BEDROOMS IN THE COMPLETED STRUCTURE (NOTE **UNKNOWN** IF APPROPRIATE)
- COMMERCIAL (PROVIDE DETAIL OF NUMBERS AND TYPES OF EMPLOYEES/ CUSTOMERS ON ACCOMPANYING PLAN)
- INSTITUTIONAL/GOVERNMENT (PROVIDE DETAIL OF NUMBERS AND TYPES OF EMPLOYEES/USERS ON ACCOMPANYING PLAN)

PROPERTY OWNER(S) \_\_\_\_\_

DAYTIME PHONE \_\_\_\_\_ CELL \_\_\_\_\_ FAX \_\_\_\_\_

MAILING ADDRESS \_\_\_\_\_  
STREET CITY/TOWN STATE ZIP

APPLICANT \_\_\_\_\_

DAYTIME PHONE \_\_\_\_\_ CELL \_\_\_\_\_ FAX \_\_\_\_\_

MAILING ADDRESS \_\_\_\_\_  
STREET CITY/TOWN STATE ZIP

APPLICANT'S ROLE: DEVELOPER BUILDER BUYER RELATIVE/FRIEND REALTOR CONSULTANT

PROPERTY LOCATION  
SUBDIVISION/PROPERTY NAME \_\_\_\_\_ LOT NO. \_\_\_\_\_

PROPERTY ADDRESS \_\_\_\_\_  
STREET TOWN/POST OFFICE

TAX MAP PAGE(S) \_\_\_\_\_ GRID \_\_\_\_\_ PARCEL(S) \_\_\_\_\_ PROPOSED LOT SIZE \_\_\_\_\_

AS APPLICANT, I UNDERSTAND THE FOLLOWING: THE SYSTEM INSTALLED SUBSEQUENT TO THIS APPLICATION IS ACCEPTABLE ONLY UNTIL PUBLIC SEWERAGE IS AVAILABLE. THIS APPLICATION IS COMPLETE WHEN ALL APPLICABLE FEES AND A SUITABLE SITE PLAN HAVE BEEN RECEIVED. I ACCEPT THE RESPONSIBILITY FOR COMPLIANCE WITH ALL M.O.S.H.A. AND "MISS UTILITY" REQUIREMENTS. APPROVAL IS BASED UPON SATISFACTORY REVIEW OF A PERC CERTIFICATION PLAN. TEST RESULTS WILL BE MAILED TO APPLICANT.

\_\_\_\_\_  
SIGNATURE OF APPLICANT

HOWARD COUNTY HEALTH DEPARTMENT, BUREAU OF ENVIRONMENTAL HEALTH, WELL AND SEPTIC PROGRAM  
3525-H ELLICOTT MILLS DRIVE, ELLICOTT CITY, MARYLAND 21043-4544 (410) 313-1771 FAX (410) 313-2648  
TDD (410) 313-2323 TOLL FREE 1-877-4MD-DHMH

NP (A)  
 Red Br Si Cl Loam  
 ~10% Rock  
 3'-3.5'  
 Br Sa Loam  
 25-50% Rock  
 7'  
 >50% Rock  
 Hard Bottom  
 7.5'

(B)  
 Br Cl Loam and Loam  
 ~10% Rock  
 5'  
 Br Sa Loam  
 15-20% Rock  
 7'  
 Hard Bottom

(C)  
 Br Loam  
 2'  
 Yellow Sa Loam  
 one pocket of ~35% Rock  
 ~10% Rock / Saprolite Throughout  
 Rest of Hole  
 12'

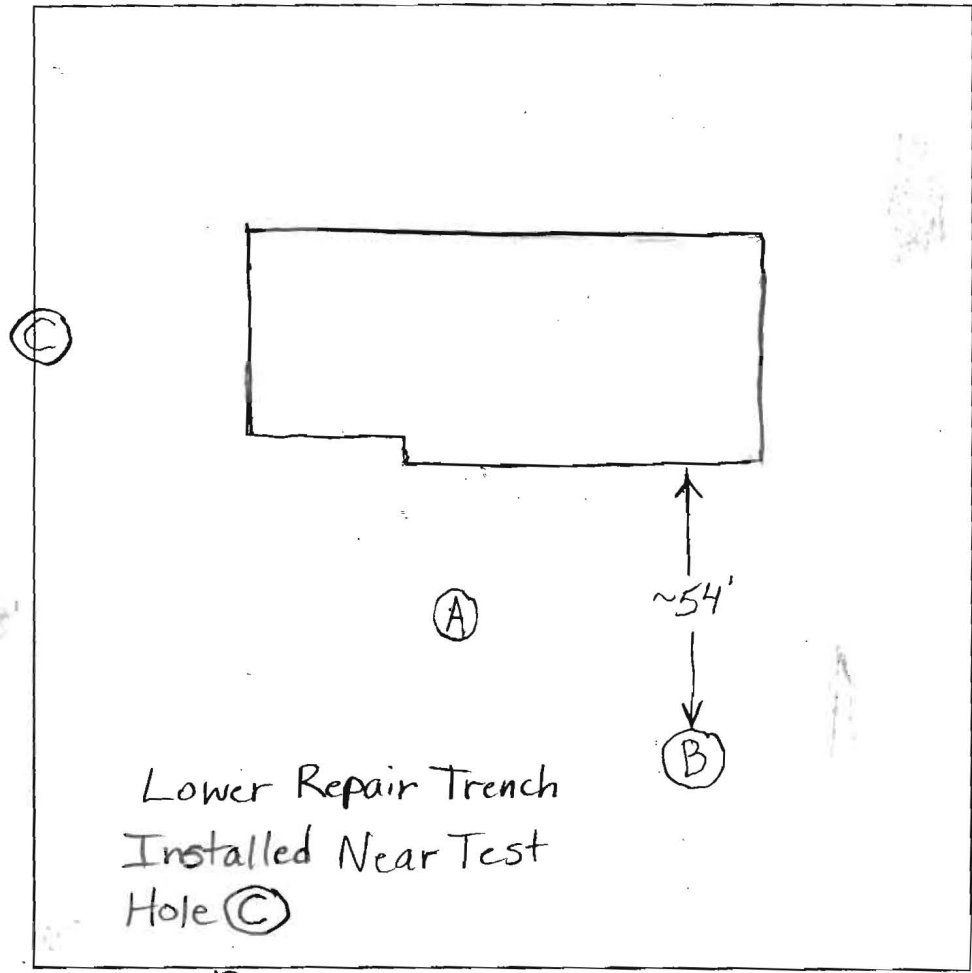

Breezewood Drive

| DATE  | TEST # | DEPTH | START          | BREAK 1" DROP | STOP 2" DROP | TIME OF 2nd INCH | P/F/H |
|---|--------|-------|----------------|---------------|--------------|------------------|-------|
| 7/21/04   | A      | 7.5'  |                |               |              |                  | (F)   |
|   | B      | 7'    | May Perc at 3' |               |              |                  | H     |
|   | C      | 12' V |                |               |              |                  | P     |
| Location of Hole C used For Repair, Best Material and Farther From Downhill Wells |        |       |                |               |              |                  |       |

REMARKS Well Across Street and Downhill From Front Yard  
 SANITARIAN B. Baker BACKHOE Linsemyer OTHERS \_\_\_\_\_  
 TEST HOLES USED IN SDA C AVG. PERC TIME \_\_\_\_\_ SQ. FT/BR \_\_\_\_\_  
 TRENCH WIDTH \_\_\_\_\_ INLET DEPTH \_\_\_\_\_ MAX. BOT DEPTH \_\_\_\_\_ EFFECTIVE SW \_\_\_\_\_

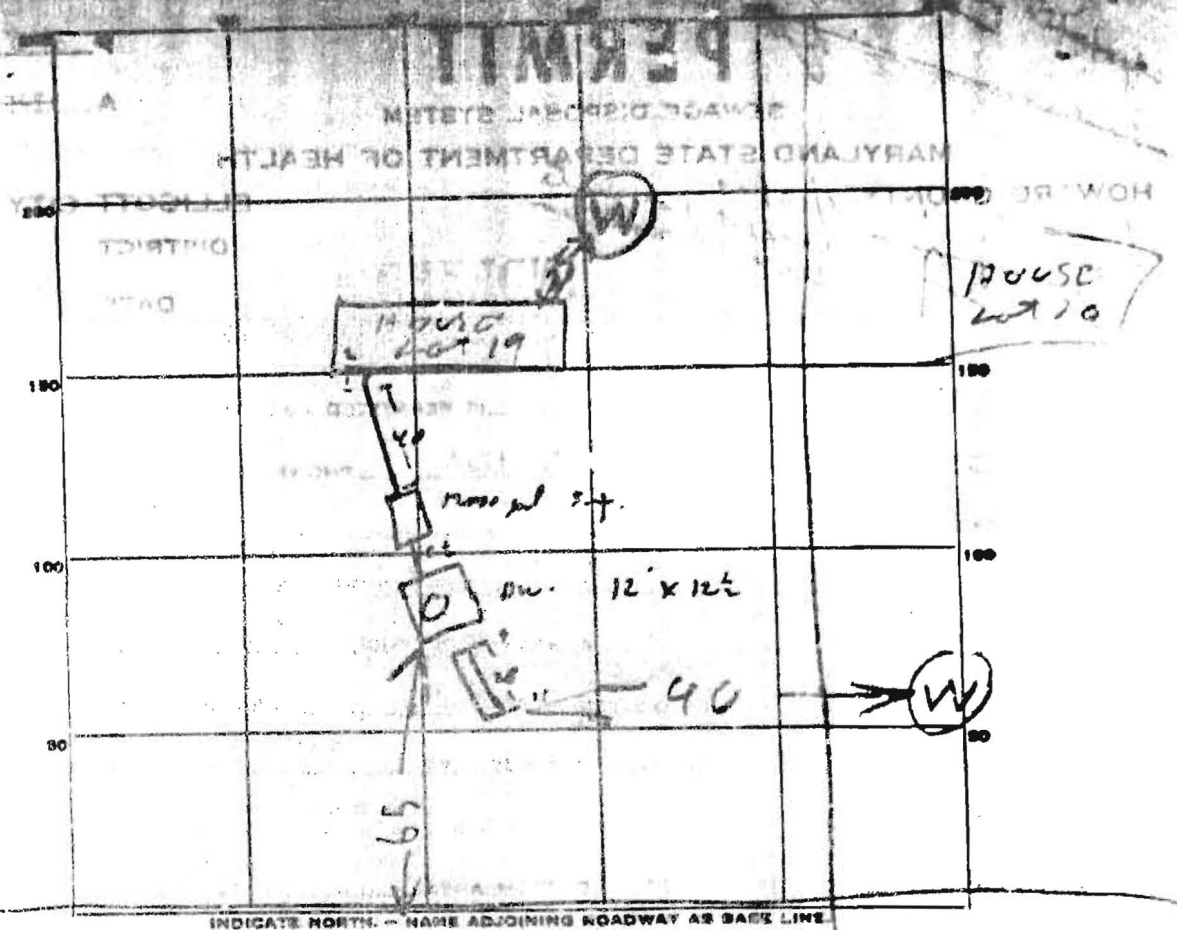

INDICATE NORTH - NAME ADJOINING ROADWAY AS BASE LINE

PERMIT CARD \_\_\_\_\_

SEPTIC TANK LEVEL \_\_\_\_\_ CLEANOUTS \_\_\_\_\_

DISTRIBUTION BOX LEVEL \_\_\_\_\_

|                               |                    |                   |        |  |     |
|-------------------------------|--------------------|-------------------|--------|--|-----|
| TILE FIELD, DEPTH             | 9-11 (incl 10) FT. | TRENCH WIDTH      | 2 FT.  |  |     |
| GRAVEL DEPTH                  | 6 FT.              | TOTAL LENGTH      | 26 FT. |  | 98  |
|                               |                    |                   |        |  | 7   |
|                               |                    |                   |        |  | 348 |
| NUMBER OF TRENCHES            | 1                  | TOTAL BOTTOM AREA | 156    |  |     |
|                               |                    |                   |        |  | 28  |
| STORAGE PITS, INSIDE DIAMETER | 49 FT.             | DEPTH BELOW INLET | 7 FT.  |  | 6   |
|                               |                    |                   |        |  | 156 |
| ABSORBENT AREA                | 499                | SQ. FT.           |        |  | 499 |

REMARKS 10/18/76 R.M.  
 10/19/76 - STONE ADDED TO DITCH TODAY  
 SYSTEM OK EXCEPT HOUSESEWER NOT  
 TIED TO HOUSE. COVER DW & DITCH  
 CONNECT HOUSE SEWER TO HOUSE & CALL FOR  
 INSPECTION RIT 10/20/76 NO ADDITIONAL WORKING RIT  
 11/13/77 - HOUSESEWER OK  
 SYSTEM APPROVED 11/13/77 INSPECTOR Raymond Hodge

# APPLICATION

STANDARD

STOPS A

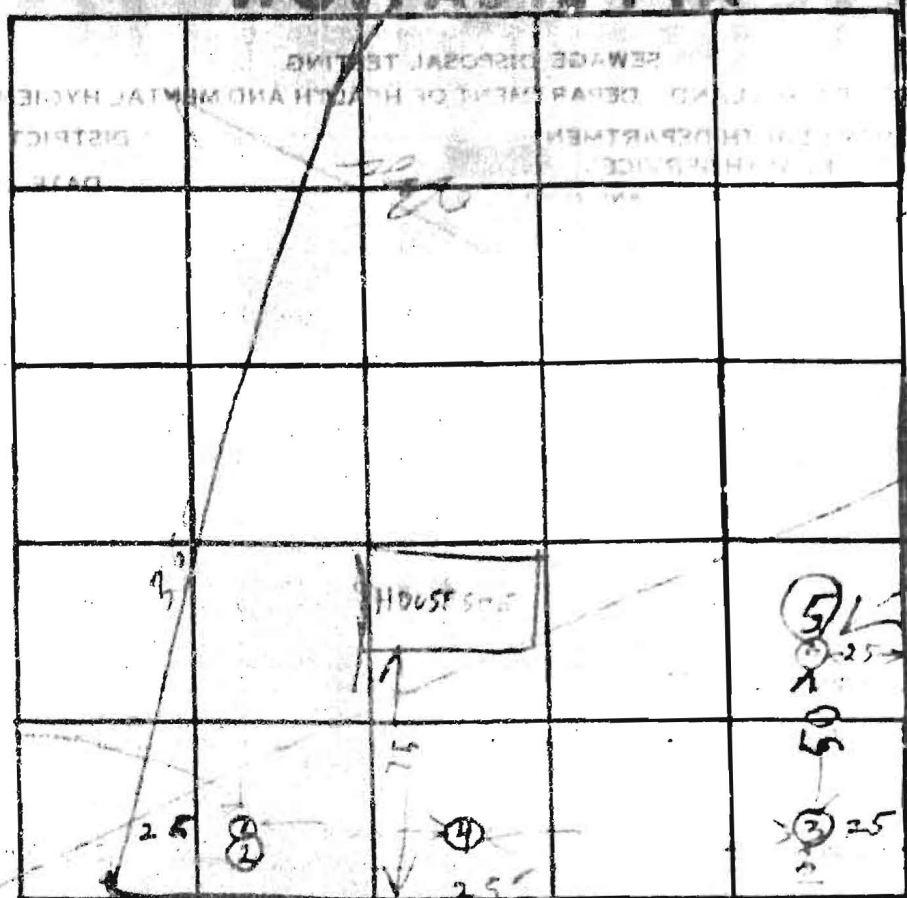

INDICATE NORTH - NAME ADJOINING PROPERTY OR BASE LINE

APPROXIMATE OR

| DATE    | TEST NO. | DEPTH  | PRE-WET  |      | TEST - 1" DROP |      | TIME |
|---------|----------|--------|----------|------|----------------|------|------|
|         |          |        | START    | STOP | START          | STOP |      |
| 4/13/73 | 1        | 9 1/2  | 210      | 211  | 211            | 214  | 3    |
| 4/13/73 | 2        | 4 1/2  | 210      | 211  | 211            | 214  | 3    |
|         | 3        | 11     | all sand |      | PRY            |      |      |
|         | 4        | 11     | all sand |      | PRY            |      |      |
|         | 5        | 4      | 219      | 221  | 221            | 223  | 2    |
| 4/13/73 | 6        | 11 1/2 | 219      | 220  | 220            | 223  | 3    |
|         |          |        |          |      |                |      |      |
|         |          |        |          |      |                |      |      |
|         |          |        |          |      |                |      |      |
|         |          |        |          |      |                |      |      |

arter  
3 m  
gran  
4F

REMARKS \_\_\_\_\_

TYPE OF SOIL \_\_\_\_\_

TESTED BY B. Dodge ALSO PRESENT lot 19 sect

301°33'07"E 34.30'

A17984

Drainage easement

I certify that all elevations & locations are correct.

Richard L. Jupp  
17959 Woodland Rd  
Woodland, CA  
MR. 328-2722

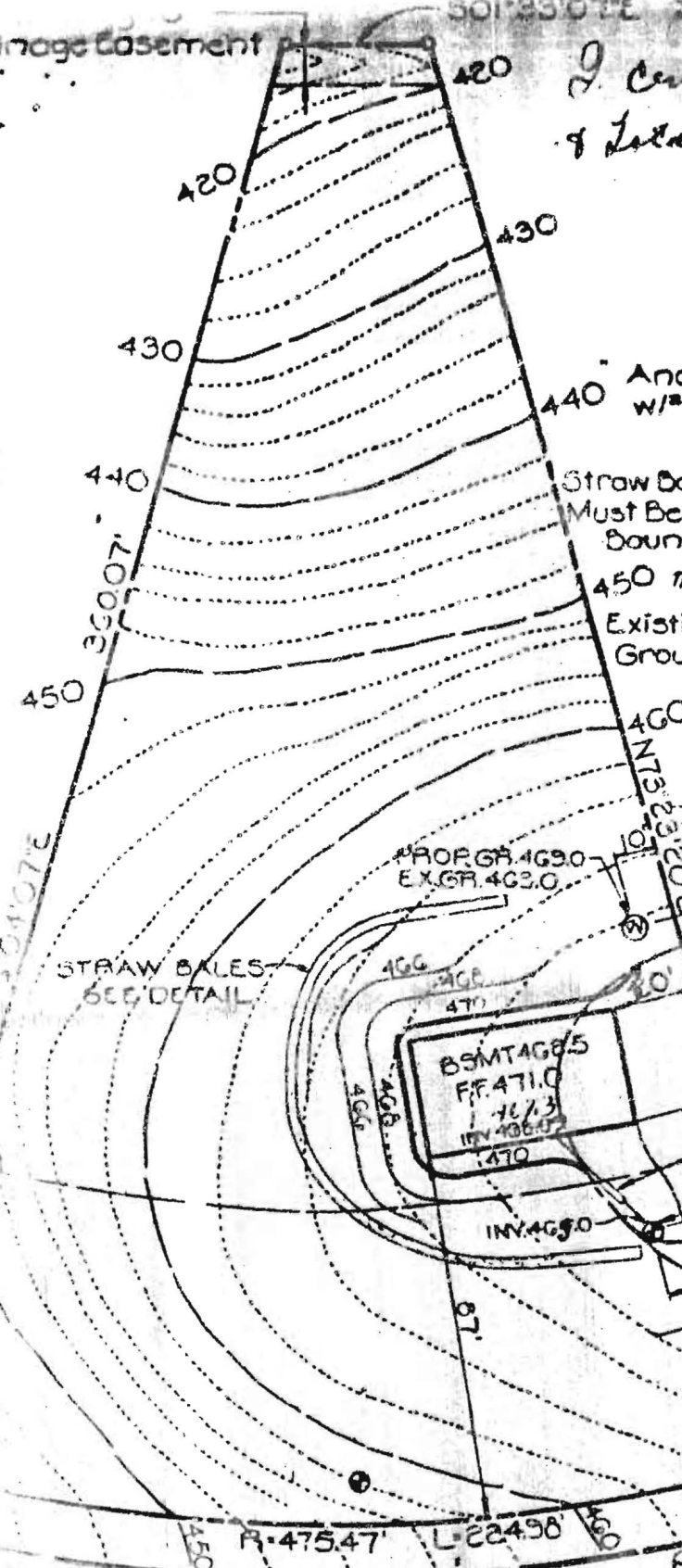

Anchor Straw Bales w/ 4 Metal Bars

Place Adjacent Straw Bales Tightly

Straw Bales Must Be Wire Bound

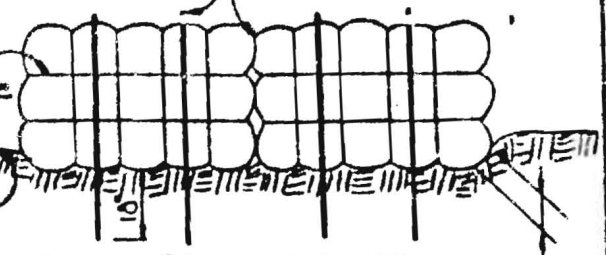

Existing Ground

Access Straw Bales 2" Below Existing Ground

### STRAW BALE DETAIL

No Scale

PROP. GR. 469.0  
EX. GR. 462.0

⊙ Denotes location of field percolation tests

PROP. 1000 GALLON SEPTIC TANK INV. 467.0

PROP. DRY WELL EL. @ TIME OF PERC. TEST 470.0 EL. FINISHED GRADE 470.0

15' House to Septic Tank In.

7' Tank to Dry Well. Inv.

BSMTAGS  
FF. 471.0  
11.2.3  
INV. 466.0

INV. 465.0

R-475.47 L-22498

BREELEWOOD FARMS

### PLAN TO ACCOMPANY

WOOD DRIVE APPLICATION FOR BUILDING PERMIT

PLANS OK RH 7/17/76

LOT 19

SECTION 4