

9/23/70
after 1 PM

9/23/70 approved JDD
P 13012

PERMIT

SEWAGE DISPOSAL SYSTEM

A 13012

MARYLAND STATE DEPARTMENT OF HEALTH

HOWARD COUNTY

ELLICOTT CITY

INDEXED

DISTRICT 5

DATE 9/2/70

Frank Hartsh IS PERMITTED TO INSTALL ALTER

ADDRESS Bayan Oak Ave., Baltimore, Md. PHONE VI 4-1500

A SEWAGE DISPOSAL SYSTEM LOCATED AT _____

SUBDIVISION Headmark, Inc. ROAD Carroll Mill LOT 23, Blk. B,

PROPERTY OWNER Mark A. Wakefield, Jr. Sec. 2

ADDRESS _____

SPECIFICATIONS - 4 bedrooms

DRAIN FIELD _____ DEPTH _____ FEET, BOTTOM AREA _____ SQ. FT.

SEEPAGE PITS _____ ABSORBENT SIDE-WALL AREA _____ SQ. FT.

SEPTIC TANK CAPACITY 1,000 GALLONS

FOR GARBAGE GRINDER, INCREASE DISPOSAL AREA 22% & TANK CAPACITY 50%.

OTHER Dry well - 100 sq. ft. absorbent sidewall area per bedroom to begin below
1 1/2 inch pipe. Max. depth permitted for dry well below original grade is 12 ft.
Place dry well about 130 ft. from front lot line and about 65 ft. from left side line
as seen when facing from Carroll Mill Road.

NOTE: ALL PIPES FROM HOUSE TO SEPTIC TANK MUST BE CAST IRON.
PERMIT VOID AFTER THREE YEARS.

PLANS APPROVED BY D. W. Morrison DATE 3/12/69

FILL SEPTIC TANK AND DISTRIBUTION BOX WITH WATER BEFORE CALLING FOR AN INSPECTION. COVER NO WORK UNTIL INSPECTED AND APPROVED.

NEITHER THE HOWARD COUNTY COMMISSIONERS NOR THE HEALTH DEPARTMENT IS RESPONSIBLE FOR THE SUCCESSFUL OPERATION OF ANY SYSTEM.

A 13012

$\frac{11}{4}$
 $\frac{44}{96}$
 $\frac{220}{336}$
 $\frac{4180}{4180}$

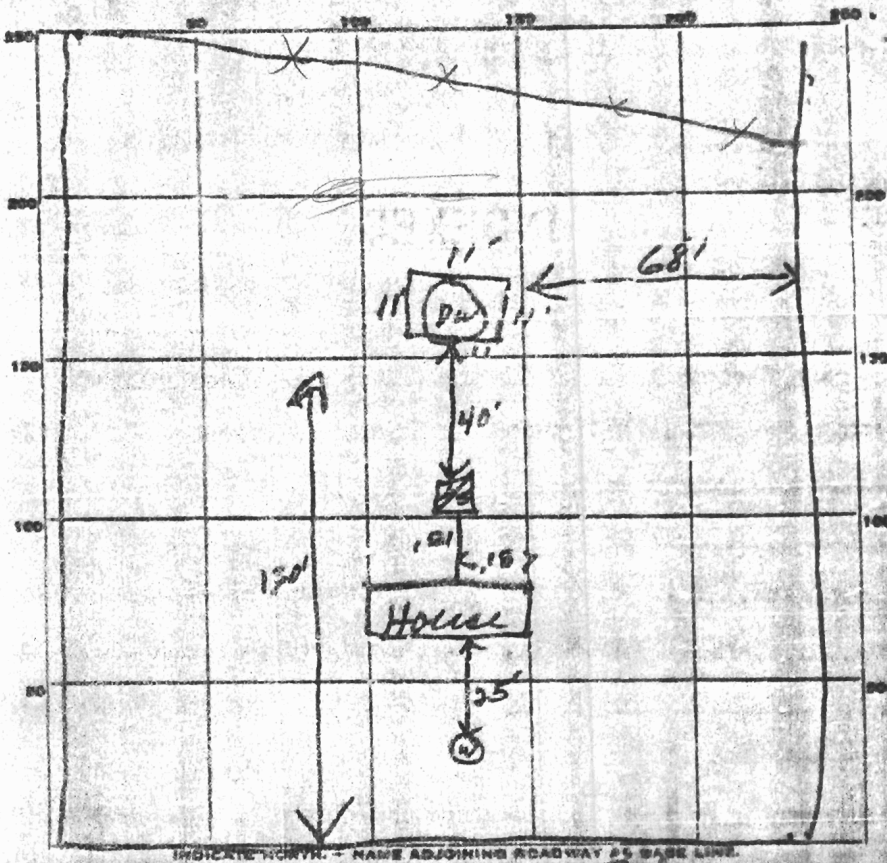

PERMIT CARD CK Corrall Mill Rd
 SEPTIC TANK, LEVEL cont 1000 CLEANOUTS _____
 DISTRIBUTION BOX, LEVEL _____
 TILE FIELD, DEPTH _____ FT. TRENCH WIDTH _____ FT.
 GRAVEL DEPTH _____ IN. TOTAL LENGTH _____ FT.
 NUMBER OF TRENCHES _____ TOTAL BOTTOM AREA _____
 SEEPAGE PITS, INSIDE DIAMETER 9 FT. DEPTH BELOW INLET 9 1/2 FT.
 ABSORBENT AREA 418⁺ SQ. FT.
 REMARKS _____

 DATE SYSTEM APPROVED 9/13/70 INSPECTOR JTS