

4/10/02
10:00

PUB. SEWER STATUS VERIFIED BY _____

ISSUE DATE: 7/01/2002

P 517343

APPROVAL DATE: 7/10/02

**PERMIT
INDEXED**

A REPAIR

**ON-SITE SEWAGE DISPOSAL SYSTEM
HOWARD COUNTY HEALTH DEPARTMENT
BUREAU OF ENVIRONMENTAL HEALTH**

Hatfields Equipment IS PERMITTED TO INSTALL ALTER

ADDRESS: 13785 Burntwoods Rd., Glenelg PHONE NUMBER: 301-854-6172

SUBDIVISION: _____ LOT NUMBER: _____

ADDRESS: 8115 Murphy Road PROPERTY OWNER: Charles Iager, Jr.

SEPTIC TANK CAPACITY (GALLONS): 24

PUMP CHAMBER CAPACITY (GALLONS): _____

NUMBER OF BEDROOMS: 4

SQUARE FEET PER BEDROOM: 130'

LINEAR FEET OF TRENCH REQUIRED: 90

TRENCHES:	Trench to be <u>2</u> feet wide. Inlet <u>4</u> feet below original grade. Bottom maximum depth <u>10</u> feet below original grade. Effective area begins at <u>4</u> feet below original grade. <u>6</u> feet of stone below distribution pipe.
LOCATION:	Existing septic system is failing. Call for inspection when ground is opened.
PURPOSE:	

PLANS APPROVED: MR/KW DATE: 7/01/2002

- NOTE: PERMIT VOID AFTER 2 YEARS
- NOTE: CONTRACTOR RESPONSIBLE FOR SCHEDULING A PRE-CONSTRUCTION INSPECTION FOR ALL INSTALLATIONS
- NOTE: WATERTIGHT SEPTIC TANKS REQUIRED
- NOTE: ALL PARTS OF SEPTIC SYSTEM SHALL BE 100 FEET FROM ANY WATER WELL
- NOTE: MANHOLE RISERS REQUIRED ON ALL SEPTIC TANKS AND PUMP CHAMBERS

**NEITHER THE HOWARD COUNTY COUNCIL NOR THE HEALTH DEPARTMENT IS
RESPONSIBLE FOR THE SUCCESSFUL OPERATION OF ANY SYSTEM
PERMITTEE RESPONSIBLE FOR OBTAINING FINAL APPROVAL ON THIS PERMIT
CALL 410-313-2640 FOR INSPECTION OF SEPTIC SYSTEM**

P517343

NOT TO SCALE

Approx
property
line

INDEXED

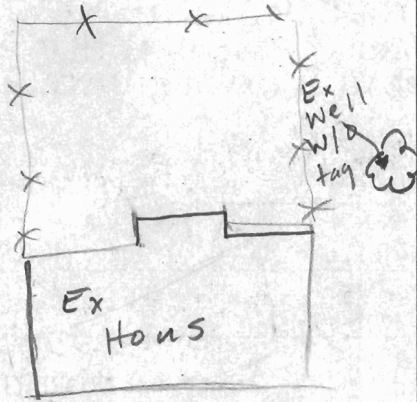

Ex.
Barn

SPAC
DRIVE

5050-As-30

ROAD

Murphy

TRENCH/DRAINFIELD DATA

WIDTH _____ INLET _____ BOTTOM _____

NUMBER OF TRENCHES _____

TOTAL LENGTH _____

ABSORPTION AREA _____

DISTRIBUTION BOX LEVEL _____

DISTRIBUTION BOX BAFFLE _____

DISTRIBUTION BOX PORT _____

SEPTIC TANK DATA

SEPTIC TANK 1 LEVEL Existing

CAPACITY _____ GAL

SEAM LOC _____

TANK LID DEPTH _____

BAFFLES _____

BAFFLE FILTER _____

MANHOLE LOC _____

6" PORT LOC _____

WATERTIGHT TEST _____

SEPTIC TANK 2 LEVEL _____

CAPACITY _____ GAL

SEAM LOC _____

TANK LID DEPTH _____

BAFFLES _____

BAFFLE FILTER _____

MANHOLE LOC _____

6" PORT LOC _____

WATERTIGHT TEST _____

PRE-CONSTRUCTION 7/1/02 Failing system. 1st trench being used. D.W. pumped. Adding another trench 90'

INSTALLATION in contour. Replacing pipe out of d.w. - possible clog since trench not failing. MR/KN

FINAL INSPECTOR Kacie Roman DATE OF APPROVAL 7/10/02

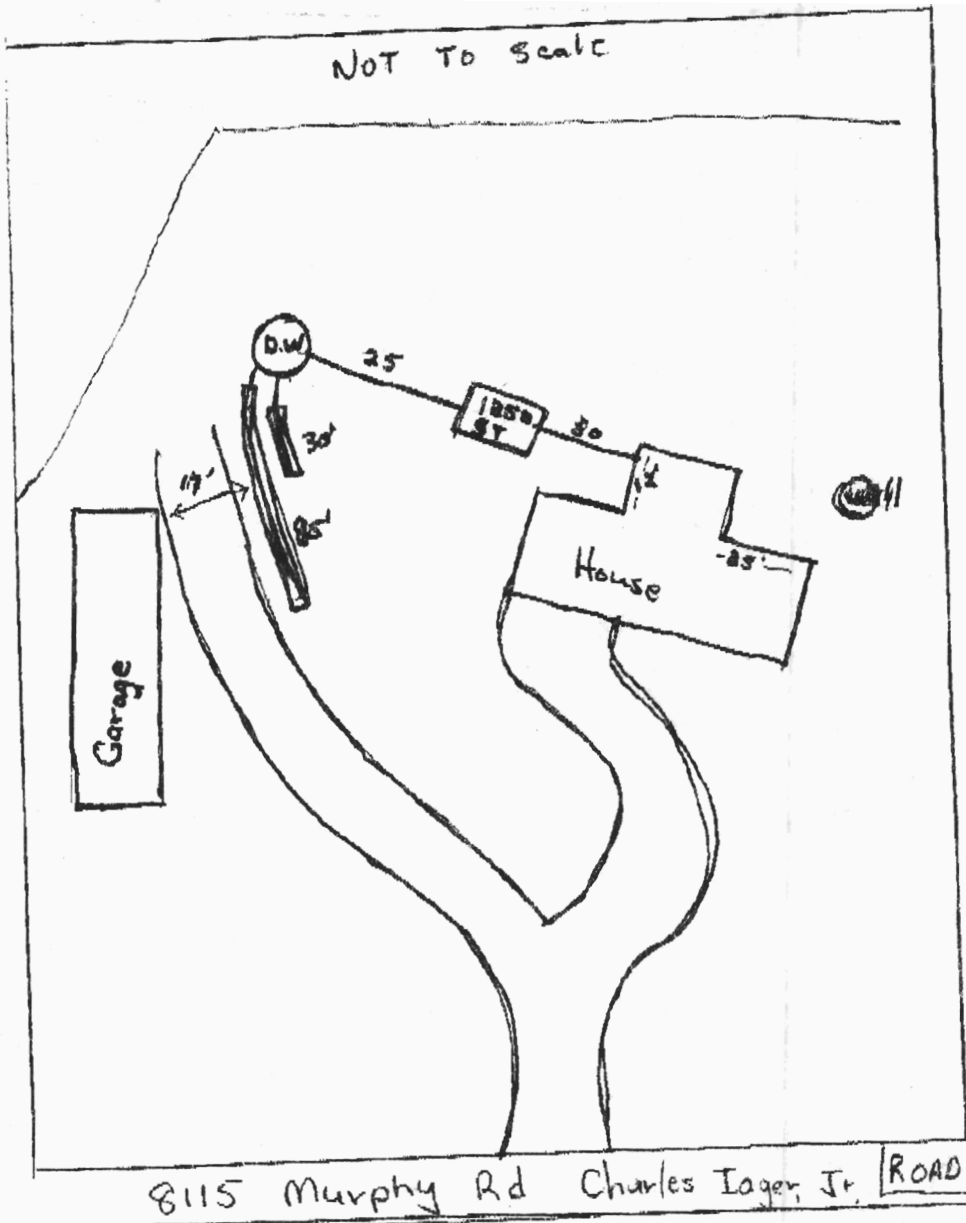

7/10/02
 No Insp.
 due to
 insp. demands.
 for this
 day KN

Both Trenches Redone 2 ft wide 10ft deep 4ft
 stone 7/01/02 Hatfields Equipment 301-854-6172

Fax Mo Co Health Dept.
 410-213-2648
 Aton Kacey