

LAYOUT 7/19/02 2:00 INSP 4 _____
 INSP 2 _____ INSP 5 _____
 INSP 3 _____ INSP 6 _____

ISSUE DATE: 7/16/02

APPROVAL DATE: 7/19/02

**PERMIT
INDEXED**

P 517367
 A REPAIR
516991

**ON-SITE SEWAGE DISPOSAL SYSTEM
 HOWARD COUNTY HEALTH DEPARTMENT
 BUREAU OF ENVIRONMENTAL HEALTH**

02-235587

South Carroll Backhoe, Inc _____ IS PERMITTED TO INSTALL ALTER

ADDRESS: 4410 Salem Bottom Road, 21157 PHONE NUMBER: 410-875-4197

SUBDIVISION: Ten Oaks Farm LOT NUMBER: 12

ADDRESS: 5030 Morningstar Drive PROPERTY OWNER: George Doetsch

SEPTIC TANK CAPACITY (GALLONS): 1000 OUTLET BAFFLE FILTER REQUIRED

PUMP CHAMBER CAPACITY (GALLONS): N/A COMPARTMENTED TANK REQUIRED

NUMBER OF BEDROOMS: 3

SQUARE FEET PER BEDROOM: 80

LINEAR FEET OF TRENCH REQUIRED: 135 75 HOUSE SERVED BY PUBLIC WATER

TRENCHES:	Trench to be 2.0 feet wide. Inlet 3.0 feet below original grade. Bottom maximum depth 7.0 feet below original grade. Effective area begins at 3.0 feet below original grade. 4.0 feet of stone below distribution pipe.
LOCATION:	Place the distribution box 50' off the 889.59' lot line and 55' off the closest corner of the existing garage. Run two trenches on contour toward the 889.59' lot line.
NOTES:	In support of adding plumbing to the existing garage. <u>sized for 50% of avg. residential flow</u>

PLANS APPROVED: MER DATE: 7/16/02

NOTES: PERMIT VOID AFTER 2 YEARS
 CONTRACTOR IS RESPONSIBLE FOR SCHEDULING A PRE-CONSTRUCTION INSPECTION FOR ALL INSTALLATIONS
 WATERTIGHT SEPTIC TANKS REQUIRED
 ALL PARTS OF SEPTIC SYSTEM SHALL BE 100 FEET FROM ANY WATER WELL UNLESS SPECIFICALLY AUTHORIZED
 MANHOLE RISERS REQUIRED ON ALL SEPTIC TANKS AND PUMP CHAMBERS UNLESS SPECIFICALLY AUTHORIZED
 CONTRACTOR RESPONSIBLE FOR COMPLIANCE WITH APPLICABLE REGULATIONS, GUIDELINES AND THE TERMS OF THIS PERMIT

**NEITHER THE HOWARD COUNTY COUNCIL NOR THE HEALTH DEPARTMENT IS
 RESPONSIBLE FOR THE SUCCESSFUL OPERATION OF ANY SYSTEM
 PERMITTEE RESPONSIBLE FOR OBTAINING FINAL APPROVAL ON THIS PERMIT
 ALL 410-313-2640 FOR INSPECTION OF SEPTIC SYSTEM**

D517367

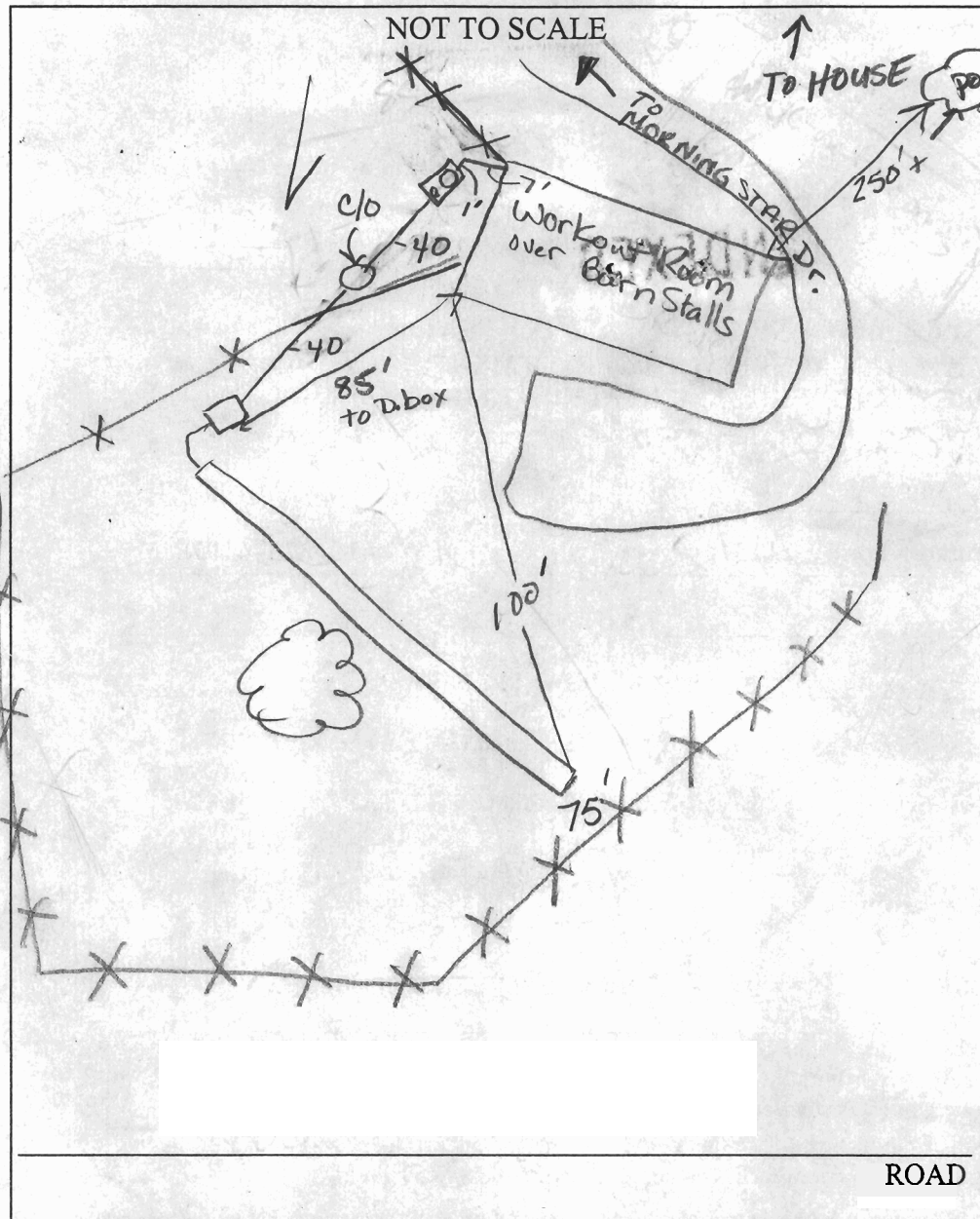

TRENCH/DRAINFIELD DATA		
WIDTH	INLET	BOTTOM
2	3	7
NUMBER OF TRENCHES <u>1</u>		
TOTAL LENGTH <u>75'</u>		
ABSORPTION AREA <u>300ft²</u>		
DISTRIBUTION BOX LEVEL <u>Y</u>		
DISTRIBUTION BOX BAFFLE <u>Y</u>		
DISTRIBUTION BOX PORT _____		

SEPTIC TANK DATA	
SEPTIC TANK 1 LEVEL	<u>yes</u>
CAPACITY	<u>1,000</u> GAL
SEAM LOC	<u>TOP</u>
TANK LID DEPTH	<u>8-10"</u>
BAFFLES	<u>OK</u>
BAFFLE FILTER	<u>N/A</u>
MANHOLE LOC	<u>Toward Building</u>
6" PORT LOC	<u>SIDE OF FIELD</u>
WATERTIGHT TEST	<u>No</u>
SEPTIC TANK 2 LEVEL	<u>N/A</u>
CAPACITY	_____ GAL
SEAM LOC	_____
TANK LID DEPTH	_____
BAFFLES	_____
BAFFLE FILTER	_____
MANHOLE LOC	_____
6" PORT LOC	_____
WATERTIGHT TEST	_____

PRE-CONSTRUCTION _____

INSTALLATION 7-19-02 1-75' trench Owner ok'd to expose man hole to surface of ground. Inspector ok'd lid under ground surface for equine/riding safety. Specs created by MR. OK TO COVER ALL WORK (KN)

FINAL INSPECTOR Noonan Kame DATE OF APPROVAL 7-19-02



HOWARD COUNTY HEALTH DEPARTMENT

A516991

DATE 5/24/2002

Received From Julius A Hader / B+CJ Construction 410-340-2580
5909 Tamar Dr. Unit 3, Columbia MD 21045

For Pesc Application
Tom Oaks Farm - Lot 12
NO. 8160
Two hundred twenty-five and 00/100 Dollars

\$ 225 | 00

Received By Mary L Bugge

BRANCH BANKING AND TRUST COMPANY
COLUMBIA, MARYLAND

8160

JULIUS A. HADER 12/97
DBA B&CJ CONSTRUCTION
5909 TAMAR DR. UNIT 3
COLUMBIA, MD 21045-4036

65-330/550
36801

5/24/02

PAY TO THE ORDER OF Howard County Dept of Finance \$ 225⁰⁰
Two hundred twenty-five and 00/100 DOLLARS

MEMO _____

[Signature]

⑈008160⑈ ⑆055003308⑆ 5150825948⑈

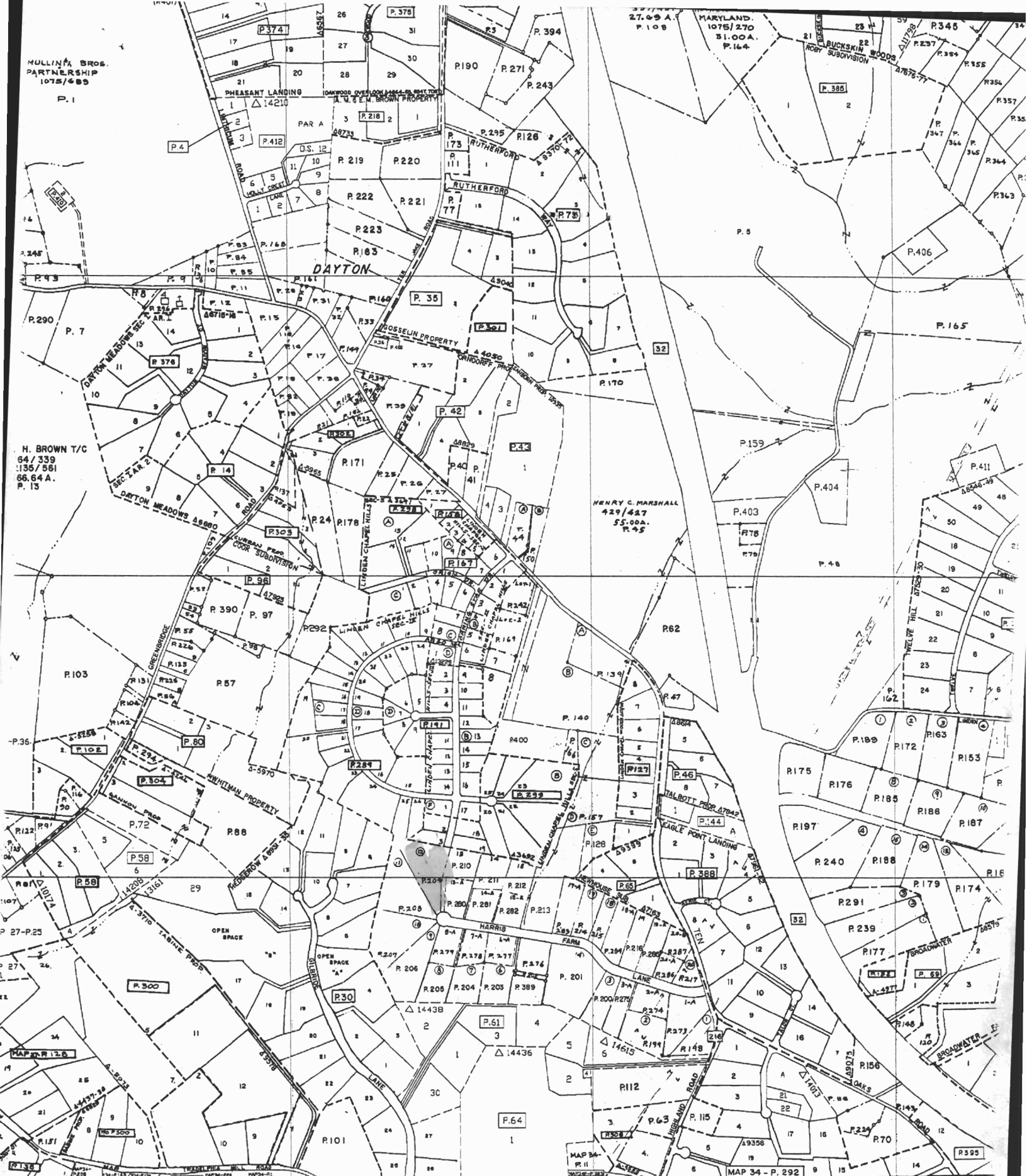

793.4mN
025.0mE

COPYRIGHT - 1992 BY THE STATE OF MARYLAND
ALL RIGHTS RESERVED.

THESE MAPS ARE PROTECTED BY COPYRIGHT. THEY MAY NOT BE COPIED OR REPRODUCED IN ANY FORM INCLUDING ELECTRONIC MEANS SUCH AS: DIGITIZING, SCANNING, VECTORIZING, OR IMAGE PROCESSING, OR BY ANY SYSTEM NOW KNOWN OR TO BE INVENTED WITHOUT PERMISSION IN WRITING FROM THE MARYLAND DEPARTMENT OF PLANNING.

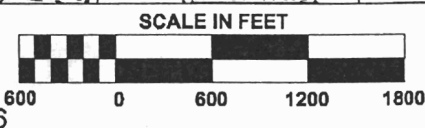

34
MARYLAND DEPARTMENT OF PROPERTY
This information shown is descriptive and does not constitute a legal description. The Maryland Department of Planning, Room 1185, 381 W. Free
REVISED TO:

803

806

809