

6/5/02
11:00

6/11/02 3:00

05-344328

PUB. SEWER STATUS VERIFIED BY MLB/ENC

ISSUE DATE: 6/3/2002

APPROVAL DATE: 6/11/02

**PERMIT
INDEXED**

P 517000-B

A 517000-B
REPAIR

**ON-SITE SEWAGE DISPOSAL SYSTEM
HOWARD COUNTY HEALTH DEPARTMENT
BUREAU OF ENVIRONMENTAL HEALTH**

Fogles Septic Clean, Inc IS PERMITTED TO INSTALL ALTER

ADDRESS: 580 Obrecht Road, Sykesville PHONE NUMBER: 410-795-5670

SUBDIVISION: Mooresfield LOT NUMBER: 17

ADDRESS: 7445 Cherry Tree Drive PROPERTY OWNER: James Panesci

SEPTIC TANK CAPACITY (GALLONS): EX 1000 gal.

PUMP CHAMBER CAPACITY (GALLONS): N/A

NUMBER OF BEDROOMS: 3

SQUARE FEET PER BEDROOM: 180

LINEAR FEET OF TRENCH REQUIRED: 108

TRENCHES:	Trench to be <u>2</u> feet wide. Inlet <u>4</u> feet below original grade. Bottom maximum depth <u>10</u> feet below original grade. Effective area begins at <u>4</u> feet below original grade. <u>6</u> feet of stone below distribution pipe.
LOCATION:	Existing septic system is failing. Call for inspection when ground is opened.
PURPOSE:	

PLANS APPROVED: MR DATE: 4/22/02

- NOTE: PERMIT VOID AFTER 2 YEARS
- NOTE: CONTRACTOR RESPONSIBLE FOR SCHEDULING A PRE-CONSTRUCTION INSPECTION FOR ALL INSTALLATIONS
- NOTE: WATERTIGHT SEPTIC TANKS REQUIRED
- NOTE: ALL PARTS OF SEPTIC SYSTEM SHALL BE 100 FEET FROM ANY WATER WELL
- NOTE: MANHOLE RISERS REQUIRED ON ALL SEPTIC TANKS AND PUMP CHAMBERS

**NEITHER THE HOWARD COUNTY COUNCIL NOR THE HEALTH DEPARTMENT IS
RESPONSIBLE FOR THE SUCCESSFUL OPERATION OF ANY SYSTEM
PERMITTEE RESPONSIBLE FOR OBTAINING FINAL APPROVAL ON THIS PERMIT
CALL 410-313-2640 FOR INSPECTION OF SEPTIC SYSTEM**

A 517000-B

NOT TO SCALE

TRENCH/DRAINFIELD DATA

WIDTH	INLET	BOTTOM
2'	4'	10'
NUMBER OF TRENCHES		1
TOTAL LENGTH		90'
ABSORPTION AREA		540 ft
DISTRIBUTION BOX LEVEL		<input checked="" type="checkbox"/>
DISTRIBUTION BOX BAFFLE		<input checked="" type="checkbox"/>
DISTRIBUTION BOX PORT		<input type="checkbox"/>

SEPTIC TANK DATA

SEPTIC TANK 1 LEVEL		
CAPACITY	EX 100	GAL
SEAM LOC		
TANK LID DEPTH		
BAFFLES		
BAFFLE FILTER		
MANHOLE LOC		
6" PORT LOC		
WATERTIGHT TEST		
SEPTIC TANK 2 LEVEL		
CAPACITY		GAL
SEAM LOC		
TANK LID DEPTH		
BAFFLES		
BAFFLE FILTER		
MANHOLE LOC		
6" PORT LOC		
WATERTIGHT TEST		

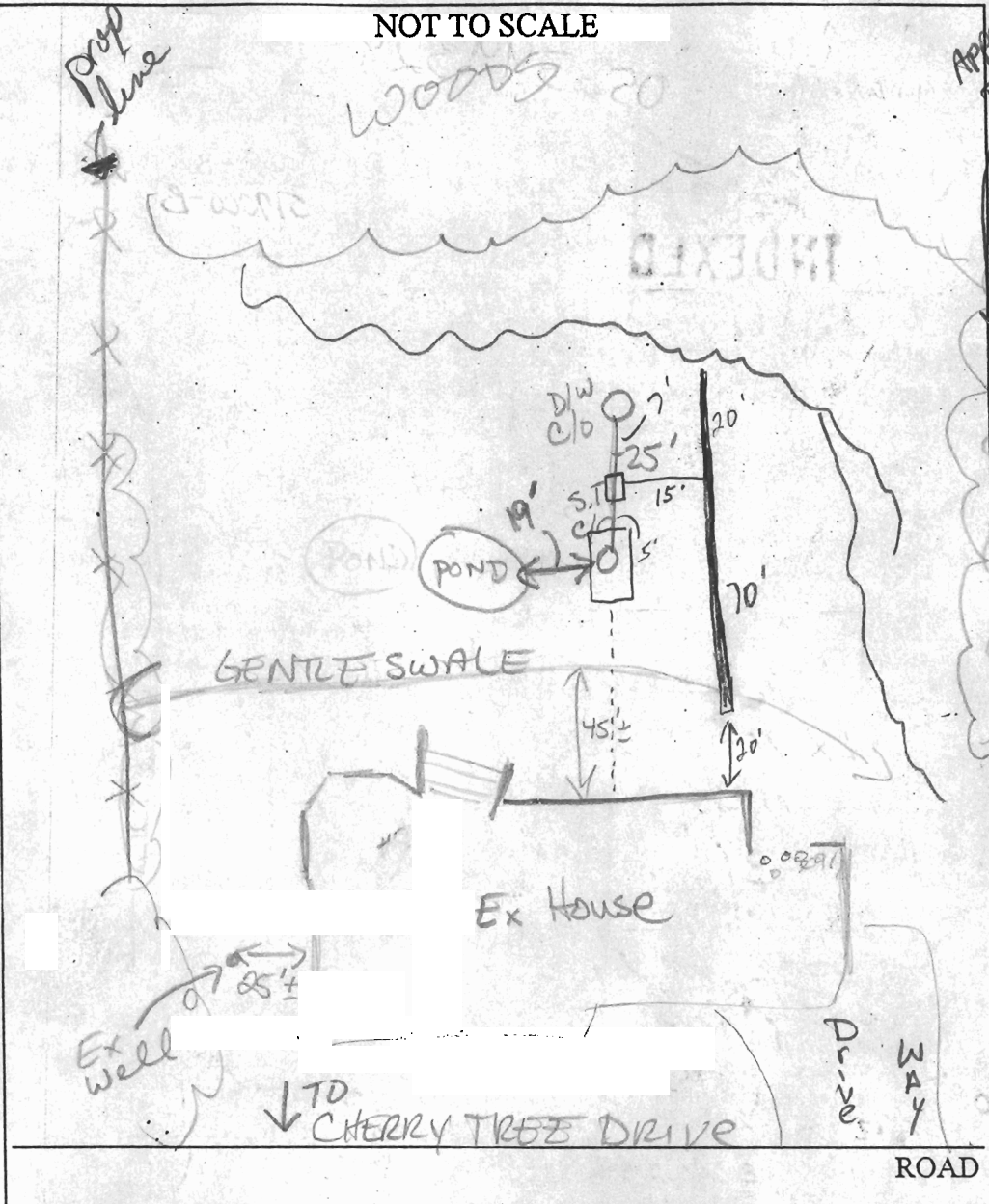

PRE-CONSTRUCTION

INSTALLATION 6/5/02 hvy Lm - Lm SAND, micaceous soils v. fr micaceous saprolite to 15%. OK install per specs. (KN/MR)
 6/11/02 Could only get 90' of trench. OK to cover all work

FINAL INSPECTOR

[Handwritten signature]

DATE OF APPROVAL

6/11/02