

04-318560

PUB. SEWER STATUS VERIFIED BY _____

ISSUE DATE: 11/30/93

APPROVAL DATE: _____

PERMIT INDEXED

P _____

A 516997-A

ON-SITE SEWAGE DISPOSAL SYSTEM HOWARD COUNTY HEALTH DEPARTMENT BUREAU OF ENVIRONMENTAL HEALTH

IS PERMITTED TO INSTALL ALTER

ADDRESS: _____ PHONE NUMBER: _____

SUBDIVISION: Woodcamp Farm LOT NUMBER: 15

ADDRESS: 17520 Hardy Road PROPERTY OWNER: William Hough

SEPTIC TANK CAPACITY (GALLONS): _____

PUMP CHAMBER CAPACITY (GALLONS): _____

NUMBER OF BEDROOMS: _____

SQUARE FEET PER BEDROOM: _____

LINEAR FEET OF TRENCH REQUIRED: _____

TRENCHES:	Trench to be _____ feet wide. Inlet _____ feet below original grade. Bottom maximum depth _____ feet below original grade. Effective area begins at _____ feet below original grade. _____ feet of stone below distribution pipe.
LOCATION:	_____
PURPOSE:	_____

PLANS APPROVED: _____ DATE: 11/30/93

- NOTE: PERMIT VOID AFTER 2 YEARS
- NOTE: CONTRACTOR RESPONSIBLE FOR SCHEDULING A PRE-CONSTRUCTION INSPECTION FOR ALL INSTALLATIONS
- NOTE: WATERTIGHT SEPTIC TANKS REQUIRED
- NOTE: ALL PARTS OF SEPTIC SYSTEM SHALL BE 100 FEET FROM ANY WATER WELL
- NOTE: MANHOLE RISERS REQUIRED ON ALL SEPTIC TANKS AND PUMP CHAMBERS

NEITHER THE HOWARD COUNTY COUNCIL NOR THE HEALTH DEPARTMENT IS RESPONSIBLE FOR THE SUCCESSFUL OPERATION OF ANY SYSTEM PERMITTEE RESPONSIBLE FOR OBTAINING FINAL APPROVAL ON THIS PERMIT CALL 410-313-2640 FOR INSPECTION OF SEPTIC SYSTEM

A516997-A

SITE INSPECTION SHEET

OWNER: William D Hough

DATE REQUESTED: 11/30/93 1:30

ADDRESS: 17520 HARDY RD. 25

DRILLER: RALPH MAYNE

MAP 7 Parcel 485 Lot 2B

WELL TAG # H0-92-0496

Woodcamp Farm S/O

COUNTY # A | 3

PROPOSAL: REPLACEMENT WELL SITE - NEARLY OUT OF WATER

DIRECTIONS - APPROACH FROM LONG CORNER RD.
LOCATION DIAGRAM

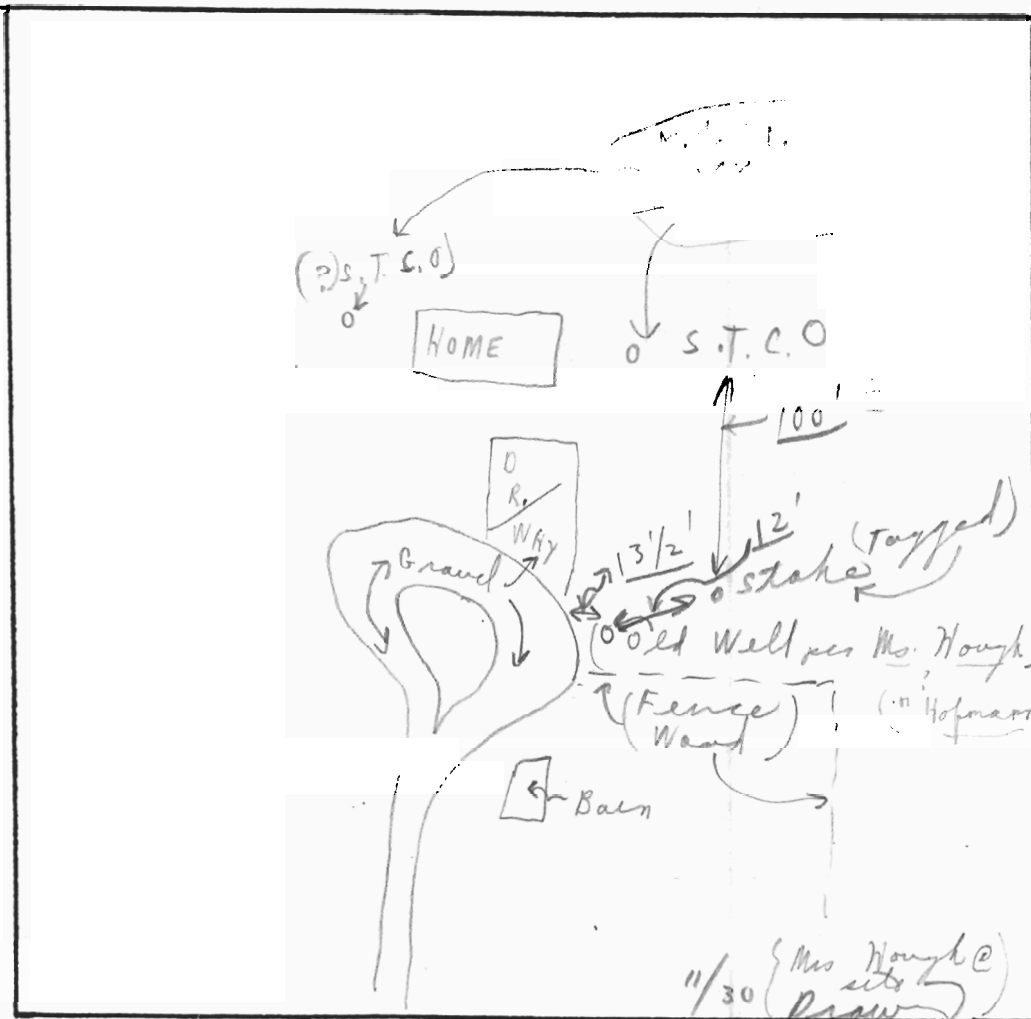

COMMENTS: "11/30/93" Well site - old; report well completion
report and tag # H0-92-0496; old (Hogman work)
at 30' from house; 15' from street with well 100' from
septic (located near old water well)

DATE: 11/30/93

INSPECTOR: C. P. [Signature]